

United States Department of the Interior  
National Park Service

National Register of Historic Places  
Registration Form

This form is for use in nominating or requesting determinations for individual properties and districts. See instructions in *How to Complete the National Register of Historic Places Registration Form* (National Register Bulletin 16A). Complete each item by marking "x" in the appropriate box or by entering the information requested. If an item does not apply to the property being documented, enter "N/A" for "not applicable." For functions, architectural classification, materials, and areas of significance, enter only categories and subcategories from the instructions. Place additional entries and narrative items on continuation sheets (NPS Form 10-900a). Use a typewriter, word processor, or computer, to complete all items.

1. Name of Property

historic name DITCHLEY

other names/site number DHR File No. 66-04

2. Location

street & number N side SR 607, 2000 ft E of jct with SR 669 N/A  not for publication

city or town Kilmarnock  vicinity

state Virginia code VA county Northumberland code 133 zip code 22482

3. State/Federal Agency Certification

As the designated authority under the National Historic Preservation Act, as amended, I hereby certify that this  nomination  request for determination of eligibility meets the documentation standards for registering properties in the National Register of Historic Places and meets the procedural and professional requirements set forth in 36 CFR Part 60. In my opinion, the property  meets  does not meet the National Register criteria. I recommend that this property be considered significant  nationally  statewide  locally. ( See continuation sheet for additional comments.)

W. C. Miller 14 Aug 1992  
Signature of certifying official/Title Date  
Virginia Department of Historic Resources  
State of Federal agency and bureau

In my opinion, the property  meets  does not meet the National Register criteria. ( See continuation sheet for additional comments.)

\_\_\_\_\_  
Signature of certifying official/Title Date  
\_\_\_\_\_  
State or Federal agency and bureau

4. National Park Service Certification

| I hereby certify that the property is:   | Signature of the Keeper | Date of Action |
|--|-------------------------|----------------|
| <input type="checkbox"/> entered in the National Register.<br><input type="checkbox"/> See continuation sheet.             | _____                   | _____          |
| <input type="checkbox"/> determined eligible for the National Register<br><input type="checkbox"/> See continuation sheet. | _____                   | _____          |
| <input type="checkbox"/> determined not eligible for the National Register.  | _____                   | _____          |
| <input type="checkbox"/> removed from the National Register.   | _____                   | _____          |
| <input type="checkbox"/> other. (explain): _____   | _____                   | _____          |

DITCHLEY  
Name of Property

Northumberland, VA  
County and State

**5. Classification**

**Ownership of Property**

(Check as many boxes as apply)

- private
- public-local
- public-State
- public-Federal

**Category of Property**

(Check only one box)

- building(s)
- district
- site
- structure
- object

**Number of Resources within Property**

(Do not include previously listed resources in the count.)

| Contributing | Noncontributing |           |
|--------------|-----------------|-----------|
| <u>3</u>     | <u>11</u>       | buildings |
| <u>2</u>     | <u>0</u>        | sites     |
| <u>0</u>     | <u>0</u>        | structure |
| <u>0</u>     | <u>0</u>        | objects   |
| <u>5</u>     | <u>11</u>       | Total     |

**Name of related multiple property listing**

(Enter "N/A" if property is not part of a multiple property listing.)

N/A

**Number of contributing resources previously listed in the National Register**

0

**6. Function or Use**

**Historic Functions**

(Enter categories from instructions)

Domestic: single dwelling  
\_\_\_\_\_  
\_\_\_\_\_  
\_\_\_\_\_  
\_\_\_\_\_  
\_\_\_\_\_  
\_\_\_\_\_

**Current Functions**

(Enter categories from instructions)

Domestic: single dwelling  
\_\_\_\_\_  
\_\_\_\_\_  
\_\_\_\_\_  
\_\_\_\_\_  
\_\_\_\_\_

**7. Description**

**Architectural Classification**

(Enter categories from instructions)

Colonial: Georgian  
\_\_\_\_\_  
\_\_\_\_\_

**Materials**

(Enter categories from instructions)

foundation Brick  
walls Brick  
\_\_\_\_\_  
roof Asbestos  
other \_\_\_\_\_  
\_\_\_\_\_

**Narrative Description**

(Describe the historic and current condition of the property on one or more continuation sheets.)

DITCHLEY  
Name of Property

Northumberland, Co. VA  
County and State

**8. Statement of Significance**

**Applicable National Register Criteria**

(Mark "x" in one or more boxes for the criteria qualifying the property for National Register listing.)

- A** Property is associated with events that have made a significant contribution to the broad patterns of our history.
- B** Property is associated with the lives of persons significant in our past.
- C** Property embodies the distinctive characteristics of a type, period, or method of construction or represents the work of a master, or possesses high artistic values, or represents a significant and distinguishable entity whose components lack individual distinction.
- D** Property has yielded, or is likely to yield, information important in prehistory or history.

**Criteria Considerations**

(Mark "x" in all the boxes that apply.)

Property is:

- A** owned by a religious institution or used for religious purposes.
- B** removed from its original location.
- C** a birthplace or grave.
- D** a cemetery.
- E** a reconstructed building, object, or structure.
- F** a commemorative property.
- G** less than 50 years of age or achieved significance within the past 50 years.

**Areas of Significance**

(Enter categories from instructions)

ARCHITECTURE

**Period of Significance**

1762-1850

**Significant Dates**

1762: traditional construction date  
of house

**Significant Person**

(Complete if Criterion B is marked above)

N/A

**Cultural Affiliation**

N/A

**Architect/Builder**

**Narrative Statement of Significance**

(Explain the significance of the property on one or more continuation sheets.)

**9. Major Bibliographical References**

**Bibliography**

(Cite the books, articles, and other sources used in preparing this form on one or more continuation sheets.)

**Previous documentation on file (NPS):**

- preliminary determination of individual listing (36 CFR 67) has been requested
- previously listed in the National Register
- previously determined eligible by the National Register
- designated a National Historic Landmark
- recorded by Historic American Buildings Survey # \_\_\_\_\_
- recorded by Historic American Engineering Record # \_\_\_\_\_

**Primary location of additional data:**

- State Historic Preservation Office
- Other State agency
- Federal agency
- Local government
- University
- Other

Name of repository:

Colonial Williamsburg Foundation  
Williamsburg, VA

DITCHLEY  
Name of Property

Northumberland Co., VA.  
County and State

**10. Geographical Data**

Acreeage of Property 156

**UTM References**

(Place additional UTM references on a continuation sheet.)

|      |         |          |         |
|------|---------|----------|---------|
| 1    | 18      | 382500   | 4177200 |
| Zone | Easting | Northing |         |
| 2    | 18      | 382520   | 4176560 |

|      |         |          |        |
|------|---------|----------|--------|
| 3    | 18      | 382210   | 417658 |
| Zone | Easting | Northing |        |
| 4    | 18      | 382190   | 417674 |

See continuation sheet

**Verbal Boundary Description**

(Describe the boundaries of the property on a continuation sheet.)

**Boundary Justification**

(Explain why the boundaries were selected on a continuation sheet.)

**11. Form Prepared By**

name/title Calder Loth, Senior Architectural Historian

organization Virginia Department of Historic Resources date March 1, 1992

street & number 221 Governor Street telephone (804) 786-3143

city or town Richmond state VA zip code 23219

**Additional Documentation**

Submit the following items with the completed form:

**Continuation Sheets**

**Maps**

A **USGS map** (7.5 or 15 minute series) indicating the property's location.

A **Sketch map** for historic districts and properties having large acreage or numerous resources.

**Photographs**

Representative **black and white photographs** of the property.

**Additional items**

(Check with the SHPO or FPO for any additional items)

**Property Owner**

(Complete this item at the request of SHPO or FPO.)

name Jessie Ball duPont Trust, James R. Glass, Representative

First Union National Bank, Trust Real Estate Management

street & number P.O. Box 40062 telephone \_\_\_\_\_

city or town Jacksonville state Florida zip code 32203-0062

**Paperwork Reduction Act Statement:** This information is being collected for applications to the National Register of Historic Places to nominate properties for listing or determine eligibility for listing, to list properties, and to amend existing listings. Response to this request is required to obtain a benefit in accordance with the National Historic Preservation Act, as amended (16 U.S.C. 470 *et seq.*).

**Estimated Burden Statement:** Public reporting burden for this form is estimated to average 18.1 hours per response including time for reviewing instructions, gathering and maintaining data, and completing and reviewing the form. Direct comments regarding this burden estimate or any aspect of this form to the Chief, Administrative Services Division, National Park Service, P.O. Box 37127, Washington, DC 20013-7127; and the Office of Management and Budget, Paperwork Reductions Projects (1024-0018), Washington, DC 20503.

United States Department of the Interior  
National Park Service

# National Register of Historic Places Continuation Sheet

Section number 7 Page 1 DITCHLEY, Northumberland County, Virginia

---

## SUMMARY DESCRIPTION

Located on Virginia's Northern Neck, Ditchley is a portion of a colonial Tidewater plantation noteworthy for its colonial plantation house. The property is between two tidal creeks within sight of the Chesapeake Bay. The architecturally sophisticated two-story mansion, erected circa 1762, is built of brick and covered with a hipped roof. Its interior preserves a significant quantity of early woodwork including an outstanding colonial stair. The interior underwent some remodeling in the Federal period at which time the most of the drawing room woodwork was installed. A bedroom wing was added to the south end around 1850. The house was renovated and modernized in the 1930s by the noted philanthropist, Mrs. Jessie Ball duPont. The property retains two early outbuildings. Also on the property is the colonial cemetery of the Lee family, original owners of Ditchley.

## CONTRIBUTING RESOURCES

### Setting

Ditchley today includes approximately 156 acres of the original colonial plantation that occupied the neck of land bounded by Dividing Creek, Lawrence Cove, and Prentice Creek within sight of the Chesapeake Bay. The end of the neck has been sold off in this century but the remaining portions of Ditchley still extend from creek to creek. The Ditchley mansion stands in a large grassy park consisting of a broad level lawn with large old trees and a massing of English boxwood. The western side is approached by an axial drive from the county road. The usual entrance to the property, however, is by the brick drive that curves from the county road to the south. Beyond the park is mostly open fields. The water front, both north and south, is generally tree-lined. Despite the separation of the property from the eastern end of the neck, and the bisection of the property by county Route 607, the immediate setting of the Ditchley mansion is still rural and retains some of its original waterfront.

### Main House

The main house at Ditchley is a classic example of a colonial Tidewater Virginia plantation mansion. Built of brick laid in Flemish bond with scattered glazed headers, the rectangular two-story structure follows the straightforward format of such notable colonial houses as Wilton, the

United States Department of the Interior  
National Park Service

## National Register of Historic Places Continuation Sheet

Section number 7 Page 2 DITCHLEY, Northumberland County, Virginia

---

### Description (continued)

George Wythe House, Brooke's Bank, and Carter's Grove (before alteration). Although the house underwent an extensive and largely undocumented restoration in the 1930s, the original character was respected in the project and the structure thus retains a high degree of architectural integrity. The major change was the addition of a one-story wing on the north end to house a kitchen and service areas. This wing balances a one-story bedroom wing on the south end added circa 1850.

Typical of many Tidewater mansions, Ditchley has a low hipped roof and nearly identical five-bay fronts. The first and second floors are separated by a plain, three-course belt course and the basement is set off by a beveled water table. The brick below the water table is laid in Flemish bond. The eight fireplaces are served by two interior end chimneys. The brickwork in both chimney stacks is laid in American bond suggesting that they both have been rebuilt above the roofline.<sup>1</sup> Rubbed brick is employed at the corners of the house and for the jambs of the windows and doors. Pre-restoration photographs in the Virginia State Library show that the windows were topped by gauged-brick jack arches of alternating stretcher-header pattern without closers. However, all of the jack arches were rebuilt in the restoration using ordinary brick but repeating the original pattern.<sup>2</sup> Except for the jack arches, most of the brickwork in the west side survives in relatively untouched condition; the east side has been largely repointed.

Both the land (west) and water (east) entrances are sheltered by early (probably Federal) but not original pedimented porches. Each of the porches has turned posts. Those on the east side have shafts that taper into elongated square bases at the railing level.<sup>3</sup> The posts on the west side have their lower portions encased in elongated pedestals. The pediments and cornices of the west porch are ornamented with rope moldings. The east porch has a modillion cornice. Plain railings with round handrails and square balusters enclose the porches. The only other exterior ornament is the main cornice surrounding the eaves. It consists of a crown molding, fascia and bed moldings, and has rather small, tightly spaced scrolled modillions. The west porch has what appear to be colonial sandstone steps with rounded nosings. The east porch has nineteenth century marble steps without nosings.

Except for two small second-story windows on the north wall (lighting chimney closets), the end walls of the house have no windows. The windows on the east and west elevations have what appear to be original architrave frames, however, the nine-over-nine sashes throughout likely date from the 1930s restoration. The pre-restoration photographs show similar sash but the muntins appear thinner than the present ones. All of the windows have molded sills. Characteristic of sophisticated Georgian houses of the period, the second-floor windows are slightly smaller than the first-story windows.

United States Department of the Interior  
National Park Service

# National Register of Historic Places Continuation Sheet

Section number 7 Page 3 DITCHLEY, Northumberland County, Virginia

---

## Description (continued)

The south wing is laid in Flemish bond incorporating many randomly placed glazed bricks. As the brickwork is fairly uneven, it may be that the bricks were salvaged from a colonial structure. The kitchen wing repeats the general lines of the south wing and is also laid in Flemish bond. Both wings are covered with gable roofs.<sup>4</sup>

The interior of Ditchley is maintained in excellent condition and remains essentially untouched since Mrs. duPont's death in 1970. Because of the fine craftsmanship employed in the restoration of the 1930s it is very difficult to determine what is original colonial woodwork, what is Federal period woodwork, and what woodwork dates from the 1930s. Adding to the confusion, some original woodwork was altered to make it appear mid-nineteenth century and some early nineteenth-century woodwork apparently has been reworked to make it appear more colonial. Because the restoration was undocumented, only a thorough paint-color analysis could precisely determine the periods of the various interior features, especially some of the moldings.<sup>5</sup> Nonetheless, significant portions of the woodwork unquestionably are original and the restoration was obviously an attempt to give the interior an overall handsome effect sympathetic to the original character of the house.

The most important original interior feature is an impressive open-well stair in the southeast corner of the passage. The stair railing is less academic in style than normally found in such sophisticated houses. It has a molded handrail, solid, baluster-type newels, and balusters consisting of urns supporting columns with swelled shafts. There are two balusters to a tread rather than the usual three. The open stringer has delicately scrolled brackets.

What appears to be original woodwork survives in the northwest first-floor room, referred to as the chamber in a 1780 inventory. This includes the raised-panel doors and trim, the chair railing, and an interesting mantel. The mantel shelf is a full entablature which breaks forward at each end. The ends are supported by stop-fluted Tuscan pilasters. The large drawing room in the southeast corner of the first floor, referred to as the "Hall" in the 1780 inventory, was remodeled in the Federal period and is dominated on its south wall by a Federal parti consisting of a mantel flanked by large arched recesses. The arches are supported on reeded pilasters and have molded keystones and paneled soffits. The mantel is a standard Federal type with a central panel, reeded pilasters and somewhat complex Federal moldings in the mantel shelf. The drawing room ceiling has a Greek Revival plaster medallion set in a plaster panel. The style of the medallion is similar to medallions found in several Northern Neck plantation houses.

United States Department of the Interior  
National Park Service

## National Register of Historic Places Continuation Sheet

Section number 7 Page 4 DITCHLEY, Northumberland County, Virginia

---

### Description (continued)

Some of the most interesting early woodwork is found in the small study in the southwest corner of the first floor, referred to in the 1780 inventory as the "Backroom." The Georgian mantel, which may be original, is flanked on the west side by an original cupboard with paneled doors. As the inventory lists library books in this room, the cupboard obviously was meant to hold books. Above the cupboard is an unusual frieze consisting of three squat tapered fluted pilasters supporting a cove molding. Apparently a matching cupboard was originally on the east side of the mantel. However, when a door was cut through the end wall to the 1850s wing, only the upper portion of the cupboard and the frieze above was retained. This makes for the odd arrangement of a small cupboard suspended high on the wall above the doorway to the wing. The paneled wainscoting in this room appears to be Federal but could be original. The detailing in the dining room is consistent with the rest of the first floor; however, the moldings in the Georgian mantel are very crisp, suggesting that it may be a 1930s addition.

The three second-floor chambers all have Federal mantels. Some of the second-floor doors are likely original, others appear to be reworked Federal or Greek Revival doors. An interesting feature of the southeast chamber is the paneling along the south wall fronting closets on either side of the fireplace. At first glance, the paneling appears to be early nineteenth-century because of the Greek moldings applied to cover the jambs of the rails and stiles. However, these moldings may be a later dressing up of original, somewhat plain colonial paneling. The paneling's cornice and chair rail are both colonial style. The mantel, however, is definitely Federal. Interestingly, the Georgian cornice in this room extends through the paneled partition into the closet. The principal alterations to the second floor include the installation of a bathroom and dressing room in the southwest corner. Small bathrooms have also been placed in the chimney closets of the two north chambers.

The attic is reached through a closet on the left of the mantel in the southeast room. A narrow opening leads up to the attic between the paneled wall and the end wall, along the haunch of the chimney. The attic preserves most of its original framing including two king-post trusses.

The 1850s wing has plain Greek Revival trim and is used for a bedroom and bathroom. The kitchen wing survives almost completely unaltered from the 1930s.



United States Department of the Interior  
National Park Service

## National Register of Historic Places Continuation Sheet

Section number 7 Page 5 DITCHLEY, Northumberland County, Virginia

---

### Outbuildings, Kitchen Site, and Cemetery

In addition to the main house, the property has two contributing outbuildings: a pair of frame smokehouses flanking the east side of the house. Both smokehouses have some early beaded siding and are topped by pyramidal roofs. The date of the smokehouses is uncertain; they may date as early as the late eighteenth century. Immediately to the north of the house is the site of the original frame kitchen outbuilding. This building is shown in early photographs of the house. The site has not been tested but may have archaeological value. The Lee family cemetery is located on the south of county Route 607, in a field near the shore of Prentice Creek. The principal element of the cemetery is the colonial marble slab marking the graves of Hancock Lee (died 1709), his first wife Mary Kendall Lee (died 1694), and his second wife Sarah Allerton Lee (died 1731).

### NON-CONTRIBUTING BUILDINGS AND STRUCTURES

Located on the property are eleven non-contributing buildings dating from the duPont ownership. To the northwest of the mansion is a two-story farm manager's house containing a garage. This building was erected in the 1930s; its massing, brickwork, and general detailing are inspired by the main house. Other non-contributing buildings include the following: a much-altered 1930s brick garage and apartment of no architectural interest, a mid-twentieth-century concrete-block storage building, a mid-twentieth-century doghouse, a mid-twentieth-century poultry house, a mid-twentieth-century stable, a mid-twentieth-century granary, an altered mid-twentieth-century tenant house, a mid-twentieth-century garage, and two mid-twentieth-century quonset huts. Except for the granary and stable which are located to the west of the main house, the rest of the non-contributing buildings are to the north of the main house. The non-contributing buildings and structures make little visual impact on the historic character of the property.

United States Department of the Interior  
National Park ServiceNational Register of Historic Places  
Continuation SheetSection number 8 Page 6DITCHLEY, NORTHUMBERLAND COUNTY

## STATEMENT OF SIGNIFICANCE

Ditchley, one of the Northern Neck's most historic plantations, was patented in 1651 by Richard Lee, progenitor of the Lee family of Virginia. The present mansion, begun circa 1762 by Kendall Lee, a great-grandson Richard Lee, is an important example of Tidewater Virginia Georgian architecture. Built of brick laid in Flemish bond, the house has the formal five-bay facades, low hipped roof, and geometric proportions characteristic of Virginia's finer colonial houses. A noteworthy interior feature is the handsomely detailed Georgian stair. For most of the nineteenth century, Ditchley was owned by the Balls, a prominent Northern Neck family whose kinswoman was Mary Ball, mother of George Washington. In 1932, Ditchley was purchased by Mr. and Mrs. Alfred I. duPont of Wilmington, Delaware. Mrs. duPont, the former Jessie Dew Ball (1884-1970) of Northumberland County, was related to the Balls of Ditchley and sought the property as a means of maintaining her Virginia connections. Following the death of her husband, Mrs. duPont became one of America's most generous philanthropists, personally making grants to several hundred institutions over four decades. The Jessie Ball duPont Trust maintains Ditchley for the use of her Virginia relatives. The period of significance for the property extends from the construction date of the house (circa 1762) to 1850, the date when the south wing is believed to have been added.

HISTORIC CONTEXT

Richard Lee, founder of the Virginia dynasty of Lees, arrived in Jamestown in 1639 seeking business opportunities. Lee's uncle was a successful London merchant and Lee sought to represent the family firm in the Indian trade. His ingenuity and enterprise soon earned him important posts in the colonial government. He was named clerk of the Quarter Court and in 1642 Governor Berkeley named him to the newly created office of attorney general. Lee expanded his interests through various land purchases. Before 1649, he acquired from local Indians some land on Dividing Creek on the Northern Neck. In 1651 he patented additional land thus forming what later

United States Department of the Interior  
National Park ServiceNational Register of Historic Places  
Continuation SheetSection number 8 Page 7 Ditchley, Northumberland County, VA

## Statement of Significance (continued)

was to become Ditchley, where Lee and his family set up residence in 1656. Lee did not live full-time on the Northern Neck. In 1658 he purchased a house near London where he moved for a stay of several years during which time he traveled back and forth to Virginia looking after his interests. In 1664 Richard Lee died at his Dividing Creek plantation, leaving it to be split among three of his five sons.<sup>1</sup>

The southern part of the Lee holdings, the portion that was to become Ditchley, was inherited by Hancock Lee (1653-1709) in 1673. At the time of his inheritance, Hancock Lee was living on the Eastern Shore with his first wife, Mary Kendall, daughter of William Kendall, daughter of the Speaker of the House of Burgesses. Hancock Lee returned to his Northumberland County inheritance about 1685 and built a house there.<sup>2</sup> Following the death of his first wife, Lee married Sarah Allerton, a descendant of William Brewster, leader of the Plymouth Colony. Lee and his two wives are buried in the family cemetery at Ditchley. At Hancock Lee's death the plantation was left to Richard Lee, his son by Mary Kendall. It was Richard Lee who named the property Ditchley after the seat of the Earl of Litchfield in Oxfordshire, England. Lee apparently thought he was related to this noble family of Lees but was mistaken.<sup>3</sup> At Richard Lee II's death in 1740, Ditchley became the property of his son Kendall Lee.

The present brick mansion was constructed by Kendall Lee around 1762.<sup>4</sup> It remained the Lee family home until 1789 when Kendall Lee's son, William, sold it in 1789 to his nephew James Ball. The property stayed in Ball family ownership until 1920 when it was sold to Cora Lee Carter Keane. Cora Keane was a Lee family descendant so the claim can be made that Ditchley continued in the ownership of descendants of Richard Lee I.

Although the name of a designer or builder has not been discovered, Kendall Lee's house follows the pattern of several noted mid-eighteenth-century colonial Virginia houses. The rectangular plan, five-bay facade, hipped roof, Flemish bond brickwork, and modillion cornice give Ditchley a strong similarity to Wilton in Richmond, the Wythe House in Williamsburg, Pembroke in Virginia Beach, and Brooke's Banke in Essex County. These dwellings, while seemingly simple because of their lack of ornament, are architecturally refined compositions whose aesthetic qualities come primarily from their carefully calculated proportions and fine workmanship. Only

United States Department of the Interior  
National Park Service

## National Register of Historic Places Continuation Sheet

Section number 8 Page 8 Ditchley, Northumberland County, VA

---

Statement of Significance (continued)

a small number of houses of this quality were built in the Virginia colony and only a handful survive. Nonetheless, they have come to symbolize the grace and elegance of high-style colonial Virginia design, and have had a profound impact on American taste, inspiring hundreds of twentieth-century imitations across the country. As such, Ditchley and related works have become icons of our architectural heritage, a distinctly Virginian contribution.

In 1932 Cora Keane's heirs sold the house and sixty-three acres to Ditchley, Inc., a corporation formed for the purpose of purchase by Alfred I. duPont, of Wilmington, Delaware.<sup>5</sup> At the time, duPont was married to his third wife, the former Jessie Dew Ball of Northumberland County. Mr. duPont was familiar with Ditchley as he had come there on hunting expeditions around the turn of the century where he first met Jessie Ball, a teenager at the time. Mrs. duPont herself was very familiar with Ditchley as it had long been the home of her relations. She was eager to acquire Ditchley for it served as a means for maintaining her identification with Virginia and the Ball family of whom she was very proud. Following the purchase Mrs. duPont undertook an extensive restoration of the house and grounds. The work was carried out by Carter Keane, a local contractor. Mr. duPont died in 1935 and Mrs. duPont continued to take an interest in Ditchley although her charitable work prevented her from spending much time there, coming only for a few days each year.

Although she was born into an distinguished Virginia family, Jessie Ball duPont as a child knew the deprivations shared by genteel Southerners in the decades following the Civil War. Being more practical than most, her family placed a high priority on education. Jessie was sent to Longwood College in Farmville where she prepared for a teaching career. Following graduation, she moved to San Diego where she taught school and became an educational administrator. In 1920 she reestablished her friendship with Alfred I. duPont whom she had met on his Virginia hunting trips, and married him the following year. As wife of a member of one of the nation's richest families, her life changed abruptly. She used her new status to her advantage by becoming a close and able business advisor to her husband.

Following Mr. duPont's death, Jessie Ball duPont took control of many of her husband's business and financial interests and began her philanthropic activities. In order to make certain that her

United States Department of the Interior  
National Park ServiceNational Register of Historic Places  
Continuation SheetSection number 8 Page 9 Ditchley, Northumberland County, VA

---

Statement of Significance (continued)

resources were not wasted on needless large projects, she personally supervised the granting of small sums for hundreds of college scholarships as well as for numerous charitable and religious organizations. The range of her interests was extraordinary. She was particularly interested in education, and scores of preparatory schools, colleges and universities received funds from her. Her interest in history was evident in the many grants she made to historical societies, historic houses, and museums. A very religious person, Mrs. duPont also made numerous bequests to religious institutions and to specific churches, especially ones affiliated with the Episcopal denomination. Other recipients of her munificence were hospitals, clinics, and social service organizations. At the time of her death, Mrs. duPont's personal fortune was over fifty million dollars, making her one of the richest women on America. The bulk of her fortune was left to establish the Jessie Ball duPont Religious, Charitable, and Educational Fund, which today has assets of over one hundred and thirty million dollars, making annual grants totaling six to eight million dollars. The fund is unique for its diversity and for still reflecting the interests of an individual who sought to share her enormous wealth for the benefit of many, many worthy activities.

Footnotes

1. One of Richard Lee's sons, Richard II, was the father of Thomas Lee from whom the Stratford branch of the Lees are descended.
2. The site of Hancock Lee's house is said to be on the present Ditchley property. It has not been identified by archaeological survey.
3. Ludwell Lee Montague, "The Lees of Northumberland," Bulletin of the Northumberland County Historical Society, Vol. IV, 1967, pp 10-11.
4. Various dates for the construction of Ditchley are given in various publications. Most frequently the date 1752 is cited. The 1762 date was assigned by Ludwell Lee Montague, op. cit., whose research on matters relating to the Lees is normally reliable. This date is consistent with the architecture of the house.
5. The duPonts increased the size of the holding through subsequent purchases.

United States Department of the Interior  
National Park Service

National Register of Historic Places  
Continuation Sheet

Section number 9 Page 10 Ditchley, Northumberland County, Va

---

PHOTOGRAPHS

All photographs are of:

DITCHLEY  
Northumberland County, VA.  
DHL FILE # 66-4

1. CREDIT: CALDER LOTH  
DATE: 1991  
VIEW OF: west elevation-main house; view looking east  
NEGATIVE FILED: VA. State Library, Richmond, VA.  
NEG. NO.: 11523  
FILE NO.: 66-4  
PHOTO 1 OF 7
2. CREDIT: CALDER LOTH  
DATE: 1991  
VIEW OF: staircase-main house; view looking south  
NEGATIVE FILED: VA. State Library, Richmond, VA.  
NEG. NO.: 11523  
FILE NO.: 66-4  
PHOTO 2 OF 7
3. CREDIT: CALDER LOTH  
DATE: 1991  
VIEW OF: north wall, northwest room, first floor-main house;  
view looking north  
NEGATIVE FILED: VA. State Library, Richmond, VA.  
NEG. NO.: 11523  
FILE NO.: 66-4  
PHOTO 3 OF 7
4. CREDIT: JEFF O'DELL  
DATE: 1991  
VIEW OF: south elevation, farm manager's house; view looking  
north  
NEGATIVE FILED: VA. State Library, Richmond, VA.  
NEG. NO.: 10897  
FILE NO.: 66-4  
PHOTO 4 OF 7

United States Department of the Interior  
National Park Service

**National Register of Historic Places  
Continuation Sheet**

Section number   9   Page   11   Ditchley, Northumberland County, VA

---

Major Bibliographical References (continued)

5. CREDIT: RALPH HARVARD  
DATE: 1972  
VIEW OF: east elevation-main house with smokehouses; view looking west  
NEGATIVE FILED: VA. State Library, Richmond, VA.  
NEG. NO.: 1373  
FILE NO.: 66-4  
PHOTO 5 OF 7
  
6. CREDIT: RALPH HARVARD  
DATE: 1972  
VIEW OF: Slab marker of Hancock Lee; view looking down onto marker  
NEGATIVE FILED: VA. State Library, Richmond, VA.  
NEG. NO.: 1373  
FILE NO.: 66-4  
PHOTO 6 OF 7
  
7. CREDIT: JEFF O'DELL  
DATE: 1991  
VIEW OF: view of three typical non-contributing outbuildings: brick garage, storage building, doghouse; view looking north  
NEGATIVE FILED: VA. State Library, Richmond, VA.  
NEG. NO.: 10897  
FILE NO.: 66-4  
PHOTO 7 OF 7

United States Department of the Interior  
National Park ServiceNational Register of Historic Places  
Continuation SheetSection number 5 Page 12 Ditchley, Northumberland County, VirginiaINVENTORY

| <u>Name</u>             | <u>Date</u>        | <u>Status</u>                |
|-------------------------|--------------------|------------------------------|
| 1. Main house           | c. 1762            | contributing building        |
| 2. south smokehouse     | 18th/early 19th c. | contributing building        |
| 3. north smokehouse     | "                  | contributing building        |
| 4. farm manager's house | c. 1930            | non-contributing<br>building |
| 5. brick garage         | mid-20th-cen.      | non-contributing<br>building |
| 6. storage building     | mid-20th cen.      | non-contributing<br>building |
| 7. doghouse             | mid-20th cen.      | non-contributing<br>building |
| 8. poultry house        | mid-20th cen.      | non-contributing<br>building |
| 9. stable               | mid-20th cen.      | non-contributing<br>building |
| 10. granary             | mid-20th-cen.      | non-contributing<br>building |
| 11. s. quonset hut      | mid-20th-cen.      | non-contributing<br>building |
| 12. n. quonset hut      | mid-20th-cen.      | non-contributing<br>building |
| 13. tenant house        | mid-20th-cen.      | non-contributing<br>building |
| 14. garage              | mid-20th-cen.      | non-contributing<br>building |



United States Department of the Interior  
National Park Service

**National Register of Historic Places  
Continuation Sheet**

Section number 5 Page 13 Ditchley, Northumberland County, Virginia

---

|                  |                     |                   |
|------------------|---------------------|-------------------|
| 15. Lee Cemetery | early 18th-cen.     | contributing site |
| 16. kitchen site | mid- late 18th-cen. | contributing site |

Resource Count:

3 contributing buildings  
2 contributing sites  
11 non-contributing buildings

United States Department of the Interior  
National Park Service

## National Register of Historic Places Continuation Sheet

Section number 10 Page 14 Ditchley, Northumberland County, Virginia

---

Acreage of Property ca. 156

### UTM References (continued)

E. 18 381700 4176690 F. 18 381650 4176770

G. 19 392-4-418700 0 H. 18 381960 4177290

### Verbal Boundary Description

Beginning at point on the south bank of Dividing Creek delineated by UTM reference A 18/382500/4177200, proceed south approximately 2100' to a point on the north bank of Prentice Creek delineated by UTM reference B 18/382520/4176560, then proceed west along the north bank of Prentice Creek to a point delineated by UTM reference C 18/382210/4176580, then proceed north approximately 600' to a point delineated by UTM reference D 18/382190/4176740, then proceed west approximately 1600' to a point on the eastern right-of-way of county route 669 delineated by UTM reference E 18/381700/4176690, then proceed north along the said right-of-way to the intersection of county route 669 and 607, then proceed northeast along the southern right-of-way of county route 669 approximately 1400' to a point delineated by UTM reference F 18/382040/4176990, then proceed north approximately 1100' to a point on the south bank of Dividing Creek delineated by UTM reference G 18/382960/4177290, thence east along the south bank of said creek to the point of beginning.

### Boundary Justification

The boundaries include the mansion, the two contributing outbuildings, the contributing farm manager's house, the archaeological site of the kitchen, and the Lee family cemetery. The boundaries follow the property lines of the land owned by the Jessie Ball DuPont Trust and take in shore line on both Dividing and Prentice creeks. The open fields to the north and south of the mansion maintain a rural context for the property.

property continues northward  
bordering Dividing Creek and Lawrence Cove

# Ditchley Northumberland County, VA

Site plan, showing all contributing  
and noncontributing structures.  
Numbers are keyed to inventory.  
J. O'Dell, January 1992  
Not to scale.

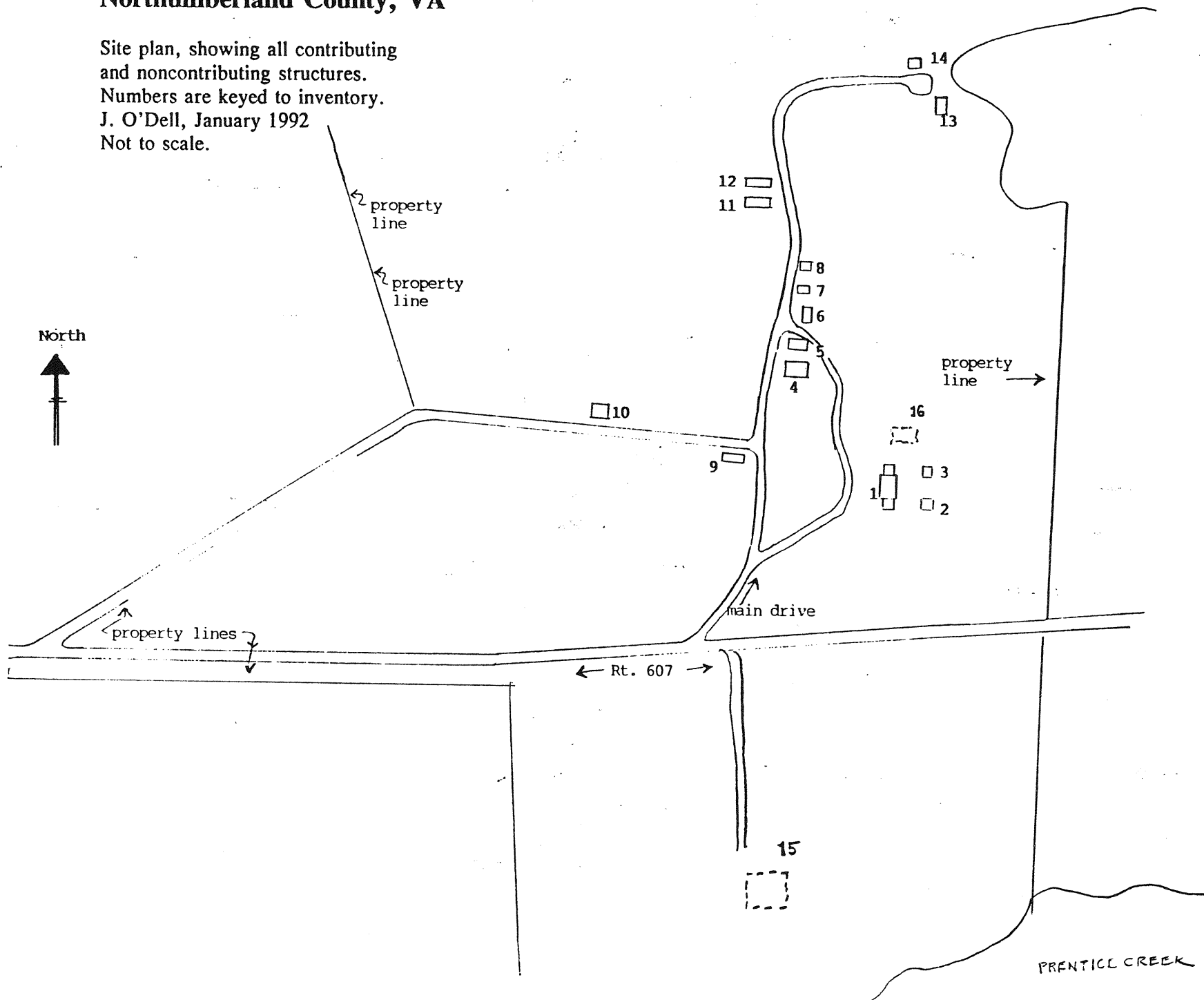



579 N SW  
(LANCASTER)

UNITED STATES  
DEPARTMENT OF THE INTERIOR  
GEOLOGICAL SURVEY

76° 22' 30"  
37° 45'

BURGESS 10 MI.  
WICOMICO CHURCH 4.5 MI.

381000m. E.

382

20'

383

4178000m. N.

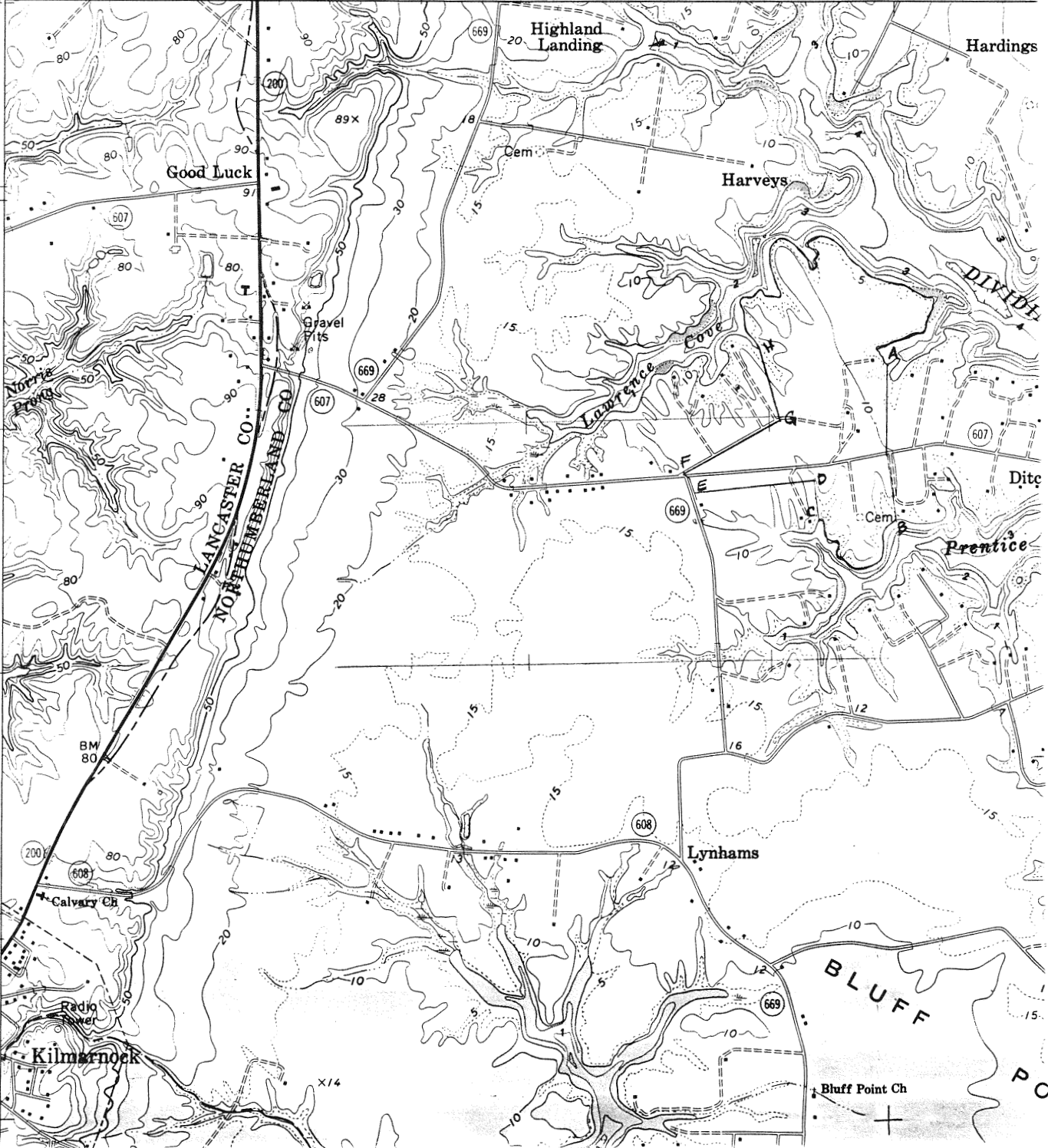

Ditchley  
DHR 66-4  
NORTHUMBERLAND Co.  
18/382500/  
4177200 4177  
18/382520/  
4176560  
18/382210/  
4176580  
18/382190/  
4176200  
18/381700/  
4176600  
18/381600/  
4176000  
18/382040/  
4176990  
18/381900/  
4177290  
LEEPS BAY, VA QUAD  
42'30"