

VLR Listed: 7/6/1971
 NRHP Listed: 8/7/1972

Form 10-300
 (July 1969)

UNITED STATES DEPARTMENT OF THE INTERIOR
 NATIONAL PARK SERVICE

**NATIONAL REGISTER OF HISTORIC PLACES
 INVENTORY - NOMINATION FORM**

(Type all entries - complete applicable sections)

STATE: VIRGINIA	
COUNTY: CLARKE	
FOR NPS USE ONLY	
ENTRY NUMBER	DATE
AUG 7 1972	



1. NAME

COMMON: THE TULEYRIES

AND/OR HISTORIC: THE TULEYRIES

2. LOCATION

STREET AND NUMBER:
 .8 mi. NE of Rt. 628, 1.5 mi. E of White Post

CITY OR TOWN:
 (White Post vicinity)

STATE: VIRGINIA CODE: 51 COUNTY: CLARKE CODE: 043

3. CLASSIFICATION

CATEGORY (Check One)	OWNERSHIP	STATUS	ACCESSIBLE TO THE PUBLIC
<input type="checkbox"/> District <input type="checkbox"/> Site <input type="checkbox"/> Object	<input checked="" type="checkbox"/> Building <input type="checkbox"/> Structure <input type="checkbox"/> Private <input type="checkbox"/> Both	<input checked="" type="checkbox"/> Occupied <input type="checkbox"/> Unoccupied <input type="checkbox"/> Preservation work in progress	Yes: <input type="checkbox"/> Restricted <input type="checkbox"/> Unrestricted <input checked="" type="checkbox"/> No
PRESENT USE (Check One or More as Appropriate)			
<input checked="" type="checkbox"/> Agricultural <input type="checkbox"/> Commercial <input type="checkbox"/> Educational <input type="checkbox"/> Entertainment	<input type="checkbox"/> Government <input type="checkbox"/> Industrial <input type="checkbox"/> Military <input type="checkbox"/> Museum	<input type="checkbox"/> Park <input checked="" type="checkbox"/> Private Residence <input type="checkbox"/> Religious <input type="checkbox"/> Scientific	<input type="checkbox"/> Transportation <input type="checkbox"/> Other (Specify) _____ <input type="checkbox"/> Comments _____

4. OWNER OF PROPERTY

OWNER'S NAME: Mrs. Orme Wilson

STREET AND NUMBER: The Tuleyries

CITY OR TOWN: White Post STATE: Virginia CODE: 51

5. LOCATION OF LEGAL DESCRIPTION

COURTHOUSE, REGISTRY OF DEEDS, ETC.: Clarke County Court House

STREET AND NUMBER:

CITY OR TOWN: Berryville STATE: Virginia CODE: 51

6. REPRESENTATION IN EXISTING SURVEYS

TITLE OF SURVEY: Historic American Building Survey

DATE OF SURVEY: c 1900 Federal State County Local

DEPOSITORY FOR SURVEY RECORDS: Library of Congress

STREET AND NUMBER:

CITY OR TOWN: Washington STATE: D. C. CODE: 11

SEE INSTRUCTIONS

STATE: VIRGINIA
 COUNTY: CLARKE
 ENTRY NUMBER
 DATE
 FOR NPS USE ONLY

7. DESCRIPTION

CONDITION	(Check One)					
	<input checked="" type="checkbox"/> Excellent	<input type="checkbox"/> Good	<input type="checkbox"/> Fair	<input type="checkbox"/> Deteriorated	<input type="checkbox"/> Ruins	<input type="checkbox"/> Unexposed
	(Check One)			(Check One)		
	<input type="checkbox"/> Altered	<input checked="" type="checkbox"/> Unaltered	<input type="checkbox"/> Moved	<input checked="" type="checkbox"/> Original Site		

DESCRIBE THE PRESENT AND ORIGINAL (If known) PHYSICAL APPEARANCE

THE TULEYRIES

Formed around 1833, The Tuleyries is an extensive estate containing an architecturally important residence, numerous early farm buildings, formal gardens, a park, pastures and woodlands. The complex is situated in the heart of the lower Shenandoah Valley, a picturesque and largely unspoiled region of finely maintained farms and orchards, all in view of the Blue Ridge Mountains. The Tuleyries is still operated as a working farm, and also serves as the summer residence of its owner.

The principal building of the estate, the residence, is a large, Late-Federal mansion built of white painted brick. The original block of the house is approximately 40 x 60 feet, although two-story additions on the rear have greatly increased the over-all size of the structure. The entrance front is embellished by a tetrastyle pedimented portico with very tall and slender Corinthian columns. The columns are wood and have stopped fluting. The front doorway and the second floor hall window directly above it are both three-part compositions topped with elliptical arches containing intricate tracery. Crowning the house's shallow hipped roof is an octagonal cupola roofed with an octagonal dome. At the apex of the dome is a metal orb.

On the interior; the entrance hall is covered by a shallow coffered dome very similar to the type employed by Benjamin Latrobe in many of his works. At the rear of the hall is a wide spiral staircase. The original portion of the house has been little altered inside except for the two large rooms on the right of the hall that were retrimmed with mahogany paneling in the early part of the present century. An interesting feature of the interior is the extensive basement which contains the old kitchen.

The house is set on a slight hill that has been planted with fine specimens of trees and shrubbery to form an informal park. Many of the trees are part of the original landscaping. An avenue of extremely old cedars leads northward from the house to an extensive formal garden containing outstanding boxwood. Admission to the grounds immediately surrounding the house is through an elaborate triple-arch brick structure containing a porter's lodge. To the northwest of the house is an interesting collection of early farm buildings including an old forge, smokehouse, ice-house, carriage house, stable, and barns. Nearly all of the buildings are brick and are treated architecturally. The most elaborate have stepped gable ends with cross gables, arched windows, and dormers.

SEE INSTRUCTIONS



3. SIGNIFICANCE

PERIOD (Check One or More as Appropriate)

- | | | | |
|--|---------------------------------------|--|---------------------------------------|
| <input type="checkbox"/> Pre-Columbian | <input type="checkbox"/> 16th Century | <input type="checkbox"/> 18th Century | <input type="checkbox"/> 20th Century |
| <input type="checkbox"/> 15th Century | <input type="checkbox"/> 17th Century | <input checked="" type="checkbox"/> 19th Century | |

SPECIFIC DATE(S) (If Applicable and Known)

AREAS OF SIGNIFICANCE (Check One or More as Appropriate)

- | | | | |
|--|--|--|--|
| <input type="checkbox"/> Aboriginal | <input type="checkbox"/> Education | <input type="checkbox"/> Political | <input type="checkbox"/> Urban Planning |
| <input type="checkbox"/> Prehistoric | <input type="checkbox"/> Engineering | <input type="checkbox"/> Religion/Philosophy | <input type="checkbox"/> Other (Specify) |
| <input type="checkbox"/> Historic | <input type="checkbox"/> Industry | <input type="checkbox"/> Science | |
| <input checked="" type="checkbox"/> Agriculture | <input type="checkbox"/> Invention | <input type="checkbox"/> Sculpture | |
| <input checked="" type="checkbox"/> Architecture | <input checked="" type="checkbox"/> Landscape Architecture | <input type="checkbox"/> Social/Humanitarian | |
| <input type="checkbox"/> Art | <input type="checkbox"/> Literature | <input type="checkbox"/> Theater | |
| <input type="checkbox"/> Commerce | <input type="checkbox"/> Military | <input type="checkbox"/> Transportation | |
| <input type="checkbox"/> Communications | <input type="checkbox"/> Music | | |
| <input type="checkbox"/> Conservation | | | |



STATEMENT OF SIGNIFICANCE THE TULEYRIES

One of the finest and best preserved ante-bellum estates in Virginia, The Tuleyries was formed around 1833 by Colonel Joseph Tuley, Jr. (1796-1860). Tuley's father was originally from New Jersey and moved to Virginia before 1768 where he amassed a sizable fortune in the tanning business. The greater part of this fortune he devised to his only son, who in turn had a gift for money-making. The son set about to ensconce himself in a setting suitable to his wealth. The result was a lavish expenditure on a stately residence almost European in scale, a complex of architecturally dignified farm buildings, and extensive gardens and grounds, all forming an estate so impressive that Tuley was moved to have its name be a play not only on his own but on the French Royal palace of the Tuileries. In 1833 Samuel Kercheval, the noted early historian of the Valley described The Tuleyries as "a most splendid and expensive mansion...in the most elegant style of modern architecture"; and said that the yard was decorated with "a great variety of native and imported trees and shrubbery, with several orange trees which bear fruit handsomely." Kercheval went on to say "Adjoining the yard, an extensive park is enclosed in the forest, within which enclosure there are a number of native elks and deer." In 1909 Thomas Cartmell in his monumental work, Shenandoah Valley Pioneers and their Descendants called The Tuleyries a "princely estate" and explained that because Tuley was a large slaveholder he was able to maintain "all the attractive features of it."

After Tuley's death in 1860, the War between the States brought calamitous damage to his estate, and his widow was forced to sell The Tuleyries in 1866 to Colonel Upton L. Boyce, an attorney for the Norfolk and Western Railway. In 1903 it was sold to Graham F. Blandy of New York who spent a considerable amount of money and effort restoring the estate to its former splendor. Shortly after Blandy completed his renovation of the house and grounds, Cartmell declared that the estate's present appearance "shows no radical changes from the original plans and designs, while the transformation is wonderful." He went on to say: "The gentleman (Blandy) who has produced it, is to be congratulated for preserving the type in vogue in the early part of the 19th Century."

Upon Blandy's death in 1926, over half of The Tuleyries lands was left to the University of Virginia as an agricultural experimental station. The residence, gardens, and most of the farm buildings were included with the land that went to his widow. The estate is now owned by one of her sisters, Mrs. Orme Wilson.

SEE INSTRUCTIONS

9. MAJOR BIBLIOGRAPHICAL REFERENCES

Cartmell, T. K., Shenandoah Valley Pioneers and Their Descendants, Berryville, Va.: Chesapeake Book Company, 1963.
 Christian, Frances Archer, and Susanne Williams Massie, editors, Homes and Gardens in Old Virginia, Richmond: Garrett & Massie, Inc. 1962
 Gold, Thomas D., History of Clarke County Virginia, Berryville, Va.: Chesapeake Book Company, 1962.
 Wayland, John W., Historic Homes of Northern Virginia, Staunton, Va.: The McClure Company, Incorporated, 1937.

10. GEOGRAPHICAL DATA

LATITUDE AND LONGITUDE COORDINATES DEFINING A RECTANGLE LOCATING THE PROPERTY			O R	LATITUDE AND LONGITUDE COORDINATES DEFINING THE CENTER POINT OF A PROPERTY OF LESS THAN TEN ACRES		
CORNER	LATITUDE	LONGITUDE		LATITUDE	LONGITUDE	
	Degrees Minutes Seconds	Degrees Minutes Seconds		Degrees Minutes Seconds	Degrees Minutes Seconds	
NW	39° 04' 50"	78° 05' 06"				
NE	39° 04' 50"	78° 03' 47"				
SE	39° 03' 43"	78° 03' 47"				
SW	39° 03' 43"	78° 05' 06"				
APPROXIMATE ACREAGE OF NOMINATED PROPERTY:			347½			
LIST ALL STATES AND COUNTIES FOR PROPERTIES OVERLAPPING STATE OR COUNTY BOUNDARIES						
STATE:	CODE	COUNTY	CODE			
STATE:	CODE	COUNTY:	CODE			
STATE:	CODE	COUNTY:	CODE			
STATE:	CODE	COUNTY:	CODE			



SEE INSTRUCTIONS

11. FORM PREPARED BY

NAME AND TITLE: Staff, Virginia Historic Landmarks Commission; James W. Moody, Director

ORGANIZATION: Virginia Historic Landmarks Commission DATE: June 3, 1971

STREET AND NUMBER: Room 1116, Ninth Street State Office Building

CITY OR TOWN: Richmond STATE: Virginia CODE: 51

12. STATE LIAISON OFFICER CERTIFICATION NATIONAL REGISTER VERIFICATION

As the designated State Liaison Officer for the National Historic Preservation Act of 1966 (Public Law 89-665), I hereby nominate this property for inclusion in the National Register and certify that it has been evaluated according to the criteria and procedures set forth by the National Park Service. The recommended level of significance of this nomination is:

National State Local

Name: James W. Moody, Jr.
 James W. Moody, Jr., Director
 Virginia Historic Landmarks Commission

Date: 6/30/71; 7/6/71

I hereby certify that this property is included in the National Register.

Robert W. Wiley
 Chief, Office of Archeology and Historic Preservation

Date: 8/7/72

ATTEST:
William J. Stunz
 Keeper of The National Register

Date: _____

U.S.G.S 7½' quadrangle (Scale:1:24000)
 Boyce, Va. 1966

The Tuleyries

Latitude	Longitude
NW 39° 04' 50"	78° 05' 06"
NE 39° 04' 50"	78° 03' 47"
SE 39° 03' 43"	78° 03' 47"
SW 39° 03' 43"	78° 05' 06"

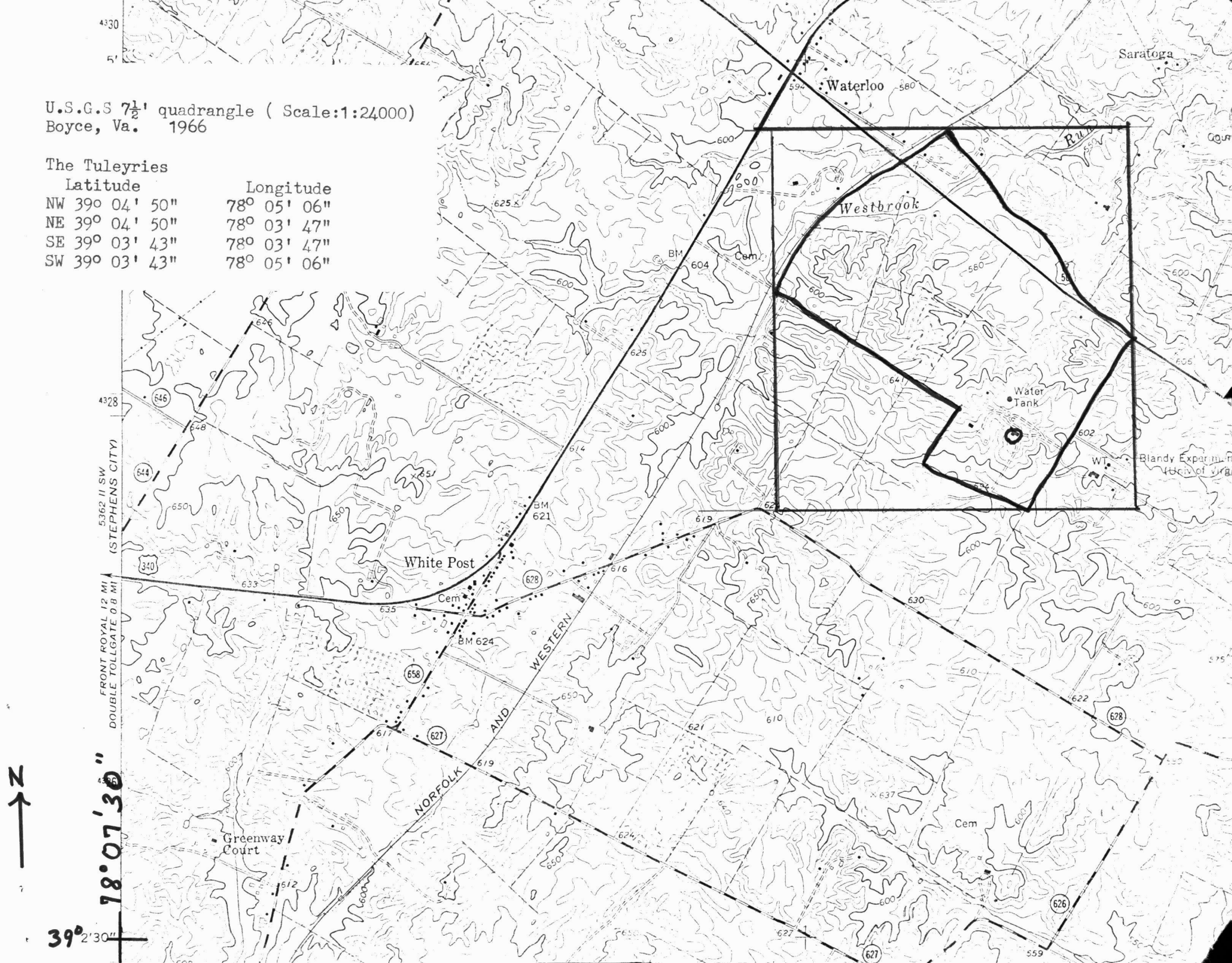

18° 07' 30"

39° 2' 30"

5362 1/2 MI SW (STEPHENS CITY)
 FRONT ROYAL 12 MI
 DOUBLE TOLLGATE 0.8 MI