

Woodlawn Plantation (Boundary Increase 2011)

Fairfax County, Virginia

United States Department of the Interior
National Park Service

LISTED ON:	
VLR	09/22/2011
NRHP	11/18/2011

National Register of Historic Places Registration Form

This form is for use in nominating or requesting determinations for individual properties and districts. See instructions in National Register Bulletin, *How to Complete the National Register of Historic Places Registration Form*. If any item does not apply to the property being documented, enter "N/A" for "not applicable." For functions, architectural classification, materials, and areas of significance, enter only categories and subcategories from the instructions. **Place additional certification comments, entries, and narrative items on continuation sheets if needed (NPS Form 10-900a).**

1. Name of Property

historic name Woodlawn Plantation (Boundary Increase 2011)

other names/site number DHR File Number: 029-0056

2. Location

street & number 9000 Richmond Highway N/A not for publication
 city or town Alexandria X vicinity
 state Virginia code VA county Fairfax code 059 zip code 22309

3. State/Federal Agency Certification

As the designated authority under the National Historic Preservation Act, as amended,
 I hereby certify that this x nomination ___ request for determination of eligibility meets the documentation standards for registering properties in the National Register of Historic Places and meets the procedural and professional requirements set forth in 36 CFR Part 60.

In my opinion, the property x meets ___ does not meet the National Register Criteria. I recommend that this property be considered significant at the following level(s) of significance:

x national ___ statewide ___ local

[Signature]
 Signature of certifying official

October 5, 2011
 Date

Deputy Director/Deputy SHPO
 Title

State or Federal agency/bureau or Tribal Government

In my opinion, the property ___ meets ___ does not meet the National Register criteria.

 Signature of commenting official

 Date

 Title

 State or Federal agency/bureau or Tribal Government

Woodlawn Plantation (Boundary Increase 2011)

Fairfax County, Virginia

4. National Park Service Certification

I, hereby, certify that this property is:

- entered in the National Register
- determined eligible for the National Register
- determined not eligible for the National Register
- removed from the National Register
- other (explain:)

Signature of the Keeper

Date of Action

5. Classification

Ownership of Property
(Check as many boxes as apply)

Category of Property
(Check only one box)

Number of Resources within Property
(Do not include previously listed resources in the count.)

- private
- public - Local
- public - State
- public - Federal

- building(s)
- district
- site
- structure
- building(s)
- object

Contributing	Noncontributing	
0	0	buildings
0	1	sites
0	0	structures
0	0	objects
0	0	buildings
0	1	Total

NOTE: Property is currently
Being transferred from the United States Government to the National Trust for Historic Preservation

Archaeological Site 44FX3256 is located within the 2.82-acre boundary increase .

Name of related multiple property listing
(Enter "N/A" if property is not part of a multiple property listing)

Number of contributing resources previously listed in the National Register
0

N/A

6. Function or Use

Historic Functions
(Enter categories from instructions)

Current Functions
(Enter categories from instructions)

AGRICULTURE/unknown

LANDSCAPE/ park (proposed)

Woodlawn Plantation (Boundary Increase 2011)

Fairfax County, Virginia

7. Description

Architectural Classification

(Enter categories from instructions)

N/A

Materials

(Enter categories from instructions) N/A

foundation: N/A

Narrative Description

(Describe the historic and current physical appearance of the property. Explain contributing and noncontributing resources if necessary. Begin with a summary paragraph that briefly describes the general characteristics of the property, such as its location, setting, size, and significant features.)

Summary Paragraph

SEE CONTINUATION SHEET 1

Narrative Description

SEE CONTINUATION SHEET 2

8. Statement of Significance

Applicable National Register Criteria

(Mark "x" in one or more boxes for the criteria qualifying the property for National Register listing)

A Property is associated with events that have made a significant contribution to the broad patterns of our history.

B Property is associated with the lives of persons significant in our past.

C Property embodies the distinctive characteristics of a type, period, or method of construction or represents the work of a master, or possesses high artistic values, or represents a significant and distinguishable entity whose components lack individual distinction.

D Property has yielded, or is likely to yield, information important in prehistory or history.

F a commemorative property.

G less than 50 years old or achieving significance within the past 50 years.

Criteria Considerations

(Mark "x" in all the boxes that apply)

Property is:

A owned by a religious institution or used for religious purposes.

B removed from its original location.

C a birthplace or grave.

D a cemetery.

E a reconstructed building, object, or structure.

Woodlawn Plantation (Boundary Increase 2011)

Fairfax County, Virginia

Areas of Significance

(Enter categories from instructions)

Conservation

Period of Significance

1800-1805

Significant Dates

1800-1805

Significant Person

(Complete only if Criterion B is marked above)

Cultural Affiliation

n/a

Architect/Builder

Thornton, Dr. William

Woodland Plantation (Boundary Increase 2011)

Fairfax County, Virginia

Period of Significance (justification)

The Period of Significance is 1800-1805 when the land was acquired and construction begun on the Woodlawn mansion.

Statement of Significance Summary Paragraph (provide a summary paragraph that includes level of significance and applicable criteria)

SEE CONTINUATION SHEET #3

Narrative Statement of Significance (provide at least one paragraph for each area of significance)

SEE CONTINUATION SHEET #4 and #5

Developmental history/additional historic context information (if appropriate)

n/a

9. Major Bibliographical References

Bibliography (Cite the books, articles, and other sources used in preparing this form on one or more continuation sheets)

Previous documentation on file (NPS):

- preliminary determination of individual listing (36 CFR 67 has been requested
- previously listed in the National Register
- previously determined eligible by the National Register
- designated a National Historic Landmark
- recorded by Historic American Buildings Survey _____

Primary location of additional data:

- State Historic Preservation Office
- Other State agency
- Federal agency
- Local government
- University
- Other

Virginia Department of Historic Resources,
Richmond, Virginia; National Trust for Historic
Preservation Archives, Washington, D.C.

recorded by Historic American Engineering Record # _____

Name of repository: _____

SEE BIBLIOGRAPHY, CONTINUATION SHEET #6

10. Geographical Data

Acreeage of Property 2.82 acres
(Do not include previously listed resource acreage)

UTM References

(Place additional UTM references on a continuation sheet)

1 18 313799 4287015
Zone Easting Northing

3 _____
Zone Easting Northing

2 _____
Zone Easting Northing

4 _____
Zone Easting Northing

Verbal Boundary Description (describe the boundaries of the property)

See Continuation Sheet #7

Boundary Justification (explain why the boundaries were selected)

See Continuation Sheet #7

11. Form Prepared By

name/title Ryan Kimberley, Environmental Protection Specialistorganization Federal Highway Administrationdate March 9, 2011street & number 21400 Ridgetop Circletelephone 703-404-6211city or town Sterlingstate VAzip code 22630e-mail Ryan.Kimberley@dot.gov

Additional Documentation

Submit the following items with the completed form:

MAP: A **USGS map** (7.5 or 15 minute series) indicating the property's location (ENCLOSED)**OTHER MAPS :**

1. **Woodlawn Plantation (Boundary Increase 2011), Fairfax County, Virginia**, Plat map depicting 2.82-acre boundary increase (Parcel 1)
2. **Woodlawn Plantation (Boundary Increase 2011), Fairfax County, Virginia**, Sketch Map Showing the Boundary of the 2.82-Acre Tract, Also Showing the Noncontributing Archaeological Site, 44FX3256.
3. **Woodlawn Plantation (Boundary Increase 2011), Fairfax County, Virginia**, The 2.82-Acre Tract Shown on a Sketch of George Washington's Mount Vernon Farm (Washington 1801). The Sketch is Overlaid onto the Fort Belvoir, Mount Vernon, and Alexandria Quadrangles. The Area of the Mount Vernon Farm Containing the 2.82 Acre Tract was Among the Property that Became Woodlawn.
4. **Woodlawn Plantation (Boundary Increase 2011), Fairfax County, Virginia**, The 2.82-Acre Tract Shown on an 1850 Plat Shortly After Woodlawn was Purchased By Individuals Belonging to the Society of Friends (Fairfax County 1850).
5. **Woodlawn Plantation (Boundary Increase 2011), Fairfax County, Virginia**, Location of 2.82-Acre Tract Shown on a 1937 Aerial Photograph.
6. **Woodlawn Plantation (Boundary Increase 2011), Fairfax County, Virginia**, Location shown on a 1953 Aerial Photograph.

PHOTOGRAPHS (SEE PHOTO LOG/CONTINUATION SHEET #8-9 and PHOTOS 1-11)**CONTINUATION SHEETS: (SEE CONTINUATION SHEETS #1-9)****Additional items:** (Check with the SHPO or FPO for any additional items)

**United States Department of the Interior
National Park Service**

National Register of Historic Places Continuation Sheet

Woodlawn Plantation (Boundary Increase 2011)

Fairfax County, Virginia

Section 7, Continuation Sheet #1

Narrative Description, Summary Paragraph

The United States Government (Fort Belvoir) is transferring ownership of a 2.82-acre tract southwest of the National Register boundary to the National Trust for Historic Preservation. The 2.82-acre boundary increase, which was originally part of the Woodlawn property, is bounded on the south by U.S. Route 1, on the east by the National Register boundary, on the north by Fort Belvoir, and on the west by the adjacent Woodlawn Quaker Meetinghouse (VDHR # 029-0172) property.

The 2.82-acre tract is currently a lawn with some young trees, shrubbery, and utility poles. A sidewalk parallels the eastern side of Woodlawn Road (State Route 618). The sidewalk does not extend to U.S. Route 1, but does continue north onto Fort Belvoir. A line of trees serves as a visible boundary marker separating the tract from Woodlawn. The tract has been graded and no structures are currently located on the tract. The tract has been disturbed by multiple utility lines.

Detailed Narrative Description

The 2.82-acre parcel was part of the original two-thousand-acre parcel of land that George Washington presented to his ward, Eleanor Parke Custis, granddaughter of Martha Washington, following her marriage in 1799 to his nephew Major Lawrence Lewis. The mansion, constructed between 1800-1805, stands on a hill to the east overlooking Dogue Creek, a site noted by Washington himself for its view of Mount Vernon and the Potomac.¹

In 1846, the original two-thousand-acre parcel was purchased by members of the Society of Friends (Quakers) for use as a timber farm and "free labor colony" to demonstrate to Southern neighbors that a successful agricultural enterprise could be run without the use of enslaved labor. In 1850, one of the Quakers donated land for a meetinghouse on the property, and a structure was built in 1851. The 2.82-acre boundary increase remained connected to Woodlawn until John and Rachel Mason sold it to Joseph M. Wood in 1869. This parcel later became part of the Grand View (VDHR # 029-0062) property. The 2.82-acre boundary increase returned to Woodlawn in 1905, when the owner of Woodlawn, Elizabeth Sharpe, bought Grand View from Ann W. and Jacob M. Troth and others. In 1919, Elizabeth Sharpe sold the 2.82-acre boundary increase to the United States Government, and it became a part of Camp Humphreys (now Fort Belvoir). From 1861-1864 of the Civil War, the Woodlawn Quaker Meetinghouse and adjacent land was heavily used by the Union Army as a camp. The 2.82-acre tract not only reconnects Woodlawn to the Meetinghouse property, but supports interpretation of the Civil War component of the site.

**United States Department of the Interior
National Park Service**

National Register of Historic Places Continuation Sheet

Woodlawn Plantation (Boundary Increase 2011)

Fairfax County, Virginia

Section 7, Continuation Sheet #2

44FX3256 (Noncontributing Site)

The tract has been the focus of an archaeological survey.² Though no structures are currently located on the tract, a previous archaeological study indicates that a structure had probably been situated there. The location (44FX3256) was defined from two positive shovel tests in the area between Woodlawn Road and the existing Woodlawn property line. Artifacts obtained from the site included a small fragment of olive glass, two brick fragments, and four wrought nail fragments, one of which retained its rose head. This small collection of material appears contemporary with the construction of the Woodlawn mansion and may have represented a farm structure or other associated outbuilding. Disturbances caused by multiple utility lines make it difficult to determine any information other than the location of this structure. This archaeological site is noncontributing due to a loss of integrity.

United States Department of the Interior
National Park Service

National Register of Historic Places Continuation Sheet

Woodlawn Plantation (Boundary Increase 2011)

Fairfax County, Virginia

Section 8, Continuation Sheet #3

Narrative Statement of Significance Summary Paragraph (provide a summary paragraph that includes level of significance and applicable criteria)

The 2.82-acre boundary increase was originally part of the land given by George Washington to Eleanor Parke Custis and Major Lawrence Lewis in 1799. The Woodlawn property, including the 2.82-acre boundary increase, was acquired by the Quakers in 1846 for use as a "Free Labor Colony" and played an important symbolic and physical role in linking the mansion, as the center of the property, to the Woodlawn Quaker Meetinghouse. It was the site of Union Army encampment between 1861-1864, and, as such, is the only documented location on Woodlawn property where a Civil War camp existed. The 2.82-acre boundary increase was acquired by the United States Government for Camp Humphreys in 1919. The National Trust for Historic Preservation obtained ownership of the 2.82-acre boundary increase in 2011. Woodlawn was placed on the Virginia Landmarks Register in 1969, the National Register of Historic Places in 1970, and was recognized as a National Historic Landmark in 1998.

The 2.82-acre boundary increase will help reunite the historic core of Woodlawn with the adjacent Woodlawn Quaker Meetinghouse property and help reestablish the physical and historical link of Woodlawn to the surrounding community that, even today, bears its name.

Narrative Statement of Significance, Historical Background (provide at least **one** paragraph for each area of significance)

George Washington presented approximately 2,000 acres of the Mount Vernon estate to his ward Eleanor Parke Custis, granddaughter of Martha Washington, following her marriage in 1799 to his nephew Major Lawrence Lewis, son of Fielding and Betty (Washington) Lewis of Kenmore. The gift included a mill and a distillery. Washington's friend, Dr. William Thornton, designed the mansion, which was erected between 1800-1805. The Lewis family maintained the property until the 1840s, when it was sold to a group of Quakers from New Jersey and Philadelphia.³ A map of George Washington's Mount Vernon estate, as it appeared in 1801, shows the tract that became part of Woodlawn (see Map 3).⁴

The Society of Friends purchased Woodlawn, in part, to establish an abolitionist community.⁵ Hardwood timber was in great demand for shipbuilding during the antebellum period, and the Society of Friends sent out timber scouts in 1845 to find hardwood forests and land for a community which would demonstrate as false the argument that slave labor was necessary for the operation of a successful plantation in the South. The scouts found that both criteria were met at the then abandoned Woodlawn. Part of their report read:

We were pleased with a part of the Mt. Vernon property belonging to Lorenzo Lewis, a grand nephew of G. Washington, in Fairfax Co., Va., 14 miles from Washington and seven from Alexandria, containing [approximately] 2000 acres of beautiful valley land and a large mansion built of brick and completely furnished, and including 1000 acres of timber, mostly oak, and for which they asked 12 ½ dollars an acre

6
....

**United States Department of the Interior
National Park Service**

National Register of Historic Places Continuation Sheet

Woodlawn Plantation (Boundary Increase 2011)

Fairfax County, Virginia

Section 8, Continuation Sheet #4

Narrative Statement of Significance, Historical Background (Continued)

Lorenzo Lewis, then living near Winchester, entered into an agreement with Joseph and Chalkley Gillingham to sell Woodlawn. Lewis passed away before a deed could be written. On August 6, 1848 a deed was recorded from Laurence B. Taylor, Commissioner, and Esther Maria Lewis to Jacob Troth, Chalkley Gillingham, Lucas Gillingham, and Paul Hillman Troth, conveying 1,959 acres. The Friends surveyed the land and, once sections were cleared by timbering, began dividing it into farms that were sold and worked without slave labor. After congregating in various places, the Quakers constructed their meetinghouse (VDHR# 029-0172) in 1851⁷ on a tract of land adjacent to the 2.82-acre boundary increase parcel.

A plat of Woodlawn attached to an 1848 deed (the plat is dated 1850) shows the extent of the property at that time.⁸ The plat encompasses 1,959 acres, including the 2.82-acre tract that is the subject of the proposed boundary expansion. Soon after this deed was entered, the Friends began selling land, and the Woodlawn property was subdivided into smaller lots, and the tract upon which the Woodlawn mansion was located was reduced considerably.⁹

Woodlawn evolved under the Friends' ownership into a community that included a number of families, including the Masons, Baptists who owned the mansion, as well as other white and free black farmers. While a series of independent freeholds existed in law, in practice the families of Woodlawn regarded themselves as a community, and established institutions (including the Baptist church, Methodist church, and an elementary school) that retained the name and identification with Woodlawn. The sense of collective identity remained until the early 20th century, at which time the United States Government began acquiring property for the development of Camp Humphreys (now Fort Belvoir) during and after the First World War. Land was acquired, families were dispersed, and the century-old social and geographical community disappeared by the end of World War II. The United States Army constructed an access road through the tract that remained in use until shortly after September 11, 2001, when the road was closed for security reasons.

Currently the land is being transferred from the United States Government to the National Trust For Historic Preservation. The National Trust for Historic Preservation is in the process of relocating the entrance to Woodlawn through the 2.82-acre boundary increase. The land transfer and driveway realignment were needed to accommodate the widening of Old Mill Road as part of the Rt. 1/ Telegraph Road connector project. The existing original entrance will not be geometrically suitable for vehicular traffic but will be converted to a pedestrian trail. The 2.82-acre boundary increase will help reunite the historic core of Woodlawn with the adjacent Quaker Meetinghouse property and help reestablish the physical and historical link of Woodlawn to the surrounding community that, even today, bears its name.

United States Department of the Interior
National Park Service

National Register of Historic Places Continuation Sheet

Woodlawn Plantation (Boundary Increase 2011)

Fairfax County, Virginia

Section 8, Continuation Sheet #5

ENDNOTES

- ¹ Virginia Historic Landmarks Commission, National Register of Historic Places Nomination Form for Woodlawn Plantation, Virginia Department of Historic Resources, Richmond, 1969.
- ² Loretta Lautzenheiser and Bill Hall, Phase 1 Archaeological Survey Old Mill Road Connector and Proposed Property Transfer of Fort Belvoir Land Between Woodlawn Friends Meetinghouse and Woodlawn Plantation, Fairfax County, Virginia (On file, Coastal Carolina Research, Tarboro, North Carolina, 2007).
- ³ Virginia Historic Landmarks Commission
- ⁴ George Washington, of *A Map of General Washington's Farm of Mount Vernon From a Drawing Transmitted by the General* (Image Electronic document, <http://hdl.loc.gov/loc.gmd/g3882m.ct000367>, Accessed December 14, 2009., 1801).
- ⁵ Horace D. Buckman, "The Quakers Came to Woodlawn" in *Historical Society of Fairfax County, Virginia, Inc.* (9:65-67, 1966), and Patricia Hickin, "Fairfax County: 1840-1870 in *Fairfax County, Virginia: A History*, edited by N. Netherton, pp. 251-391. 250th Anniversary Commemorative Edition. Fairfax County Board of Supervisors, Fairfax, Virginia, 1992, Originally published 1978.
- ⁶ Buckman, 65.
- ⁷ Ibid.
- ⁸ FC 1848 DB O-3: 395.
- ⁹ Dorothy Troth Muir, *Potomac Interlude: The Story of Woodlawn Mansion and the Mount Vernon Neighborhood 1846-1943* (Mount Vernon Print Shop, Washington, D.C., 1943).

United States Department of the Interior
National Park Service

National Register of Historic Places Continuation Sheet

Woodlawn Plantation (Boundary Increase 2011)

Fairfax County, Virginia

Section 9, Continuation Sheet #6

Major Bibliographical References

Buckman, Horace D.

1966 "The Quakers Come to Woodlawn." *Historical Society of Fairfax County, Virginia, Inc.* 9:65-67.

Fairfax County

1850 Plat of Woodlawn. Deed Book 0-3:396-A. On file, Virginia Room, City of Fairfax Regional Library, Fairfax.

Fairfax County

1921 Plat Showing Woodlawn. Deed Book W-8: 188. On file, Virginia Room, City of Fairfax Regional Library, Fairfax.

Geddes, Jean

1967 *Fairfax County Historical Highlights From 1607*. Denlinger's, Middleburg, Virginia.

Hickin, Patricia

1992 Fairfax County: 1840-1870. In *Fairfax County, Virginia: A History*, edited by N. Netherton, pp. 251-391. Originally published 1978. 250th Anniversary Commemorative Edition. Fairfax County Board of Supervisors, Fairfax, Virginia.

Lautzenheiser, Loretta and Bill Hall

2007 *Phase 1 Archaeological Survey Old Mill Road Connector and Proposed Property Transfer of Fort Belvoir Land Between Woodlawn Friends Meetinghouse and Woodlawn Plantation, Fairfax County, Virginia*. On file, Coastal Carolina Research, Tarboro, North Carolina.

Muir, Dorothy Troth

1943 *Potomac Interlude: The Story of Woodlawn Mansion and the Mount Vernon Neighborhood 1846-1943*. Mount Vernon Print Shop, Washington, D.C.

Templeman, Eleanor Lee and Nan Netherton

1966 *Northern Virginia Heritage*. Privately printed.

Virginia Historic Landmarks Commission

1969 "National Register of Historic Places Nomination Form for Woodlawn Plantation." Manuscript on file, Virginia Department of Historic Resources, Richmond.

Washington, George

1801 Image of A Map of General Washington's Farm of Mount Vernon From a Drawing Transmitted by the General. Electronic document, <http://hdl.loc.gov/loc.gmd/g3882m.ct000367>, Accessed December 14, 2009.

Woodlawn Plantation, pamphlet of the National Trust for Historic Preservation.

Woodlawn Plantation, American Landmarks ~ Illustrated Program Series, available from the National Trust for Historic Preservation.

**United States Department of the Interior
National Park Service**

National Register of Historic Places Continuation Sheet

Woodlawn Plantation (Boundary Increase 2011)

Fairfax County, Virginia

Section 10 **Continuation Sheet #7**

Verbal Boundary Description (describe the boundaries of the property)

The 2.82-acre boundary increase is currently under the process of being transferred from the United States Government (Fort Belvoir) to the National Trust for Historic Preservation. A plat depicting the proposed parcel is included with this nomination (see MAP 1). The tract is currently part of Fort Belvoir and, therefore, has no individual tax parcel information. The tract is generally bounded on the south by the U.S. Route 1 (Richmond Highway) right-of-way, the east by the Woodlawn National Register boundary, on the north by Lampert Road, and on the west by the Woodlawn Quaker Meetinghouse (See Maps 1 and 2) .

Boundary Justification (explain why the boundaries were selected)

The 2.82-acre boundary increase tract was originally part of Woodlawn. The property is located adjacent to the current National Trust for Historic Preservation-owned Woodlawn boundary. The ownership of the 2.82-acre boundary increase is currently being transferred from the United States Government (Fort Belvoir) to the National Trust for Historic Preservation. The proposed increase is a rejoining under common ownership of part of the original Woodlawn tract (See Maps 1, 2 and 3).

**United States Department of the Interior
National Park Service**

National Register of Historic Places Continuation Sheet

Woodlawn Plantation (Boundary Increase 2011)

Fairfax County, Virginia

Section: PHOTOGRAPHS Continuation Sheet #8

Photographs:

All photographs common to:

Name of Property: Woodlawn Plantation (Boundary Increase 2011)
City or Vicinity: N/A
County: Fairfax County **State:** VA
Photographer: Billy Hall
Date Photographed: December 10, 2009
Images Stored: Virginia Department of Historic Resources, Richmond, Virginia

Description of Photograph(s) and number:

1 of 10	Exchange Tract Looking Towards Meeting House, SW VA_FairfaxCounty_WoodlawnPlantation(BoundaryIncrease2011)_0001.tif
2 of 10	Exchange Tract Looking Towards U.S. Route 1, S VA_FairfaxCounty_WoodlawnPlantation(BoundaryIncrease2011)_0002.tif
3 of 10	Exchange Tract Looking Towards U.S. Route 1, SE VA_FairfaxCounty_WoodlawnPlantation(BoundaryIncrease2011)_0003.tif
4 of 10	Woodlawn Plantation Main House VA_FairfaxCounty_WoodlawnPlantation(BoundaryIncrease2011)_0004.tif
5 of 10	Exchange Tract from Lampert Rd., E VA_FairfaxCounty_WoodlawnPlantation(BoundaryIncrease2011)_0005.tif
6 of 10	Exchange Tract from U.S. Route 1, N VA_FairfaxCounty_WoodlawnPlantation(BoundaryIncrease2011)_0006.tif
7 of 10	Exchange Tract US 1, NW VA_FairfaxCounty_WoodlawnPlantation(BoundaryIncrease2011)_0007.tif
8 of 10	Exchange Tract from US 1, NW VA_FairfaxCounty_WoodlawnPlantation(BoundaryIncrease2011)_0008.tif
9 of 10	Exchange Tract from Baptist Church, NW VA_FairfaxCounty_WoodlawnPlantation(BoundaryIncrease2011)_0009.tif
10 of 10	Exchange Tract from South Side of US 1, NE VA_FairfaxCounty_WoodlawnPlantation(BoundaryIncrease2011)_0010.tif

FORT BELVOIR QUADRANGLE
 VIRGINIA - MARYLAND
 7.5 MINUTE SERIES (TOPOGRAPHIC - BATHYMETRIC)
 NW/4 INDIAN HEAD 15' QUADRANGLE

5561
 (ALEXANDRIA)

LINE 13 MI.
 TO INTERSTATE 495

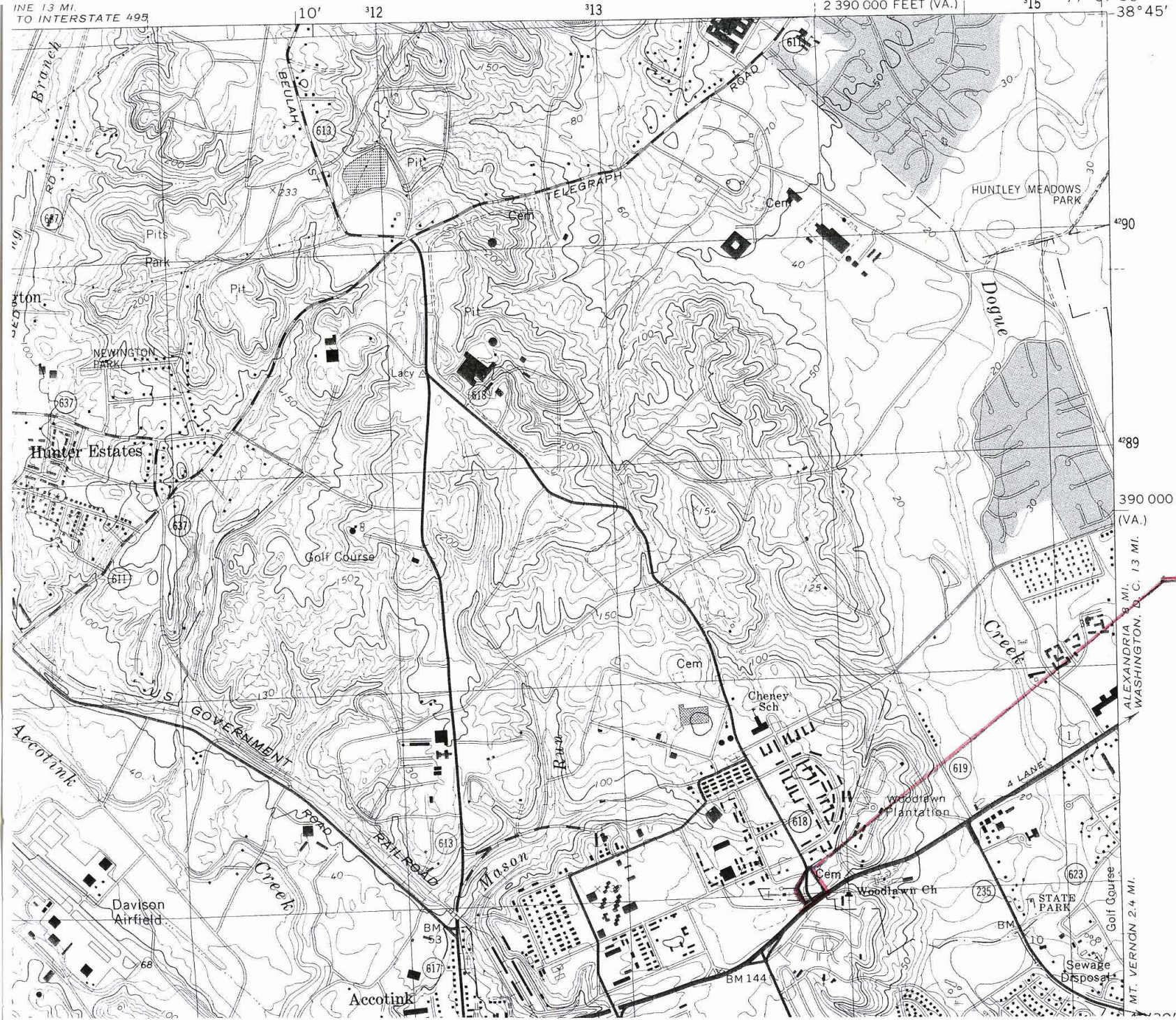

ALEXANDRIA 3 MI.
 WASHINGTON, D.C. 13 MI.
 MT. VERNON 2.4 MI.

Woodlawn PLANTATION
 (BOUNDARY INCREASE 201)
 Fairfax County, VA
 DHR FILE NO.: 629-0056
 UTM Reference =
 18/313799(E)/4287015(N)
 QUAD: FT. BELVOIR, VA-MD
 NAD: 1927

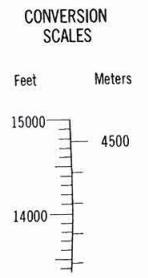

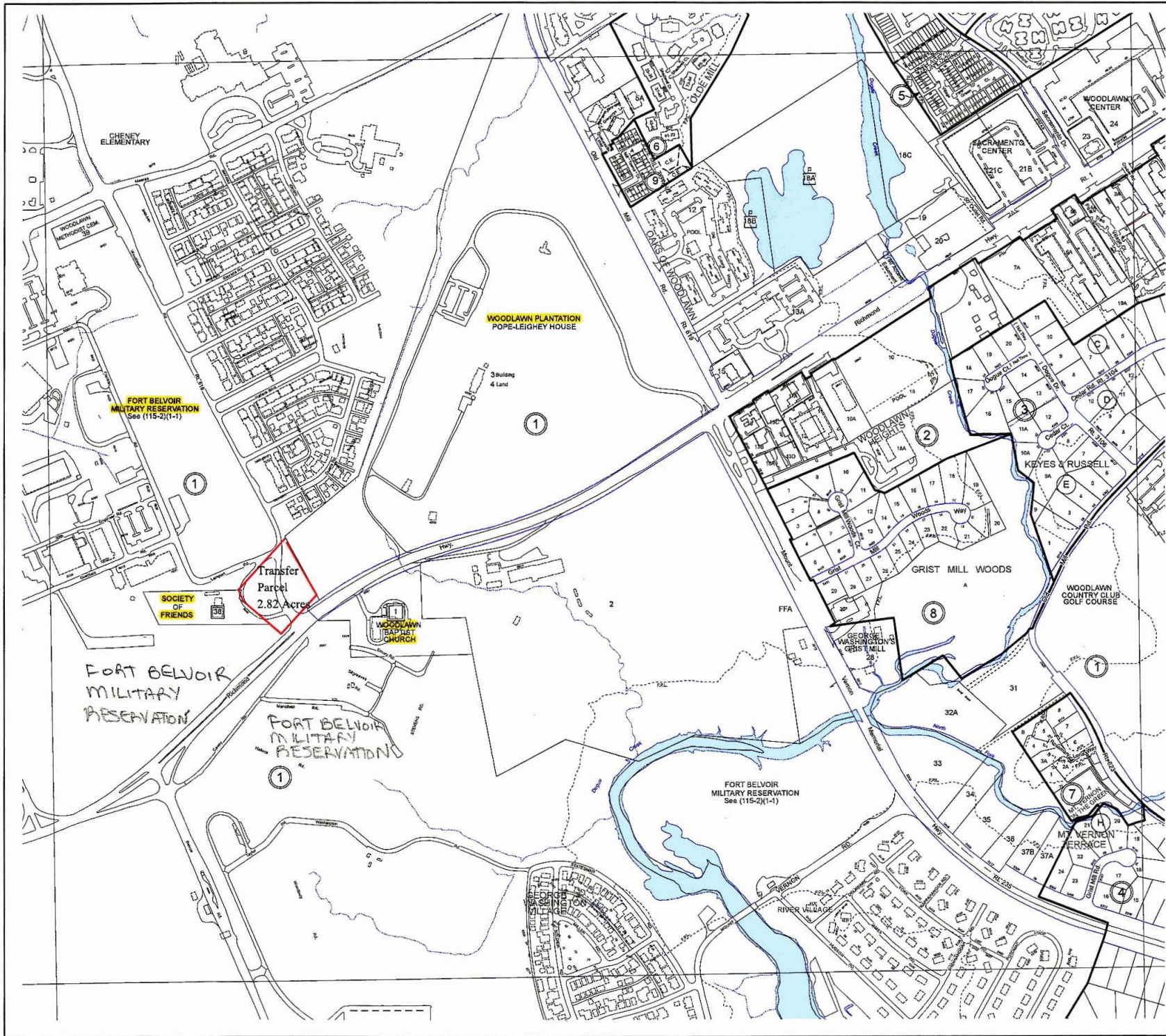

A Fairfax County, Virginia Publication



Map Scale is 1" = 577' based on 1983 USGS datum.
 7.15 meters Grid, Virginia Coordinate System.
 Vertical datum of 1983 North Zone as U.S. datum and
 NAD 83 (1) State Plane Zone 18N (North adjustment)
 National Geodetic Vertical Datum 1929

GENERAL NOTES

MAJOR CLAY DEPOSITS
 The location of the Major Clay Deposits shown on this map are general and not to be used.

The information contained on this map is for informational purposes only and does not constitute a warranty or representation of any kind. The County is not responsible for any errors or omissions on this map. The County is not responsible for any damages, including but not limited to, loss of data, and other losses, arising from the use of this map. The County is not responsible for any damages, including but not limited to, loss of data, and other losses, arising from the use of this map.

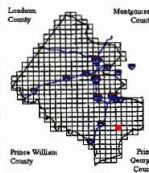

ADMINISTRATIVE INDEX

100-3	100-4	101-3
109-1		110-1
109-3	109-4	110-3

SHEET INDEX

CADASTRAL MAP

109-2

Revised to: 01-01-2011

Prepared by:
 DEPARTMENT OF INFORMATION TECHNOLOGY
 Geographic Services Division
 GIS and Mapping Services
 12300 Government Center Parkway, Suite 1117
 Fairfax, Virginia 22035-0610
 (703) 374-3215
 FAX (703) 324-9337

WOODLAWN PLANTATION (BOUNDARY INCREASE PLAN)
 FAIRFAX CO., VIRGINIA
 VDH&F FILE NO: 07-0052