

**NATIONAL REGISTER OF HISTORIC PLACES
INVENTORY - NOMINATION FORM**

(Type all entries - complete applicable sections)

STATE: Virginia	
COUNTY: Goochland	
FOR NPS USE ONLY	
ENTRY NUMBER 68-11-45-0001	DATE 11/22/68

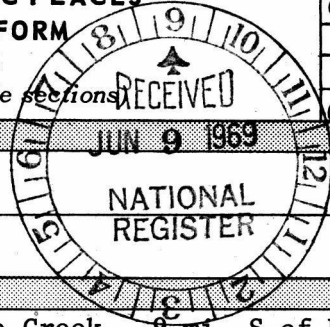

1. NAME

COMMON:
Tuckahoe

AND/OR HISTORIC:
Tuckahoe

2. LOCATION

STREET AND NUMBER: .3 mi. N of Tuckahoe Creek, .9 mi. S of Rt. 650, .6 mi. E of intersection of Rt. 650 and Rt. 647.

CITY OR TOWN:

STATE: Virginia CODE: 45 COUNTY: Goochland CODE: 075

3. CLASSIFICATION

CATEGORY (Check One)	OWNERSHIP		STATUS	ACCESSIBLE TO THE PUBLIC
District <input type="checkbox"/> Building <input checked="" type="checkbox"/>	Public <input type="checkbox"/>	Public Acquisition: <input type="checkbox"/>	Occupied <input checked="" type="checkbox"/>	Yes: <input type="checkbox"/>
Site <input type="checkbox"/> Structure <input type="checkbox"/>	Private <input checked="" type="checkbox"/>	In Process <input type="checkbox"/>	Unoccupied <input type="checkbox"/>	Restricted <input type="checkbox"/>
Object <input type="checkbox"/>	Both <input type="checkbox"/>	Being Considered <input type="checkbox"/>	Preservation work in progress <input type="checkbox"/>	Unrestricted <input type="checkbox"/>
PRESENT USE (Check One or More as Appropriate)				
Agricultural <input type="checkbox"/>	Government <input type="checkbox"/>	Park <input type="checkbox"/>	Transportation <input type="checkbox"/>	Comments <input type="checkbox"/>
Commercial <input type="checkbox"/>	Industrial <input type="checkbox"/>	Private Residence <input checked="" type="checkbox"/>	Other (Specify) <input type="checkbox"/>	
Educational <input type="checkbox"/>	Military <input type="checkbox"/>	Religious <input type="checkbox"/>		
Entertainment <input type="checkbox"/>	Museum <input type="checkbox"/>	Scientific <input type="checkbox"/>		

4. OWNER OF PROPERTY

OWNERS NAME:
Mrs. W. Taliaferro Thompson, Jr. (Jessie Gresham Baker)

STREET AND NUMBER:
4602 Sulgrave Road

CITY OR TOWN: Richmond STATE: Virginia CODE: 45

5. LOCATION OF LEGAL DESCRIPTION

COURTHOUSE, REGISTRY OF DEEDS, ETC.:
Goochland County Court House

STREET AND NUMBER:

CITY OR TOWN: Goochland STATE: Virginia CODE: 45

APPROXIMATE ACREAGE OF NOMINATED PROPERTY: 561.97 acres

6. REPRESENTATION IN EXISTING SURVEYS

TITLE OF SURVEY:
Historic American Buildings Survey Inventory

DATE OF SURVEY: 1958 Federal State County Local

DEPOSITORY FOR SURVEY RECORDS:
Library of Congress

STREET AND NUMBER:

CITY OR TOWN: Washington STATE: District of Columbia CODE: 08

SEE INSTRUCTIONS

STATE: Virginia
COUNTY: Goochland
ENTRY NUMBER: 68-11-45-0001
DATE: 11/25/68
FOR NPS USE ONLY

7. DESCRIPTION

CONDITION	(Check One)					
	Excellent <input type="checkbox"/>	Good <input checked="" type="checkbox"/>	Fair <input type="checkbox"/>	Deteriorated <input type="checkbox"/>	Ruins <input type="checkbox"/>	Unexposed <input type="checkbox"/>
INTEGRITY	(Check One)			(Check One)		
	Altered <input type="checkbox"/>	Unaltered <input checked="" type="checkbox"/>		Moved <input type="checkbox"/>	Original Site <input checked="" type="checkbox"/>	

DESCRIBE THE PRESENT AND ORIGINAL (if known) PHYSICAL APPEARANCE

Tuckahoe is a two-story frame structure, covered with weatherboarding except for the brick ends of the south wing. These features, along with the glazed headers in Flemish bond, the use of a water table, and the variety of end chimneys, suggest that Tuckahoe was not only built in the early-eighteenth century but that it was, indeed, built over a period of time. Although most of the mantels have been replaced by others, circa 1800, the original paneling remains. Within the framework of this single building, we find more than its share of important early-eighteenth century features, making the structure a veritable house museum to which historians can look for definite illustrative examples. Tuckahoe's importance is heightened by the existence of original outbuildings; more particularly the school house to the east and a row of structures on the west, including the kitchen and the slave quarters.

SEE INSTRUCTIONS

**NATIONAL REGISTER OF HISTORIC PLACES
INVENTORY - NOMINATION FORM**

(Continuation Sheet)

STATE Virginia	
COUNTY Goochland	
FOR NPS USE ONLY	
ENTRY NUMBER	DATE
68-11-45-0001	11/22/68

(Number all entries)

6. Virginia Historic Landmarks Commission Report #37-33
1968 State
Virginia Historic Landmarks Commission
Room 1116, Ninth Street State Office Building
Richmond, Virginia 23219

Code: 45



8. SIGNIFICANCE

PERIOD (Check One or More as Appropriate)

Pre-Columbian 16th Century 18th Century 20th Century
 15th Century 17th Century 19th Century

SPECIFIC DATE(S) (If Applicable and Known)

AREAS OF SIGNIFICANCE (Check One or More as Appropriate)

Aboriginal <input type="checkbox"/>	Education <input type="checkbox"/>	Political <input type="checkbox"/>	Urban Planning <input type="checkbox"/>
Prehistoric <input type="checkbox"/>	Engineering <input type="checkbox"/>	Religion/Philosophy <input type="checkbox"/>	Other (Specify) <input checked="" type="checkbox"/>
Historic <input type="checkbox"/>	Industry <input type="checkbox"/>	Science <input type="checkbox"/>	<u>History</u>
Agriculture <input type="checkbox"/>	Invention <input type="checkbox"/>	Sculpture <input type="checkbox"/>	_____
Art <input checked="" type="checkbox"/>	Landscape <input type="checkbox"/>	Social/Humanitarian <input type="checkbox"/>	_____
Commerce <input type="checkbox"/>	Architecture <input type="checkbox"/>	Theater <input type="checkbox"/>	_____
Communications <input type="checkbox"/>	Literature <input type="checkbox"/>	Transportation <input type="checkbox"/>	_____
Conservation <input type="checkbox"/>	Military <input type="checkbox"/>		_____
	Music <input type="checkbox"/>		_____

STATEMENT OF SIGNIFICANCE (Include Personages, Dates, Events, Etc.)

Tuckahoe serves as a valuable source of early-eighteenth century architectural design. With its complex of plantation dependencies and with its interior decoration and arrangement, it serves as an excellent example of the Virginia house and plantation of the eighteenth century. It also served as the seat of one of the cadet branches of the Randolph family of Turkey Island and as one of the early homes of Thomas Jefferson, third President of the United States.

The property on which Tuckahoe stands was originally owned by William Randolph (1651-1711) of Turkey Island who left part of the land to his son Thomas. Thomas Randolph (1683-1730) enlarged his share in 1714 by purchasing an adjoining tract from his brother. Some time in the first quarter of the century Thomas Randolph began construction of the present house. At his death in 1730 Thomas left the plantation to his son William, who, in turn, at his death in 1745, left the property to his son, Thomas Mann Randolph (1741-1793). During the infancy of Thomas Mann Randolph, Peter Jefferson, the father of the future President, served as guardian and lived with his family at Tuckahoe. With the death of Thomas Mann Randolph in 1793, Tuckahoe came into the possession of his son, another Thomas Mann Randolph (1791-circa 1850), who held the property until 1830 when it was sold. Tuckahoe subsequently descended through the Wight, Allen and Coolidge families until it was purchased in 1935 by John Hopkins Baker and Jessie Gresham Baker, with their mother, Isabelle Ball Baker having a life estate.

SEE INSTRUCTIONS



9. MAJOR BIBLIOGRAPHICAL REFERENCES

Anderson, Jefferson Randolph, "Tuckahoe and the Tuckahoe Randolphs", Virginia Magazine of History and Biography, Vol. 45, 1937.
 Malone, Dumas, Jefferson the Virginian, Boston: 1948.
 Randolph, Wassell, William Randolph, I, of Turkey Island, Memphis: 1949.
 Waterman, Thomas Tileston, The Mansions of Virginia, 1706-1776, New York: Bonanza Books, 1945.

18/265680/416/200
 JTM Ref
 10-30-75

10. GEOGRAPHICAL DATA

LATITUDE AND LONGITUDE COORDINATES DEFINING A RECTANGLE LOCATING THE PROPERTY			O R	LATITUDE AND LONGITUDE COORDINATES DEFINING THE CENTER POINT OF A PROPERTY OF LESS THAN ONE ACRE		
CORNER	LATITUDE	LONGITUDE		LATITUDE	LONGITUDE	
	Degrees Minutes Seconds	Degrees Minutes Seconds		Degrees Minutes Seconds	Degrees Minutes Seconds	
NW	° ' "	° ' "		37 ° 34 ' 12 "	77 ° 39 ' 10 "	
NE	° ' "	° ' "				
SE	° ' "	° ' "				
SW	° ' "	° ' "				

LIST ALL STATES AND COUNTIES FOR PROPERTIES OVERLAPPING STATE OR COUNTY BOUNDARIES

STATE:	CODE	COUNTY	CODE
STATE:	CODE	COUNTY:	CODE
STATE:	CODE	COUNTY:	CODE
STATE:	CODE	COUNTY:	CODE

11. FORM PREPARED BY

NAME AND TITLE:
 Staff, Virginia Historic Landmarks Commission, James W. Moody, Jr., Director

ORGANIZATION: Virginia Historic Landmarks Commission DATE: April 25, 1969

STREET AND NUMBER:
Room 1116, Ninth Street State Office Building

CITY OR TOWN: Richmond STATE: Virginia CODE: 45

SEE INSTRUCTIONS

12. STATE LIAISON OFFICER CERTIFICATION

NATIONAL REGISTER VERIFICATION

As the designated State Liaison Officer for the National Historic Preservation Act of 1966 (Public Law 89-665), I hereby nominate this property for inclusion in the National Register and certify that it has been evaluated according to the criteria and procedures set forth by the National Park Service. The recommended level of significance of this nomination is:

National State Local

Name Edw. P. Alexander per John
 Title Dr. Edward P. Alexander, Chairman
Virginia Historic Landmarks Comm
 Date June 2, 1969

I hereby certify that this property is included in the National Register.

Ernest Allen Connelly
 Chief, Office of Archeology and Historic Preservation

Date NOV 22 1968

ATTEST:
William J. Mustagh
 Keeper of The National Register
 Date NOV 22 1968

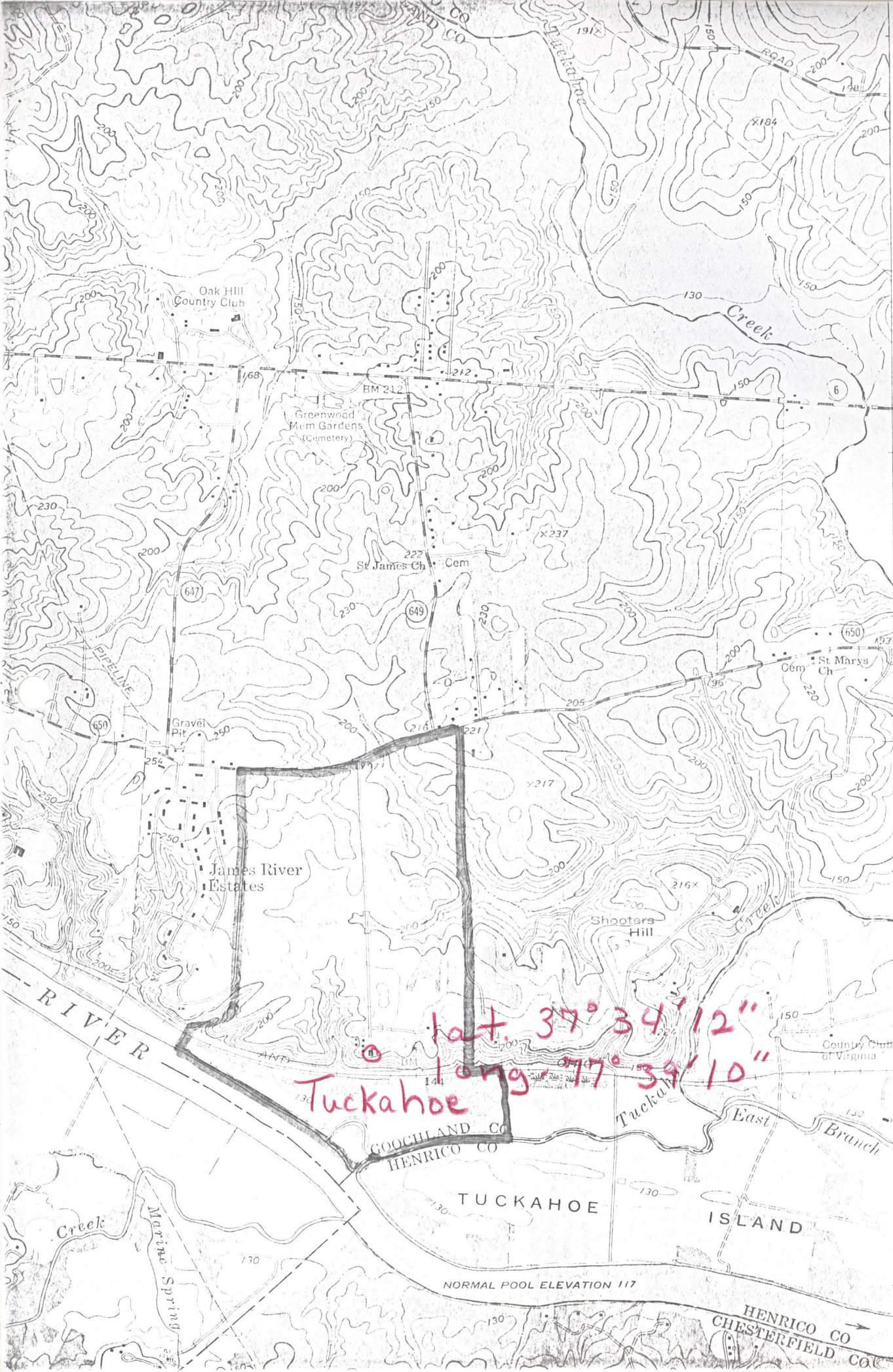

4166
1.5 MI. TO VA 157
RICHMOND (U.S. 250) 9 MI.
4164
4163
357
4162
4161
4160
(CON. AIR) 5:45-11:55

Tuckahoe
(37-33)

Lat. $37^{\circ} 34' 12''$
Long. $77^{\circ} 39' 10''$
Tuckahoe

GOOCHLAND CO
HENRICO CO
TUCKAHOE
ISLAND
HENRICO CO
CHESTERFIELD CO

**NATIONAL REGISTER OF HISTORIC PLACES
PROPERTY MAP FORM**

(Type all entries - attach to or enclose with map)

STATE Virginia	
COUNTY Goochland	
FOR NPS USE ONLY	
ENTRY NUMBER 68-11-45-0001	DATE 11/22/68

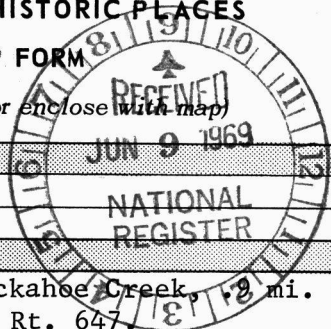

SEE INSTRUCTIONS

1. NAME

COMMON: **Tuckahoe**
AND/OR HISTORIC: **Tuckahoe**

2. LOCATION

STREET AND NUMBER: **.3 mi. N of Tuckahoe Creek, .2 mi. S of Rt. 650, .6 mi. E of intersection of Rt. 650 and Rt. 647.**
CITY OR TOWN:

STATE: Virginia	CODE 45	COUNTY: Goochland	CODE 075
---------------------------	-------------------	-----------------------------	--------------------

3. MAP REFERENCE

SOURCE:
U.S.G.S. 7½', quadrangle Midlothian, Va.
SCALE: **1:24000**
DATE: **1964**

4. REQUIREMENTS

- TO BE INCLUDED ON ALL MAPS
1. Property boundaries where required.
 2. North arrow.
 3. Latitude and longitude reference.