

✓LR-2/10/73 NRHP-11/27/73

NATIONAL REGISTER OF HISTORIC PLACES  
INVENTORY - NOMINATION FORM

(Type all entries - complete applicable sections)

STATE: Virginia	
COUNTY: Middlesex	
FOR NPS USE ONLY	
ENTRY NUMBER	DATE

1. NAME

COMMON:  
Rosegill

AND/OR HISTORIC:

2. LOCATION

STREET AND NUMBER: 1.7 miles North West of northern end of Route 639,  
8 miles North of intersection with Route 33.

CITY OR TOWN:  
Urbanna vicinity

STATE Virginia	CODE 51	COUNTY: Middlesex	CODE 119
-------------------	------------	----------------------	-------------

3. CLASSIFICATION

CATEGORY (Check One)	OWNERSHIP	STATUS	ACCESSIBLE TO THE PUBLIC
<input type="checkbox"/> District <input type="checkbox"/> Site <input type="checkbox"/> Object <input checked="" type="checkbox"/> Buildings <input type="checkbox"/> Structure	<input type="checkbox"/> Public <input checked="" type="checkbox"/> Private <input type="checkbox"/> Both	<input checked="" type="checkbox"/> Occupied <input type="checkbox"/> Unoccupied <input type="checkbox"/> Preservation work in progress	Yes: <input type="checkbox"/> Restricted <input type="checkbox"/> Unrestricted <input checked="" type="checkbox"/> No
PRESENT USE (Check One or More as Appropriate)			
<input type="checkbox"/> Agricultural <input type="checkbox"/> Commercial <input type="checkbox"/> Educational <input type="checkbox"/> Entertainment	<input type="checkbox"/> Government <input type="checkbox"/> Industrial <input type="checkbox"/> Military <input type="checkbox"/> Museum	<input type="checkbox"/> Park <input checked="" type="checkbox"/> Private Residence <input type="checkbox"/> Religious <input type="checkbox"/> Scientific	<input type="checkbox"/> Transportation <input type="checkbox"/> Other (Specify) _____ _____

4. OWNER OF PROPERTY

OWNER'S NAME:  
Mrs. Sidney L. Shannon

STREET AND NUMBER:  
Rosegill

CITY OR TOWN:  
Urbanna

STATE: Virginia	CODE 51
--------------------	------------

5. LOCATION OF LEGAL DESCRIPTION

COURTHOUSE, REGISTRY OF DEEDS, ETC.:  
Middlesex County Court House

STREET AND NUMBER:

CITY OR TOWN:  
Saluda

STATE: Virginia	CODE 51
--------------------	------------

6. REPRESENTATION IN EXISTING SURVEYS

TITLE OF SURVEY:  
Historic American Buildings Survey Inventory

DATE OF SURVEY: 1959  Federal  State  County  Local

DEPOSITORY FOR SURVEY RECORDS:  
Library of Congress

STREET AND NUMBER:

CITY OR TOWN:  
Washington

STATE: D.C.	CODE 11
----------------	------------

SEE INSTRUCTIONS

STATE: Virginia	COUNTY: Middlesex	ENTRY NUMBER	DATE
--------------------	----------------------	--------------	------

FOR NPS USE ONLY

7 DESCRIPTION

CONDITION	(Check One)					
	<input checked="" type="checkbox"/> Excellent	<input type="checkbox"/> Good	<input type="checkbox"/> Fair	<input type="checkbox"/> Deteriorated	<input type="checkbox"/> Ruins	<input type="checkbox"/> Unexposed
	(Check One)			(Check One)		
	<input checked="" type="checkbox"/> Altered	<input type="checkbox"/> Unaltered	<input type="checkbox"/> Moved	<input checked="" type="checkbox"/> Original Site		

DESCRIBE THE PRESENT AND ORIGINAL (if known) PHYSICAL APPEARANCE

The Rosegill plantation complex is located in a commanding position near the end of a narrow peninsula formed by Urbanna Creek on the west and a millpond and marshy creek on the east. The complex is approached from the south by a long axial avenue across open fields. On the north side of the complex is a broad flat field and a sweeping prospect of the two mile wide Rappahannock River.

At present, the complex consists of an impressive range of five eighteenth century buildings. From east to west the range includes: a wash house (now the manager's house), the dwelling house, the kitchen (now an office), and a storage house (now a garage). The land fronts of the buildings are aligned, forming a grandiose row, stretching 466 feet from end to end. The focal point of the group, the dwelling house, has had a complex architectural evolution. In its original form it was a small, 1 1/2-story brick structure, approximately 37'6" X 21', covered by a gable roof with interior-end brick chimneys. In this form it was similar in style and proportion to the dependencies; and thus it is assumed that all the buildings were built at the same time as an architecturally unified complex. While it is known that Rosegill was occupied since the mid-seventeenth century, this complex stylistically dates no earlier than the period 1730-1750. The brickwork details in the dependencies, and the few remaining pieces of original paneling in the house substantiate this dating.

The plan of the dwelling house's original core consists of a center hall with a room on either side. The stair must have ascended either in one of the rooms or between the walls as the hall is too narrow to permit a stair. Still in place beneath the hall is an original vaulted wine cellar. The footings of the unexcavated portion of the original core are ballast stones.

This core was enlarged by the addition of a room, twenty-five feet in length, at either end, making the overall length of the facade eighty-eight feet with eleven bays. The style of the paneling installed in these rooms is of the 1770 period, and the English marble mantle with carved shell and foliage, and Sienna Marble panels is very similar to one in Carter's Grove ordered in 1771. It is likely that part of this circa 1770 enlargement included the twelve foot wide stair hall added across the entire river front. A further enlargement is known through an 1801 policy of the Mutual Assurance Company showing that the house was made U-shaped by the addition of two 33' X 25' wings on the river front. These wings probably formed part of the circa 1770 enlargement, but may have come later. The same policy stated that the house by then was covered by a "Dutch Roof," probably meaning a gambrel roof.

As shown on an 1805 revaluation policy of the Mutual

SEE INSTRUCTIONS

**SIGNIFICANCE**

PERIOD (Check One or More as Appropriate)

- |  |  |  |                                       |
|--|--|--|---------------------------------------|
| <input type="checkbox"/> Pre-Columbian | <input type="checkbox"/> 16th Century            | <input checked="" type="checkbox"/> 18th Century | <input type="checkbox"/> 20th Century |
| <input type="checkbox"/> 15th Century  | <input checked="" type="checkbox"/> 17th Century | <input checked="" type="checkbox"/> 19th Century |                                       |

SPECIFIC DATE(S) (If Applicable and Known)

AREAS OF SIGNIFICANCE (Check One or More as Appropriate)

- |  |   |   |  |
|--|---|---|--|
| <input type="checkbox"/> Aboriginal              | <input type="checkbox"/> Education              | <input checked="" type="checkbox"/> Political | <input type="checkbox"/> Urban Planning        |
| <input type="checkbox"/> Prehistoric             | <input type="checkbox"/> Engineering            | <input type="checkbox"/> Religion/Philosophy  | <input type="checkbox"/> Other (Specify) _____ |
| <input type="checkbox"/> Historic                | <input type="checkbox"/> Industry               | <input type="checkbox"/> Science              | _____  |
| <input checked="" type="checkbox"/> Agriculture  | <input type="checkbox"/> Invention              | <input type="checkbox"/> Sculpture            | _____  |
| <input checked="" type="checkbox"/> Architecture | <input type="checkbox"/> Landscape Architecture | <input type="checkbox"/> Social/Humanitarian  | _____  |
| <input type="checkbox"/> Art                     | <input type="checkbox"/> Literature             | <input type="checkbox"/> Theater              | _____  |
| <input type="checkbox"/> Commerce                | <input type="checkbox"/> Military               | <input type="checkbox"/> Transportation       | _____  |
| <input type="checkbox"/> Communications          | <input type="checkbox"/> Music                  |   |  |
| <input type="checkbox"/> Conservation            |   |   |  |

STATEMENT OF SIGNIFICANCE

Rosegill ranks among the oldest and most historic estates in America. It was established in 1649, when Ralph Wormeley I patented 3200 acres "on South side of Rappahannock River, 10 miles up the river from Bay, bounded on the northwest by Rosegill Creek." Ralph Wormeley and his brother, Christopher (a former governor of the Tortuga), were the first of their distinguished family to settle in Virginia, and both served on the Governor's Council. Following Wormeley's death his widow, the former Agatha Eltonhead of Eltonhead, married Sir Henry Chicheley, Deputy Governor of the Colony, who made Rosegill his home. The estate was inherited, however, by Wormeley's son, Ralph Wormeley II (1650-1700), probably the most distinguished member of the family. Ralph II matriculated at Oriel College, Oxford in 1665, and returned to Virginia following the completion of his education. During his career of public service he acquired the reputation of being "the most powerful man in Virginia"; serving as a burgess, a member of the Council, Secretary of State, trustee of the College of William and Mary, and President of the Council.

Rosegill was an elaborate seat during Ralph II's tenure. It was described in 1686 by M. Durand, a French Huguenot immigrant, as consisting of ". . . at least 20 houses scattered along a charming plateau above the River. The best of these he [Ralph Wormeley II] lends to the Governor." The governor to whom Durand referred was Lord Howard of Effingham, who spent his summers at Rosegill to avoid the inhospitable climate of Jamestown. That Rosegill should have been chosen by Effingham over all other places available to him is indicative of the plantations' importance.

Ralph Wormeley II left Rosegill to his son Ralph III (circa 1680-circa 1715). Ralph III served as sheriff of Middlesex County from 1704 to 1705, but died before he had the opportunity to hold any other public offices. His brother, John Wormeley (1689-1726) fell heir to Rosegill, and lived there quietly until his death. John's son, Ralph Wormeley IV (1715-1790) was the next owner of the estate and it probably was he who erected the present complex of brick buildings. Recent architectural investigation of these structures by Mr. Paul Buchanan of the Colonial Williamsburg Foundation has led

SEE INSTRUCTIONS

**9. MAJOR BIBLIOGRAPHICAL REFERENCES**

Homes and Gardens in Old Virginia, Garden Clubs of Va., pp.367-371.  
 Lancaster, Historic Virginia Homes and Gardens, pp.287 ff.  
 Nugent, Cavaliers and Pioneers, p. 181.  
 Torrence, Virginia Wills and Administrations, p. 470.  
 Virginia Magazine of History and Biography, vol. 8, pp. 179 ff;  
 vol. 16, pp. 16-17; vol. 18, pp.373-375; vol. 36, pp.98-101, pp. 283 ff. pp. 385 ff.  
 Mutual Assurance Company, vol. 14, policy 474; vol. 35 revaluation policy 161; vol. 43 revaluation policy 1935.

**10. GEOGRAPHICAL DATA**

LATITUDE AND LONGITUDE COORDINATES DEFINING A RECTANGLE LOCATING THE PROPERTY			LATITUDE AND LONGITUDE COORDINATES DEFINING THE CENTER POINT OF A PROPERTY OF LESS THAN TEN ACRES		
CORNER	LATITUDE	LONGITUDE			
	Degrees Minutes Seconds	Degrees Minutes Seconds	Degrees	Minutes	Seconds
NW	37 ° 38' 22 "	76 ° 34' 25 "	°	'	"
NE	37 ° 38' 22 "	76 ° 33' 28 "	°	'	"
SE	37 ° 36' 59 "	76 ° 33' 28 "	°	'	"
SW	37 ° 36' 59 "	76 ° 34' 25 "	°	'	"

APPROXIMATE ACREAGE OF NOMINATED PROPERTY: 400 acres

LIST ALL STATES AND COUNTIES FOR PROPERTIES OVERLAPPING STATE OR COUNTY BOUNDARIES

STATE:	CODE	COUNTY	CODE
STATE:	CODE	COUNTY:	CODE
STATE:	CODE	COUNTY:	CODE
STATE:	CODE	COUNTY:	CODE

**11. FORM PREPARED BY**

NAME AND TITLE:  
 Virginia Historic Landmarks Commission Staff  
 ORGANIZATION: Virginia Historic Landmarks Commission  
 DATE: January 1973  
 STREET AND NUMBER:  
 Room 1116 Ninth Street State Office Building  
 CITY OR TOWN: Richmond  
 STATE: Virginia  
 CODE: 51

**12. STATE LIAISON OFFICER CERTIFICATION NATIONAL REGISTER VERIFICATION**

<p>As the designated State Liaison Officer for the National Historic Preservation Act of 1966 (Public Law 89-665), I hereby nominate this property for inclusion in the National Register and certify that it has been evaluated according to the criteria and procedures set forth by the National Park Service. The recommended level of significance of this nomination is:</p> <p>National <input type="checkbox"/> State <input checked="" type="checkbox"/> Local <input type="checkbox"/></p> <p>Name _____                  Junius R. Fishburne, Jr. Director                  Virginia Historic Landmarks Commission                  Title _____</p> <p>Date _____</p>	<p>I hereby certify that this property is included in the National Register.</p> <p>_____                  Chief, Office of Archeology and Historic Preservation</p> <p>Date _____</p> <p>ATTEST:                  _____                  Keeper of The National Register</p> <p>Date _____</p>
--	---

SEE INSTRUCTIONS

NATIONAL REGISTER OF HISTORIC PLACES  
INVENTORY - NOMINATION FORM

(Continuation Sheet)

STATE	Virginia
COUNTY	Middlesex
FOR NPS USE ONLY	
ENTRY NUMBER	DATE

(Number all entries)

7.  
Assurance Company, the house by that date had been connected to each dependency by a "covered way part brick & part wood." These ways were over eighty-six feet in length and nine feet deep. Also a "Wooden Piazza 10 by 20 feet" had been added to the center of the land front. An 1815 revaluation policy shows that the covered ways had been replaced by a brick wall, and the the "piazza" or portico had a stone floor. All three policies mention numerous wooden outbuildings of which only a smokehouse remains.

The house underwent a major remodeling around 1850, probably after its sale to Captain John Bailey in 1849. The "Dutch Roof" was removed and the main body of the house raised to two full stories with a gable roof. The second story was faced with weatherboards. It may have been at this time that the two wings on the north side were removed as they were not incorporated in the remodeling scheme. All the brick walls on the main portion were stuccoed and scored (perhaps to hide the scars of the lost wings) and all the eighteenth century exterior trim was replaced with simple Greek Revival trim. The portico appears to have been replaced also since the present porch is mid-nineteenth century in style. About the only exterior feature left to show the building's early origin was the beveled water table.

On the interior, the long hall across the north side of the house was retrimmed with Greek Revival woodwork, and the two stairs there appear to be entirely of mid-nineteenth century origin. The paneling in the small room on the east side of the entrance hall was retained as was the paneling in the circa 1770 rooms. Some original woodwork was left on the second floor, but the exact quantity is not known.

The house underwent yet another major remodeling in the early 1940's, after it was acquired by the late husband of the present owner. In this remodeling, the paneling in the east room of the original core was dismantled and installed in the room on the west side of the entrance hall. The east wall of the original core was then demolished to make a large new dining room. Half the area of the circa 1770 east room was incorporated into the new dining room and the rest of the space was made into a breakfast room. The fine paneling of the circa 1770 east room was discarded, although the Greek Revival plaster rosette was saved and moved to the new dining room. Fortunately, the paneling in the corresponding room on the opposite end of the house was spared. Notable features of this unusually handsome fully paneled room include the imported marble mantel already mentioned, the eight-panel doors, and the full length fluted Ionic pilasters flanking the mantel. The second floor was altered by the removal of the interior fireplaces to provide space for

NATIONAL REGISTER OF HISTORIC PLACES  
INVENTORY - NOMINATION FORM

(Continuation Sheet)

STATE	
Virginia	
COUNTY	
Middlesex	
FOR NPS USE ONLY	
ENTRY NUMBER	DATE

(Number all entries)

7.  
bathrooms and closets. Some eighteenth century doors remain on the second floor, but there is little other early woodwork. Additions in the 1940's remodeling include small, one-story service wings at either end of the house and a one-story sun porch in the center of the north front. The wash house and kitchen have undergone several renovations, and, except for the brick walls, little original fabric remains in either building. Both buildings are laid in Flemish bond above the water table and have wide segmental arched windows with gauged brick lintels. Any glazing in the brickwork is hidden by numerous coats of paint. The kitchen has a symmetrical five-bay facade, however the wash house has an asymmetrical six-bay facade. The kitchen retains its original fireplace with its eight-foot wide opening. The storage house to the west of the kitchen is also laid in Flemish bond, but the front wall has been removed to make a garage opening. A brick on the east wall is inscribed "RW". Other early out-buildings include a nineteenth century frame smokehouse and a nineteenth century bake oven, both near the wash house. Immediately in front of the main house are two interesting fragments of Corinthian pilaster capitals in what appears to be Portland stone. The origin of these fragments is unknown, but they may once have formed part of the front portico.

CCL

NATIONAL REGISTER OF HISTORIC PLACES  
INVENTORY - NOMINATION FORM

(Continuation Sheet)

STATE	
Virginia	
CO. NTY	
Middlesex	
FOR NPS USE ONLY	
ENTRY NUMBER	DATE

(Number all entries)

8.

to the belief that these buildings belong to the 1730-1750 period and incorporate no seventeenth century fabric.

Ralph Wormeley IV, served as a burgess, and, like his son, Ralph V (1774-1806), was not sympathetic with the Revolution. Both father and son attempted to remain passive during the struggle, but Ralph V, accused of loyalist sympathies, was banished to Frederick County for the duration of the War. Upon his release, he returned to Rosegill only to discover that the house ironically had been pillaged by a Tory privateer. Ralph V later accepted the break from England, and continued his family's tradition of leadership in Virginia affairs by serving in the House of Delegates and being a member of the Virginia Convention of 1788.

Following Ralph Wormeley V's death Rosegill passed through various ownerships. From 1848 to 1855 it was in the possession of Captain John Bailey whose extensive alterations gave the house its present nineteenth century aspect. From 1901 to 1924 it was owned by J. Henry Cochran, a United States Senator from Pennsylvania. Rosegill was acquired by the late husband of the present owner in 1944.

Although the present complex of buildings is a significant relic of colonial plantation architecture, the extensive nature of the original complex, coupled with its associations with some of the colonies' most prestigious individuals, makes Rosegill potentially one of the state's richest archaeological sites.

CCL

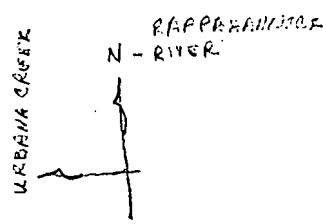

ROSEGILL - MIDDLESEX CO  
 MRS. S. SHANNON, SR.  
 OWNER SINCE 1944  
 VISITED 9-1-72 BY PB  
 WITH CALDER LOYD OF  
 VA LANDMARKS COMMISSION.  
 ORIGINALLY A WORKMAN'S HOME  
 UNTIL 1806

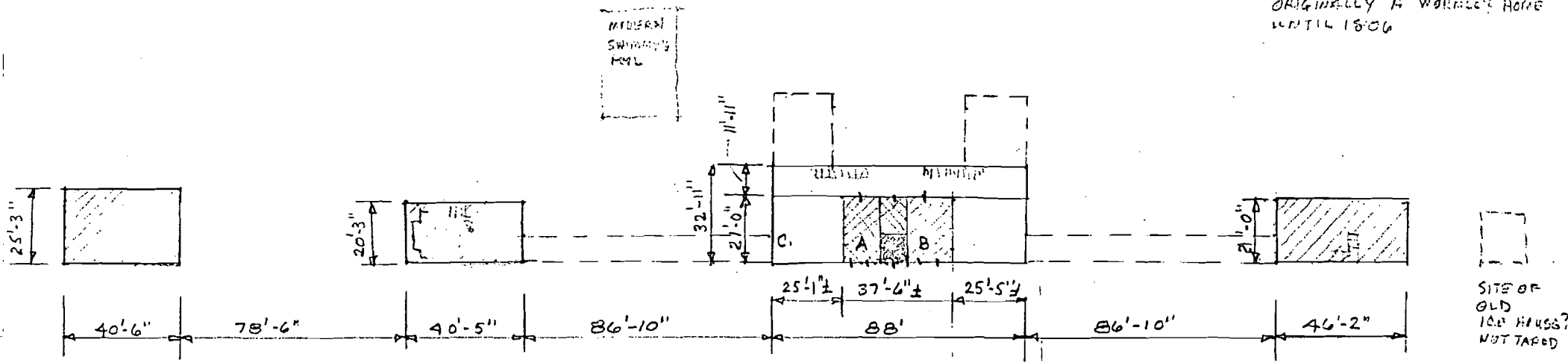

CARRIAGE HOUSE  
 NOW LUMBER HOUSE  
 INTERIOR GUTTED OPENINGS CHANGED  
 BRICK PAINTED

OFFICE  
 INTERIOR MODERN EXCEPT WEST 2' FIREPLACE GREEN MANTLE  
 BRICK PAINTED

COVERED WAY  
 SOUTH WALL EXISTED 1801 REMOVED c1850

MAIN HOUSE  
 HATCHED PORTION BUILT FIRST  
 CELLAR DOUBLE HATCHED VAULTED WINE CELLAR IN SOLID AREA  
 BOTTLED BEER WINGS EXISTED IN 1801 REMOVED c1850. MAIN HOUSE (33x88) HAD A DUTCH ROOF IN 1801, MADE 2 STORIES c1850. 2ND STORY FRAME 1200YR BRICK STUCCOED FOOTINGS OF 1ST BLDG. c1850 STONE.  
 PANGLED ROOM 'A' WAS MOVED FROM 'B' c.1844 SIENNA MARBLE MANTLE AT 'C' c.1771 (VERY SIMILAR TO ONE AT CARTERS GROVE)

COVERED WAY  
 SAME AS WEST ONLY

KITCHEN  
 NOW CARRIAGE HOUSE INTERIOR MODERN STAIR c1850  
 PAINTED BRICK

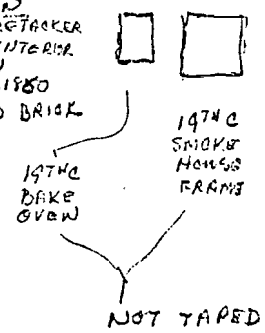

MODERN FARM BLDGS

PLAN (MODERN ADDITIONS NOT SHOWN)

SCALE 1"=50' TAPED DIMENSIONS ABOVE WATERTABLE

HATCHED BLDGS. SUPPOSED TO BE 17<sup>TH</sup> C BUT APPEAR TO BE 1730-1750

PB  
 9-1-72



U.S.G.S. 7½' quadrangles (scale 1:24000)  
Urbanna, Va. 1946; Saluda, Va. 1965

ROSEGILL  
LATITUDE  
NW 37° 38' 22"  
NE 37° 38' 22"  
SE 37° 36' 59"  
SW 37° 36' 59"

LONGITUDE  
76° 34' 25"  
76° 33' 28"  
76° 33' 28"  
76° 34' 25"

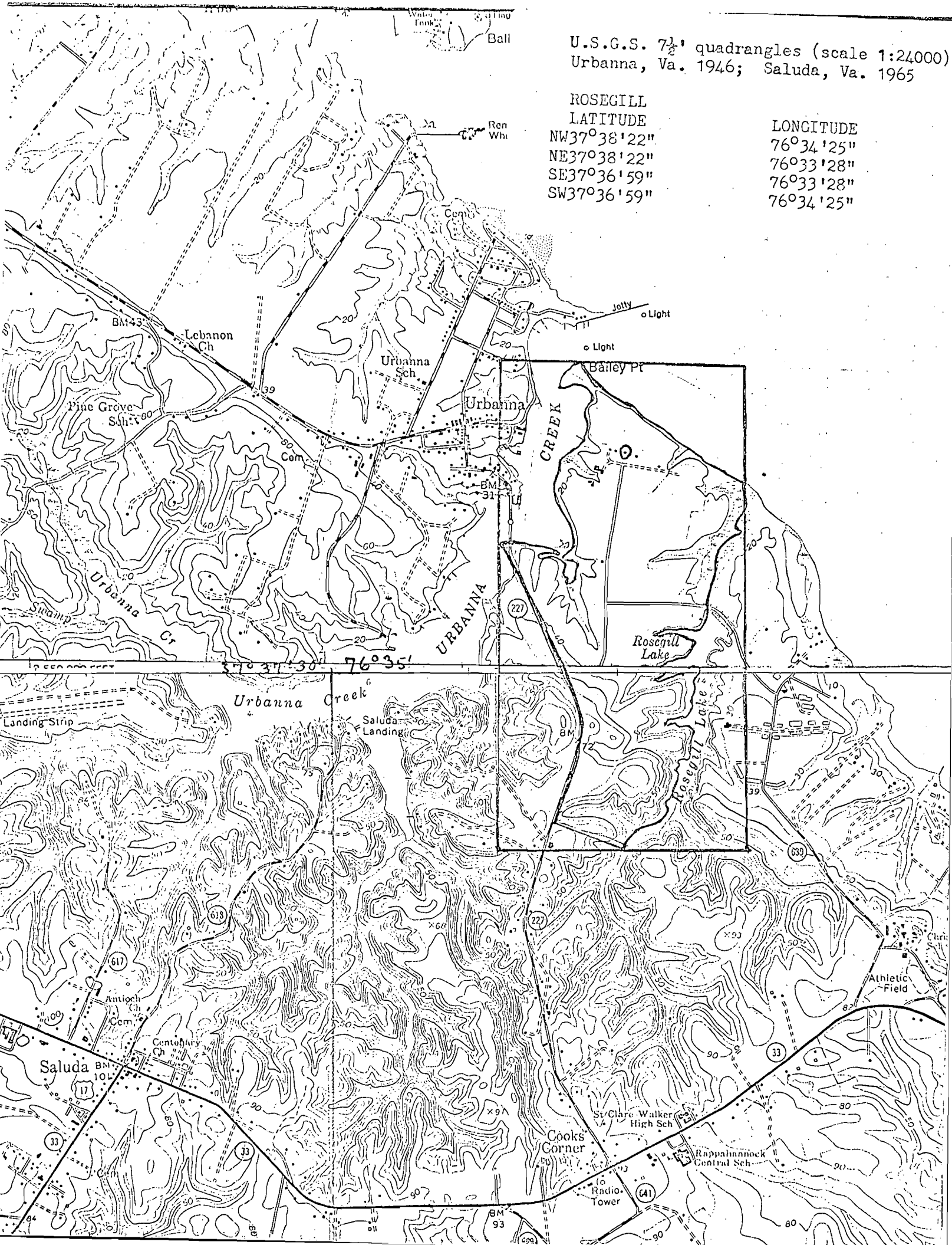

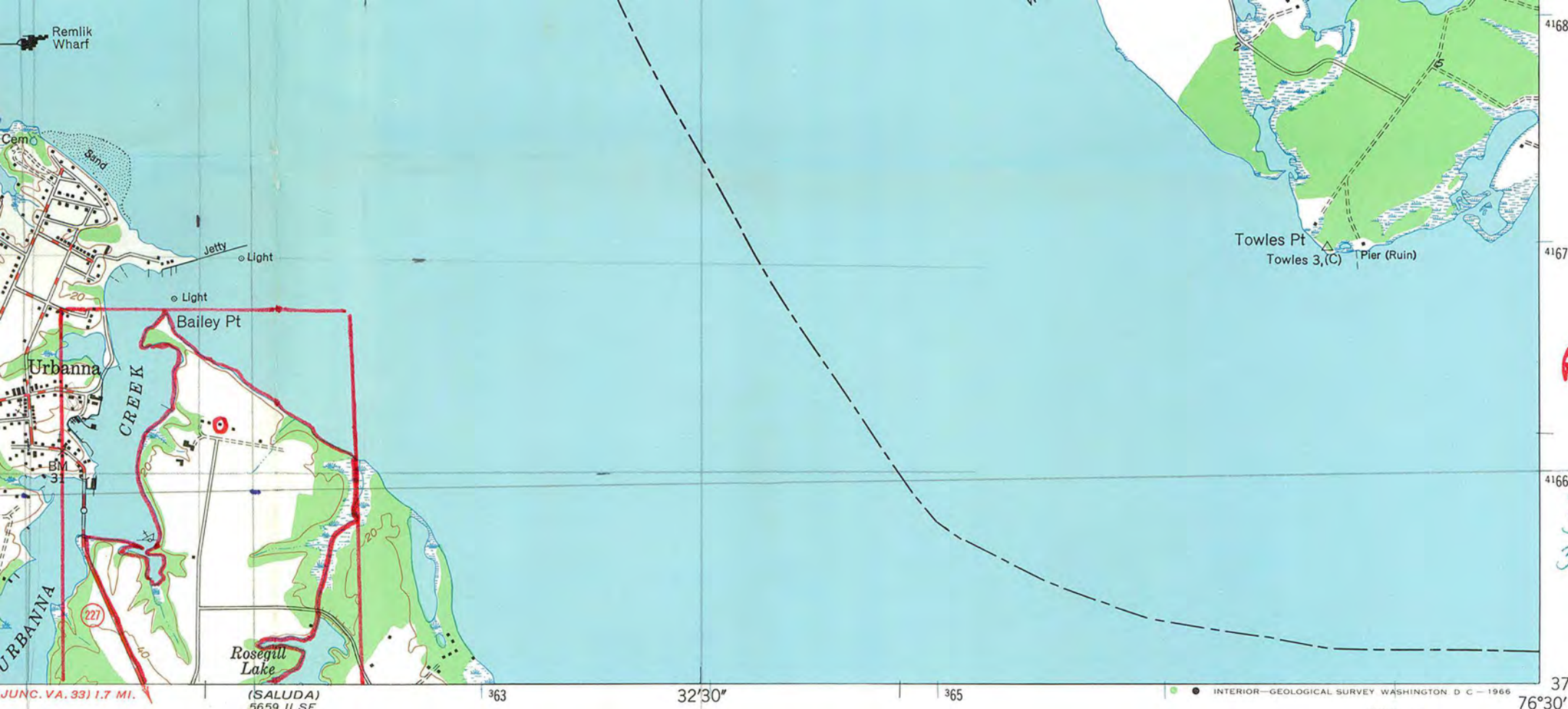

*Rosegill*  
 Lat.  
 37° 38' 22"  
 37° 38' 22"  
 37° 36' 59"  
 37° 36' 59"  
 Long.  
 76° 34' 25"  
 76° 33' 28"  
 76° 33' 28"  
 76° 34' 25"  
 (WATSON) 5759 W SW

JUNC. VA. 33) 1.7 MI. (SALUDA) 5659 II SE 363 32'30" 365 37°37'30" 367000m.E. 76°30' 4166000m.N. 4167 4168

INTERIOR—GEOLOGICAL SURVEY WASHINGTON D.C.—1966 USC&GS T-8345

ROAD CLASSIFICATION

- |   |                   |
|---|-------------------|
| HARD-SURFACE ALL WEATHER ROADS                | DRY WEATHER ROADS |
| Heavy-duty <i>4 LANE 16 LANE</i>              | Improved dirt     |
| Medium-duty <i>4 LANE 16 LANE</i>             | Unimproved dirt   |
| Loose-surface, graded, or narrow hard-surface |                   |
| U. S. Route                                   | State Route       |

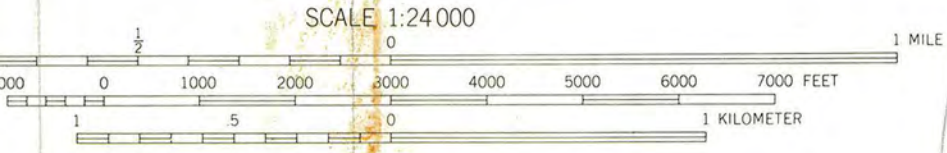

SCALE 1:24 000  
 CONTOUR INTERVAL 20 FEET  
 DATUM IS MEAN SEA LEVEL

SHORELINE SHOWN REPRESENTS THE APPROXIMATE LINE OF MEAN HIGH WATER  
 THE AVERAGE RANGE OF TIDE IS APPROXIMATELY 2 FEET

THIS MAP COMPLIES WITH NATIONAL MAP ACCURACY STANDARDS  
 FOR SALE BY U. S. GEOLOGICAL SURVEY, WASHINGTON, D. C. 20242,  
 VIRGINIA DIVISION OF MINERAL RESOURCES, CHARLOTTESVILLE, VIRGINIA  
 LEADER DESCRIBING TOPOGRAPHIC MAPS AND SYMBOLS IS AVAILABLE ON REQUEST

URBANNA, VA.  
 N3737.5—W7630/7.5

1946

AMS 5659 II NE—SERIES V834

*Sheet one*

*Rosegill*

ENTERED  
MIDDLESEX C.H.  
in map book  
(57-8)

ENTERED  
CHRISTCHURCH  
in map book  
(57-2)

COMMONWEALTH OF VIRGINIA  
DIVISION OF MINERAL RESOURCES  
JAMES L. CALVER, STATE GEOLOGIST

SALUDA

7.5 MINUTE S

SE/4 URBA

