

VLR-11/5/68 NRHP-10/1/69

NATIONAL REGISTER OF HISTORIC PLACES
INVENTORY - NOMINATION FORM

(Type all entries - complete applicable sections)

STATE: Virginia	
COUNTY: Northampton	
FOR NPS USE ONLY	
ENTRY NUMBER	DATE

1. NAME

COMMON:
Winona

AND/OR HISTORIC:
Winonah

2. LOCATION

STREET AND NUMBER: .7 mi. S of Rt. 619, .4 mi. NW of intersection of Rt. 619 and Rt. 622.

CITY OR TOWN:

STATE: Virginia CODE: 45 COUNTY: Northampton CODE: 131

3. CLASSIFICATION

CATEGORY (Check One)	OWNERSHIP		STATUS	ACCESSIBLE TO THE PUBLIC
District <input type="checkbox"/> Building <input checked="" type="checkbox"/>	Public <input type="checkbox"/>	Public Acquisition: <input type="checkbox"/>	Occupied <input checked="" type="checkbox"/>	Yes: <input type="checkbox"/>
Site <input type="checkbox"/> Structure <input type="checkbox"/>	Private <input checked="" type="checkbox"/>	In Process <input type="checkbox"/>	Unoccupied <input type="checkbox"/>	Restricted <input type="checkbox"/>
Object <input type="checkbox"/>	Both <input type="checkbox"/>	Being Considered <input type="checkbox"/>	Preservation work in progress <input type="checkbox"/>	Unrestricted <input type="checkbox"/>
No: <input checked="" type="checkbox"/>				

PRESENT USE (Check One or More as Appropriate)

Agricultural <input type="checkbox"/>	Government <input type="checkbox"/>	Park <input type="checkbox"/>	Transportation <input type="checkbox"/>	Comments <input type="checkbox"/>
Commercial <input type="checkbox"/>	Industrial <input type="checkbox"/>	Private Residence <input checked="" type="checkbox"/>	Other (Specify) <input type="checkbox"/>	
Educational <input type="checkbox"/>	Military <input type="checkbox"/>	Religious <input type="checkbox"/>		
Entertainment <input type="checkbox"/>	Museum <input type="checkbox"/>	Scientific <input type="checkbox"/>		

4. OWNER OF PROPERTY

OWNERS NAME:
Mrs. Mamie Belote Williams Bell

STREET AND NUMBER:

CITY OR TOWN: Machipongo STATE: Virginia CODE: 45

5. LOCATION OF LEGAL DESCRIPTION

COURTHOUSE, REGISTRY OF DEEDS, ETC:
Northampton County Court House

STREET AND NUMBER:

CITY OR TOWN: Eastville STATE: Virginia CODE: 45

APPROXIMATE ACREAGE OF NOMINATED PROPERTY: 72 acres

6. REPRESENTATION IN EXISTING SURVEYS

TITLE OF SURVEY:
Historic American Buildings Survey

DATE OF SURVEY: 1940 Federal State County Local

DEPOSITORY FOR SURVEY RECORDS:
Library of Congress

STREET AND NUMBER:

CITY OR TOWN: Washington STATE: District of Columbia CODE: 08

SEE INSTRUCTIONS

STATE: Virginia
COUNTY: Northampton
FOR NPS USE ONLY
ENTRY NUMBER
DATE

7. DESCRIPTION

CONDITION	(Check One)					
	Excellent <input type="checkbox"/>	Good <input checked="" type="checkbox"/>	Fair <input type="checkbox"/>	Deteriorated <input type="checkbox"/>	Ruins <input type="checkbox"/>	Unexposed <input type="checkbox"/>
INTEGRITY	(Check One)			(Check One)		
	Altered <input type="checkbox"/>			Unaltered <input checked="" type="checkbox"/>		
<div style="display: flex; justify-content: space-between;"> Moved <input type="checkbox"/> Original Site <input checked="" type="checkbox"/> </div>						

DESCRIBE THE PRESENT AND ORIGINAL (if known) PHYSICAL APPEARANCE

The original portion of Winona is a small story-and-a-half brick structure with a gable roof and simple box cornice. The outside of the house, exclusive of the chimney base, measures 32'6" long by 27'6" wide. Its brickwork is laid in Flemish bond with random glazed headers, and has a beveled water table. The building's west wall fell many years ago and was replaced with clapboarding. A section of the north wall also fell and has been replaced by brick laid in five course American bond. Winona's outstanding architectural feature is its fine exterior chimney on the eastside with its three freestanding stacks set diagonally on the base. The caps of the stacks are engaged and are decorated with mouse-tooth bricks. This same type of decoration appears around the base just below the wash. Unfortunately the bottom portion of the chimney has been hidden by a later one-story frame addition. A second one-story frame wing has recently been added to the west side of the house. Originally the house probably had dormers; however, the present ones appear to be a renewal.

The first floor of Winona is divided into two rooms and a side hall containing the staircase. Unfortunately the house retains little if any of its interior woodwork. The present woodwork is very plain and probably dates from the late-nineteenth century.

Winona has recently been renovated.

SEE INSTRUCTIONS

6. SIGNIFICANCE

PERIOD (Check One or More as Appropriate)

Pre-Columbian 16th Century 18th Century 20th Century
 15th Century 17th Century 19th Century

SPECIFIC DATE(S) (If Applicable and Known)

AREAS OF SIGNIFICANCE (Check One or More as Appropriate)

Aboriginal	Education	Political	Urban Planning
Prehistoric <input type="checkbox"/>	Engineering <input type="checkbox"/>	Religion/Philosophy <input type="checkbox"/>	Other (Specify) <input type="checkbox"/>
Historic <input type="checkbox"/>	Industry <input type="checkbox"/>	Science <input type="checkbox"/>	_____
Agriculture <input type="checkbox"/>	Invention <input type="checkbox"/>	Sculpture <input type="checkbox"/>	_____
Art <input checked="" type="checkbox"/>	Landscape <input type="checkbox"/>	Social/Humanitarian <input type="checkbox"/>	_____
Commerce <input type="checkbox"/>	Architecture <input type="checkbox"/>	Theater <input type="checkbox"/>	_____
Communications <input type="checkbox"/>	Literature <input type="checkbox"/>	Transportation <input type="checkbox"/>	_____
Conservation <input type="checkbox"/>	Military <input type="checkbox"/>		_____
	Music <input type="checkbox"/>		_____

STATEMENT OF SIGNIFICANCE (Include Personages, Dates, Events, Etc.)

The date of this Eastern Shore farmhouse is uncertain, however, it is thought to have been built by Mathew Patrick after 1681 when he acquired a reversionary interest in the property on which the house is located. It is reported that a brick in the chimney is dated "1645", and that a brick in the west wall is inscribed "1649".

Despite the uncertainty of its date Winona is of great architectural significance as it is the only known seventeenth century house in the country, other than Bacon's Castle, to have diagonally placed triple chimney stacks. Such chimney treatment is indicative of the architectural consciousness of seventeenth century Virginia. It also demonstrates the delayed impact that English architectural forms had in the colonies. The importance of the chimney at Winona, as an excellent example of late medieval architecture, cannot be exaggerated.

SEE INSTRUCTIONS

9. MAJOR BIBLIOGRAPHICAL REFERENCES

Whitelaw, Ralph T., Virginia's Eastern Shore. 2 Volumes. Gloucester, Mass.: Peter Smith, 1968.
 Robertson, John William, On Land and Sea. Onancock, Va.: The Eastern Shore News, Inc., 1962.
 Forman, Henry Chandlee, The Architecture of the Old South; the Medieval Style, 1585-1850. New York: Russell & Russell, 1948.

10. GEOGRAPHICAL DATA

LATITUDE AND LONGITUDE COORDINATES DEFINING A RECTANGLE LOCATING THE PROPERTY			O R	LATITUDE AND LONGITUDE COORDINATES DEFINING THE CENTER POINT OF A PROPERTY OF LESS THAN ONE ACRE		
CORNER	LATITUDE	LONGITUDE		LATITUDE	LONGITUDE	
	Degrees Minutes Seconds	Degrees Minutes Seconds		Degrees Minutes Seconds	Degrees Minutes Seconds	
NW	0 ' "	0 ' "		37 ° 26 ' 24 "	75 ° 56 ' 10 "	
NE	0 ' "	0 ' "				
SE	0 ' "	0 ' "				
SW	0 ' "	0 ' "				

LIST ALL STATES AND COUNTIES FOR PROPERTIES OVERLAPPING STATE OR COUNTY BOUNDARIES

STATE:	CODE	COUNTY	CODE

11. FORM PREPARED BY

NAME AND TITLE:
 Staff, Virginia Historic Landmarks Commission, James W. Moody, Jr., Director

ORGANIZATION: Virginia Historic Landmarks Commission

DATE: May 28, 1969

STREET AND NUMBER:
 Room 1116, Ninth Street State Office Building

CITY OR TOWN: Richmond

STATE: Virginia

CODE: 45

12. STATE LIAISON OFFICER CERTIFICATION

As the designated State Liaison Officer for the National Historic Preservation Act of 1966 (Public Law 89-665), I hereby nominate this property for inclusion in the National Register and certify that it has been evaluated according to the criteria and procedures set forth by the National Park Service. The recommended level of significance of this nomination is:

National State Local

Name: Dr. Edward P. Alexander
 Dr. Edward P. Alexander, Chairman

Title: Virginia Historic Landmarks Comm.

Date: June 2, 1969

NATIONAL REGISTER VERIFICATION

I hereby certify that this property is included in the National Register.

Ernest Allen Cunnally
 Chief, Office of Archeology and Historic Preservation

Date: Oct 1 1969

ATTEST:

William P. Smith
 Keeper of The National Register

Date: Oct 1 1969

SEE INSTRUCTIONS

NATIONAL REGISTER OF HISTORIC PLACES
INVENTORY - NOMINATION FORM

(Continuation Sheet)

STATE	
Virginia	
COUNTY	
Northampton	
FOR NPS USE ONLY	
ENTRY NUMBER	DATE

(Number all entries)

6. Historic American Buildings Survey Inventory
1958 Federal
Library of Congress
Washington, D. C. Code: 08

Virginia Historic Landmarks Commission Report #65-32
1968 State
Virginia Historic Landmarks Commission
Room 1116, Ninth Street State Office Building
Richmond, Virginia Code: 45

NATIONAL REGISTER OF HISTORIC PLACES
PROPERTY MAP FORM

(Type all entries - attach to or enclose with map)

STATE Virginia	
COUNTY Northampton	
FOR NPS USE ONLY	
ENTRY NUMBER	DATE

SEE INSTRUCTIONS

1. NAME			
COMMON: Winona			
AND/OR HISTORIC: Winonah			
2. LOCATION			
STREET AND NUMBER: .7 mi. S of Rt. 619, .4 mi. NW of intersection of Rt. 619 and Rt. 622.			
CITY OR TOWN:			
STATE: Virginia	CODE 45	COUNTY: Northampton	CODE 131
3. MAP REFERENCE			
SOURCE: U.S.G.S. 7.5' quadrangle Franktown			
SCALE: 1:24000			
DATE: 1943			
4. REQUIREMENTS			
TO BE INCLUDED ON ALL MAPS			
1. Property boundaries where required.			
2. North arrow.			
3. Latitude and longitude reference.			

NATIONAL REGISTER OF HISTORIC PLACES
PROPERTY PHOTOGRAPH FORM

(Type all entries - attach to or enclose with photograph)

STATE Virginia	
COUNTY Northampton	
FOR NPS USE ONLY	
ENTRY NUMBER	DATE

SEE INSTRUCTIONS

1. NAME			
COMMON: Winona			
AND/OR HISTORIC: Winonah			
2. LOCATION			
STREET AND NUMBER: .7 mi. S of Rt. 619, .4 mi. NW of intersection of Rt. 619 and Rt. 622.			
CITY OR TOWN:			
STATE: Virginia	CODE 45	COUNTY: Northampton	CODE 131
3. PHOTO REFERENCE			
PHOTO CREDIT: Virginia Historic Landmarks Commission			
DATE OF PHOTO: 1968			
NEGATIVE FILED AT: Virginia Historic Landmarks Commission Richmond, Virginia			
4. IDENTIFICATION			
DESCRIBE VIEW, DIRECTION, ETC.			
View of front from the North			

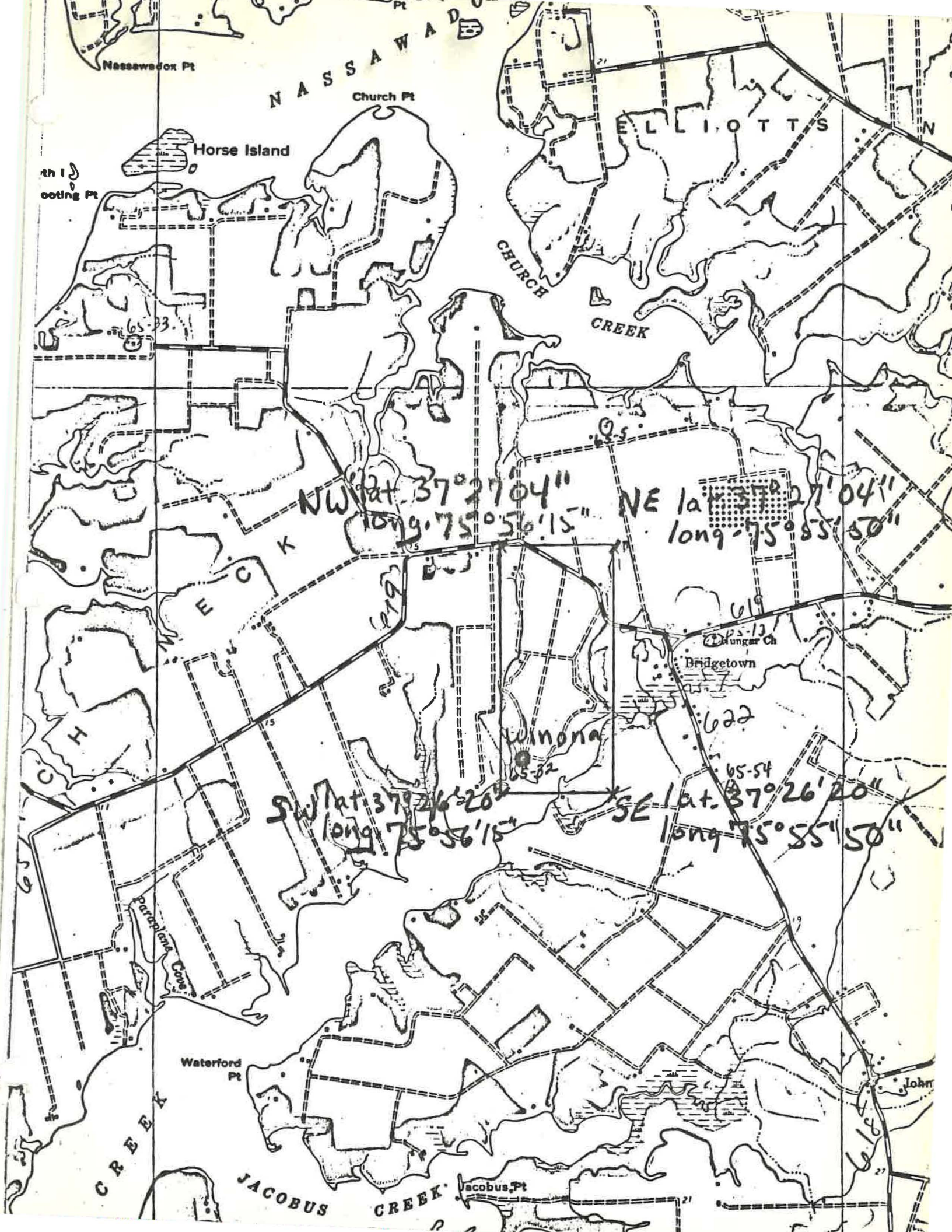

Nassawadox Pt

NASSAWADOX

Church Pt

ELLIOTTS

Horse Island

Boating Pt

CHURCH

CREEK

NW lat. 37° 27' 04"
long 75° 56' 15"

NE lat. 37° 27' 04"
long 75° 55' 50"

W. C. K.

Bridgetown

Winona

SW lat. 37° 26' 20"
long 75° 56' 15"

SE lat. 37° 26' 20"
long 75° 55' 50"

Waterford Pt

CREEK

JACOBUS CREEK

Jacobus Pt

John

NATIONAL REGISTER OF HISTORIC PLACES
INVENTORY - NOMINATION FORM

(Type all entries - complete applicable sections)

STATE: Virginia	
COUNTY: Northampton	
FOR NPS USE ONLY	
ENTRY NUMBER 69-10-45, 0036	DATE 10-1-69

1. NAME

COMMON:
Winona

AND/OR HISTORIC:
Winonah

2. LOCATION

STREET AND NUMBER: .7 mi. S of Rt. 619, .4 mi. NW of intersection of Rt. 619 and Rt. 622.

CITY OR TOWN:

STATE Virginia	CODE 45	COUNTY: Northampton	CODE 131
-------------------	------------	------------------------	-------------

3. CLASSIFICATION

CATEGORY (Check One)	OWNERSHIP	STATUS	ACCESSIBLE TO THE PUBLIC
District <input type="checkbox"/> Building <input checked="" type="checkbox"/>	Public <input type="checkbox"/> Private <input checked="" type="checkbox"/> Both <input type="checkbox"/>	Occupied <input checked="" type="checkbox"/> Unoccupied <input type="checkbox"/> Preservation work in progress <input type="checkbox"/>	Yes: Restricted <input type="checkbox"/> Unrestricted <input type="checkbox"/> No: <input checked="" type="checkbox"/>
Site <input type="checkbox"/> Structure <input type="checkbox"/> Object <input type="checkbox"/>	Public Acquisition: In Process <input type="checkbox"/> Being Considered <input type="checkbox"/>		

PRESENT USE (Check One or More as Appropriate)

Agricultural <input type="checkbox"/>	Government <input type="checkbox"/>	Park <input type="checkbox"/>	Transportation <input type="checkbox"/>	Comments <input type="checkbox"/>
Commercial <input type="checkbox"/>	Industrial <input type="checkbox"/>	Private Residence <input checked="" type="checkbox"/>	Other (Specify) <input type="checkbox"/>	
Educational <input type="checkbox"/>	Military <input type="checkbox"/>	Religious <input type="checkbox"/>		
Entertainment <input type="checkbox"/>	Museum <input type="checkbox"/>	Scientific <input type="checkbox"/>		

4. OWNER OF PROPERTY

OWNERS NAME:
Mrs. Mamie Belote Williams Bell

STREET AND NUMBER:

CITY OR TOWN: Machipongo	STATE: Virginia	CODE 45
-----------------------------	--------------------	------------

5. LOCATION OF LEGAL DESCRIPTION

COURTHOUSE, REGISTRY OF DEEDS, ETC.:
Northampton County Court House

STREET AND NUMBER:

CITY OR TOWN: Eastville	STATE: Virginia	CODE 45
----------------------------	--------------------	------------

APPROXIMATE ACREAGE OF NOMINATED PROPERTY: 72 acres

6. REPRESENTATION IN EXISTING SURVEYS

TITLE OF SURVEY:
Historic American Buildings Survey

DATE OF SURVEY: 1940 Federal State County Local

DEPOSITORY FOR SURVEY RECORDS:
Library of Congress

STREET AND NUMBER:

CITY OR TOWN: Washington	STATE: District of Columbia	CODE 08
-----------------------------	--------------------------------	------------

STATE: Virginia

COUNTY: Northampton

FOR NPS USE ONLY

ENTRY NUMBER

DATE

SEE INSTRUCTIONS

10-1-69

131

69-10-45

19

4

69-10-45