

Form 10-300
(Dec. 1968)

UNITED STATES DEPARTMENT OF THE INTERIOR
NATIONAL PARK SERVICE

NATIONAL REGISTER OF HISTORIC PLACES
INVENTORY - NOMINATION FORM

(Type all entries - complete applicable sections)

| | |
|-------------------------------|-----------------|
| STATE: Virginia | |
| COUNTY: Surry | |
| FOR NPS USE ONLY | |
| ENTRY NUMBER 69-10-45-0043 | DATE 10/1/69 |

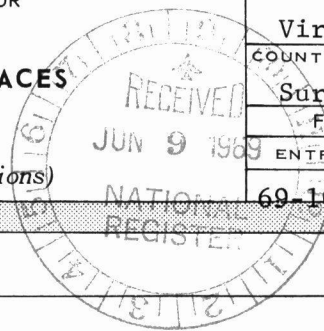

1. NAME

COMMON:
Chippokes Plantation

AND/OR HISTORIC:
Chippokes

2. LOCATION

STREET AND NUMBER: South bank of James River between College Run on the west and Lower Chippokes Creek on the east, opposite Jamestown Island.

CITY OR TOWN:
Jamestown vicinity

| | | | |
|-------------------|------------|------------------|-------------|
| STATE Virginia | CODE 45 | COUNTY: Surry | CODE 181 |
|-------------------|------------|------------------|-------------|

3. CLASSIFICATION

| CATEGORY (Check One) | OWNERSHIP | STATUS | ACCESSIBLE TO THE PUBLIC |
|--------------------------------------------------------------------------------|---------------------------------------------|--------------------------------------------------------|---------------------------------------------------------------------------|
| District <input type="checkbox"/> Building <input checked="" type="checkbox"/> | Public <input checked="" type="checkbox"/> | Occupied <input checked="" type="checkbox"/> | Yes: Restricted <input checked="" type="checkbox"/> |
| Site <input type="checkbox"/> Structure <input type="checkbox"/> | Private <input checked="" type="checkbox"/> | Unoccupied <input type="checkbox"/> | Unrestricted <input type="checkbox"/> |
| Object <input type="checkbox"/> | Both <input type="checkbox"/> | Preservation work in progress <input type="checkbox"/> | No: <input type="checkbox"/> |
| PRESENT USE (Check One or More as Appropriate) | | | |
| Agricultural <input type="checkbox"/> | Government <input type="checkbox"/> | Park <input type="checkbox"/> | Transportation <input type="checkbox"/> Comments <input type="checkbox"/> |
| Commercial <input type="checkbox"/> | Industrial <input type="checkbox"/> | Private Residence <input checked="" type="checkbox"/> | Other (Specify) <input checked="" type="checkbox"/> <u>Farm</u> |
| Educational <input type="checkbox"/> | Military <input type="checkbox"/> | Religious <input type="checkbox"/> | |
| Entertainment <input type="checkbox"/> | Museum <input type="checkbox"/> | Scientific <input type="checkbox"/> | |

4. OWNER OF PROPERTY

OWNERS NAME:
Commonwealth of Virginia

STREET AND NUMBER:

| | | |
|---------------------------|--------------------|------------|
| CITY OR TOWN: Richmond | STATE: Virginia | CODE 45 |
|---------------------------|--------------------|------------|

5. LOCATION OF LEGAL DESCRIPTION

COURTHOUSE, REGISTRY OF DEEDS, ETC.:
Surry County Court House

STREET AND NUMBER:

| | | |
|------------------------|--------------------|------------|
| CITY OR TOWN: Surry | STATE: Virginia | CODE 45 |
|------------------------|--------------------|------------|

APPROXIMATE ACREAGE OF NOMINATED PROPERTY: 1403 acres

6. REPRESENTATION IN EXISTING SURVEYS

TITLE OF SURVEY:
Historic American Buildings Survey Inventory

DATE OF SURVEY: 1959 Federal State County Local

DEPOSITORY FOR SURVEY RECORDS:
Library of Congress

STREET AND NUMBER:

| | | |
|-----------------------------|--------------------------------|------------|
| CITY OR TOWN: Washington | STATE: District of Columbia | CODE 08 |
|-----------------------------|--------------------------------|------------|

SEE INSTRUCTIONS

STATE: Virginia
COUNTY: Surry
ENTRY NUMBER: 69-10-45-0043
DATE: 10/1/69
FOR NPS USE ONLY

7. DESCRIPTION

| | | | | | | |
|-----------|------------------------------------|-----------------------------------------------|-------------------------------|---------------------------------------|---------------------------------------------------|------------------------------------|
| CONDITION | (Check One) | | | | | |
| | Excellent <input type="checkbox"/> | Good <input checked="" type="checkbox"/> | Fair <input type="checkbox"/> | Deteriorated <input type="checkbox"/> | Ruins <input type="checkbox"/> | Unexposed <input type="checkbox"/> |
| INTEGRITY | (Check One) | | | (Check One) | | |
| | Altered <input type="checkbox"/> | Unaltered <input checked="" type="checkbox"/> | | Moved <input type="checkbox"/> | Original Site <input checked="" type="checkbox"/> | |

DESCRIBE THE PRESENT AND ORIGINAL (if known) PHYSICAL APPEARANCE

X

Chippokes Plantation consists of a 1403 acre working farm located on the bluffs of the Cobham Bay section of the James River, opposite Jamestown Island. In addition to the agricultural lands, the plantation contains wooded areas and marshes around the two creeks, College Run and Lower Chippokes Creek, which border the property.

The architectural features of Chippokes include a story-and-a-half frame house built circa 1810 in the vicinity of the site of the original seventeenth century plantation house. The interior framing of this house has been exposed for educational purposes. The plantation's present main residence is a two-story brick Greek Revival house built circa 1850. Also included on the property are numerous outbuildings and farm structures.

SEE INSTRUCTIONS

**NATIONAL REGISTER OF HISTORIC PLACES
INVENTORY - NOMINATION FORM**

(Continuation Sheet)

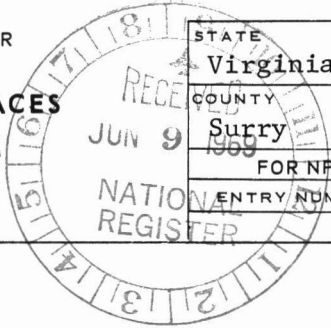

| | |
|-------------------|------|
| STATE Virginia | |
| COUNTY Surry | |
| FOR NPS USE ONLY | |
| ENTRY NUMBER | DATE |

(Number all entries)

- 6. Virginia Historic Landmarks Commission Report #90-3
1968 State
Virginia Historic Landmarks Commission
Room 1116, Ninth Street State Office Building
Richmond, Virginia Code: 45

8. SIGNIFICANCE

PERIOD (Check One or More as Appropriate)

Pre-Columbian 16th Century 18th Century 20th Century
 15th Century 17th Century 19th Century

SPECIFIC DATE(S) (If Applicable and Known)

AREAS OF SIGNIFICANCE (Check One or More as Appropriate)

| | | | | | | | |
|----------------|--------------------------|--------------|--------------------------|----------------|--------------------------|-----------------|-------------------------------------|
| Aboriginal | <input type="checkbox"/> | Education | <input type="checkbox"/> | Political | <input type="checkbox"/> | Urban Planning | <input type="checkbox"/> |
| Prehistoric | <input type="checkbox"/> | Engineering | <input type="checkbox"/> | Religion/Phi- | <input type="checkbox"/> | Other (Specify) | <input checked="" type="checkbox"/> |
| Historic | <input type="checkbox"/> | Industry | <input type="checkbox"/> | losophy | <input type="checkbox"/> | History | <input type="checkbox"/> |
| Agriculture | <input type="checkbox"/> | Invention | <input type="checkbox"/> | Science | <input type="checkbox"/> | _____ | _____ |
| Art | <input type="checkbox"/> | Landscape | <input type="checkbox"/> | Sculpture | <input type="checkbox"/> | _____ | _____ |
| Commerce | <input type="checkbox"/> | Architecture | <input type="checkbox"/> | Social/Human- | <input type="checkbox"/> | _____ | _____ |
| Communications | <input type="checkbox"/> | Literature | <input type="checkbox"/> | itarian | <input type="checkbox"/> | _____ | _____ |
| Conservation | <input type="checkbox"/> | Military | <input type="checkbox"/> | Theater | <input type="checkbox"/> | _____ | _____ |
| | | Music | <input type="checkbox"/> | Transportation | <input type="checkbox"/> | _____ | _____ |

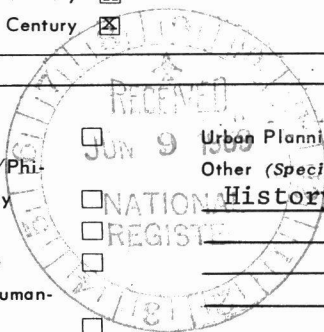

STATEMENT OF SIGNIFICANCE (Include Personages, Dates, Events, Etc.)

Chippokes Plantation was named after an early Indian chief who was friendly to the English settlers and whose domain included the present plantation acreage. The first English owner was Captain William Powell who was a shareholder in the Virginia Company of 1609. By 1625 the present plantation land was patented to Captain Powell or to his estate, as he was supposed to have been killed in an Indian massacre in 1623. In 1643 the plantation reverted to the Crown because the son of Captain William Powell died without issue. The land was then patented to Governor William Berkeley. In 1684 the land belonged to Philip Ludwell, the second husband of Governor Berkeley's widow. The Chippokes Plantation was owned by the Ludwell family, and their descendants bought the property in 1837, probably living in the one and one-half story early-nineteenth century frame house which still stands on the ridge overlooking College Run. In 1858 the two-story brick house, which now serves as the residence of Mrs. Stewart, was built by Mr. Jones.

Chippokes is particularly significant because it was one of the earliest plantations, and was well known for its rich flourishing fruit trees. In addition, two excellent early and mid-nineteenth century buildings remain on the land. The extensive gardens and the beautiful view of the James River are impressive.

SEE INSTRUCTIONS

9. MAJOR BIBLIOGRAPHICAL REFERENCES

Riley, Edward M., "Chippokes Plantation," unpublished manuscript, Colonial Williamsburg, Inc., Williamsburg, Virginia.
 Stephenson, Mary A., Old Homes in Surry and Sussex. Richmond: The Dietz Press, 1942.

17/348530/4109990
 17/348590/4112550
 17/344780/4112620
 17/344740/4110060
 UTM REF
 11-20-75000-
 SEE INSTRUCTIONS

10. GEOGRAPHICAL DATA

| LATITUDE AND LONGITUDE COORDINATES DEFINING A RECTANGLE LOCATING THE PROPERTY | | | O R | LATITUDE AND LONGITUDE COORDINATES DEFINING THE CENTER POINT OF A PROPERTY OF LESS THAN ONE ACRE | | |
|----------------------------------------------------------------------------------|-------------------------|-------------------------|--------|--------------------------------------------------------------------------------------------------------|-------------------------|--|
| CORNER | LATITUDE | LONGITUDE | | LATITUDE | LONGITUDE | |
| | Degrees Minutes Seconds | Degrees Minutes Seconds | | Degrees Minutes Seconds | Degrees Minutes Seconds | |
| NW | 37° 08' 58" | 76° 44' 53" | | ° ' " | ° ' " | |
| NE | 37° 08' 58" | 76° 42' 14" | | ° ' " | ° ' " | |
| SE | 37° 07' 32" | 76° 42' 14" | | ° ' " | ° ' " | |
| SW | 37° 07' 32" | 76° 44' 53" | | ° ' " | ° ' " | |

LIST ALL STATES AND COUNTIES FOR PROPERTIES OVERLAPPING STATE OR COUNTY BOUNDARIES

| STATE: | CODE | COUNTY | CODE |
|--------|------|---------|------|
| | | | |
| STATE: | CODE | COUNTY: | CODE |
| | | | |
| STATE: | CODE | COUNTY: | CODE |
| | | | |
| STATE: | CODE | COUNTY: | CODE |
| | | | |

11. FORM PREPARED BY

NAME AND TITLE:
 Staff, Virginia Historic Landmarks Commission, James W. Moody, Jr., Director

ORGANIZATION: Virginia Historic Landmarks Commission

DATE: May 2, 1969

STREET AND NUMBER:
 Room 1116, Ninth Street State Office Building

CITY OR TOWN: Richmond

STATE: Virginia

CODE: 45

12. STATE LIAISON OFFICER CERTIFICATION

As the designated State Liaison Officer for the National Historic Preservation Act of 1966 (Public Law 89-665), I hereby nominate this property for inclusion in the National Register and certify that it has been evaluated according to the criteria and procedures set forth by the National Park Service. The recommended level of significance of this nomination is:

National State Local

Name: Edw P. Alexander per form
 Dr. Edward P. Alexander, Chairman

Title: Virginia Historic Landmarks Comm.

Date: June 2, 1969

NATIONAL REGISTER VERIFICATION

I hereby certify that this property is included in the National Register.

Ernest Allen Connally
 Chief, Office of Archeology and Historic Preservation

Date: OCT 1 1969

ATTEST:

William J. Murtagh
 Keeper of The National Register

Date: SEP 29 1969

UNITED STATES DEPARTMENT OF THE INTERIOR
NATIONAL PARK SERVICE

NATIONAL REGISTER OF HISTORIC PLACES

PROPERTY MAP FORM

(Type all entries - attach to or enclose with map)

STATE

Virginia

COUNTY

Surry

FOR NPS USE ONLY

ENTRY NUMBER

DATE



SEE INSTRUCTIONS

1. NAME

COMMON: Chippokes Plantation
AND/OR HISTORIC: Chippokes

2. LOCATION

STREET AND NUMBER: South bank of James River between College Run on the west
and Lower Chippokes Creek on the east, opposite Jamestown Island.
CITY OR TOWN:

STATE:

Virginia

CODE

45

COUNTY:

Surry

CODE

181

3. MAP REFERENCE

SOURCE:

U.S.G.S. 7.5', quadrangle Hog Island

SCALE: 1:24000

DATE: 1965

4. REQUIREMENTS

TO BE INCLUDED ON ALL MAPS

1. Property boundaries where required.
2. North arrow.
3. Latitude and longitude reference.

COBHAM BAY



NW
lat. $37^{\circ}08'58''$
long. $76^{\circ}44'53''$

NE
lat. $37^{\circ}08'58''$
long. $76^{\circ}42'14''$

SW
lat. $37^{\circ}07'32''$
long. $76^{\circ}44'53''$

SE
lat. $37^{\circ}07'32''$
long. $76^{\circ}42'14''$

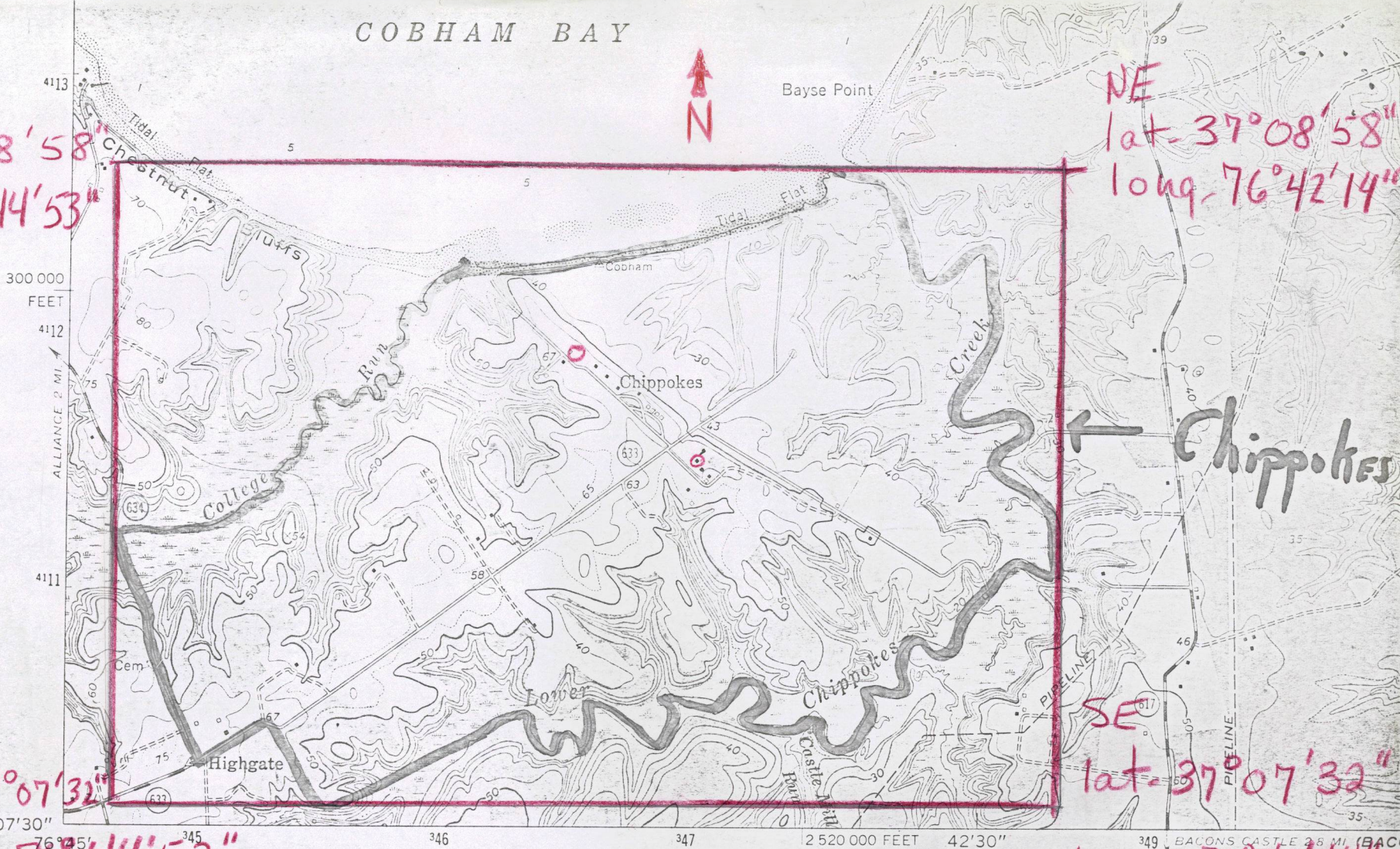

Mapped, edited, and published by the Geological Survey

Control by USGS and USC&GS

Topography by photogrammetric methods from aerial photographs taken 1963 Field checked 1965
Supersedes Army Map Service Cobham Bay map dated 1957

Selected hydrographic data compiled from USC&GS Chart 529 (1964)
This information is not intended for navigational purposes

Polyconic projection. 1927 North American datum
10,000-foot grid based on Virginia coordinate system, south zone
1000-meter Universal Transverse Mercator grid ticks.
zone 18. shown in blue

Fine red dashed lines indicate selected fence and field lines where generally visible on aerial photographs. This information is unchecked

(RUNNYMEDE)
5658 III SE

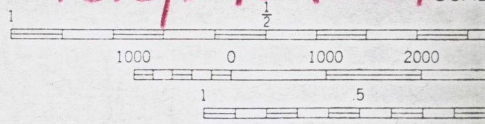
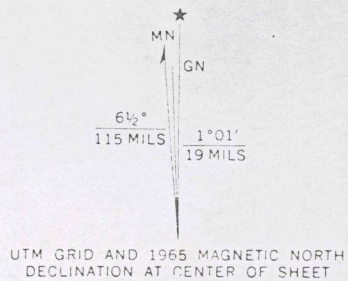

CONTOUR 1
DOTTED LINES REP
DATUM IS
DEPTH CURVES AND SOUNDINGS
SHORELINE SHOWN REPRESENTS TO
THE MEAN RANGE OF T
THIS MAP COMPLIES WITH N
FOR SALE BY U.S. GEOLOGIC/
AND VIRGINIA DIVISION OF MINERAL
A FOLDER DESCRIBING TOPOGRAPHIC M