

VLR-3-14-01  
NRHP-5-16-02

United States Department of the Interior  
National Park Service

NATIONAL REGISTER OF HISTORIC PLACES  
REGISTRATION FORM

This form is for use in nominating or requesting determinations for individual properties and districts. See instructions in *How to Complete the National Register of Historic Places Registration Form* (National Register Bulletin 16A). Complete each item by marking "X" in the appropriate box or by entering the information requested. If any item does not apply to the property being documented, enter "N/A" for "not applicable." For functions, architectural classification, materials, and areas of significance, enter only categories and subcategories from the instructions. Place additional entries and narrative items on continuation sheets (NPS Form 10-900a). Use a typewriter, word processor, or computer, to complete all items.

1. Name of Property

historic name Manchester Residential and Commercial Historic District (127-0859)

other names/site number \_\_\_\_\_

2. Location

street & number 900, 1201 & 1501 Decatur Street, 901 thru 1625 Hull Street, 1007 thru 1428 Bainbridge Street, 921 thru 1522 Porter Street, 1210 thru 1518 Perry Street, 104, 106-112 and 116-118 Cowardin Avenue, 14, 209-211 W. 11<sup>th</sup> Street, 5, 7, 12-14, E. 12<sup>th</sup> Street, 115, 214-216 W. 12<sup>th</sup> Street, 208 and 209 W. 13<sup>th</sup> Street, 211 and 309 W. 14<sup>th</sup> Street, 111, 204, 205, 209, 211 and 212 W. 15<sup>th</sup> Street not for publication N/A

city or town City of Richmond

vicinity N/A

state Virginia

code VA

county Richmond (Independent City)

code 760

zip code 23224

3. State/Federal Agency Certification

As the designated authority under the National Historic Preservation Act of 1966, as amended, I hereby certify that this  nomination  request for determination of eligibility meets the documentation standards for registering properties in the National Register of Historic Places and meets the procedural and professional requirements set forth in 36 CFR Part 60. In my opinion, the property  meets  does not meet the National Register Criteria. I recommend that this property be considered significant  nationally  statewide  locally. (  See continuation sheet for additional comments.)

M. Catherine Allen  
Signature of certifying official/Title

March 29, 2002  
Date

Director, Virginia Department of Historic Resources  
State or Federal agency and bureau

In my opinion, the property  meets  does not meet the National Register criteria. (  See continuation sheet for additional comments.)

\_\_\_\_\_  
Signature of certifying official/Title

\_\_\_\_\_  
Date

\_\_\_\_\_  
State or Federal agency and bureau

4. National Park Service Certification

I, hereby certify that this property is:

- entered in the National Register
  - See continuation sheet.
- determined eligible for the National Register
  - See continuation sheet.
- determined not eligible for the National Register
- removed from the National Register
- other (explain) \_\_\_\_\_

\_\_\_\_\_  
Signature of the Keeper

\_\_\_\_\_  
Date of Action

**5. Classification**

Ownership of Property  
(Check as many boxes as apply)

Category of Property  
(Check only one box)

Number of Resources within Property  
(Do not include previously listed resources in the count)

- private
- public-local
- public-State
- public-Federal

- building(s)
- district
- site
- structure
- object

Contributing	Non-contributing	
214	33	buildings
0	0	sites
0	0	structures
0	0	objects
214	33	Total

Name of related multiple property listing  
(Enter "N/A" if property is not part of a multiple property listing.)  
N/A

Number of contributing resources previously listed  
in the National Register  
1 (127-5010)

**6. Function or Use**

**Historic Functions**

(Enter categories from instructions)

DOMESTIC: single dwelling, multiple dwelling

COMMERCE/TRADE: business, specialty store, restaurant

SOCIAL: meeting hall

GOVERNMENT: post office, courthouse

EDUCATION: school

RELIGION: church, church school, church related residence

RECREATION & CULTURE: theater

**Current Functions**

(Enter categories from instructions)

DOMESTIC: single dwelling, multiple dwelling

COMMERCE/TRADE: business, specialty store, restaurant

SOCIAL: meeting hall

GOVERNMENT: police station, courthouse

RELIGION: church, church school, church residence

RECREATION & CULTURE: theater

**7. Description**

**Architectural Classification**

(Enter categories from instructions)

Colonial: Georgian

Mid-19th Century: Greek Revival, Gothic Revival, Other

Late Victorian: Italianate, Queen Anne, Romanesque, Gothic

Late 19th & 20th Century: Commercial, American 4-square

Modern Movement: Modern, Art Deco

**Materials**

(Enter categories from instructions)

foundation: BRICK, CONCRETE, STONE

walls: WOOD: Weatherboard

BRICK, STONE

roof: SLATE, OTHER: Standing Seam

other: N/A

**Narrative Description**

(Describe the historic and current condition of the property on one or more continuation sheets.)

**8. Statement of Significance**

**Applicable National Register Criteria**

(Mark "x" in one or more boxes for the criteria qualifying the property for National Register listing)

- A** Property is associated with events that have made a significant contribution to the broad patterns of our history.
- B** Property is associated with the lives of persons significant in our past.
- C** Property embodies the distinctive characteristics of a type, period, or method of construction or represents the work of a master, or possesses high artistic values, or represents a significant and distinguishable entity whose components lack individual distinction.
- D** Property has yielded, or is likely to yield, information important in prehistory or history.

**Criteria Considerations**

(Mark "X" in all the boxes that apply.)

Property is:

- A** owned by a religious institution or used for religious purposes.
- B** removed from its original location.
- C** a birthplace or a grave.
- D** a cemetery.
- E** a reconstructed building, object, or structure.
- F** a commemorative property.
- G** less than 50 years of age or achieved significance within the past 50 years.

**Areas of Significance**

(Enter categories from instructions)

- ARCHITECTURE
- COMMERCE
- COMMUNITY PLANNING & DEVELOPMENT
- EDUCATION
- ENTERTAINMENT & RECREATION
- ETHNIC HERITAGE
- POLITICS/GOVERNMENT
- RELIGION

**Period of Significance**

1797-1950

**Significant Dates**

- 1797 Earliest surviving building
- 1871 becomes seat of Chesterfield County
- 1874 Manchester City Charter
- 1910 Manchester Consolidates with Richmond

**Significant Person**

(Complete if Criterion B is marked above)  
N/A

**Cultural Affiliation**

N/A

**Architect/Builder**

Builders/Contractors: Allen J. Saville, J.A. Clay  
Graham Construction Company  
Architects: Charles Robinson, J. Binford Walford,  
D. Wiley Anderson, Albert West

**Narrative Statement of Significance**

(Explain the significance of the property on one or more continuation sheets.)

**9. Major Bibliographical References**

**Bibliography**

(Cite the books, articles, and other sources used in preparing this form on one or more continuation sheets.)

**Previous documentation on file (NPS)**

- preliminary determination of individual listing (36 CFR 67) has been requested.
- previously listed in the National Register
- previously determined eligible by the National Register
- designated a National Historic Landmark
- recorded by Historic American Buildings Survey # \_\_\_\_\_
- recorded by Historic American Engineering Record# \_\_\_\_\_

**Primary Location of Additional Data**

- State Historic Preservation Office
  - Other State agency
  - Federal agency
  - Local government
  - University
  - Other
- Name of repository : \_\_\_\_\_

Manchester Residential and Commercial Historic District  
Name of Property

Richmond (Independent City), VA  
County and State

**10. Geographical Data**

**Acreage of Property** Approximately 75 acres

**UTM References**

(Place additional UTM references on a continuation sheet)

1	<u>18</u>	<u>283,740</u>	<u>4,155,740</u>	3	<u>18</u>	<u>284,150</u>	<u>4,155,480</u>
	Zone	Easting	Northing		Zone	Easting	Northing
2	<u>18</u>	<u>283,640</u>	<u>4,155,960</u>	4	<u>18</u>	<u>284,300</u>	<u>4,155,290</u>
					X	See continuation sheet.	

**Verbal Boundary Description**

(Describe the boundaries of the property on a continuation sheet.)

**Boundary Justification**

(Explain why the boundaries were selected on a continuation sheet.)

**11. Form Prepared By**

name/title Bill Laffoon

organization \_\_\_\_\_ date 28 November 2000

street & number 303 North 19<sup>th</sup> Street telephone 804-649-8068

city or town Richmond state VA zip code 23223

**Additional Documentation**

Submit the following items with the completed form:

**Continuation Sheets**

**Maps**

A **USGS map** (7.5 or 15 minute series) indicating the property's location.

A **Sketch map** for historic districts and properties having large acreage or numerous resources.

**Photographs**

Representative **black and white photographs** of the property.

**Additional Items**

(Check with the SHPO or FPO for any additional items)

**Property Owner**

(Complete this item at the request of the SHPO or FPO.)

name See completed Owner of Record form and attached mailing labels

street & number \_\_\_\_\_ telephone \_\_\_\_\_

city or town \_\_\_\_\_ state \_\_\_\_\_ zip code \_\_\_\_\_

**Paperwork Reduction Act Statement:** This information is being collected for applications to the National Register of Historic Places to nominate properties for listing or determine eligibility for listing, to list properties, and to amend existing listings. Response to this request is required to obtain a benefit in accordance with the National Historic Preservation Act, as amended (16 U.S.C. 470 et seq.).

**Estimated Burden Statement:** Public reporting burden for this form is estimated to average 18.1 hours per response including the time for reviewing instructions, gathering and maintaining data, and completing and reviewing the form. Direct comments regarding this burden estimate or any aspect of this form to the Chief, Administrative Services Division, National Park Service, P.O. Box 37127, Washington, DC 200137127; and the Office of Management and Budget, Paperwork Reduction Project (10240018), Washington, DC 20503.

**U. S. Department of the Interior  
National Park Service**

**National Register of Historic Places  
Continuation Sheet**

Section number   7   Page   1  

Manchester Residential and Commercial Historic District  
Richmond, Virginia

**SUMMARY DESCRIPTION**

The Manchester Residential and Commercial Historic District is located in the city of Richmond, Virginia, on the south side of the James River. It is linked to the central business district by the Lee, Mayo and Manchester bridges. Situated on a rise three blocks above the south bank of the James River, the district encompasses a significant concentration of mid-nineteenth and early-twentieth century, residential and commercial buildings from the former city of Manchester. Manchester began as an English settlement after 1609, and later became a port for the tobacco trade. In the 1800's, Manchester along with Richmond, had become a major port and commercial center serving the eastern seaboard and beyond. Manchester was granted city status in 1874, thus becoming the seat of Chesterfield County. In 1910, Manchester was consolidated into the city of Richmond. The Manchester Residential and Commercial Historic District is generally bounded by Hull Street on the south; Commerce Road on the east and Cowardin Avenue on the west. Hull Street is devoted primarily to commercial and governmental buildings. Bainbridge, Porter and Perry streets, parallel to and north of Hull Street are devoted primarily to residential buildings with a number of historic churches and schools. The district contains 248 buildings, one of which—the Manchester Courthouse—is already listed in the National Register and thirty-three of which are noncontributing. The district's architecture is impressive for its variety of late nineteenth and early-twentieth-century building types and styles.

**ARCHITECTURAL ANALYSIS**

Although Manchester's history dates to the Colonial period and earlier, most of the buildings in the district are from the late-nineteenth and early-twentieth centuries. The development of Manchester in the early-eighteenth century was primarily along the James River and Manchester Canal--included in the Manchester Industrial Historic District (NRHP). From the early-eighteenth century until the late-nineteenth century, Manchester's growth spread to the south and west in the form of scattered, frame, residential and commercial structures. These early buildings were replaced in the late-nineteenth and early-twentieth centuries by more substantial commercial and residential buildings.

**1790 to 1860**

Prior to 1790, Manchester's development was primarily influenced by its setting on the south bank of the James River across from Richmond. The tobacco trade was the industry that built Manchester. A 1781 map entitled "A Skirmish at Richmond" and recorded by a British officer in his journal shows warehouses, cleared roads and cultivated fields in Manchester. The Micajah Bates Map of 1835 clearly delineates Manchester's street grid, including the historic district, as it extended south from the James River, and the building development along the grid. Within the district there are four significant buildings that were built before the Civil War.

**U. S. Department of the Interior  
National Park Service**

**National Register of Historic Places  
Continuation Sheet**

Section number   7   Page   2  

Manchester Residential and Commercial Historic District  
Richmond, Virginia

*Georgian Dwellings*

The earliest building in the district is the Archibald Freeland House, 1015 Bainbridge Street. The house, built before 1797 is a two-story, red brick, Georgian-style dwelling with a raised basement and a molded brick water table. The building features Flemish bond brickwork, four large chimneys, and a hipped roof. An interesting feature of the house is the keystones in the jack arches that are made of bricks set in relief and not covered with plaster. A Victorian era porch has been added across the facade of the house, replacing the original two-story porch depicted on a 1803 Mutual Assurance policy. Another surviving Georgian-style dwelling is the Dr. Thomas D. Jones House, 115 West 12th Street. It was built, prior to 1811, by Thomas Treadway. Dr. Jones, a well-known Manchester physician, purchased the house in 1912. The two-story dwelling with a raised basement and a molded brick water table is constructed of brick laid in a Flemish bond pattern. It features plastered brick jack arches with keystones at the openings. A major yellow brick addition of was built in 1897.

*Greek Revival Churches and Dwellings*

Bainbridge Baptist Church, 1101 Bainbridge Street, completed in 1857, is a Greek Revival-style, brick, two-story structure with a raised basement. The three-bay, front portico has two-story, Ionic columns that support an Ionic entablature. The tympanum is decorated with a cartouche and garlands. The columns are set on pedestals that rise from the steps leading to the portico. The main body of the church is divided into three-bays by pilasters and covered with a pedimented-front gable roof. There are three entries, paired doors with transoms above, leading to the sanctuary. Pilasters also define the six-bay sides with stained glass windows at each bay. The church was remodeled and modernized in 1901. Built prior to 1859, the Turner-Baldwin House, 1209 Porter Street, is a two-story, red brick, Greek Revival-style residence with a raised basement. The house also displays some early Italianate influences in the floor-to-ceiling windows in the first story and the paneled frieze. A one-story, three-bay wide, Classical Revival-style porch with Ionic columns, modillions and a turned baluster railing has been added to the house. The builder of the house and its exact date of construction are unknown, but in November 1859 the property was sold to Esther Lazendre, a free black woman, to be held in trust by her son Solomon Turner. According to the deed, Esther Lazendre had resided in the house for a number of years. By 1902, the residence was the property of Alma Baldwin. The John B. Anderson House, 12-14 East 12th Street, built prior to 1860, is a 1 ½-story frame dwelling. The house is one-room deep with one-story additions at the side and rear. There are two large central chimneys and two wall dormers in the steeply pitched gable roof. The house sits on a lot most closely associated with Farmer's Tavern an early hostelry built on Hull Street in the late eighteenth century and demolished around 1913. The Anderson House is a surviving example of the frame buildings once found scattered throughout Manchester.

1861 to 1865

There are no buildings remaining in the district that were built during the turbulent years of the Civil War. Manchester, because of its proximity to Richmond, its industrial base, and its transportation links became consumed in the conflict. On August 9, 1862, Harpers Weekly published a map of Richmond and Manchester, from a drawing by a refugee just escaped from "Secessia". This map clearly illustrates Manchester's street grid with its connections to Richmond and the surrounding county. An 1865 Confederate Engineers' map of Manchester illustrates building development along the town's street grid as well as the fortifications protecting Richmond and

**U. S. Department of the Interior  
National Park Service**

**National Register of Historic Places  
Continuation Sheet**

Section number   7   Page   3  

Manchester Residential and Commercial Historic District  
Richmond, Virginia

Manchester. The nearby Confederate Naval Yard, railroads, Mayo's Bridge and roads connecting Manchester with Richmond illustrate the importance of Manchester's location in this period. Richmond, north of the river, was burned at the end of the War. The bridges crossing the James River to Manchester were also burned by the retreating Confederate Army, this may have contributed to the survival of buildings in Manchester. A map published by the Richmond Whig newspaper shows the burned district after the evacuation fire of 1865.

1866 to 1917

The majority of buildings that remain in the historic district were constructed between 1866 and 1917. Recovery and reconstruction in the years following the Civil War came slowly. The 1876 Beer's Atlas of Manchester shows the limited development of scattered residential buildings along Bainbridge, Porter and Perry Streets. Residential and commercial buildings fronted Hull Street. An isometric drawing illustrates the local style of the scattered one and two-story frame buildings, most common in 1869. By 1874, Manchester's population had reached 3,207 citizens, increasing to 5,729 in 1880. Flour from Manchester's mills was widely exported, with business from railroads, shipping and manufacturing moving the economy. This new prosperity generated the bulk of development that remains in the historic district today. The Sanborn Maps of 1895, 1905 and 1910 illustrate the development of buildings that replaced the older scattered structures and infilled open lots to create the dense urban neighborhood visible today.

Along Bainbridge, Porter, Perry and the numbered cross streets, residences are the predominant building type with a few scattered schools and churches. Hull Street is dominated by commercial buildings. Churches are the dominant building type on Cowardin Avenue and Decatur Street. The residential structures are primarily detached, wood dwellings with Italianate and Queen Anne being the favored architectural styles. The commercial buildings are primarily attached, brick structures constructed in the Italianate, Colonial Revival and commercial vernacular-styles of architecture. The churches and schools are detached structures and brick is the most common building material. Gothic Revival and Romanesque were popular styles for these institutional buildings.

*Italianate Dwellings*

Several surviving residences illustrate these architectural trends. The Ingram House, 1201 Porter Street, built in 1876, is the earliest Italianate-style dwelling remaining in the historic district. The two-story, three-bay wide, brick dwelling has a recessed wing to the side. The windows in the first story are full height. The one-story, three-bay wide, full width front porch is cast iron, one of two such porches in the Manchester historic. The wood cornice has brackets, dentils, and alternating panels and decorative vents. The other dwelling with a cast iron porch is found at 1109 Bainbridge Street. Built in 1886, it is a two-story brick, Italianate, detached-house. The windows have hoods and there are brackets and decorative vents in the wood cornice. The cast iron, one-story, three-bay front porch is the most significant feature. A two-story brick addition was built in 1905 to the rear of the house and a modern two-story frame addition followed.

There are two attached dwellings, built in 1910, which demonstrate the continued influence of Italianate architecture. The attached, brick, Italianate-style houses at 1100, 1102 and 1104 Bainbridge Street, built 1910, are a well-preserved group. The center building, 1102, projects slightly thus emphasizing a three-bay unifying rhythm

U. S. Department of the Interior  
National Park Service

National Register of Historic Places  
Continuation Sheet

Section number 7 Page 4

Manchester Residential and Commercial Historic District  
Richmond, Virginia

---

for the group. The details for each dwelling are similar. Each dwelling is three-bays wide with an entrance door and transom at one end and floor-to-ceiling, double-hung windows in the first story. All of the windows have stone lintels and sills. The wood cornice has modillions, dentils, and alternating panels and decorated vents. The Classical Revival-style, one-story, front porches are three-bays wide with ionic columns set on wood pedestals. The porch railings have turned balusters and the cornice has modillion blocks. The dwellings located at 1200, 1202, 1204 and 1206 Bainbridge Street, built 1910, are brick, attached Italianate multi-family residences. Each dwelling is three-bays wide with side entry and floor-to-ceiling windows in the first story. The windows have stone lintels and sills. The wood cornice has modillions, dentils, and alternating panels and decorated vents. The deteriorated, one-story, Classical Revival-style porches are three-bays wide with tapered wood columns set on wood pedestals. The porch cornice has modillions and dentils. There is a decorative brick belt course at the second story window sills and saw tooth soldier course belt course at the second story window lintels. Above which are alternating plain and glazed stretchers that create a polychrome effect.

*Queen Anne Dwellings*

Queen Anne, of which there are many fine examples in brick and frame, is the predominant architectural style found in the district. The building located at 1300-1302 Bainbridge Street, built 1895, is an attached, Queen Anne-style, brick, two-story multi-family dwelling. The entry is located in the recessed center bay, creating the appearance of two detached dwellings. Each dwelling, excluding the center recess, is three bays wide. In the first story, the off set entry doors have sidelights and transoms and the two windows extend from floor to ceiling. The two side-bays have matching one-story, three-bay, porches. The porches have turned posts, brackets and a spindle work frieze below the roof line that is distinctly Queen Anne style. There is a mansard roof covered with decorative slate. Another fine Queen Anne row is found at 1301, 1303, and 1305 Bainbridge Street. This row, built 1895, is a well-preserved group of attached, two-story, brick dwellings that present a unified facade. Each dwelling is three bays wide with a projecting side entry tower that breaks the rhythm of the facade. The windows have double-hung sash and stone sills and lintels. The first-story windows extend from floor to ceiling. The side-bay towers have paired entry doors and each tower is capped with a pediment roof, of differing designs, and metal cresting. Recessed behind the towers are decorative slate mansard roofs with continuous cresting. At each tower projection there is a one-story, three-bay porch, a bay of which projects with the tower. The porches are capped with roofs of various designs. Most of the porches have turned posts, brackets and a spindle-work frieze.

There are several examples of frame Queen Anne-style dwellings in the district. The row of two-story, detached dwellings found at 1307, 1311, 1317, and 1319 Bainbridge Street illustrates the variety of forms and details found in the Queen Anne style. The house at 1300 Perry Street, built 1906, is a two-story frame Queen Anne dwelling and one of the few in the district with a one-story, wraparound porch. The porch has turned posts with brackets and spindle work supporting a cornice with dentils. The front-gable end of this dwelling has a decorative vent in the attic. The houses at 1415 and 1417 Perry Street, are excellent examples of two-story, Queen Anne-style, single-family frame dwellings in the historic district. The Ligouri House, located at 1415 Perry Street, and built in 1905 is almost identical to the residence at 1417 Perry Street. The three-bay, two-story, front-gables have decorative vents in the attic. Both have three-bay, one-story porches with turned posts, brackets and spindle friezes. The grouping of Queen Anne-style, single-family dwellings at 1505, 1507, and 1509 Perry Street displays a variety of the details associated with the style. All of these dwellings, built 1905, are two-story, three-bays wide, with front-gables and one-story, full-width porches. The houses at 1507 and 1509 have side entrances that are recessed behind arched openings and feature Palladian windows in the front-gable ends at the attic level. The first floor windows at 1505



**U. S. Department of the Interior  
National Park Service**

**National Register of Historic Places  
Continuation Sheet**

Section number 7 Page 5

**Manchester Residential and Commercial Historic District  
Richmond, Virginia**

---

and 1507 extend to the floor with transoms at the head and the upper window sashes at the second floor are patterned.

The residences at 1104, 1106, 1108, and 1110 Porter Street, are a varied group of two-story, frame dwellings, all built in 1895, that illustrate the predominance of the Queen Anne-style architecture in the historic district. Number 1104 Porter Street is a three-bay wide dwelling with a low, hipped roof. The one-story, full-width porch has turned posts and brackets. The house at 1106 Porter Street is a three-bay wide, Queen Anne dwelling with gable front. The projecting gable front roof is supported by brackets and timbering, and finished with vertical wood. The one-story, three-bay wide, full-width porch has turned posts, brackets and a fine spindle work. The house at 1108 Porter is four-bays wide with a projecting bay and a bracketed cornice. It has a one-story, three-bay wide porch with turned posts, brackets and a spindle work frieze. The building at 1110 Porter is a gable-front, Queen Anne-style dwelling with a Palladian window at the attic story.

The dwellings at 1407, 1409, 1411, and 1419 Porter Street, all built in 1905, are two-story, frame Queen Anne dwellings that illustrate the wide variety of characteristics associated with the style. Number 1407 Porter is a three-bay, gable-front dwelling with a one-story wraparound porch. The porch has turned posts, brackets and a spindle work frieze. Number 1409 Porter has a centered, two-story, projecting, front-gable bay with paired windows. The projecting front-gable roof has half timbering and fine scroll work. Number 1411 Porter is a three-bay wide, gable front dwelling with a one-story, full-width porch. The porch has turned posts, brackets and scroll work with a pediment above the entry bay. Number 1419 Porter is a three-bay wide, gable-front dwelling with a Palladian window in the gable at the attic story. The one-story, three-bay wide porch has turned posts, brackets and a spindle work frieze.

A unique multi-family dwelling in the historic district is located at 212 and 214 West 15th Street. Built in 1905, 212 West 15th Street originally had a shallow hipped roof. When 214 was built later and attached to 212, the facade was altered so that the entire structure resembled a Queen Anne-style double house. There is a five-bay, full width, one-story porch with turned posts. The three center bays have a front gable roof with projecting brackets and scroll work at the top of the gable. The gable is finished with diagonal wood siding.

#### *Colonial Revival Dwellings*

Two fine examples of two-story, Colonial Revival-style, brick dwellings are found at 1012 and 1014 Porter Street. The house at 1012 was built 1919 and 1014 was built 1915. Both have slate mansard roofs and one-story, full width porches. The facade at 1012 is two bays wide with a tripartite window and entry with a narrow window at the first story and double windows above at the second story. At 1012 the porch is two bays wide with a pedimented roof at the entry bay and there are two, double-windowed, pedimented dormers in the mansard. The house at 1014 has a two-bay wide porch and one, tripartite-windowed, pedimented dormer in the mansard.

The 1500 block of Porter Street contains a collection of large, brick single-family dwellings, all built in 1910 and 1911. Number 1503 and 1505 is a four-bay wide, Queen Anne-style, attached-dwelling with cylindrical towers at the corner bays. The towers are capped with conical slate roofs set in front of a polychrome slate mansard roof. The dwelling at 1509 Porter is a two-bay wide Colonial Revival-style building. The two-bay, one-story porch has a projecting entry bay with pedimented roof. The windows are triple sashes with elliptical fanlight transoms. There is a gable front at the roof above the tripartite windows and a dormer in the mansard roof above the entry bay.

**U. S. Department of the Interior  
National Park Service**

**National Register of Historic Places  
Continuation Sheet**

Section number 7 Page 6

Manchester Residential and Commercial Historic District  
Richmond, Virginia

---

Number 1511 Porter is a two-bay wide dwelling with a projecting tower, capped with a slate mansard roof and metal cresting. The one-story porch has classical columns supporting a cornice with modillions and metal cresting above. The facade has two, double-hung windows with stone heads at each story and is capped with a slate mansard roof and metal cresting. Number 1513 Porter Street is a two-bay wide dwelling with a slate mansard and metal cresting above. The full width, one-story porch has classical columns and modillion trim at the roof. There is a projecting window bay at the second story and two dormers set in the mansard roof.

*Vernacular Dwellings*

Vernacular dwellings are those buildings that have a traditional form and are generally devoid of any stylistic or character defining features. One such building, 14 West 11th Street, built in 1886, is a vernacular, two-story frame dwelling. It has a shallow hipped roof and there is a large central chimney. This two-story dwelling connects to an earlier one story structure at the rear. Another example of a vernacular dwelling is found at 208 West 13th Street, built 1905. It is a one-story dwelling with a hipped roof, central chimney and a utilitarian, two-bay wide porch.

*Commercial Buildings*

In this period, Hull Street remained the commercial artery, serving Manchester and connecting Southside Virginia with Richmond and trade on the James River. New government and commercial buildings emerged here creating an urban landscape oriented to the street grid. The commercial buildings created a unified street facade while the government buildings dominated a city block or a major intersection.

The Beattie Block, 1119 to 1125 Hull Street, built in 1887, is the earliest commercial building in the district. It was designed by architect D. Wiley Anderson. It is a three-story, four-bay, brick Italianate commercial building with storefront bays at the first story. Brick pilasters define each of the bays in the upper two stories and there are three, double-hung windows (in each bay and each story) with stone sills and hooded lintels. The wood cornice has brackets, decorated vents and panels. There is a stone in the center pilaster, inscribed with "The Beattie Block 1887". The storefronts have been altered and the upper floors are vacant.

The Baldwin Building, 1209 Hull Street, built 1905, is a three-story, brick Italianate department store building, with a three-bay facade. At the first story, wood pilasters defining three storefront bays extend to a full width spandrel separating the first and second stories. The wide center storefront bay is recessed with display windows on each side. The two outside storefront bays have fixed display windows. At the upper floors there are four equal bays defined by brick pilasters extending to round brick arches with keystones under a corbeled brick belt course just below the brick cornice. The design of the corbeled brick cornice emulates brackets. The upper windows are double-hung, and the third-story windows have round heads.

Number 1309 and 1311 Hull Street, built in 1895, is a two-story, brick commercial building, constructed in the Beaux Arts style. The second-floor facade is seven-bays wide defined by pairs of castiron Corinthian columns set on pedestals supporting a heavy entablature with panels and brackets. This is one of the few metal storefronts found in the district.

U. S. Department of the Interior  
National Park Service

**National Register of Historic Places  
Continuation Sheet**

Section number 7 Page 7

Manchester Residential and Commercial Historic District  
Richmond, Virginia

---

*Institutional Buildings*

The Manchester Courthouse, 920 Hull Street, built in 1871, dominates the entire block. The block is bounded by Hull, Decatur, 9th and 10th Streets, with the courthouse located in the center. The one-story, brick, Colonial Revival-style courthouse has a Tuscan portico with paired columns supporting a pedimented porch roof. The original front facing Hull Street is three-bays wide with the portico in the center bay flanked by double-hung windows with projecting lintels supported by consoles. A pediment with wood cornice and modillions defines the gable-end front and the building has brick quoins at the corners. The pediment at the front has a false round window to the attic. Albert West was the architect, V. J. Cutter was the general contractor, J. H. Ragland was the mason, and Edward Gallagher was the plasterer. Additions to the original courthouse were built in 1923, 1940 and 1969. The Manchester Courthouse is presently on the state and national registers. The Manchester Post Office, 1019 Hull Street, built 1910, is a one-story, brick and stone, Georgian Revival building with a raised basement. The building foundation is coursed granite and the upper portion is Flemish-bond brick with stone quoins at the corners. The five-bay facade has a center entry with a semi-circular stone arch, a sculpted panel, and two double-hung windows with stone sills and keystone lintels on each side. There are stone panels with garlands above each window. The entablature is stone with modillions below the cornice. Stone balustrade with interspersed pedestals surround the roof.

New churches were built, some replacing earlier buildings to accommodate the growing population. Meade Memorial Episcopal Church, 1201 Decatur Street, built in 1869, is a one-story, frame, Gothic Revival church. It has a gable-end front with a center projecting vestibule and a steeple with a pyramidal roof. The steeple has pointed-arch openings at the sides. The side of the church, five-bays deep, is defined by buttresses and pointed-arch windows with stained glass. The unusual wood buttresses are covered with alternating courses of square, butt-cut and pointed-cut wood shingles.

Cowardin Avenue Christian Church, 116 and 118 Cowardin Avenue, built in 1891, is a one-story, brick, Gothic Revival church with a raised basement. The gable-end front has a three-bay vestibule with a projecting center bay. The projecting center bay has three pointed-arch windows. The two side bays have pairs of pointed-arch doors leading into the church. There are pilasters at the corners and corbeled brick at the edge of the sloped roof at the gable-end front. A round window is set high in the gable-end facade. The sides of the church have six bays defined by pilasters and pointed-arch windows. A rear addition was constructed in 1906.

Decatur Street Methodist-Episcopal Church South, 900 Decatur Street, built in 1910, is a 1 1/2-story, red brick, Gothic Revival-style building. It has a gable front with a projecting, center bay and a three-story belfry tower at the side. The projecting bay at the front of the church has a tripartite, rectangular, stained glass window. The front walls on each side of the projecting center bay have a single, rectangular, stained glass window. Entry to the church is through a pair of doors centered in the belfry tower. The two stories above in the tower are defined by stone belt courses. Both stories have windows and the tower is capped with battlements. There are brick buttresses at the corners to support the tower. The rear, one-story Sunday School room, with a curved brick wall, was built before 1905. The main Church sanctuary was constructed later.

First Baptist Church, South Richmond, 1501 Decatur Street, built in 1892, a large, two-story, brick, Romanesque Revival building has a gable-end front with a bell tower at the corner. The church has stone belt courses between the first and second stories and a one-story entry vestibule centered in the facade. The vestibule has three, semi-circular arched openings in the brick wall with engaged columns below a pediment. At the front above the

U. S. Department of the Interior  
National Park Service

National Register of Historic Places  
Continuation Sheet

Section number 7 Page 8

Manchester Residential and Commercial Historic District  
Richmond, Virginia

---

vestibule, is a round stained glass window set in a brick panel with a round stone arch. The fenestration on the front and sides of the nave consists of rectangular, stained glass windows with stone lintels and sills. A steeple, at the front to the side of the vestibule, has stone belt courses, windows and louvers below a pyramid roof. There is a 1970s two-story addition at the rear and a 1980s or 1990s educational wing addition to the side.

Sacred Heart Catholic Church, 1401 Perry Street, built in 1901, is a two-story, brick, Romanesque church with a gable front and a bell tower at the corner. The church has a stone belt course at the floor level and a stone and brick parapet above a semi-circular, arched stained glass window in the gable end. The primary entrance is a pair of paneled doors in the bell tower that are approached by stone steps. The bell tower has a concave pyramidal roof.

Central United Methodist Church, 1213 Porter Street, built in 1899, is a red brick Romanesque church that dominates the 1200 block of Porter Street. The church was designed by architect D. Wiley Anderson. The church is two stories in height with a projecting gable-end front and projecting towers at each side. The gable-end front has a tripartite, stained glass window at the lower level and a larger, tripartite, stained glass window with pointed-arches and keystones at the upper level. The predominate tower on the left side has a pair of doors leading into the church from the street, and a stone belt course above the second story. Above the stone belt course are semi-circular arches with keystones and louvered openings. There is a second, narrower belt course above the louvered openings that forms the base for a series of four blind arches with stone impost blocks. The tower terminates in a pyramidal roof with single dormers on each side and corner battlements. The tower on the right side has similar elements but is more diminutive with a single-leaf entry door and no dormers in the roof.

Matthew F. Maury School, 1411 Bainbridge Street, is a two-story, brick Classical Revival-style building with a raised basement. The stuccoed, center, thirteen-bay section was built in 1888, with side and rear wings added in 1922. The earliest portion of the building is broken into three blocks with the center three bays slightly projected. There is a centered, one-story, three-bay wide, arcaded porch which emphasizes the main entrances into the raised basement. The projecting center three bays terminate in a pedimented roof with a plastered oculus in the center. The two projecting wings, added in 1922, are similar, with brick pilasters at the outside corners and a stuccoed plane between. A wooden cornice with modillions unifies the composition. Charles M. Robinson, a prolific school architect of the era, designed the original building and three wings. Graham Construction Company was the contractor. The design illustrates the importance that was placed on public education in this period.

#### 1918 to 1941

During this period, construction was hampered by World War I and the depression that followed. Where it occurred, construction was primarily infill in the residential and commercial neighborhoods of the historic district. Early Twentieth Century American Movement, especially the American Foursquare became a favorite style in the residential neighborhoods. Commercial buildings were constructed in a variety of new styles including Art Deco and Classical Revival.

The buildings at 1304, 1306, and 1308 Bainbridge Street are American Foursquare-style dwellings of this period, all with dormered hip roofs and more spacious entry halls than the narrow side-hall Queen Anne and Italianate dwellings built earlier. The American Foursquare at 1308 Porter Street with its porte cochere and two-car garage at the rear illustrates the influence that the automobile would play in Manchester's future.

U. S. Department of the Interior  
National Park Service

National Register of Historic Places  
Continuation Sheet

Section number 7 Page 9

Manchester Residential and Commercial Historic District  
Richmond, Virginia

---

The only apartment building in Manchester is at 1301 Porter Street. The Porter Street Apartments, built in 1919, is a four-story, brick, Italian Renaissance-style building that is unique in the historic district and dominates the block. The four-story, five-bay wide block is set on a raised basement with a parged foundation wall below a water table course. The major entrance is a centered, recess with a pedimented hood. All of the windows are double-hung, wood sashes with stone lintels and sills. The center bay has paired, double-hung windows. There is a cornice between the first and second stories, stone quoins at the corners on the second and third stories, and a horizontal stone belt between the third and fourth stories. The fourth story also has decorative brick panels between the windows and at the corners. There is a wood cornice with brackets and modillions below a brick parapet at the roof.

*Commercial Buildings*

The Bank of Commerce and Trusts, 1128 Hull Street, built in 1921, is a two-story Classical Revival bank building. Pairs of cast stone pilasters flank the sides of the arched entry. Cast stone pilasters, at the entry and the corners, extend the full height of the building to a cast stone architrave on which the bank's name is inscribed. Above the architrave is a cast stone cornice with a brick parapet and cast stone balustrade. The Venus Theatre, 1410-14 Hull Street, built in 1926, is a two-story, Classical Revival-style building. The building is faced with cast stone and pilasters defining the bays. There is a stone entablature with "VENUS" carved in the frieze and stone modillions below the cornice.

The American Bank & Trust, 1518 Hull Street, built in 1930, is a three-story, two-bay wide, Art Deco building with a brick and stone facade. The center bay is cast stone with a two-story entrance and windows at the third story. Fluted and stepped pilasters define the bays and extend to the roof at the center bay. Decorative brick panels separate the floors at the side bays.

*Institutional Buildings*

Brinser Hall, 1606-16 Hull Street, built in 1930, is a two-story, Classical Revival-style building. Brick pilasters set on stone pedestals define the three-bay facade. The masonry joints are raked out and the second story windows have brick jack arches with keystones. There is a metal cornice below the brick parapet at the roof.

Saint Luke's Episcopal Church, built in 1929, replaced the earlier Meade Memorial Episcopal Church, constructed in 1869 at 104 Cowardin Avenue. Saint Luke's is a two-story, Classical Revival, Flemish-bond brick church with a raised basement. There are quoins at the corners and glazed brick headers in the field. The gable-front church has a two-story, three-bay wide, projecting portico with Corinthian columns supporting a pedimented roof with modillions and half round window in the tympanum. There is a centered double-leaf entry door with an arched transom and single-leaf entry doors with decorative lintels in the flanking bays. There are double-hung windows in the second story below the portico. A steeple with a brick base extends from the roof. Above the base is a square, louvered story with pairs of columns at the corners. It is capped with an octagonal tower, a steep roof, and a ball and cross.

**U. S. Department of the Interior  
National Park Service**

**National Register of Historic Places  
Continuation Sheet**

Section number   7   Page   10  

**Manchester Residential and Commercial Historic District  
Richmond, Virginia**

Across from Sacred Heart Church at 1400-18 Perry Street, is the Sacred Heart School. Built in 1931, it is a two-story brick Art Deco building. Projecting windowless end bays flank a seven-bay wide block. The windowless end bays have pilasters at the corners. The seven central bays are defined by brick pilasters. At the centered entrance there are projecting pilasters which support brick and cast stone ornamentation above the entry doors.

The Bainbridge Junior High School Gymnasium, adjoining the Maury School at 111 West 15th Street, was built in 1939. The three-story, brick, Classical Revival gymnasium was design by architect J. Binford Walford and built by the Allen Saville Construction Company. The center three-bays of the facade are projected, slightly in front of un-fenestrated blocks at the corners. The first story of the projecting plane is rusticated and pierced by three pairs of doors with transoms. Cast stone bands separate the first and second stories. Above the doors are three, two-story brick arches with cast stone keystones. Recessed in the brick arches are sixteen-light industrial sash windows in the second story and arched windows in the third story. A metal cornice with modillions wraps the projecting bay below the brick parapet.

**1942 TO THE PRESENT**

The end of World War II brought short lived prosperity to Manchester. By the 1950s, new suburban development drew residents away from the town and by the 1960s, suburban shopping centers began to draw business away from the Hull Street commercial area. The widening of Cowardin Avenue from the Lee Bridge and Commerce Road from the Manchester Bridge (9th Street) gave definition to the east and west sides of the historic district. New public housing following demolition, south of Hull, and defines the south boundary of the historic district. Overnite Trucking Company cleared large areas of historic residences north of the district towards the James River, during the 1960s and 1970s. The late-eighteenth and early-nineteenth century commercial and residential buildings in the historic district had become largely abandoned and deteriorated by 1980.

Historically, Manchester's significance has been based on its location on the James River across from Richmond. This importance was rediscovered in the 1990s with the development of large, river-oriented, office buildings between the Lee and Manchester Bridges. In 1997, the master plan for the city of Richmond expanded Richmond's "downtown" to include the residential and commercial historic district and established a "redevelopment" plan for Manchester.

**MANCHESTER RESIDENTIAL COMMERCIAL HISTORIC DISTRICT INVENTORY**

All resources are contributing unless noted "NONCONTRIBUTING".

**1000 block Bainbridge Street**

- 06 1007-09 Bainbridge Street, 1915, two-story brick, multi-family detached, double house, Italianate.
- 053 1015 Bainbridge Street, The Archibald Freeland House, 1797, two-story brick over raised basement, single family, detached, Georgian.

**1100 block Bainbridge Street, Even Side**

- 1021 1100 Bainbridge Street, 1910, two-story brick, single family, attached house, Italianate.

**U. S. Department of the Interior  
National Park Service**

**National Register of Historic Places  
Continuation Sheet**

Section number 7 Page 11

**Manchester Residential and Commercial Historic District  
Richmond, Virginia**

- ~~103~~ 102 Bainbridge Street, 1910, two-story brick, multi-family, attached house, Italianate.  
~~104~~ 104 Bainbridge Street, 1910, two-story brick, single family, attached house, Italianate.  
~~107~~ 108 Bainbridge Street, 1906, two-story frame, single family, detached house, Queen Anne.  
 Two wood sheds at rear.  
 One modular shed at rear, NONCONTRIBUTING.

1100 block Bainbridge Street, Odd Side

- ~~325~~ 1101 Bainbridge Street, Bainbridge Baptist Church, 1857, two-story brick over a raised basement, detached church building, Greek Revival.  
~~603~~ 1109 Bainbridge, 1886, two-story brick single family, detached house, Italianate with a one-story cast iron front porch.

1200 block Bainbridge Street

- ~~105~~ 1200 Bainbridge Street, 1910, two-story brick multi-family, attached house, Italianate.  
~~106~~ 1202 Bainbridge Street, 1910, two-story brick multi-family, attached house, Italianate.  
~~107~~ 1204 Bainbridge Street, 1910, two-story brick multi-family, attached house, Italianate.  
~~108~~ 1206 Bainbridge Street, 1910, two-story brick multi-family, attached house, Italianate.  
~~651~~ 1216-18 Bainbridge Street, Bainbridge Apartments, 1895, two-story frame multi-family, detached house, Italianate.  
~~133~~ 1220 Bainbridge Street, 1915, two-story brick single family, detached house, Colonial Revival.  
~~152~~ 1222 Bainbridge Street, 1919, two-story brick single family, detached house, Colonial Revival.  
 one-story brick garage at rear NONCONTRIBUTING.

1300 Bainbridge Street, Even Side

- ~~029~~ 1300 Bainbridge Street, 1895, two-story brick multi-family, attached house, Queen Anne.  
~~633~~ 1302 Bainbridge Street, 1895, two-story brick multi-family, attached house, Queen Anne.  
 one-story brick garage at rear NONCONTRIBUTING.  
~~200~~ 1304 Bainbridge Street, 1935, two-story frame single family, detached house, Early 20th Century American Movement.  
~~211~~ 1306 Bainbridge Street, 1935, two-story frame single family, detached house, Early 20th Century American Movement.  
 one-story frame shed at rear, NONCONTRIBUTING.  
~~212~~ 1308 Bainbridge Street, 1935, two-story frame single family, detached house, Early 20th Century American Movement.  
~~284~~ 1310 Bainbridge Street, South Richmond Health Department, 1958, two-story brick detached health clinic, Modern Movement. NONCONTRIBUTING.

1300 Bainbridge Street, Odd Side

- ~~031~~ 1301 Bainbridge Street, 1895, two-story brick single family, attached house, Queen Anne.  
 two-story brick garage at rear contributing.  
~~033~~ 1303 Bainbridge Street, 1895, two-story brick single family, attached house, Queen Anne.  
~~036~~ 1305 Bainbridge Street, 1895, two-story brick single family, attached house, Queen Anne.  
~~064~~ 1307 Bainbridge Street, 1905, two-story frame single family, detached house, Queen Anne.  
~~067~~ 1311 Bainbridge Street, 1905, two-story frame single family, detached house, Queen Anne.  
~~041~~ 1317 Bainbridge Street, 1895, two-story frame single family, detached house, Queen Anne.  
~~042~~ 1319 Bainbridge Street, 1895, two-story frame single family, detached house, Queen Anne.  
~~107~~ 1323 Bainbridge Street, 1910, two-story brick single family, detached dwelling, Queen Anne.

U. S. Department of the Interior  
National Park Service

National Register of Historic Places  
Continuation Sheet

Section number 7 Page 12

Manchester Residential and Commercial Historic District  
Richmond, Virginia

one-story block garage at rear NONCONTRIBUTING.

1400 block Bainbridge Street, Even Side

- 204 1400-02 Bainbridge Street, 1934, two-story brick multi-family attached apartment building, Colonial Revival. one-story brick garage at rear, NONCONTRIBUTING.
- 207 1404 Bainbridge Street, 1934, two-story brick multi-family attached apartment building, Colonial Revival. one-story brick garage at rear, NONCONTRIBUTING.
- 044 1412 Bainbridge Street, 1895, two-story frame single family, detached house, Italianate.
- 045 1414 Bainbridge Street, 1895, two-story frame single family, detached house, Italianate.
- 046 1416 Bainbridge Street, 1895, one-story frame single family, detached house, Late 19th Century Builder's Vernacular. one-story metal shed at rear NONCONTRIBUTING.
- 047 1422 Bainbridge Street, 1895, two-story brick single family, detached house, Italianate.
- 140 1424-26 Bainbridge Street, 1919, two-story brick multi-family, detached house, Italianate.
- 111 1428 Bainbridge Street, 1910, two-story frame single family, detached house, Queen Anne.

1400 block Bainbridge Street, Odd Side

- 110 1411 Bainbridge Street, Matthew F. Maury School, 1888, two-story brick school building over a raised basement, detached, Classical Revival.

Cowardin Avenue

- 140 1104 Cowardin Avenue, Saint Luke's Episcopal Church, 1929, two-story brick church over a raised basement, detached, Classical Revival.
- 224 106-8-10 Cowardin Avenue, 1950, one-story brick commercial building, detached, Modern Builder's Vernacular. NONCONTRIBUTING.
- 06 1112 Cowardin Avenue, 1905, two-story frame single family detached house, Queen Anne.
- 05 1116-18 Cowardin Avenue, Cowardin Avenue Christian Church, 1 ½ story brick church building over a raised basement, detached, Gothic Revival.

Decatur Street

- 23 900 Decatur Street, Decatur Street Methodist-Episcopal Church South, 1910, 1 ½ story brick church building, detached, Gothic Revival.
- 24 1201 Decatur Street, Meade Memorial Episcopal Church, 1869, 1 ½ story frame church building detached, Gothic Revival.
- 05 1501 Decatur Street, First Baptist Church South Richmond, 1892, two-story brick church building detached, Romanesque.

900 block Hull Street, Even Side

- 010 920 Hull Street, The Manchester Courthouse, 1871, one-story brick courthouse building, detached, Colonial Revival.

900 block Hull Street, Odd Side

- 173 901-03 Hull Street, 1919, two-story brick commercial building, detached, Classical Revival.
- 19 917-21 Hull Street, 1926, one-story brick commercial building, attached, Commercial Builder's Vernacular.
- 09 925-27 Hull Street, 1905, two-story brick commercial building, attached, Italianate.



U. S. Department of the Interior  
National Park Service

National Register of Historic Places  
Continuation Sheet

Section number 7 Page 13

Manchester Residential and Commercial Historic District  
Richmond, Virginia

two-story brick building at rear, contributing.

1000 block Hull Street, Even Side

- 06 1010 Hull Street, 1910, two-story brick commercial building, attached, Italianate.
- 01 1012-14 Hull Street, 1930, one-story brick commercial building, attached, Spanish Colonial.
- 016 1020 Hull Street, 1895, two-story commercial brick building, attached, Italianate.
- 07 1022-24 Hull Street, 1895, two-story commercial brick building, attached, Italianate.

1000 block Hull Street, Odd Side

- 1 1011 Hull Street, The Nance Building, 1915, two-story brick commercial building, detached, Italianate.
- 06 1019 Hull Street, Manchester Post Office, 1910, one-story brick post office building over a raised basement, detached, Georgian.

1100 block Hull Street, Even Side

- 0R 1100 Hull Street, 1895, two-story brick commercial building, attached, Italianate.
- 01 1102 Hull Street, 1895, two-story brick commercial building, attached, Italianate.
- 235 1104 Hull Street, 1960, one-story concrete block commercial building, attached, modern builder's Vernacular.  
NONCONTRIBUTING.
- 06 1114 Hull Street, 1960, one-story masonry & metal panel commercial building, detached, modern builder's vernacular.  
NONCONTRIBUTING.
- 134 1124-26 Hull Street, 1915, three-story brick commercial building, attached, Commercial Style.
- 127 1128 Hull Street, Bank of Commerce & Trusts, 1921, two-story brick bank building attached, Classical Revival. - 176 Also

1100 block Hull Street, Odd Side

- 149 1101-03 Hull Street, 1919, one-story brick commercial building, attached, Italianate.
- 150 1105 Hull Street, 1919, three-story brick commercial building, attached, Italianate.
- 06 1109-15 Hull Street, 1905, three-story brick commercial building, attached, Italianate.
- 04 1119-25 Hull Street, The Beattie Block, 1887, three-story brick commercial building, attached, Italianate.
- 146 1129 Hull Street, Mechanics & Merchants Bank, 1915, two-story brick bank building, attached, Classical Revival.

1200 block Hull Street, Even Side

- 04 1204 Hull Street, 1892, two-story brick commercial building, attached, Italianate.
- 09 1206 Hull Street, 1895, two-story brick commercial building, attached, Queen Anne.
- 02 1208 Hull Street, 1895, two-story brick commercial building, attached, Commercial Style.
- 225 1212 Hull Street, 1950, one-story brick commercial building, attached, modern builder's vernacular.  
NONCONTRIBUTING.
- 134 1224 Hull Street, 1915, one-story brick commercial building, attached, Commercial Style.
- 02 1226 Hull Street, 1895, two-story brick commercial building, attached, Italianate.
- 22 1228 Hull Street, 1950, one-story brick & aluminum commercial restaurant building, attached, Moderne.  
NONCONTRIBUTING.

1200 block Hull Street, Odd Side

- 03 1201 Hull Street, The Hutzler Building, 1919, two-story brick department store, attached, Colonial Revival.
- 04 1209 Hull Street, The Baldwin Building, 1905, three-story brick department store, attached, Italianate.
- 15 1213 Hull Street, 1919, two-story brick commercial building, attached, Italianate.
- 12 1215-17 Hull Street, The Ullman Building, 1910, three-story brick commercial building, attached, Italianate.

U. S. Department of the Interior  
National Park Service

National Register of Historic Places  
Continuation Sheet

Section number 7 Page 14

Manchester Residential and Commercial Historic District  
Richmond, Virginia

- 0251221 Hull Street, 1895, two-story brick commercial building, attached, Italianate.  
one-story brick building at rear, NONCONTRIBUTING.
- 0261223-25 Hull Street, 1895, one-story brick commercial building, attached, Commercial Builder's Vernacular.  
NONCONTRIBUTING.
- 0281227-29 Hull Street, 1895, three-story brick commercial building, attached, Italianate.

1300 block Hull Street, Even Side

- 0301300-04 Hull Street, 1895, two-story brick commercial building, attached, Italianate.
- 0311306-08 Hull Street, 1895, two-story brick commercial building attached, Italianate.
- 1361312-14 Hull Street, 1915, two-story brick commercial building, attached, Commercial Style.
- 1411316 Hull Street, The Victoria Movie Theater, 1915, one-story brick movie theater, attached, Commercial Builder's  
Vernacular.
- 1791320 Hull Street, 1921, two-story brick commercial building, attached, Commercial Style.
- 041324 Hull Street, Reformer's Mercantile & Industrial Association, 1886, two-story brick commercial building, attached,  
Commercial Style.

1300 block Hull Street, Odd Side

- 0341301 Hull Street, 1895, two-story brick commercial building, attached, Italianate.
- 0351303 Hull Street, 1895, two-story brick commercial building, attached, Italianate.
- 0511305 Hull Street, 1895, two-story brick commercial building, attached, Italianate.
- 1541307 Hull Street, 1919, two-story brick commercial building, attached, Italianate.
- 0311309-11 Hull Street, 1895, two-story brick commercial building, attached, Beaux Arts.
- 0401313-15 Hull Street, 1895, three-story brick commercial building, attached, Italianate.
- 211317 Hull Street, F. W. Woolworth & Co., 1935, two-story yellow brick commercial building, attached, Commercial  
Builder's Vernacular.
- 1231319 Hull Street, Standard Drug Co., 1910, two-story brick commercial building, attached, Italianate.
- 1571321 Hull Street, 1919, two-story brick commercial building, attached, Colonial Revival.

1400 block Hull Street, Even Side

- 142400 Hull Street, Hull Street Library, 1985, one-story brick library building, attached, Modern Style.  
NONCONTRIBUTING.
- 0541410-14 Hull Street, The Venus Theater, 1926, two-story stone masonry movie theater building, attached, Classical  
Revival.
- 1571416 Hull Street, 1915, two-story brick commercial building, attached, Italianate.
- 1391418 Hull Street, 1915, two-story brick commercial building, attached, Italianate.
- 1401420 Hull Street, 1915, two-story brick commercial building, attached, Italianate.
- 1881430 Hull Street, 1926, one-story brick commercial building, attached, Spanish Colonial.
- 1891432 Hull Street, 1926, one-story brick commercial building, attached, Spanish Colonial.
- 1901434 Hull Street, 1926, one-story brick commercial building, attached, Spanish Colonial.
- 1431436-38 Hull Street, 1915, three-story, stone faced commercial building, detached, Art Deco style.

1400 block Hull Street, Odd Side

- 1591401 Hull Street, 1919, one-story brick commercial building, attached, No Style Listed. NONCONTRIBUTING
- 0711405 Hull Street, 1919, one-story brick commercial building, attached, No Style Listed. NONCONTRIBUTING

**U. S. Department of the Interior  
National Park Service**

**National Register of Historic Places  
Continuation Sheet**

Section number 7 Page 15

Manchester Residential and Commercial Historic District  
Richmond, Virginia

- ~~191~~1407 Hull Street, 1930, two-story brick commercial building, attached, Commercial Builder's Vernacular. one-story masonry block garage at rear, NONCONTRIBUTING.
- ~~191~~1409 Hull Street, 1930, two-story brick commercial building, attached, Commercial Builder's Vernacular. one-story brick garage at rear, NONCONTRIBUTING.
- ~~151~~1413-15 Hull Street, 1926, one-story brick commercial building, attached, Commercial Builder's Vernacular.
- ~~131~~1417 Hull Street, 1915, two-story brick commercial building, attached, Colonial Revival.
- ~~181~~1417 ½ Hull Street, 1926, one-story brick commercial building, attached, Commercial Builder's Vernacular. one-story brick garage at rear, NONCONTRIBUTING.
- ~~201~~1419-21 Hull Street, 1930, one-story brick commercial building, attached, Spanish Colonial.
- ~~181~~1423 Hull Street, 1925, one-story brick commercial building, attached, Spanish Colonial.
- ~~141~~1425 Hull Street, 1925, one-story brick commercial building, attached, Spanish Colonial.
- ~~201~~1427-29 Hull Street, 1947, one-story brick & metal panel commercial building, attached, Commercial Builder's Vernacular. NONCONTRIBUTING.
- ~~141~~1431 Hull Street, 1935, one-story brick commercial building, attached, Commercial Builder's Vernacular.
- ~~112~~1433-35 Hull Street, 1910, two-story brick commercial building, attached, Italianate.
- ~~052~~1437 Hull Street, Moore & Burke Saloon, 1895, two-story brick commercial building, attached, Italianate.

1500 block Hull Street, Even Side

- ~~046~~1500 Hull Street, 1895, two-story brick commercial building, attached, No Style Listed. NONCONTRIBUTING.
- ~~049~~1504 Hull Street, 1895, two-story brick commercial building, attached, No Style Listed. NONCONTRIBUTING.
- ~~054~~1506-12 Hull Street, The Imani Center, 1895, two-story brick commercial building, attached, No Style Listed. NONCONTRIBUTING.
- ~~176~~1518 Hull Street, American Bank & Trust Co, South Richmond, 1930, three-story brick and stone bank building, detached, Art Deco.

1500 block Hull Street, Odd Side

- ~~071~~1501 Hull Street, 1905, two-story brick commercial building, attached, Italianate.
- ~~079~~1503 Hull Street, 1905, two-story brick commercial building, attached, Italianate.
- ~~219~~1505-07 Hull Street, 1946, two-story brick commercial building, attached, Commercial Builder's Vernacular.
- ~~201~~1509-13 Hull Street, 1930, one-story brick commercial building, attached, Commercial Builder's Vernacular.
- ~~221~~1515 Hull Street, 1947, one-story brick commercial building, attached, Modern Movement.
- ~~205~~1517 Hull Street, 1934, one-story brick commercial building, attached, Commercial Builder's Vernacular.
- ~~215~~1519 Hull Street, 1935, one-story brick attached, commercial building, Commercial Builder's Vernacular style.
- ~~163~~1521 Hull Street, 1919, two-story brick commercial building, attached, Italianate.
- ~~164~~1523-1601 Hull Street, 1919, two-story brick commercial building, attached, No Style Listed. NONCONTRIBUTING.

1600 block Hull Street, Even Side

- ~~086~~1600-02 Hull Street, 1905, two-story brick commercial building, detached, Modern Movement.
- ~~1606~~1606-16 Hull Street, Brinser Hall Building, 1930, two-story brick commercial building, attached, Classical Revival.

1600 Hull Street, Odd Side

- ~~233~~1603-05 Hull Street, 1955, one-story brick commercial building, attached, Commercial Builder's Vernacular. NONCONTRIBUTING.
- ~~204~~1607 Hull Street, 1930, one-story brick commercial building, attached, Spanish Colonial.
- ~~203~~1609 Hull Street, 1930, one-story brick commercial building, attached, Spanish Colonial.
- ~~210~~1611 Hull Street, 1935, one-story brick commercial building, attached, Moderne.

**U. S. Department of the Interior  
National Park Service**

**National Register of Historic Places  
Continuation Sheet**

Section number 7 Page 16

Manchester Residential and Commercial Historic District  
Richmond, Virginia

- ~~104~~ 1615-17 Hull Street, 1934, two-story brick commercial building, attached, Commercial Builder's Vernacular.  
~~115~~ 1619 Hull Street, 1919, two-story brick commercial building, attached, Italianate.  
~~108~~ 1625 Hull Street, 1919, two-story brick commercial building, attached, Italianate.

1200 block Perry Street

- ~~177~~ 1210 Perry Street, 1921, two-story frame single family detached house, Queen Anne.  
~~060~~ 1213 Perry Street, 1905, one-story frame single family detached house, Italianate.  
~~131~~ 1214 Perry Street, 1915, two-story brick single family detached house, Colonial Revival.  
~~018~~ 1215-17 Perry Street, 1905, two-story frame multiple family house, detached, Early 20th Century Builder's Vernacular.  
~~132~~ 1216 Perry Street, 1915, two-story brick single family house, detached, Colonial Revival.

1300 block Perry Street, Even Side

- ~~099~~ 1300 Perry Street, 1906, two-story frame single family house, detached, Queen Anne.  
~~133~~ 1302 Perry Street, 1906, two-story frame single family house, detached, Colonial Revival.  
~~040~~ 1310 Perry Street, 1905, two-story frame single family house, detached, Italianate.  
~~171~~ 1312 Perry Street, 1921, two-story frame single family house, detached, Colonial Revival.  
~~070~~ 1322 Perry Street, 1905, two-story frame single family house, detached, Queen Anne.

1300 block Perry Street, Odd Side

- ~~028~~ 1313 Perry Street, 1905, two-story frame single family house, detached, Italianate.  
~~064~~ 1315 Perry Street, 1905, two-story frame single family house, detached, Queen Anne.

1400 block Perry Street, Even Side

- ~~105~~ 1400-18 Perry Street, Sacred Heart School, 1931, two-story brick school building, detached, Art Deco.  
~~110~~ 1426 Perry Street, 1910, two-story frame single family detached house, Queen Anne.  
~~142~~ 1428 Perry Street, 1915, two-story frame single family detached house, Colonial Revival.

1400 block Perry Street, Odd Side

- ~~055~~ 1401 Perry Street, Sacred Heart Catholic Church, 1901, two-story brick church building, detached, Romanesque.  
~~251~~ 1401 Perry Street, Sacred Heart Church Parish House, 1905, one-story frame church building, detached, Late Victorian.  
~~054~~ 1409 Perry Street, Sacred Heart Church Rectory, 1901, two-story brick single family house, detached, Queen Anne.  
~~045~~ 1415 Perry Street, Liguori House, 1905, two-story frame single family house, detached, Queen Anne.  
~~079~~ 1417 Perry Street, 1905, two-story frame single family house, detached, Queen Anne.  
~~141~~ 1423-25 Perry Street, 1915, two-story frame multi-family house, detached, Italianate.  
~~077~~ 1431 Perry Street, 1905, two-story frame single family house, detached, Early 20th Century Builder's Vernacular.

1500 Perry Street, Even Side

- ~~114~~ 1512 Perry Street, 1910, two-story frame single family house, detached, Queen Anne.  
~~118~~ 1514 Perry Street, 1910, two-story frame single family house, detached, Queen Anne.  
~~085~~ 1516 Perry Street, 1910, two-story brick single family house, detached, Italianate.  
~~141~~ 1518 Perry Street, 1910, two-story brick multi-family house, detached, Colonial Revival.

1500 block Perry Street, Odd Side

- ~~076~~ 1503 Perry Street, 1905, two-story frame single family house, detached, Early 20th Century Builder's Vernacular.

**U. S. Department of the Interior  
National Park Service**

**National Register of Historic Places  
Continuation Sheet**

Section number 7 Page 17

Manchester Residential and Commercial Historic District  
Richmond, Virginia

- 0811 505 Perry Street, 1905, two-story frame single family house, detached, Queen Anne.  
0831 507 Perry Street, 1905, two-story frame single family house, detached, Queen Anne.  
0841 509 Perry Street, 1905, two-story frame single family house, detached, Queen Anne.

900 block Porter Street

- 145 921 Porter Street, 1915, two-story single family house, detached, Queen Anne.  
120 923 Porter Street, 1910, two-story single family house, detached, Queen Anne.

1000 block Porter Street, Even Side

- 110 008 Porter Street, Porter Street Presbyterian Church Manse, 1895, two-story frame single family house, detached, Queen Anne.  
144 1012 Porter Street, 1919, two-story brick single family house, detached, Colonial Revival.  
121 1014 Porter Street, 1915, two-story brick single family house, detached, Colonial Revival.

1000 block Porter Street, Odd Side

- 121 1001 Porter Street, 1915, two-story brick single family house, detached, Queen Anne.  
104 1003 Porter Street, 1910, two-story frame single family house, detached, Queen Anne.  
114 1005-07 Porter Street, 1950, two-story brick multi-family house, detached, Colonial Revival. NONCONTRIBUTING.  
123 1009-11 Porter Street, 1950, two-story brick multi-family house, detached, Colonial Revival. NONCONTRIBUTING.  
058 1017 Porter Street, 1905, two-story frame single family house, detached, Queen Anne.

1100 block Porter Street

- 021 1104 Porter Street, 1895, two-story frame single family house, detached, Italianate.  
021 1106 Porter Street, 1895, two-story frame single family house, detached, Queen Anne.  
021 1108 Porter Street, 1895, two-story frame single family house, detached, Italianate.  
023 1110 Porter Street, 1895, two-story frame single family house, detached, Queen Anne.

1200 block Porter Street

- 051 1201 Porter Street, The Ingram House, 1876, two-story brick multiple dwelling, detached, Italianate.  
182 1202 Porter Street, 1926, two-story frame single family house, detached, Early 20th Century American Movement, American Foursquare  
004 1209 Porter Street, The Turner-Baldwin House, 1860, two-story brick single family house over a raised basement, detached, Greek Revival.  
121 1211 Porter Street, Central United Methodist Church Parsonage, 1910, two-story brick single family house, detached, Colonial Revival.  
001 1213 Porter Street, Central United Methodist Church, 1899, two-story brick church building, detached, Romanesque.

1300 block Porter Street, Even Side

- 153 1300 Porter Street, 1919, two-story brick multi-family building, detached, Colonial Revival.  
121 1302 Porter Street, 1926, two-story brick single family house, detached, Colonial Revival.  
121 1308 Porter Street, 1926, two-story brick single family house, detached, Early 20th Century American Movement, American Foursquare  
154 1316 Porter Street, 1919, two-story brick multi-family house, detached, Colonial Revival.  
043 1320 Porter Street, 1920, two-story brick multiple family house, detached, Early 20th Century American Movement, American Foursquare

**U. S. Department of the Interior  
National Park Service**

**National Register of Historic Places  
Continuation Sheet**

Section number 7 Page 19

Manchester Residential and Commercial Historic District  
Richmond, Virginia

~~093~~ 216 West 12th Street, 1905, two-story frame single family house, detached, Italianate.

13th Street

~~088~~ 208 West 13th Street, 1905, one-story frame single family house, detached, Early 20th Century Builder's Vernacular.

~~108~~ 209 West 13th Street, 1919, two-story brick multi-family house, detached, Colonial Revival.

14th Street

~~060~~ 211 West 14th Street, 1905, two-story frame single family house, detached, Early 20th Century Builder's Vernacular.

~~178~~ 309 West 14th Street, 1919, two-story frame multi-family house, detached, Colonial Revival.

15th Street

~~111~~ West 15th Street, Bainbridge Junior High School Gymnasium, 1939, two-story brick school gym building, detached, Classical Revival.

~~143~~ 204 West 15th Street, 1928, two-story frame multi family house, detached, Colonial Revival.

~~087~~ 205 West 15th Street, 1905, two-story frame single family house, detached, Italianate.

~~172~~ 209 West 15th Street, 1919, two-story frame single family house, detached, Colonial Revival.

~~171~~ 211 West 15th Street, 1919, two-story frame single family house, detached, Colonial Revival.

~~091~~ 212-14 West 15th Street, 1905, two-story frame multi-family house, detached, Italianate.

**U. S. Department of the Interior  
National Park Service**

**National Register of Historic Places  
Continuation Sheet**

Section number   7   Page   18  

Manchester Residential and Commercial Historic District  
Richmond, Virginia

~~113~~ 1322 Porter Street, 1935, one-story frame single family house, detached, Early 20th Century Builder's Vernacular.

1300 block Porter Street, Odd Side

~~174~~ 1301 Porter Street, Porter Street Apartments, 1919, 4 story brick multi-family apartment building, detached, Italianate.  
~~158~~ 1321 Porter Street, 1919, two-story brick single family house, detached, Colonial Revival.

1400 block Porter Street

~~072~~ 1407 Porter Street, 1905, two-story frame single family house, detached, Queen Anne.  
~~073~~ 1409 Porter Street, 1905, two-story frame single family house, detached, Queen Anne.  
~~074~~ 1411 Porter Street, 1905, two-story frame single family house, detached, Queen Anne.  
~~126~~ 1415 Porter Street, 1920, two-story frame multiple family house, detached, Early 20th Century American Movement, American Foursquare  
~~678~~ 1419 Porter Street, 1905, two-story frame single family house, detached, Queen Anne.

1500 block Porter Street, Even Side

~~144~~ 1500 Porter Street, 1915, 2 ½ story brick single family house, detached, Colonial Revival.  
~~104~~ 1502 Porter Street, 1906, two-story brick single family house, detached, Queen Anne.  
~~082~~ 1506 Porter Street, 1905, two-story frame single family house, detached, Queen Anne.  
~~291~~ 1516 Porter Street, 1955, two-story brick multi family apartment building, detached, Colonial Revival.  
NONCONTRIBUTING.  
~~034~~ 1518 Porter Street, 1955, two-story brick multi family apartment building, detached, Colonial Revival.  
NONCONTRIBUTING.  
~~164~~ 1520 Porter Street, 1919, two-story brick single family house, detached, Colonial Revival.  
~~119~~ 1522 Porter Street, 1910, two-story brick single family house, detached, Queen Anne.

1500 block Porter Street, Odd Side

~~113~~ 1503 Porter Street, 1910, two-story brick single family house, attached, Queen Anne.  
~~111~~ 1505 Porter Street, 1910, two-story brick single family house, attached, Queen Anne.  
~~125~~ 1509 Porter Street, 1911, two-story brick single family house, detached, Colonial Revival.  
~~115~~ 1511 Porter Street, 1910, two-story brick single family house, attached, Queen Anne.  
~~117~~ 1513 Porter Street, 1910, two-story brick single family house, detached, Colonial Revival.

11th Street

~~014~~ West 11th Street, 1886, two-story frame single family house, detached, Late 19th & Early 20th Century Builder's Vernacular.  
~~076~~ 209-11 West 11th Street, 1905, one-story frame double house, detached, Italianate.

12th Street

~~015~~ East 12th Street, 1960, two-story brick single family house, attached, Modern Movement. NONCONTRIBUTING.  
~~057~~ East 12th Street, 1895, two-story frame single family house, detached, Italianate.  
~~05~~ 12-14 East 12th Street, The John B. Anderson House, 1867, 1 ½-story frame double house, detached, Late 19th Century Builder's Vernacular.  
~~04~~ 115 West 12th Street, The Thomas D. Jones House, 1814, two-story brick house over a raised basement, detached, Georgian.  
~~076~~ 14 West 12th Street, 1905, two-story frame single family house, detached, Italianate.

**U. S. Department of the Interior  
National Park Service**

**National Register of Historic Places  
Continuation Sheet**

Section number   8   Page  20 

Manchester Residential and Commercial Historic District  
Richmond, Virginia

**STATEMENT OF SIGNIFICANCE**

The Manchester Residential and Commercial Historic District in Richmond, Virginia, is eligible for listing on the National Register of Historic Places under criteria A and C. The historic district illustrates the growth of a community from a scattered settlement in the seventeenth century, to a thriving port in the eighteenth century. Manchester was granted city status in the nineteenth century and in the twentieth century it was consolidated into the city of Richmond. The surviving architecture represents the prosperous era, the mid-nineteenth to the early twentieth centuries, when Manchester thrived as a port and manufacturing center on the south side of the James River across from Richmond. This period saw the construction of a wide variety of commercial and residential building types and styles in Manchester. The buildings are elaborate and modest and include schools, churches and government buildings mixed into the residential and commercial areas. Hull Street is the focus of the commercial area with multi-story masonry buildings, standing shoulder to shoulder along the street. Hull Street is a major thoroughfare connecting Chesterfield County and Southside Virginia to Richmond via Mayo's Bridge over the James River. While commercial activity is predominant on Hull Street interspersed meeting halls, movie houses and restaurants contributed to the social and cultural life in Manchester. Bainbridge, Porter and Perry Streets retain a wide variety of two-story, detached dwellings of various styles mixed with the schools and churches necessary to serve the community. Many individual buildings are noteworthy but the district's significance lies in the unified commercial and residential streetscapes representative of "hometown America." The commercial, residential and public buildings exhibit a wide variety of architectural styles construction methods and craftsmanship.

**HISTORIC BACKGROUND**

***The Settlement Period 1607-1750***

On 24 May 1607, Captain Christopher Newport, from Jamestown, and his band of English explorers planted a cross at the falls of the James River, near the heart of the present city of Richmond and Manchester. They were attracted to the natural features of the falls of the James. In 1676, William Byrd I was awarded tracks of land on both sides of the James. The north bank was to be known as "Shockoe" and the south bank as "the Mills." A canal, mill race and two mills were built at the falls on the south bank. One mill was for cloth and the other, a grist mill. William Byrd I died in 1704, leaving his land and enterprises to his son, William Byrd II. In 1730, Patrick Coult built a ferry, which ran from the Mills to Rockett's, on the north side of the James. The ferry, between the future cities of Manchester and Richmond, was the first and only transportation across the river for over fifty years. Additional warehouses and wharves were built to accommodate the growing trades and industry. Because of its topography, the area on the south side of the James River came to be known as Rocky Ridge. In 1737,



U. S. Department of the Interior  
National Park Service

## National Register of Historic Places Continuation Sheet

Section number   8   Page  21 

Manchester Residential and Commercial Historic District  
Richmond, Virginia

---

William Byrd II asked John Mayo, who had laid out the streets for Richmond, to do so for his holdings on the south side of the river. Mayo's street grid is still evident in the district today.

### Colony to Nation Period 1750-1789

William Byrd II died in 1744, and his son, William Byrd III inherited his father's wealth. Byrd had Benjamin Watkins, then the surveyor for Chesterfield County, resurvey his holdings south of the river. It is said that William Byrd III was careless with his finances and in November 1768, needing to raise capital, he held a lottery. The winners were given lots in the new town. Some received such things as fishing rights to certain areas. While others were given administrative positions in the newly formed town government. In 1769, Rocky Ridge was incorporated as a town, and the name was changed to Manchester. Prior to the Revolutionary War, Manchester was a major slave market. The point of entry was Osbornes' located just east of Manchester on the south side. Slave labor was instrumental in the development of Virginia. Slaves not only worked in the fields but also in shipping along the wharves and in the coal mines. They often become skilled artisans and were hired out by their owners.<sup>1</sup>

In Manchester, the wealthier citizens built fine homes and elaborate gardens. However, most residents were poor, and their homes were much more modest. Since brick was expensive, they commonly built chimneys of wood, with a clay lining. These proved to be a fire hazard, so the General Assembly passed a law that prohibited their use. In 1770, some residents invited two Baptist ministers to preach in Manchester. They held meetings which attracted large crowds. Archibald Cary, who was then the magistrate, had the preachers arrested, because they had not obtained a license to preach. Over the next four years, five more Baptist ministers were arrested. Despite this persecution, they established three churches, in outlying communities. Blacks were among those who joined these congregations, and others, which were organized later. However, the Baptists did not establish a church in Manchester until after 1800.

Manchester was a major staging and supply area for south side Virginia during the American Revolution. In 1776, a system of warehouses, including warehouses in Manchester, had been authorized by the General Assembly and John Mayo, Richard Adams and William Cole were authorized to procure and store flour and pork at Manchester for the Army. The majority of Manchester's citizens were loyal to the cause of independence. However, there were prominent British interests, particularly Scottish merchants, loyal to the Crown in Manchester on the eve of the Revolution. In January 1776, the *Virginia Gazette* published a list of nine Tories in Manchester who were leaving or about to leave the city. During and after the war, the properties of some of these merchants were sold.<sup>2</sup> In 1781 British General Benedict Arnold's troops entered Richmond for a twenty-four hour occupation and a bit of destruction. British Colonel J. G. Simcoe played a leading role in this brief occupation and so called "skirmish" at Richmond, as indicated in his personal journal. A map of the "skirmish" said to have been made by Lt. Allang of the Queen's Rangers, shows both Richmond and Manchester, with buildings, roads and fields

U. S. Department of the Interior  
National Park Service

National Register of Historic Places  
Continuation Sheet

Section number   8   Page  22 

Manchester Residential and Commercial Historic District  
Richmond, Virginia

---

on both sides of the James River. Again in April of 1781, General Arnold sent a detachment of British troops, commanded by Major General William Phillips, to destroy the warehouses and other important buildings in Richmond and Manchester.<sup>3</sup> Thomas Jefferson, then governor of Virginia, watched them approach Richmond from Manchester. Richmond was devastated by the attack, and Manchester suffered considerable damage, as well. Troops of both sides occupied Manchester during the war.

Richmond became the capital of the Commonwealth in 1779, and thus enjoyed increased prestige. Manchester, sometimes called the Free State, lived in its shadow. A rivalry developed between Richmond and Manchester, as they competed for new business. In 1785, John Mayo was granted a charter to build a bridge, at the site of the present-day 14th Street Bridge. The first bridge was completed in 1788, but it washed away several times and was reconstructed. It was to be the only bridge across the James, connecting Manchester and Richmond, until 1873. Also in 1785, plans were being developed for the construction of the James River and Kanawha Canal. The canal company's engineer thought that the best route would be through Manchester. Several wealthy British commercial houses had establishments in Manchester and imported large quantities of goods. With three tobacco inspection stations and a flour mill, Manchester felt herself a rival of Richmond, and may have been a powerful one too, but for the selfish and narrow minded policy of one of her richest Scottish merchants. He believed that if the canal was brought to Manchester it would attract too many merchants and create competition for his business. Patrick Henry was retained, for a large fee, and succeeded in diverting the canal's construction to the Richmond side of the river. This proved a hollow victory as many merchants moved their enterprises to Richmond, to be near the canal. Manchester declined until no trade remained.<sup>4</sup> Since Manchester held water rights for half of the river, many good sites were available for mills. This combined with low taxes and less expensive land were the factors that helped to revive the economy.

Early National Period 1789-1830

When President George Washington toured the South in 1791, he came to Manchester. Crossing from Richmond via the Mayo Bridge, he received a twenty-one-gun salute. Washington had several friends in Manchester. Among them were Patrick Coult, who ran the ferry, Archibald Freeland, a Scottish tobacco exporter, and Archibald Cary, who was the magistrate for a time. While residing in Richmond in the 1790s, famed architect, Benjamin Henry Latrobe entered the following description of Manchester in his diary. "Manchester is a small decaying town irregularly built upon irregular ground. Not a tree exists to enliven the dead appearance of its wooden buildings." By contrast at the same time, French traveler Duc de la Rochefoucauld-Liancourt said "...the little, and well built town of Manchester, environed by cultivated fields, which are ornamented by an infinite number of trees, and dotted with scattered houses, embellishes the sweet, variegated, agreeable and romantic perspective."<sup>5</sup> In 1798, the first church was built in Manchester. A Methodist group built a simple wooden structure, later known as the Old Plank

**U. S. Department of the Interior  
National Park Service**

**National Register of Historic Places  
Continuation Sheet**

Section number   8   Page  23 

Manchester Residential and Commercial Historic District  
Richmond, Virginia

Church, at 10<sup>th</sup> and Perry Streets, near the edge of the historic district. With the coming of a new century, new inventions awed the citizens of Manchester and Richmond.

By 1805, the primary development in Manchester was in the warehouse and industrial area along the James River. In this era the economy was principally based on tobacco, which was grown locally and exported across the Atlantic and exchanged for needed products made there. But the plateau to the south offered an area for expansion and a more pastoral setting for Manchester's wealthier citizens to build their residences above the river and the waterfront development. In 1809-1810, Richard Young prepared a map of Richmond and part of Manchester, in Chesterfield County. The Manchester portion shows "Turnpike Road", later to be named Hull Street, leading from Chesterfield, through Manchester to the south end of the Mayo Bridge, and into Richmond. The named streets, in Manchester, crossing Hull Street were Jackson Street, later to be 5<sup>th</sup> Street, and Biddle Street, later to become 6<sup>th</sup> Street. The map also shows the mill canal, the mill pond at Mayo's Mill and the mill race.

In 1811, Edwin C. Trent attempted to build a second bridge across the James, but his engineering was flawed. He built the bridge only two feet above the water, and it washed away almost immediately. The early 1800s and in particular, the years of 1812 and 1813 were nervous times for Richmond and Manchester. *Life still depended on trade across the Atlantic and many countries paid tribute to pirates for protection on the open seas.* Further, war against Great Britain had been declared on 12 June 1812 and volunteers were called to fill Virginia's quota for the militia. This era produced American naval heroes whose names would later adorn the streets of Manchester. The Turnpike Road shown on Richard Young's 1809-1810 map of Richmond and Manchester would be named for Commodore Isaac Hull who served in the war with Tripoli and later became commandant of the Boston Naval Yard. Bainbridge Street gets its name from William Bainbridge, Commander of the warship Constitution in the war of 1812. Porter Street gets its name from Commander David Porter, who captured nine prizes in one cruise from New York to the West Indies during the War of 1812. Perry Street is named for Commander Oliver Perry who effected the surrender of the British Fleet on the Great Lakes in the War of 1812. Decatur Street is named for Commodore Stephen Decatur, who was the commander of the warship Constitution in the Tripoli War in 1803. Originally, the cross streets of Manchester were also named for American military heroes, but those names were later replaced with numbers.<sup>6</sup>

Since the settlement and colonial periods, Manchester's growth has never matched the pace of Richmond's. Many buildings, both public and private, constructed during the Early National Period in Manchester have disappeared over the years. The first school in America for the deaf and dumb was founded in Manchester in 1818. It was in the old Masonic Hall (no longer standing) at 5th and Hull Streets. Around 1821, a group of free blacks started holding church meetings at a member's home. Two years later, they erected a building (no longer standing) on 7th Street, on the edge of the historic district, known as the Slab Church. The Freeland and Jones Houses are the only remaining buildings in the historic district from this era. The earliest dwelling is the Archibald Freeland House, built ca. 1797. The large brick house, which dominates the 1000 block of Bainbridge Street, was called "the mansion"

**U. S. Department of the Interior  
National Park Service**

**National Register of Historic Places  
Continuation Sheet**

Section number   8   Page  24 

Manchester Residential and Commercial Historic District  
Richmond, Virginia

by old residents. Freeland, a native of Glasgow, Scotland, came to Virginia in 1780. He was in the tobacco export business. The house was probably built by John Murchie, one of the early trustees of the town of Manchester, and later bought by Freeland.<sup>7</sup> The Freeland House was purchased by the Manchester Lodge Number 843 of the BPOE and was used as an Elks Club for nearly 30 years. The substantial brick dwelling at 115 West 12<sup>th</sup> Street, built ca 1814, is best known as the home of Manchester physician, Dr. Thomas D. Jones. It stands, set back from the street, on lot number 105, purchased from William Byrd's trustee, by Thomas and Mary Turpin of Powhatan County. The lot was sold in 1797 to Manchester merchant, Archibald Campbell. In 1798, Campbell insured a frame house on this lot, measuring thirty-two feet by eighteen feet, for \$500. Campbell died owing money and Thomas Treadway bought the property at public auction and sold it to Edward Johnson in 1811. Johnson sold it in 1814 to Robert Cary Jennings and Jennings insured the brick house and kitchen for \$3,400. Jennings sold the property in 1817 to Branch Cheatham who owned a tavern on Hull Street. The house was enlarged in the 1870s, ownership changed hands numerous times until it was purchased by Dr. Thomas Jones in 1912 for \$8,000.<sup>8</sup> The Freeland and Jones Houses are similar Georgian-style dwellings built in an era when wealthy Virginia planters and merchants emulated the style of choice among the gentry in the British Isles. This style also reflected Virginia's economic and social ties to Britain after the War of Independence.

*The Antebellum Period 1830-1860*

Coal mining became increasingly important to Manchester and Chesterfield County by 1830. A tramway, built in 1831, hauled coal from the mines at Midlothian to the port in Manchester. The tramway, among the first of its kind in the nation, was powered by gravity. Mules were loaded in the rear car to pull the empty cars back to the mines. The coal tram operated until 1856. The railroads came to Manchester, beginning in 1836, when Hull Street Station was built. The tracks were run from Manchester to Danville around 1847, and a railroad bridge was built across the James in 1850. Manchester became one of the most important commercial and industrial centers in Virginia. In 1860, Manchester's population totaling 2,793, was made up of "1,828 whites, 222 free colored and 743 slaves."<sup>9</sup>

The Bainbridge Street Baptist Church, a Greek Revival-style building, was constructed in 1857 at the corner of 11th and Bainbridge streets. A Baptist Sunday School had been organized in the area as early as 1816. The Baptists, for a time met in the Old Masonic Hall and in 1846 they purchased the Methodist's Old Plank Church. The present church building was started in 1855 and is still in use by descendants of the original congregation. A well know preacher there, from 1858 until 1867, William E. Hatcher wrote letters to newspapers under the pen name "Struggle". Hatcher pretended to be a mill girl and commented on the abuses of the mills and other town problems.<sup>10</sup> The Turner-Baldwin House, a substantial brick Greek Revival-style dwelling at 1209 Porter Street, was originally the property of Col. David Patteson. The property transferred to Holden Rhodes and his heirs sold the property to Esther

**U. S. Department of the Interior  
National Park Service**

**National Register of Historic Places  
Continuation Sheet**

Section number   8   Page  25 

Manchester Residential and Commercial Historic District  
Richmond, Virginia

Lazendre, a free black woman in 1859. It was held in trust by her son, Solomon Turner. The deed said that she had resided there for "some years".<sup>11</sup> Bainbridge Baptist Church and the Turner-Baldwin House are the only remaining buildings in the historic district from this era. The Confederate engineer's maps from 1865 show scattered buildings in the historic district, all except four, have been lost, or were later replaced in the late-nineteenth century.

*The Civil War 1861-1865*

When the Civil War began in 1861, Manchester's industries and citizens were enlisted in the cause of the South. The Manchester Elliot Grays and the Manchester Artillery were the two most prominent units. When Richmond became the Confederate Capital, existing defenses were built up even more. Confederate Military maps indicate several artillery batteries, outside of the historic district, around Manchester. An extensive Confederate naval yard was developed, southeast of Manchester, down river and outside of the historic district.

On 2 April 1865, Confederate troops evacuating Richmond came across the Mayo Bridge, and burned it behind them. Confederate President Jefferson Davis, along with his family, fled to Danville. He boarded the train in Manchester. General Grant and his victorious Federal Army, rode through Manchester, having built a pontoon bridge to serve as a temporary crossing. General Lee and the remainder of his troops came through after the surrender at Appomattox.

After the fall of Richmond, William Ira Smith, proprietor of the Richmond Whig published a map, drawn on stone by C. L. Ludwig showing the burnt districts of Richmond. The map showed both Richmond and Manchester. The Confederate Navy Yard, east of Manchester, was the only "burnt" area south of the river. The map shows that the Mayo Bridge, the Richmond and Danville Railroad Bridge and the Richmond and Petersburg Railroad Bridge had been burned, as well. The burning of those bridges by the evacuating troops minimized the burning of Manchester. The map also shows a "new pontoon" bridge, just east of the burned Mayo Bridge, crossing the eastern tip of Mayo's Island. A Matthew Brady photograph taken in 1865, from the north side of the river in Richmond, looking south to Manchester shows the pontoon bridge and the extensive flour, cotton and woolen mills on the Manchester side, below the historic district. Manchester had escaped serious damage during this period. Few buildings were constructed during this period and none remain in the historic district.

*Reconstruction & Growth 1865-1917*

As with the rest of the South, the next years found Manchester in an economic depression and faced with military occupation. After the initial lull of Reconstruction, Manchester experienced a period of growth, unmatched at any other time. Manchester had been, and would remain a "working class"

**U. S. Department of the Interior  
National Park Service**

**National Register of Historic Places  
Continuation Sheet**

Section number   8   Page  26 

Manchester Residential and Commercial Historic District  
Richmond, Virginia

community reliant upon employment in the mills, the trade related businesses, and the transportation systems concentrated at the falls of the James River. In 1870 Manchester's population totaled 2,599, made up of "1,517 whites, 1,082 colored and 40 foreign."<sup>12</sup> Two buildings can be found in the historic district that were constructed in the early years of Reconstruction. The John B. Anderson House, a 1 ½ story, frame dwelling was built in 1867. In 1819 the lot belonged to tavern keeper, Zachariah Brooks, whose tavern was on the same square. Brooks sold the lot to Mary Jones in 1833. She in turned sold part of the lot to James Donely in 1855. In 1867, both Jones and Donely owned parts of the lot with buildings valued at \$200. In 1874, Donely's wife Jane sold part of their lot with improvements to John B. Anderson for \$800. This part of the lot is labeled "JBA" on the Beers map. Anderson was living there in 1877, and the 1885 census listed his occupation as "nailer". Anderson died in 1894.<sup>13</sup>

Meade Memorial Episcopal Church, a frame, Gothic Revival-style building with wooden buttresses along the sides, was erected in 1869 as a memorial to Bishop William Meade. For a number of years after the Revolutionary War, the Episcopal Church was in dire straits, as it represented to many people the power and coercion of Great Britain. The Manchester Parish had been formed from Dale Parish in 1722 but it was dissolved in 1778. As early as 1791 the General Assembly passed a law allowing a group to raise money for an Episcopal Church in Manchester, but nothing happened until much later. In the early 1800s, the Episcopalians met in the Masonic Hall at 5<sup>th</sup> and Bainbridge Streets. The cornerstone for the new church was laid in the presence of the rectors of Saint James' and Saint Paul's Episcopal churches in Richmond. The first rector of Meade Memorial was J. E. Hammand, who served until 1873. The church was replaced in 1929, by Saint Luke's on Cowardin Avenue. Today, the church is used by another congregation.

Manchester served as the county seat for Chesterfield County for three years, beginning in 1871. The Colonial Revival Manchester Courthouse was built in 1871 as the Chesterfield County courthouse. Albert West was the architect and Capt V. J. Cutter was the general contractor. Among the craftsmen who worked on the building were J. H. Ragland, mason; Edward Gallegher, plasterer; and Arthur Evans, faux finisher. When Manchester became a city, in 1874, the county seat was moved back to the old Chesterfield County Courthouse and the Manchester courthouse continued to serve the newly formed city. The 1910, Act of the Assembly, consolidating Manchester and Richmond, required that a courthouse be maintained on the south side of the river. The courthouse is still in use as a General District and Circuit Court for the city of Richmond. When constructed the Manchester Courthouse shared the block with a jail, a market and the Methodist-Episcopal Church. Those buildings have disappeared, and additions to the Courthouse in 1923, 1940 and 1969 have covered the west side of the block.<sup>14</sup>

In 1874 a town census revealed a population of 3,207 white and 1,935 black citizens. Most of the citizens of Manchester believed it should become a city, independent from Chesterfield County and in March 1874 the General Assembly granted Manchester a City Charter.<sup>15</sup> In 1876, the streets were finally graded and improved under the direction of Andrew L. Johnson, a graduate of VMI. That same

**U. S. Department of the Interior  
National Park Service**

**National Register of Historic Places  
Continuation Sheet**

Section number  8  Page  27

Manchester Residential and Commercial Historic District  
Richmond, Virginia

year the city finally got new and improved street lamps. The *Richmond Whig* stated that the "same lamp is used in some of the large Northern cities."<sup>16</sup> Railroads, shipping, mining, and manufacturing, along with a thriving retail sector, all contributed to the economy. Flour from local mills was widely exported. Some enterprising millers had trade agreements with Brazil. They imported coffee, which had been exchanged for flour.

The 1876 Beer's Atlas Map of Manchester shows the historic district in great detail. Along Hull Street, the predominate structures were small, detached, frame businesses and dwellings. Dwellings, were scattered along Bainbridge, Porter & Perry Streets and a reservoir had been built at the corner of 11<sup>th</sup> and Bainbridge Streets, to provide domestic water service. The Ingram House, 1201 Porter Street, with its cast iron porch, was built in 1876 and is best know as the home of Dr Sylvanus Ingram and his son Dr. Lawrence Ingram. Sylvanus was from Lunenburg County, Virginia and had studied in Charlottesville, Philadelphia and Paris. During the Civil War he was a surgeon attached to Courtney's Battery. After the war he briefly returned to Lunenburg before setting up practice in Manchester. Sylvanus' son, David, graduated from the Medical College of Virginia in 1886, became head of the Manchester Board of Health and founded the Manchester Almshouse. Sylvanus' other son was John H. Ingram who became a judge and was a member of the Constitutional Convention of 1901-1902.

The end of the War and Reconstruction spurred the business interests of the recently freed black citizens. The Reformers Mercantile and Industrial Association, a black owned business, was formed and constructed a two-story, brick building at 1324 Hull Street. Much altered and connected to the adjacent building, the Reformers building is in use today as a furniture store. During the Reconstruction era, Ballard T. Edwards, a black man born free in Manchester, was elected to the Virginia House of Delegates. Edwards, a Republican, was a master bricklayer, plasterer, and contractor. He was instrumental in saving the state capitol building from being demolished after the fatal collapse of the House of Delegates balcony in 1870. Edwards was also a principal sponsor for the construction of the second bridge to span the James. The Free Bridge, on the site of the present Manchester Bridge, or Ninth Street Bridge, was built in 1873. When the Free Bridge was later rebuilt, a streetcar track was installed, one of the first streetcar systems in America. Edwards fell out of political favor when he proposed legislation to ban discrimination in public transportation. He was succeeded in office by another free black, Henry J. Cox. Edwards was a member of the African Baptist Church at 15th and Decatur Streets. The congregation continues today at that location.

A series of articles in the *Richmond Dispatch* during September 1878 related the present state of Manchester. Porter Street was called "Manchester's 5<sup>th</sup> Avenue". The articles spoke of the street grading, the hansom new porch on the Taylor mansion and the new granite wall at the Presbyterian Church. Also mentioned were the residences of Maj. John Vaughan, Thomas Fendley, Robert Perdue, James Patteson, Reverend D. B. Winfree, Walter Cheatham, Dr. Ingram and others. These houses were described as "mostly brick and all handsome."<sup>17</sup> By 1880 Manchester's population had grown to 5,729 people.<sup>18</sup> The city had 631 acres and 21 miles of streets and by 1881 there were "a dozen

**U. S. Department of the Interior  
National Park Service**

**National Register of Historic Places  
Continuation Sheet**

Section number   8   Page  28 

Manchester Residential and Commercial Historic District  
Richmond, Virginia

telephones" connecting it with Richmond.<sup>19</sup> In 1885, the Manchester and Richmond Street Railway began operating on a route between Manchester and Richmond. The first cars were pulled by horses and mules and the system was electrified in the 1890s. The street railway was built by Lewis H. Blair and purchased by Joseph Bryan. Manchester's Mayor John E. Taylor was first president of the line.<sup>20</sup>

The question of Virginia's policy in regard to saloons and liquor replaced the old issues of free silver, sectionalism and the Negro in politics. The anti-liquor crusade immersed itself in State politics with the goal of achieving statewide prohibition. The strategy was to curtail the use of liquor by mobilizing public opinion against the granting of licenses and by outlawing the saloon. A law was passed for local option liquor in 1886.<sup>21</sup> In voting on liquor licenses in Manchester, the "wets" defeated the "drys" by a vote of 974 to 348.<sup>22</sup> While most areas of Virginia became dry by 1900, Manchester, typical of the developing urban areas, would remain wet. Taverns continued to develop in Manchester and distilling alcohol would become another business enterprise. The buildings of the Burke & Moore Saloon, at 1437 Hull Street, built in 1895, and the Southside Distilling Company, at 1111 Hull Street, are still standing.

The 1886 Sanborn Map of Manchester illustrates the development of part of the historic district along Decatur, Hull and Bainbridge Streets, from 9<sup>th</sup> to 14<sup>th</sup> Streets. By 1886, the density of frame commercial buildings along this part of Hull Street, had increased. While some buildings reflected vernacular trends, Italianate and Queen Anne style were the most popular. In 1886, 1109 Bainbridge Street was built and later served as the home for the Bainbridge Street Baptist Church's preacher.

Before the Civil War, education was primarily a private matter. Virginia's Reconstruction Constitution permitted Negro suffrage and provided for a system of public education advocated by Robert E. Lee and others. The debt of the War would plague the finances of Virginia and public education would flounder until late in the nineteenth century.<sup>23</sup> Early in the nineteenth century Archibald Freeland, David Weisiger, Washington Weisiger, Miles Bott, Zachariah Brooks, Samuel Taylor and others successfully petitioned the legislature to establish the Manchester Academy which opened in 1809 and continued to operate into the 1860s. In 1815, Reverend John Kilpatrick opened a school in the Masonic Hall and in the 1820s Mrs. Eliza Harris opened a school for young ladies in Manchester. In 1870, funds were appropriated for the Free School of Manchester and by 1871 the Richmond Dispatch reported that Manchester had three public schools. In 1872, the School Board asked for a school tax and it was approved. The Manchester City Council, in 1875, proposed the building of one new school for whites and one new school for blacks to replace inadequate facilities that were serving 400 white and 200 black pupils. The first Manchester High School building was on Hull Street between 4<sup>th</sup> and 5<sup>th</sup> Streets and the Manchester Public school on West 8<sup>th</sup> Street.<sup>24</sup> The Matthew F. Maury School at 1411 Bainbridge Street was built as the Bainbridge Elementary School in 1888 to serve the black community with James Blackwell as the principal. The nearby Blackwell neighborhood is named in his honor. The school was renamed in 1919 for Matthew F. Maury (1806-1873), a noted Confederate naval officer and geographer known as "Pathfinder of the Seas." In 1922, end bays and a rear wing designed by Charles M.



**U. S. Department of the Interior  
National Park Service**

**National Register of Historic Places  
Continuation Sheet**

Section number   8   Page  29 

Manchester Residential and Commercial Historic District  
Richmond, Virginia

Robinson, an architect noted for his school designs at the turn of the century, were added to the building nearly doubling its size.<sup>25</sup>

In 1888, Manchester and Chesterfield officials had Colonel C. P. E. Burgwyn, a Civil Engineer, prepare a report on the physical and geographic features of the area and demonstrate their great potential from an engineering standpoint, especially, the prospect of water power facilities at the falls of the James River. Burgwyn concluded that during the summer season, the driest of the year, water falling at Manchester would give 21,040 horsepower which compared favorably with other cities. Burgwyn noted that the horse power at Manchester greatly exceeded that of Holyoke Mass, Manchester NH, Lowell, Mass, Lewiston, Maine and Lawrence, Mass. Manchester and Chesterfield were clearly trying to capitalize on their positions at the fall of the James to join in the national trend of industrial expansion.<sup>26</sup>

In 1890, the United States Census recorded Manchester's population at 9,246.<sup>27</sup> The 1895 Sanborn Map of Manchester shows a marked change in building development. The early detached, frame dwellings and commercial buildings along Hull Street were giving way to attached brick commercial buildings. The heaviest construction along Hull Street by 1895 was in the 1100, 1200 and 1300 blocks. These were all multistory brick commercial buildings like the Beattie Block, 1119-1125 Hull Street, built in 1887 to serve multiple businesses. The growth of new dwellings was greatest in the 1100 block of Porter Street and in the 1300 and 1400 blocks of Bainbridge Street. There are approximately thirty-seven buildings in the historic district that were constructed in the 1890s. Italianate and vernacular styles were the most popular for commercial buildings, while the Queen Anne and Italianate styles of architecture dominant for residential building.

The increase in the number of churches responded to the growth in the business and residential sectors of Manchester. The first meeting of the Presbyterians in Manchester occurred when Parson Turner established a Sunday School at the old Masonic Hall on 5<sup>th</sup> Street in 1812. In 1870 a meeting, sparked by Miss Margaret Allen, was held to organize the First Presbyterian Church of Manchester. The first elders were William Buell and Henry Fitzgerald and the Deacons were O. H. Clarke and W. T. Lithgow. In July 1889 construction began on the First Presbyterian Church of Manchester at 10<sup>th</sup> and Porter Streets. The name was changed to Porter Street Presbyterian Church in 1910 when Manchester consolidated with Richmond. In 1966 the congregation left for a new church, Southminster Presbyterian Church in Chesterfield County and the Porter Street Church was torn down. The Church Manse, built 1895, still stands today at 1008 Porter Street.

In 1876, Bishop James Gibbons purchased a tract of land at 14<sup>th</sup> and Perry Streets and in the same year a Catholic Sunday School was started at the home of John A. Carroll just outside of Manchester. There were over 40 Catholic families in Manchester and northern Chesterfield County, most of whom worshiped at Saint Peter's or at Saint Mary's in Richmond. The Sunday School developed into a day school and in 1897 a new school was built.<sup>28</sup> Thomas Fortune Ryan of Nelson County, Virginia, moved north to Baltimore and then New York, where he purchased a seat on the New York Stock Exchange, and

**U. S. Department of the Interior  
National Park Service**

**National Register of Historic Places  
Continuation Sheet**

Section number   8   Page  30 

Manchester Residential and Commercial Historic District  
Richmond, Virginia

within several years had become a multimillionaire. Ryan is best known for his wealth and the formation of the American Tobacco Company and British-American Tobacco Company. Ryan also had significant political influence and was an intimate friend of Virginia's powerful, Democratic United States Senator Thomas Martin. Through the years Ryan generously supported Catholic charities including the Cathedral of the Sacred Heart in Richmond. Over his life time his charitable contributions amounted to about \$20,000,000.<sup>29</sup> Sacred Heart Catholic Church was built at the corner of 14<sup>th</sup> and Perry Streets in 1901. Mrs. Thomas Fortune Ryan contributed the money for construction of the church, and requested that the church be named Sacred Heart. The new church dedicated on 1 December 1901, was built by Fritz Sitterding at a cost of \$14,608.91. The first priest was Father Thomas Waters. The rectory was built next door in the same year. The church and school have thrived since that time.<sup>30</sup>

The Methodist church in Manchester dates to about 1786 when services were held in the home of John Botts. In 1798 the "Old Plank Church" was built at 10<sup>th</sup> and Perry Streets and demolished about 1896. About 1846, the Methodists built a new church on 9<sup>th</sup> Street between Hull and Decatur. In 1899 the Gothic style Central United Methodist Church at 13<sup>th</sup> and Porter Streets was built, replacing the 9<sup>th</sup> Street church. Mr. John Hughes, a faithful member, always there, always fell asleep when the sermon was preached, because, he had "perfect confidence in the preacher." Frank B. Dunford has compiled an excellent history of the church still in use by the congregation today.

The 1900 United States Census recorded Manchester's population at 9,715.<sup>31</sup> The 1905 Sanborn Map of Manchester continued to show an increase in building development since the publication of the 1895 map. New brick commercial buildings were constructed on Hull Street and new dwellings were built on the numbered cross streets as well as Bainbridge, Perry and Porter Streets. There are approximately thirty-nine buildings in the historic district that were constructed between 1895 and 1905. In 1905, the Baldwin Building at 1209 Hull Street was built as the first, full service department store in Manchester. While a variety of merchandise was available in the many shops along Hull Street, the Baldwin Department Store provided that variety on three floors under one roof. The building was designed by architect Wiley Anderson. The Baldwin Department Store was later purchased by Thalhimer's Department Stores of Richmond and made a part of that chain. The building was most recently used as a bookstore.

In 1906 the Hill Directory Company of Richmond published the first business directory of Manchester, independent of Richmond, with street addresses. The directory lists seven law firms, three bakers, thirteen barbers, two bicycle dealers, seven blacksmiths, thirteen boarding houses, six brick manufacturers, nine butchers, six druggists, seventeen dry goods stores, three eating houses, sixty-five grocers, seven meeting halls, seven insurance companies, three laundries, four newspapers, fourteen physicians, fifteen saloons and ten shoemakers. Businesses owned by blacks were noted with an asterisk. All the boarding houses were owned by whites while all of the eating houses were black owned. Sixteen of the grocery businesses were listed as black owned, including the Reformers Mercantile and Industrial Association's grocery at 1322 Hull Street. Of the fourteen physicians, three

**U. S. Department of the Interior  
National Park Service**

**National Register of Historic Places  
Continuation Sheet**

Section number   8   Page  31 

Manchester Residential and Commercial Historic District  
Richmond, Virginia

were black including William H Hughes at 1413 Hull Street. The Burke & Moore Saloon operated at 1437 Hull Street, Jonathan Onesty operated a saloon at 1309 Hull Street, and Robert J Morris, a black, operated a saloon across the street at 1316 Hull Street. While there was no distinct neighborhood designated for black owned businesses at this time, the majority of the black businesses and residences were in the 1000, 1100, 1300 and 1400 blocks of Hull Street.<sup>32</sup>

In 1907, possibly to keep pace with national and regional industrial expansion, the City of Manchester's Committee of Industries published a booklet touting special inducements to manufacturers noting a profitable field for investors. The population was listed as 15,000 with the Manchester city and suburbs, magnificently located on the James River, opposite Richmond. Large establishments recently located on Manchester included the Virginia-Carolina Chemical Company, the Richmond Electric Company, the Blair Glass Works, the Standard Paper Manufacturing Company, the Standard Oil Company, the Carrington Tobacco Factories, the American Bridge Company, the American Foundry Company and the Virginia Metal Company. Shipping facilities and access to raw materials were noted as advantages for wood working plants. The shipping facilities were all outside, and along the edge of the historic district and they included the Manchester wharves, the Southern Railway, the Seaboard Air Line, the Norfolk and Western and the Atlantic Coast Line railroads. The booklet noted that there were twenty-nine schools in Manchester, twenty for white students and nine for colored students. The Merchants and Mechanic Bank, J. H. Patteson, cashier, had deposits of nearly \$500,000 and the Bank of Manchester, Clarence Vaden, cashier, had deposits of nearly \$250,000. The new city waterworks had a capacity 1,500,000 gallons per day and gas and electricity provided lighting. The city also touted a fire department that was well equipped with paid firemen. The demand for new residences in Manchester was great and suburban building lots close to street railways could be purchased at low rates.<sup>33</sup>

In 1908 discussions of consolidating Richmond and Manchester were renewed. There had been earlier discussions as far back as 1878 but nothing substantial had come of them. In the meantime, Manchester had financial difficulties and was making overtures to manufacturers and other commercial bodies to locate in the south side. Richmond was fast becoming a financial center, and soon became cognizant of Manchester's financial ills and began to look for a remedy. William T. "Booster Bill" Dabney operated a cigar and soda emporium near 9<sup>th</sup> and Main Streets in Richmond. Dabney was a member of the Richmond Board of Aldermen and chosen, without opposition, to be the business manager for the Richmond Chamber of Commerce. Early in 1908, Dabney pursued the idea of consolidation with members of the two cities municipal bodies. In February of 1908 the General Assembly approved an Act of Consolidation subject to the consent of the majority of the voters in the city of Manchester. Dabney went door to door in Manchester selling the consolidation idea. In spite of some opposition, the vote on 4 April 1908 was 513 for consolidation versus 223 against. Effective 15 April 1910, Manchester became a part of the City of Richmond. This addition to the city was regarded as the ace of the eleven expansions to the Capital City prior to 1960.<sup>34</sup> Manchester did not die with consolidation, but prospered as part of Richmond.

**U. S. Department of the Interior  
National Park Service**

**National Register of Historic Places  
Continuation Sheet**

Section number   8   Page  32 

Manchester Residential and Commercial Historic District  
Richmond, Virginia

Manchester had often been referred to as "Dog Town". The earliest mention is found in an 1887 *Richmond Times* newspaper article. Benjamin Weisiger writes that there have been a lot of theories but the most common explanation by old-timers refers to the large number of dogs in Manchester "Everybody had a dog." The late Major John Wright said that the name originated among students at old John Marshall High School just before World War I, when the school received an influx of Manchester students after consolidation. Wright felt that it was not intended as a compliment but the term has stuck to the area.

The 1910 Sanborn Map of shows extensive commercial development along Hull Street with only a few frame dwellings and commercial structures remaining. By 1910, there were only four small frame structures on the southside of the 1400 block. The north side of the 1500 and 1600 blocks, were almost without any development except for B. P. Vaden's Hardware Store at 1501 and D. D. Harrison's Drug Store at 1503 Hull Street. The Manchester Post Office had been built at the corner of 10<sup>th</sup> and Hull Streets. Black owned businesses still occupied the commercial section of Hull Street in the 1000, 1100, 1300 and 1400 blocks. Italianate and Colonial Revival styles were the most popular styles for commercial buildings. The Merchants and Mechanics Bank, a two-story Classical Revival building was built in 1915 at 1129 Hull Street. The Standard Drug Company, a locally owned business built a two-story Italianate branch store at 1319 Hull Street in 1910. In 1913, the old Mayo's Bridge (outside of the historic district, connecting Manchester and Richmond) was replaced with a new concrete span, bearing the same name. It is still in use today, with few changes.

*World War I & World War II 1917-1945*

During World War I, many of Manchester's factories and shipping facilities were enlisted to support the war effort. The suburban area surrounding Manchester, namely Swansboro, Springhill, Woodland Heights and Forest Hill continued to expand. Each of these distinctive neighborhoods shared a common reliance on the Hull Street commercial corridor and access across the Mayo and 9<sup>th</sup> Street Bridges into Richmond. After World War I, the area continued to thrive until the Great Depression and, like everywhere else, it suffered. When the WPA was created, one of its projects was the building of the Robert E. Lee Bridge in 1934. The WPA bridge was recently replaced by a new bridge, which bears the same name. Cowardin Avenue, extending south from the Lee Bridge forms the western edge of the historic district.

Numerous new buildings were erected in the historic district during this period. New commercial buildings on Hull Street began to "fill in the gaps" between the 1890-1915 commercial development. The Bank of Commerce & Trusts, a three-story, Classical Revival, building at 12<sup>th</sup> & Hull Streets was opened in 1921. The Venus Theater, a two-story, Classical Revival, movie theater was opened in 1926. American Bank and Trust Company, later to become State Planters Bank, and then Crestar, opened a

**U. S. Department of the Interior  
National Park Service**

**National Register of Historic Places  
Continuation Sheet**

Section number   8   Page  33 

Manchester Residential and Commercial Historic District  
Richmond, Virginia

three-story, Art Deco building at 16<sup>th</sup> and Hull Streets in 1930. F. W. Woolworth and Company opened a store at 1317 Hull Street in 1935. Commercial development was not limited to the larger scale buildings. In 1926, Martin The Cleaner, Mrs. Susie Shumaker and the Singer Sewing Machine Company opened in adjoining one-story Spanish Colonial storefronts at 1430-32-34 Hull Street.

This era saw the introduction of a new house type, the American Foursquare. The box-form house provided a new plan that eliminated the narrow side-hall so typical in the houses built earlier. Illustrating the influence of the automobile on architecture, the Dr. W. H. Craig House at 1306 Porter Street, built in 1926, is an American Foursquare with a porte cochere so that Dr. Craig could go from his car into the house, thus avoiding inclement weather. Another good example of the American Foursquare-style is the dwelling at 1304 Bainbridge Street, built in 1935. Showing the growing affects of urbanization, apartment buildings were constructed in 1934 at 1400, 1402 and 1404 Bainbridge Street.

The post World War II years have seen the steady decline of the former city of Manchester. Hull Street was still an active retail strip until the 1960s, when suburban development came, most notably, South Side Plaza Shopping Center further out on Hull Street. Scattered site public housing development made its debut east of Hull Street, and along Decatur Street in the 1960s, removing older residential buildings along the eastern edge of the historic district. In the early 1970s Overnite Transportation Company built its corporate headquarters on Semmes Avenue, just outside the historic district. By 1977, J. Harwood Cochrane, founder of the Overnite Transportation Company, had purchased more than 160 parcels in Manchester at a cost of over \$8,000,000 and began demolishing the old buildings. The Richmond Times Dispatch reported in 1977 that Overnite's presence had "created an uneasiness in the neighborhood that is heightened by the roar of a bulldozer grinding old houses into oblivion."

**END NOTES**

<sup>1</sup> Kenneth Shores, From Rocky Ridge to Richmond: Research Paper, page 31.

<sup>2</sup> Benjamin B. Weisiger, III, Old Manchester & Its Environs, 1769-1910, page 5.

<sup>3</sup> Alexander Wilborne Weddell, Richmond, Virginia in Old Prints, page 14-19.

<sup>4</sup> Samuel Mordecai, Richmond In By Gone Days, page 249-251.

<sup>5</sup> Benjamin B. Weisiger, III, Old Manchester & Its Environs, 1769-1910, page 9.

<sup>6</sup> Richmond Times Dispatch, Manchester: City's Most Valuable Addition, April 10, 1960

<sup>7</sup> Benjamin B. Weisiger, III, Old Manchester & Its Environs, 1769-1910, page 101.

<sup>8</sup> Benjamin B. Weisiger, III, Old Manchester & Its Environs, 1769-1910, page 119.

<sup>9</sup> United States & Virginia Census, 1860.

<sup>10</sup> Benjamin B. Weisiger, III, Old Manchester & Its Environs, 1769-1910, page 127.

<sup>11</sup> Benjamin B. Weisiger, III, Old Manchester & Its Environs, 1769-1910, page 107.

**U. S. Department of the Interior  
National Park Service**

**National Register of Historic Places  
Continuation Sheet**

Section number   8   Page  34 

Manchester Residential and Commercial Historic District  
Richmond, Virginia

- 
- <sup>12</sup> United States & Virginia Census, 1870.  
<sup>13</sup> Benjamin B. Weisiger, III, Old Manchester & Its Environs, 1769-1910, page 123.  
<sup>14</sup> John O. & Margaret T. Peters, Virginia's Historic Courthouses, page 140.  
<sup>15</sup> Benjamin B. Weisiger, III, page 21.  
<sup>16</sup> Benjamin B. Weisiger, III, page 20.  
<sup>17</sup> Benjamin B. Weisiger, III, page 21.  
<sup>18</sup> United States & Virginia Census, 1880.  
<sup>19</sup> Benjamin B. Weisiger, III, page 23.  
<sup>20</sup> Benjamin B. Weisiger, III, page 23.  
<sup>21</sup> Allen W. Moger, Virginia: Bourbonism to Byrd, 1870-1925, page 297.  
<sup>22</sup> Benjamin B. Weisiger, III, page 23.  
<sup>23</sup> Allen W. Moger, Virginia: Bourbonism to Byrd, 1870-1925, page 6-7.  
<sup>24</sup> Benjamin B. Weisiger, III, page 40-41.  
<sup>25</sup> Richmond Public Schools, Department of Plant Services, Facilities Records.  
<sup>26</sup> Col. CPE Burgwyn, Report on Advantages and Water Power Facilities for the City of Manchester.  
<sup>27</sup> United States & Virginia Census, 1890.  
<sup>28</sup> Benjamin B. Weisiger, III, page 131.  
<sup>29</sup> Allen W. Moger, Virginia: Bourbonism to Byrd, 1870-1925, page 268-269.  
<sup>30</sup> Benjamin B. Weisiger, III, page 131-132.  
<sup>31</sup> United States & Virginia Census, 1900.  
<sup>32</sup> Hill Directory Company, The 1906 Manchester City Directory  
<sup>33</sup> Manchester City, Committee of Industries, Special Inducements to Manufacturers  
<sup>34</sup> Richmond Times Dispatch, Manchester: City's Most Valuable Addition, April 10, 1960

U. S. Department of the Interior  
National Park Service

National Register of Historic Places  
Continuation Sheet

Section number 9 Page 35

Manchester Residential and Commercial Historic District  
Richmond, Virginia

---

BIBLIOGRAPHY

Beard, Charles A. and Mary R., New Basic History of the United States, Garden City, NY: Double Day and Company, 1944.

Bean, R. Bennett, The Peopling of Virginia, Boston: Chapman and Grimes Publishers, 1938.

Beverly, Robert, The History and Present State of Virginia, Chapel Hill: University of North Carolina Press, 1947.

Burgwyn, Colonel Collinson Pierrepont Edwards, Report of Col. CPE Burgwyn, Civil engineer, On the Natural Advantages and Water-Power Facilities of the City of Manchester, Leader Book and Job Office, Manchester, 1888. (Found at the Virginia State Library, F234 M2 B9)

Chesson, Michael B., Richmond After the War, 1865-1890, Richmond: Virginia State Library, 1981.

Dabney, Virginius, Richmond: The Story of A City, Garden City, NY: Double Day and Company, 1976.

Hill City Directory, Manchester and Richmond City Directories, Hill Directory Company 1906, 1910, 1911, 1915, 1921, 1926, 1930, 1934, 1935.

Lutz, Francis Earle, Chesterfield: An Old Virginia County, Richmond: William Byrd Press, 1954.

Manchester, Virginia, Committee of Industries, Manchester, Virginia Offers Special Inducements to Manufacturers, Manchester: Anderson, 1907. (Found at the Virginia State Library, F234 M2 M2)

McCary, Ben C., Indians in the 17<sup>th</sup> Century Virginia, Jamestown Booklet No. 18, Charlottesville: University Press of Virginia, 1957.

Moger, Allen J., Virginia: Bourbonism to Byrd, 1870-1925, Charlottesville: University Press of Virginia, 1968.

Mordecai, Samuel, Richmond In By-gone Days, Richmond: George West Publisher, 1856, New York: Arno Press, 1975.

Peters, John O. and Margaret T., Virginia's Historic Courthouses, Charlottesville: University Press of Virginia, 1995.

Richmond Afro-American Newspaper:

History South of the James Comes Alive, 24 February – 2 March 1994.

Richmond Times-Dispatch Newspaper:

Manchester, 16 September 1992.

Manchester: City's Most Valuable Addition, Special Section E, 10 April 1960.

Manchester Finally Added to the City in 1910, 8 September 1937.

Manchester Spirit Keeps City's Memory Alive, 28 July 1985.

**U. S. Department of the Interior  
National Park Service**

**National Register of Historic Places  
Continuation Sheet**

Section number   9   Page  36 

Manchester Residential and Commercial Historic District  
Richmond, Virginia

---

Spirit of "Old Manchester" Still Sparks, 13 February 1977.  
Struggle's Hoax, 5 July 1936.

Sanborn Map Company, Manchester, Virginia, New York: Sanborn Map Company, 1886, 1895, 1905, 1910.

Sanborn Map Company, Richmond, Virginia, New York: Sanborn Map Company, 1919-1950.

Scott, Mary Wingfield, Houses of Old Richmond, New York: Bonanza Books, Crown Publishers, 1941.

Serow, William J., The Population of Virginia: Past, Present and Future, Charlottesville: University Press of Virginia, 1978.

Shores, Kenneth, Research Paper: From Rocky Ridge to Richmond, Virginia, Virginia Department of Historic Resources Cultural Resource Management Files, 1977.

Smith, Lavame Byrd, Traveling On: First Baptist Church, South Richmond, 1821-1871, Richmond: First Baptist Church, 1994.

Virginia and United States Census 1860, 1870, 1880, 1890, 1900.

Virginia Department of Historic Resources, Cultural Resource Management File 127-0859, Richmond: 1990 to present.

Weddell, Alexander Wilbourne, Richmond, Virginia In Old Prints, Richmond: Johnson Publishing, 1932.

Weisiger III, Benjamin B., Old Manchester and Its Environs, 1769-1910, Richmond: William Byrd Press, 1993.

Wright, Louis B., The Prose Works of William Byrd of Westover, Harvard Press, 1966.



**U. S. Department of the Interior  
National Park Service**

**National Register of Historic Places  
Continuation Sheet**

Section number 10 Page 37

**Manchester Residential and Commercial Historic District  
Richmond, Virginia**

---

**GEOGRAPHICAL DATA**

**UTM References**

5	18	283750	4154950	6	18	283560	4154960
	Zone	Easting	Northing		Zone	Easting	Northing
7	18	283420	4155030	8	18	283380	4155190
	Zone	Easting	Northing		Zone	Easting	Northing
9	18	283410	4155390				
	Zone	Easting	Northing				

**VERBAL BOUNDARY DESCRIPTION**

The boundaries of the Manchester Residential and Commercial Historic District are as indicated on the accompanying map.

**BOUNDARY JUSTIFICATION**

The Manchester Residential and Commercial Historic District boundaries were drawn to include the largest concentration of historic buildings in the area that once was the City of Manchester. The northern boundary, towards the James River, is defined by open blocks of land and new construction, the result of large-scale demolition that removed a significant number of resources. Commerce Road to the east, formerly 9<sup>th</sup> Street, has been significantly widened and forms the boundary between the residential-commercial area and the warehouse-industrial section of the city. Decatur Street, which forms the southern boundary, is defined by extensive demolition and 1960's scattered site public housing. Cowardin Avenue, a six-lane thoroughfare, defines the western boundary.

**U. S. Department of the Interior  
National Park Service**

**National Register of Historic Places  
Continuation Sheet**

Section number Additional Documentation Page 38

Manchester Residential and Commercial Historic District  
Richmond, Virginia

---

**PHOTOGRAPHIC DOCUMENTATION**

Photographs are of the Manchester Residential and Commercial Historic District, Richmond, Virginia  
VDHR File Number: 127-0859                      VDHR Negative Number: 16596  
Photographs taken 23 March 1998 by Bill Lafoon

Photo 1 of 23  
Archibald Freeland House, 1015 Bainbridge Street  
View of Bainbridge Street elevation, looking north

Photo 2 of 23  
Thomas Jones House, 115 West 12<sup>th</sup> Street  
View of 12<sup>th</sup> Street elevation, looking east

Photo 3 of 23  
Bainbridge Baptist Church, 1101 Bainbridge Street  
View of Bainbridge Street elevation, looking north

Photo 4 of 23  
Turner-Baldwin House, 1209 Porter Street  
View of Porter Street elevation, looking north

Photo 5 of 23  
John B. Anderson House, 12-14 East 12th Street  
View of 12th Street elevation, looking east

Photo 6 of 23  
Meade Memorial Episcopal Church, 1201 Decatur Street  
View of Decatur Street elevation, looking north

Photo 7 of 23  
Manchester Courthouse, 920 Hull Street  
View of Hull Street elevation, looking south

Photo 8 of 23  
1301-1305 Bainbridge Street  
View of Bainbridge Street elevation, looking north

Photo 9 of 23  
Mathew F. Maury School, 1411 Bainbridge Street  
View of Bainbridge Street elevation, looking north

Photo 10 of 23  
Cowardin Avenue Christian Church, 116-118 Cowardin Avenue  
View of Cowardin Avenue elevation, looking west

**U. S. Department of the Interior  
National Park Service**

**National Register of Historic Places  
Continuation Sheet**

Section number Additional Documentation Page 39

Manchester Residential and Commercial Historic District  
Richmond, Virginia

---

Photo 11 of 23  
Manchester Post Office, 1019 Hull Street  
View of Hull Street elevation, looking north

Photo 12 of 23  
1105, 1109-1115 (The Beattie Block) and 1119-1125 Hull Street  
View of Hull Street elevation, looking north

Photo 13 of 23  
1124-1126, and 1128 Hull Street (Bank of Commerce and Trust)  
View of Hull Street elevation, looking south

Photo 14 of 23  
The Baldwin building, 1209-1213 Hull Street  
View of Hull Street elevation, looking north

Photo 15 of 23  
1309-1315 Hull Street  
View of Hull Street elevation, looking north

Photo 16 of 23  
F W Woolworth Company, 1317 Hull Street; Standard Drug Company, 1319 Hull Street; and 1321 Hull Street  
View of Hull Street elevation, looking north

Photo 17 of 23  
1300, 1302, and 1310 Perry Street  
View of Perry Street elevation, looking south

Photo 18 of 23  
1313-1315 Perry Street  
View of Perry Street elevation, looking north

Photo 19 of 23  
1017-1019 Porter Street  
View of Porter Street elevation, looking north

Photo 20 of 23  
1104-1110 Porter Street  
View of Porter Street elevation, looking south

Photo 21 of 23  
Central United Methodist Church, 1213 Porter Street  
Central United Methodist Church Parsonage, 1211 Porter Street  
View of Porter Street elevation, looking north

**U. S. Department of the Interior  
National Park Service**

**National Register of Historic Places  
Continuation Sheet**

Section number Additional Documentation Page 40

Manchester Residential and Commercial Historic District  
Richmond, Virginia

---

Photo 22 of 23  
1509-1511 Porter Street  
View of Porter Street elevation, looking north

Photo 23 of 23  
1307, 1311 and 1317 Bainbridge Street  
View of Bainbridge Street elevation, looking north







# MANCHESTER RESIDENTIAL & COMMERCIAL HISTORIC DISTRICT

RICHMOND, VIRGINIA

SEPTEMBER 15, 2000



## LEGEND

-  LIGHTBULB: BUILDING WITH BUILDING ADDRESS NUMBER
-  MAJORITY: BUILDING WITH BUILDING ADDRESS NUMBER
-  HISTORIC DISTRICT BOUNDARY
-  LOT OR LESSOR BLOCK REFERENCE NUMBER

NUMBERED  
STREETS  
WEST

NUMBERED  
STREETS  
EAST



VLR 6/17/15  
NRHP 6/17/15

United States Department of the Interior  
National Park Service

### NATIONAL REGISTER OF HISTORIC PLACES REGISTRATION FORM

This form is for use in nominating or requesting determinations for individual properties and districts. See instructions in **How to Complete the National Register of Historic Places Registration Form (National Register Bulletin 16A)**. Complete each item by marking "x" in the appropriate box or by entering the information requested. If any item does not apply to the property being documented, enter "N/A" for "not applicable." For functions, architectural classification, materials, and areas of significance, enter only categories and subcategories from the instructions. Place additional entries and narrative items on continuation sheets (NPS Form 10-900a). Use a typewriter, word processor, or computer, to complete all items.

#### 1. Name of Property

historic name: Manchester Residential and Commercial Historic District  
[Amendment to contributing status of two buildings]  
other names/site number: VDHR #127-0859-0222 and #127-0859-0223

#### 2. Location

street & number: 1005-1007 and 1-009-1011 Porter Street nor for publication: NA  
city or town: Richmond vicinity: NA  
state: Virginia code: VA county: Independent City code: 760 Zip: 23224

#### 3. State/Federal Agency Certification

As the designated authority under the National Historic Preservation Act of 1986, as amended, I hereby certify that this X nomination request for determination of eligibility meets the documentation standards for registering properties in the National Register of Historic Places and meets the procedural and professional requirements set forth in 36 CFR Part 60. In my opinion, the property X meets does not meet the National Register Criteria. I recommend that this property be considered significant  nationally statewide X locally. (  See continuation sheet for additional comments. )

Signature of certifying official \_\_\_\_\_ Date \_\_\_\_\_  
Virginia Department of Historic Resources  
State or Federal agency and bureau

In my opinion, the property  meets does not meet the National Register criteria. (  See continuation sheet for additional comments. )

Signature of commenting or other official \_\_\_\_\_ Date \_\_\_\_\_

State or Federal agency and bureau \_\_\_\_\_

#### 4. National Park Service Certification

I, hereby certify that this property is: \_\_\_\_\_ other (explain): \_\_\_\_\_  
\_\_\_\_\_ entered in the National Register  
\_\_\_\_\_ See continuation sheet.  
\_\_\_\_\_ determined eligible for the National Register  
\_\_\_\_\_ See continuation sheet. Signature of Keeper \_\_\_\_\_  
\_\_\_\_\_ determined not eligible for the National Register  
\_\_\_\_\_ removed from the National Register Date of Action \_\_\_\_\_

**5. Classification**

**Ownership of Property** (Check as many boxes as apply)

- private
- public-local
- public-State
- public-Federal

**Category of Property** (Check only one box)

- building(s)
- district
- site
- structure
- object

**Number of Resources within Property**

Contributing	Noncontributing	
<u>  2  </u>	<u>  0  </u>	buildings
<u>  0  </u>	<u>  0  </u>	sites
<u>  0  </u>	<u>  0  </u>	structures
<u>  0  </u>	<u>  0  </u>	objects
<u>  2  </u>	<u>  0  </u>	Total

Number of contributing resources previously listed in the National Register   

Name of related multiple property listing (Enter "N/A" if property is not part of a multiple property listing.)

  N/A  

**6. Function or Use**

**Historic Functions** (Enter categories from instructions)

Cat: <u>  Domestic  </u>	Sub: <u>  Multiple Dwelling  </u>
_____	_____
_____	_____
_____	_____
_____	_____
_____	_____

**Current Functions** (Enter categories from instructions)

Cat: <u>  Domestic  </u>	Sub: <u>  Multiple Dwelling  </u>
_____	_____
_____	_____
_____	_____
_____	_____
_____	_____



U. S. Department of the Interior  
National Park Service

Manchester Residential and Commercial Historic District (Amendment)  
Richmond, Virginia

---

### 7. Description

---

**Architectural Classification** (Enter categories from instructions)

Colonial Revival

---

---

**Materials** (Enter categories from instructions)

foundation brick

roof unknown

walls brick

---

other \_\_\_\_\_

---

**Narrative Description** (Describe the historic and current condition of the property on one or more continuation sheets.)

---

### 8. Statement of Significance

---

**Applicable National Register Criteria** (Mark "x" in one or more boxes for the criteria qualifying the property for National Register listing)

- A Property is associated with events that have made a significant contribution to the broad patterns of our history.
- B Property is associated with the lives of persons significant in our past.
- C Property embodies the distinctive characteristics of a type, period, or method of construction or represents the work of a master, or possesses high artistic values, or represents a significant and distinguishable entity whose components lack individual distinction.
- D Property has yielded, or is likely to yield information important in prehistory or history.

**Criteria Considerations** (Mark "X" in all the boxes that apply.)

- A owned by a religious institution or used for religious purposes.
- B removed from its original location.
- C a birthplace or a grave.
- D a cemetery.
- E a reconstructed building, object or structure.
- F a commemorative property.
- G less than 50 years of age or achieved significance within the past 50 years.

U. S. Department of the Interior  
National Park Service

Manchester Residential and Commercial Historic District (Amendment)  
Richmond, Virginia

**Areas of Significance** (Enter categories from instructions)

Architecture

Community Development

**Period of Significance** 1797-1950 (entiredistrict)

**Significant Dates** 1925-26 and 1927

**Significant Person** (Complete if Criterion B is marked above)

NA

**Cultural Affiliation** NA

**Architect/Builder** NA

**Narrative Statement of Significance** (Explain the significance of the property on one or more continuation sheets.)

**9. Major Bibliographical References**

**Bibliography**

(Cite the books, articles, and other sources used in preparing this form on one or more continuation sheets.)

**Previous documentation on file** (NPS)

preliminary determination of individual listing (36 CFR 67) has been requested.

previously listed in the National Register

previously determined eligible by the National Register

designated a National Historic Landmark

recorded by Historic American Buildings Survey # \_\_\_\_\_

recorded by Historic American Engineering Record # \_\_\_\_\_

**Primary Location of Additional Data**

State Historic Preservation Office

Other State agency

Federal agency

Local government

University

Other

Name of repository: \_\_\_\_\_

**10. Geographical Data**

**Acreage of Property** Less than one acre

**UTM References** (Place additional UTM references on a continuation sheet)

Zone Easting Northing

1 18 282930 4155560

Zone Easting Northing

2 \_\_\_\_\_

See continuation sheet.

U. S. Department of the Interior  
National Park Service

Manchester Residential and Commercial Historic District (Amendment)  
Richmond, Virginia

---

**Verbal Boundary Description** (Describe the boundaries of the property on a continuation sheet.)

**Boundary Justification** (Explain why the boundaries were selected on a continuation sheet.)

---

**11. Form Prepared By**

name/title: Jean McRae, Register Program Specialist

Organization: Virginia Department of Historic Resources date: May 2005

street & number: 2801 Kensington Avenue telephone: 804-367-2323

city or town: Richmond state: VA zip code: 23221

---

**Additional Documentation**

Submit the following items with the completed form:

**Continuation Sheets**

**Maps**

A USGS map (7.5 or 15 minute series) indicating the property's location.

A sketch map for historic districts and properties having large acreage or numerous resources.

**Photographs**

Representative black and white photographs of the property.

**Additional items** (Check with the SHPO or FPO for any additional items)

---

**Property Owner**

(Complete this item at the request of the SHPO or FPO.)

Name: Matthew E. Duke, 1005 Porter Street, L.C.

street & number: 16415 Locust Hill Drive telephone: 804-387-1675

city or town: Rockville state: VA zip code: 23146

---

**Paperwork Reduction Act Statement:** This information is being collected for applications to the National Register of Historic Places to nominate properties for listing or determine eligibility for listing, to list properties, and to amend existing listings. Response to this request is required to obtain a benefit in accordance with the National Historic Preservation Act, as amended (16 U.S.C. 470 et seq.).

**Estimated Burden Statement:** Public reporting burden for this form is estimated to average 18.1 hours per response including the time for reviewing instructions, gathering and maintaining data, and completing and reviewing the form. Direct comments regarding this burden estimate or any aspect of this form to the Chief, Administrative Services Division, National Park Service, P.O. Box 37127, Washington, DC 20013-7127; and the Office of Management and Budget, Paperwork Reductions Project (1024-0018), Washington, DC 20503.

United States Department of the Interior  
National Park Service

National Register of Historic Places    Manchester Residential and Commercial Historic District (Amendment)  
Continuation Sheet    Richmond, Virginia

Section   7      Page   1  

---

**7. Summary Description:**

**1005-1007 Porter Street, Richmond, Virginia #127-0859-0222, Contributing**

This building was constructed in 1927 as a typical two-story brick, multi-dwelling building with four apartments. The building was originally thought to be dated in the 1950's due to later porch replacements and was considered non-contributing to the historic district at the time of the district registration in 2002. It has now been shown that the building is a typical 1920-30's apartment building and still maintains its integrity as a contributing resource sympathetic to the historic district. The original brick façade has remained intact with a blind window opening above a centered door with a cantilevered pedimented hood. The roof has also remained as a slate gable with brick parapet end walls and a centrally located front-facing gable peak with a pointed louvered vent. Behind the front gable the roof slopes to the rear towards a rear brick parapet wall. There are also two extant brick chimneys located on the exterior of the rear wall. On either side of the centered door, are one- and two-story porches each with a door and window opening. The doors are multi-paned and the windows have six-over-one sashes. The building has a similar setback to adjacent buildings in the neighborhood, and overall maintains its historic character in scale, design and materials, as a contributing resource within the residential area of the district.

**1009-1011 Porter Street, Richmond, Virginia #127-0859-0223, Contributing**

This building was constructed in 1925-26 as a typical two-story brick, multi-dwelling building with four apartments. The building was originally thought to be dated in the 1950's due to later porch replacements and was considered non-contributing to the historic district at the time of the district registration in 2002. It has now been shown that the building is a typical 1920-30's apartment building and still maintains its integrity as a contributing resource sympathetic to the historic district. The original brick façade has remained intact with blind brick arches located along the second level above the two central doors. The roof has also remained as a slate gable with brick parapet end walls and firewall separating the apartments. Behind the front gable the roof slopes to the rear towards a brick parapet wall. There is also an extant brick chimney near the center of the roof end. On either side of the centered doors, are one- and two-story porches each with a door and window opening. The doors are multi-paned and the windows have six-over-one sashes. The building has a similar setback to adjacent buildings in the neighborhood, and overall maintains its historic character in scale, design and materials, as a contributing resource within the residential area of the district.



**United States Department of the Interior  
National Park Service**

**National Register of Historic Places**      Manchester Residential and Commercial Historic District (Amendment)  
**Continuation Sheet**      Richmond, Virginia

Sections 10 and Photographic Data      Page 3

---

**10. Geographical data:**

**Verbal Boundary Description:**

The buildings addressed as 1005-1007 and 1009-1011 Porter Street as shown on the attached map (Attachment One) which was used with the previous historic district nomination.

**Verbal Boundary Justification:**

The boundaries are as they apply only to the two buildings whose contributing status is changing within the district. These buildings are listed as 1005-1007 and 1009-1011 Porter Street in the neighborhood of Manchester in the City of Richmond, Virginia.

**Photographic Data:**

Originals not provided as this amendment is solely for the status change of two buildings from non-contributing to contributing within the currently registered historic district. Attached are copies of the photographic documentation as it is presented with the tax credit application and previous district nomination.

Attachment Two: Upper photograph shows front façade of 1005-1007 Porter Street; lower photograph shows 1005-1007 Porter Street on the right and 1009-1011 Porter Street on the left.

Attachment Three: Upper photograph shows front façade of 1009-1011 Porter Street; lower photograph shows 1005-1007 Porter Street on the right and 1009-1011 Porter Street on the left.

Attachment Four: Upper photograph shows streetscape of 1001, 1003, 1005-1007, and 1009-1011 Porter Street with the latter closest; lower photograph shows rear of 1005-1007 and 1009-1011 Porter Street with the latter closest.

McDONOUGH STREET

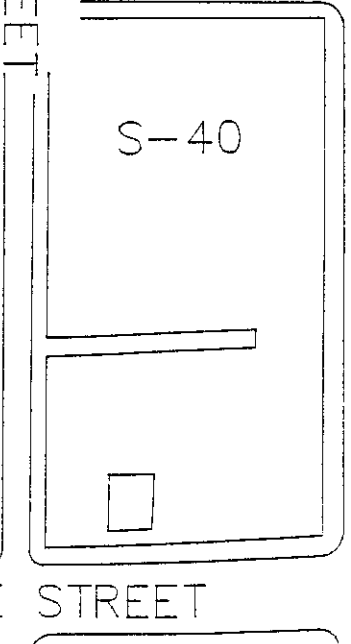
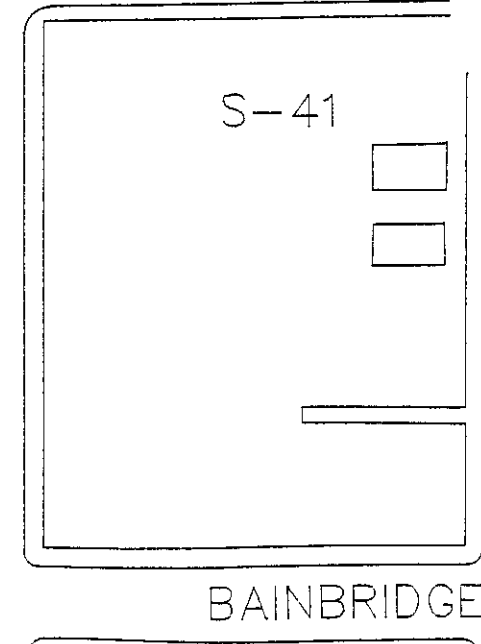
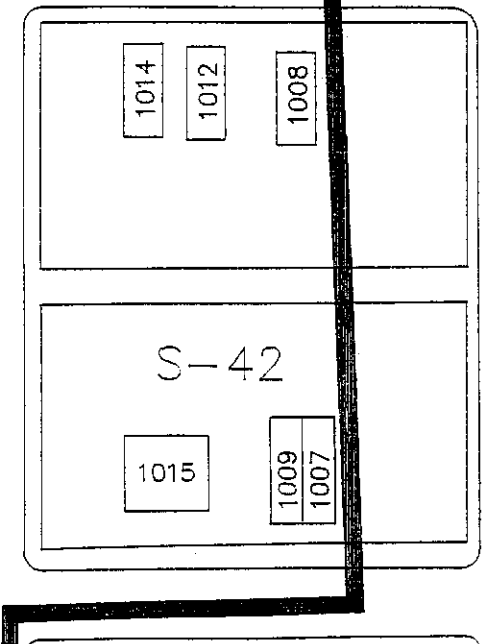
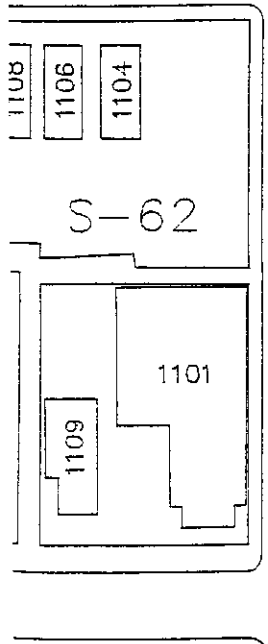
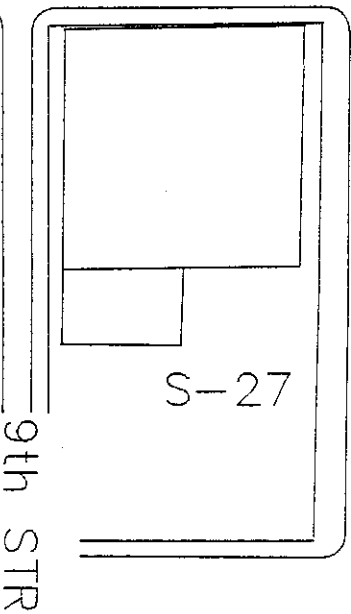
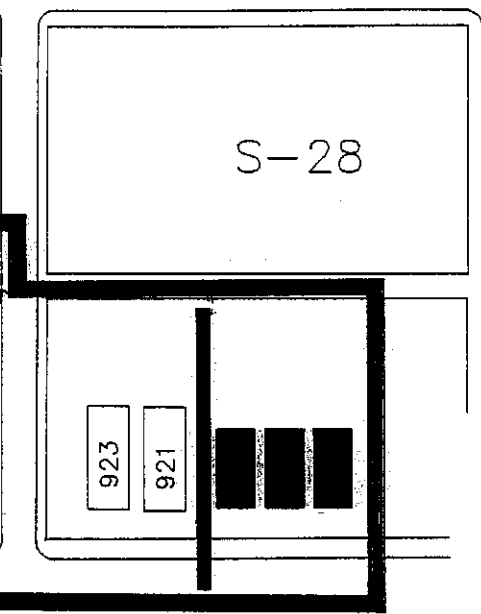
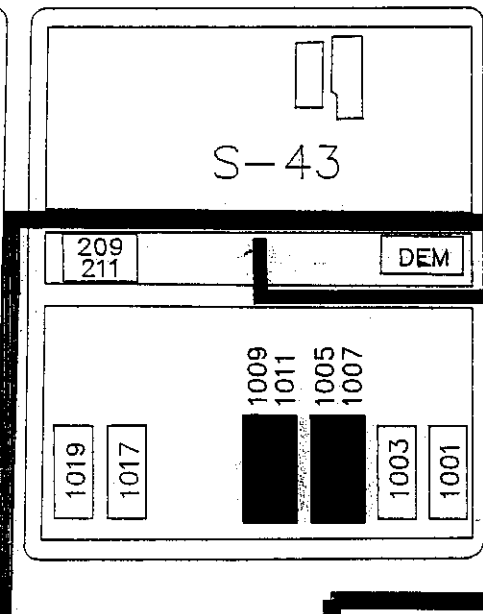
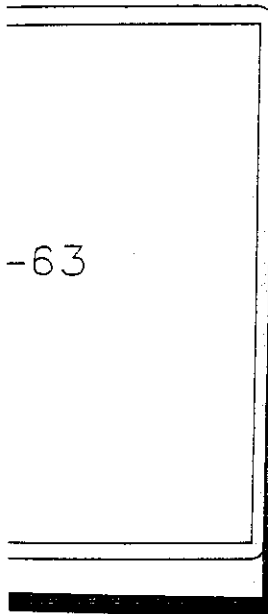
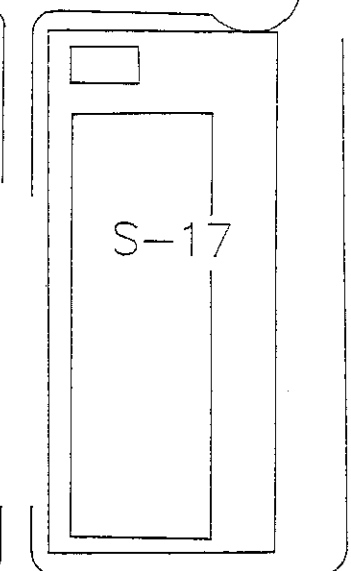
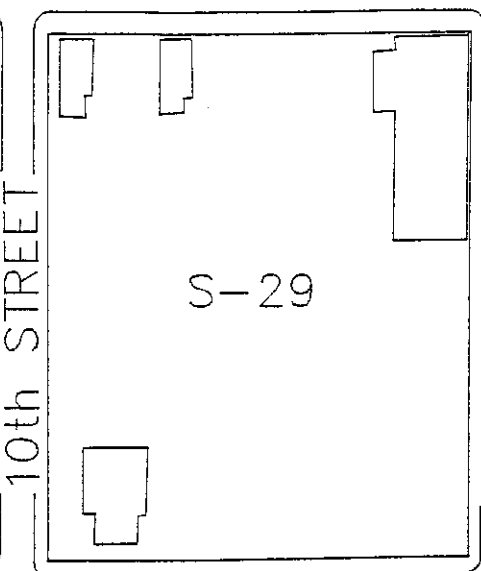
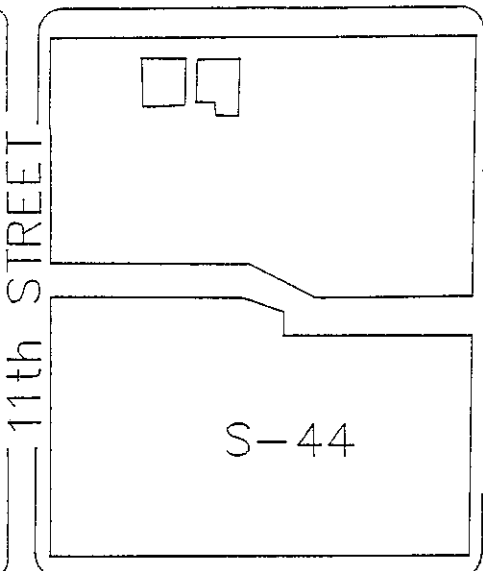
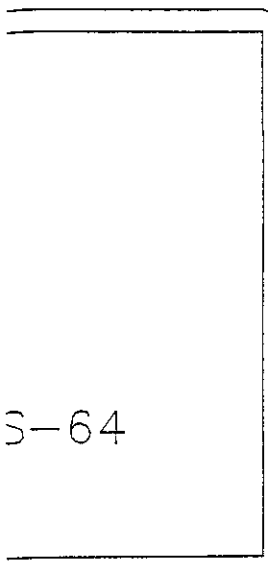

11th STREET

10th STREET

9th STREET

PERRY STREET

BAINBRIDGE STREET

MANCHESTER  
RESIDENTIAL +  
COMMERCIAL  
HIST. DISTRICT  
(AMENDMENT)  
127-0859-0222  
127-0859-0223  
UTM ZONE 18  
282930E  
4155560N  
RICHMOND  
QUADS

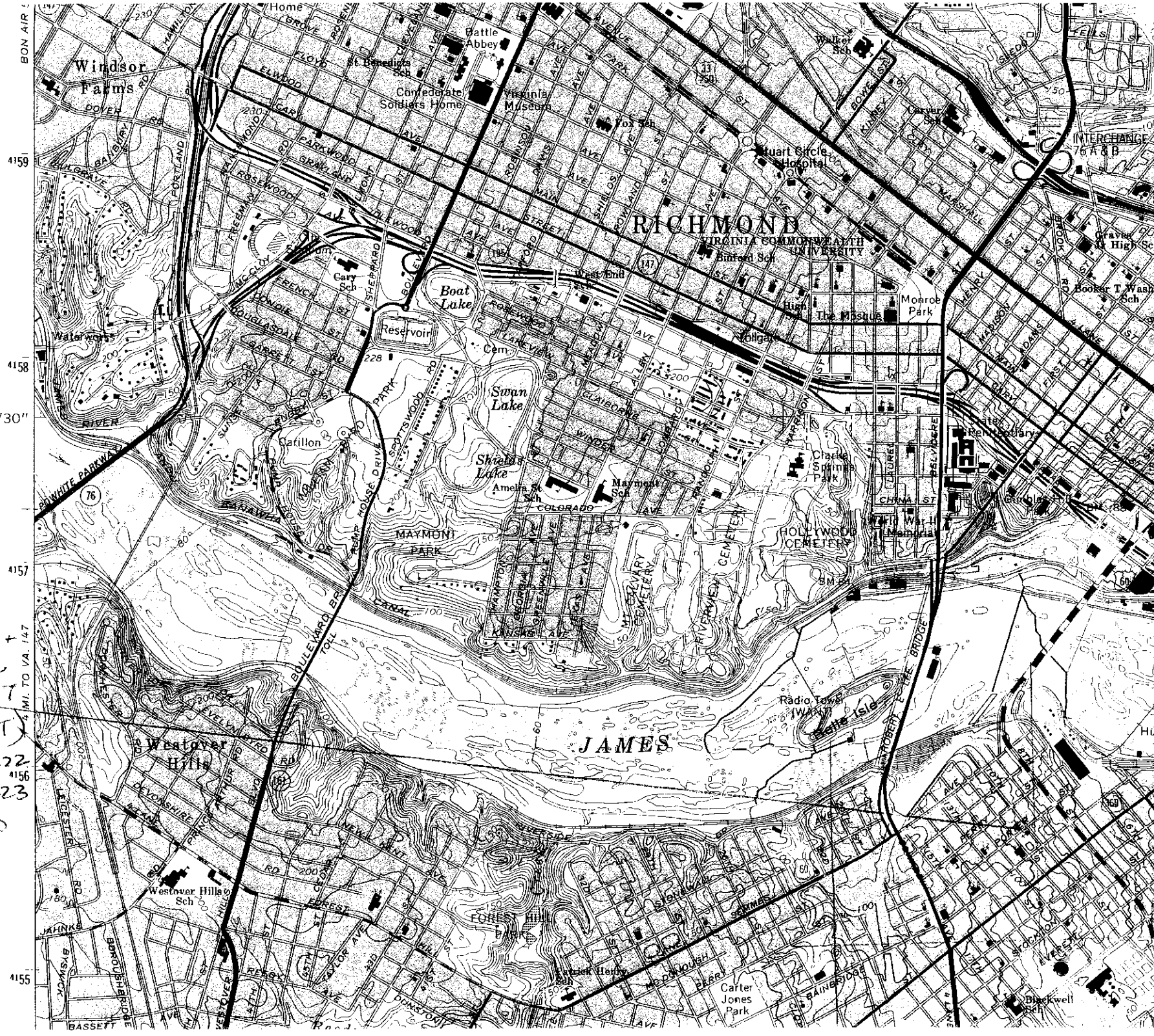



VLR  
NRHP > 10/11/05

United States Department of the Interior  
National Park Service

**NATIONAL REGISTER OF HISTORIC PLACES  
REGISTRATION FORM**

This form is for use in nominating or requesting determinations for individual properties and districts. See instructions in How to Complete the National Register of Historic Places Registration Form (National Register Bulletin 16A). Complete each item by marking "x" in the appropriate box or by entering the information requested. If any item does not apply to the property being documented, enter "N/A" for "not applicable." For functions, architectural classification, materials, and areas of significance, enter only categories and subcategories from the instructions. Place additional entries and narrative items on continuation sheets (NPS Form 10-900a). Use a typewriter, word processor, or computer, to complete all items.

**1. Name of Property**

historic name: Manchester Residential and Commercial Historic District  
(Amendment to contributing status of one building)  
other names/site number: VDHR #127-0859-0227

**2. Location**

street & number: 1228 Hull Street not for publication: NA  
city or town: Richmond vicinity: NA  
state: Virginia code: VA county: Independent City code: 760 Zip: 23224

**3. State/Federal Agency Certification**

As the designated authority under the National Historic Preservation Act of 1986, as amended, I hereby certify that this X nomination request for determination of eligibility meets the documentation standards for registering properties in the National Register of Historic Places and meets the procedural and professional requirements set forth in 36 CFR Part 60. In my opinion, the property X meets does not meet the National Register Criteria. I recommend that this property be considered significant    nationally    statewide X locally (    See continuation sheet for additional comments )

 8/29/05  
Signature of certifying official Date  
**Virginia Department of Historic Resources**  
State or Federal agency and bureau

In my opinion, the property    meets    does not meet the National Register criteria. (    See continuation sheet for additional comments.)

\_\_\_\_\_  
Signature of commenting or other official Date  
\_\_\_\_\_  
State or Federal agency and bureau

**4. National Park Service Certification**

I, hereby certify that this property is: \_\_\_\_\_ other (explain): \_\_\_\_\_  
   entered in the National Register  
See continuation sheet.  
   determined eligible for the  
National Register  
   See continuation sheet. Signature of Keeper \_\_\_\_\_  
   determined not eligible for the National Register  
   removed from the National Register Date of Action \_\_\_\_\_

U. S. Department of the Interior

Manchester Residential and Commercial Historic District  
(1228 Hull Street Amendment)

National Park Service

Richmond, Virginia

**5. Classification**

**Ownership of Property** (Check as many boxes as apply)

- private
- public-local
- public-State
- public-Federal

**Category of Property** (Check only one box)

- building(s)
- district
- site
- structure
- object

**Number of Resources within Property**

Contributing	Noncontributing	
<u>  1  </u>	<u>  0  </u>	buildings
<u>  0  </u>	<u>  0  </u>	sites
<u>  0  </u>	<u>  0  </u>	structures
<u>  0  </u>	<u>  0  </u>	objects
<u>  1  </u>	<u>  0  </u>	Total

Number of contributing resources previously listed in the National Register   0  

Name of related multiple property listing (Enter "N/A" if property is not part of a multiple property listing.)

  N/A  

**6. Function or Use**

**Historic Functions** (Enter categories from instructions)

Cat: \_\_\_\_\_ Sub: \_\_\_\_\_

  Commerce/Trade     Restaurant  

\_\_\_\_\_

\_\_\_\_\_

\_\_\_\_\_

\_\_\_\_\_

\_\_\_\_\_

**Current Functions** (Enter categories from instructions)

Cat: \_\_\_\_\_ Sub: \_\_\_\_\_

  Commerce/Trade     Restaurant  

\_\_\_\_\_

\_\_\_\_\_

\_\_\_\_\_

\_\_\_\_\_

\_\_\_\_\_

U. S. Department of the Interior

Manchester Residential and Commercial Historic District  
(1228 Hull Street Amendment)

National Park Service

Richmond, Virginia

---

### 7. Description

---

**Architectural Classification** (Enter categories from instructions)

   Moderne

**Materials** (Enter categories from instructions)

foundation    brick

roof    flat asphalt

walls    brick

other    aluminum

**Narrative Description** (Describe the historic and current condition of the property on one or more continuation sheets.)

---

### 8. Statement of Significance

---

**Applicable National Register Criteria** (Mark "x" in one or more boxes for the criteria qualifying the property for National Register listing)

- A Property is associated with events that have made a significant contribution to the broad patterns of our history.
- B Property is associated with the lives of persons significant in our past.
- C Property embodies the distinctive characteristics of a type, period, or method of construction or represents the work of a master, or possesses high artistic values, or represents a significant and distinguishable entity whose components lack individual distinction.
- D Property has yielded, or is likely to yield information important in prehistory or history.

**Criteria Considerations** (Mark "X" in all the boxes that apply.)

- A owned by a religious institution or used for religious purposes.
- B removed from its original location.
- C a birthplace or a grave.
- D a cemetery.
- E a reconstructed building, object or structure.
- F a commemorative property.
- G less than 50 years of age or achieved significance within the past 50 years.

U. S. Department of the Interior

Manchester Residential and Commercial Historic District  
(1228 Hull Street Amendment)

National Park Service

Richmond, Virginia

**Areas of Significance** (Enter categories from instructions)

Architecture  
Commerce/Trade

**Period of Significance** 1797-1950 (entire district)

**Significant Dates** 1935

**Significant Person** (Complete if Criterion B is marked above)  
NA

**Cultural Affiliation** NA

**Architect/Builder** NA

**Narrative Statement of Significance** (Explain the significance of the property on one or more continuation sheets.)

**9. Major Bibliographical References**

**Bibliography**

(Cite the books, articles, and other sources used in preparing this form on one or more continuation sheets.)

**Previous documentation on file** (NPS)

- preliminary determination of individual listing (36 CFR 67) has been requested.
- previously listed in the National Register
- previously determined eligible by the National Register
- designated a National Historic Landmark
- recorded by Historic American Buildings Survey # \_\_\_\_\_
- recorded by Historic American Engineering Record # \_\_\_\_\_

**Primary Location of Additional Data**

- State Historic Preservation Office
- Other State agency
- Federal agency
- Local government
- University
- Other

Name of repository: \_\_\_\_\_

**10. Geographical Data**

**Acreeage of Property** Less than one acre

**UTM References** (Place additional UTM references on a continuation sheet)

Zone	Easting	Northing	Zone	Easting	Northing
1	<u>18</u>	<u>283943</u>	<u>4155419</u>	2	_____
<input type="checkbox"/> See continuation sheet.					

U. S. Department of the Interior

Manchester Residential and Commercial Historic District  
(1228 Hull Street Amendment)

National Park Service

Richmond, Virginia

**Verbal Boundary Description** (Describe the boundaries of the property on a continuation sheet.)

**Boundary Justification** (Explain why the boundaries were selected on a continuation sheet.)

**11. Form Prepared By**

name/title: Jean McRae, Register Program Specialist

Organization: Virginia Department of Historic Resources date: August 2005

street & number: 2801 Kensington Avenue telephone: 804-367-2323

city or town: Richmond state: VA zip code: 23221

**Additional Documentation**

Submit the following items with the completed form:

**Continuation Sheets**

**Maps**

- A USGS map (7.5 or 15 minute series) indicating the property's location.
- A sketch map for historic districts and properties having large acreage or numerous resources.

**Photographs**

Representative black and white photographs of the property.

**Additional items** (Check with the SHPO or FPO for any additional items)

**Property Owner**

(Complete this item at the request of the SHPO or FPO.)

Name: Mr. Tom Robinson

street & number: 1228 Hull Street telephone: N/A

city or town: Richmond state: VA zip code: 23224

**Paperwork Reduction Act Statement:** This information is being collected for applications to the National Register of Historic Places to nominate properties for listing or determine eligibility for listing, to list properties, and to amend existing listings. Response to this request is required to obtain a benefit in accordance with the National Historic Preservation Act, as amended (16 U.S.C. 470 et seq.).

**Estimated Burden Statement:** Public reporting burden for this form is estimated to average 18.1 hours per response including the time for reviewing instructions, gathering and maintaining data, and completing and reviewing the form. Direct comments regarding this burden estimate or any aspect of this form to the Chief, Administrative Services Division, National Park Service, P.O. Box 37127, Washington, DC 20013-7127; and the Office of Management and Budget, Paperwork Reductions Project (1024-0018), Washington, DC 20503.

**United States Department of the Interior  
National Park Service**

**National Register of Historic Places**

Manchester Residential and Commercial Historic District  
(1228 Hull Street Amendment)

**Continuation Sheet**

Richmond, Virginia

Section 7 Page 1

---

**7. Summary Description:**

**Lighthouse Diner, Commercial Building**

**1228 Hull Street, Richmond, Virginia #127-0859-0227, Contributing**

The one-story diner stands at the corner of 13<sup>th</sup> Street facing Hull Street in the Manchester neighborhood on the south side of the James River in Richmond, Virginia. Recent research has shown the building to have been built in 1935 as a representative signature design for a chain of retail/restaurants. The "Lighthouse" restaurants, a diner style, have a lighthouse motif on the front corner of the roof. The roof design is flat (asphalt) with a parapet edge facing both 13<sup>th</sup> and Hull Streets. Below the roof line and also facing both 13<sup>th</sup> and Hull Streets is an aluminum marquee which shades the plate glass windows along the street façades. Surrounding the aluminum window frames are aluminum panels over the brick construction of the building.

The building has a similar street setback to adjacent buildings in the neighborhood, and overall maintains its historic character in scale, design and materials, as a contributing resource within the commercial area of the district. (This building was originally listed as non-contributing (based upon incorrect construction date information) on Page 13 of Section 7 of the original Manchester Residential and Commercial Historic District listed in 2002.)

**United States Department of the Interior  
National Park Service**

**National Register of Historic Places**

Manchester Residential and Commercial Historic District  
(1228 Hull Street Amendment)

**Continuation Sheet**

Richmond, Virginia

Section   8   Page   2  

---

**8. Statement of Significance**

The Manchester Residential and Commercial Historic District was originally listed in March 2001 on the Virginia Landmarks Register and in May 2002 on the National Register of Historic Places. The district is significant under Criterion A for its community planning and settlement south of the James River and the City of Richmond, and for Criterion C for its architecture. When this district was listed, the building at 1228 Hull Street was thought to be of 1950's construction, and was considered non-contributing.

Recent research by the current owner, who plans to restore the diner for continued use, found the construction date of the "Lighthouse Diner" to be 1935. Its unique signature Moderne design with the lighthouse motif make it an integral part of the commercial development of the Manchester neighborhood and therefore significant for not only for its architecture but commercial restaurant use during the period of significance (1797-1950) for the district.

**United States Department of the Interior  
National Park Service**

**National Register of Historic Places**

Manchester Residential and Commercial Historic District  
(1228 Hull Street Amendment)

**Continuation Sheet**

Richmond, Virginia

Sections 10 and Photographic Data Page 3

---

**10. Geographical Data:**

**Verbal Boundary Description:**

The building addressed as 1228 Hull Street as shown on the attached map (Attachment One) which was used with the previous historic district nomination.

**Boundary Justification:**

The boundary is as it applies only to the building whose contributing status is changing within the district. This building is listed as 1228 Hull Street in the neighborhood of Manchester in the City of Richmond, Virginia.

**Photographic Data:**

Originals not provided as this amendment is solely for the status change of one building from non-contributing to contributing within the currently registered historic district.

Attachment One: Copy of section of detailed district map included with original nomination for entire registered historic district.

Attachment Two: Copy of sketch map for individual building, included with original survey material at the time of historic district nomination.

Attachment Three: Copy of Richmond Quadrangle map showing location of building within the registered historic district boundaries.

Attachment Four: Copy of photograph of building included with original survey material at the time of historic district nomination.



NPS Form 10-900-a  
(8-86)

OMB No. 1024-0018

**United States Department of the Interior  
National Park Service**

**National Register of Historic Places**

Manchester Residential and Commercial Historic District  
(1228 Hull Street Amendment)

**Continuation Sheet**

Richmond, Virginia

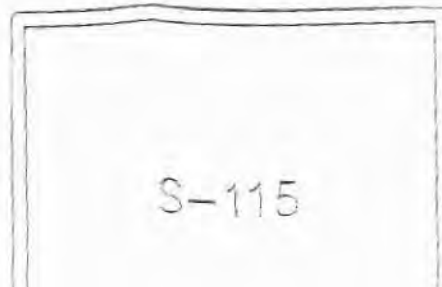
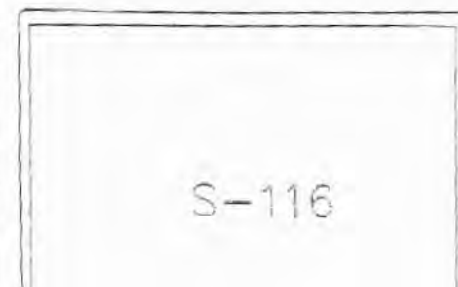
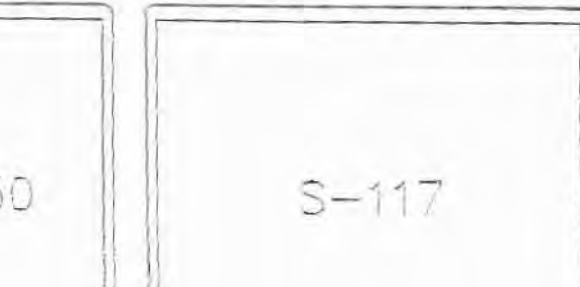
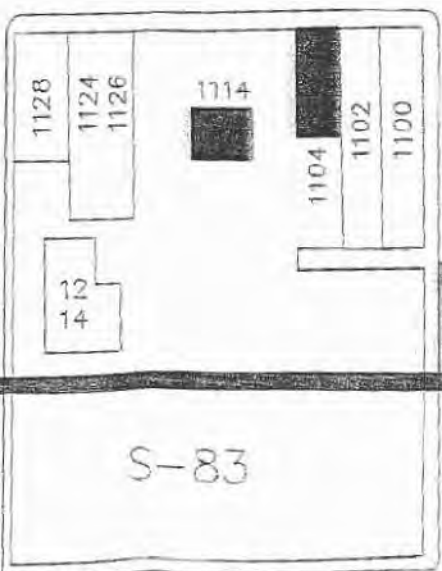
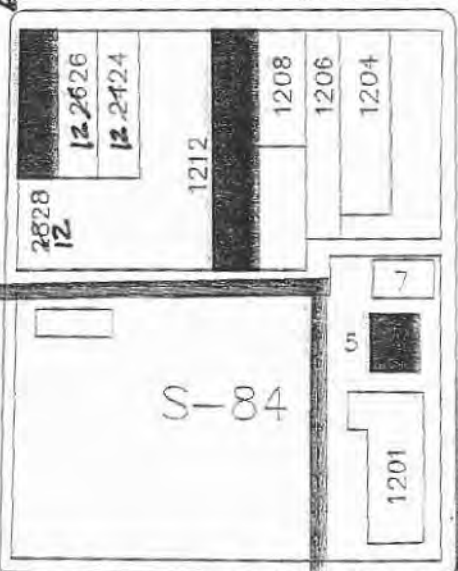
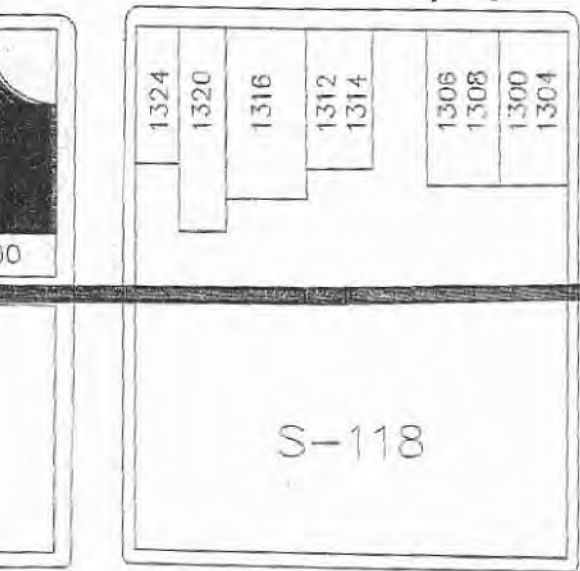
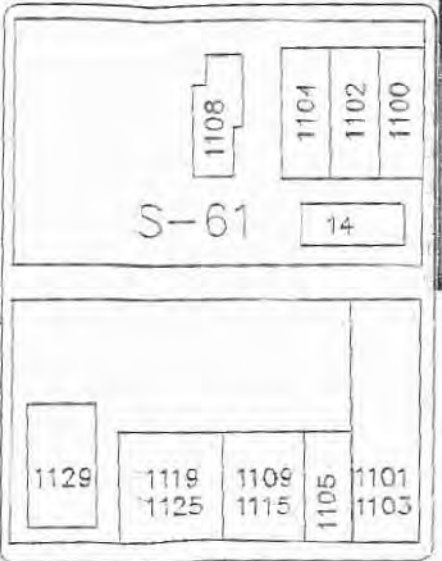
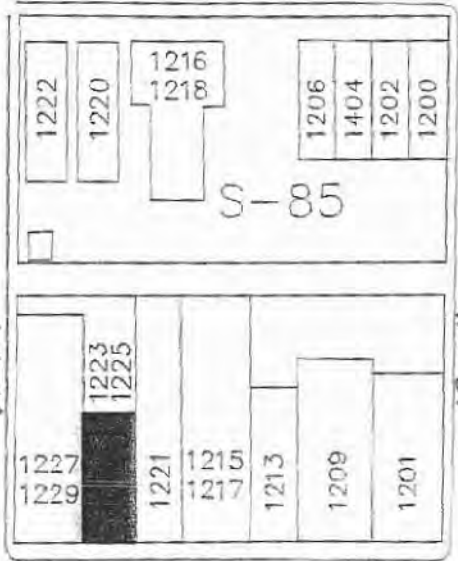
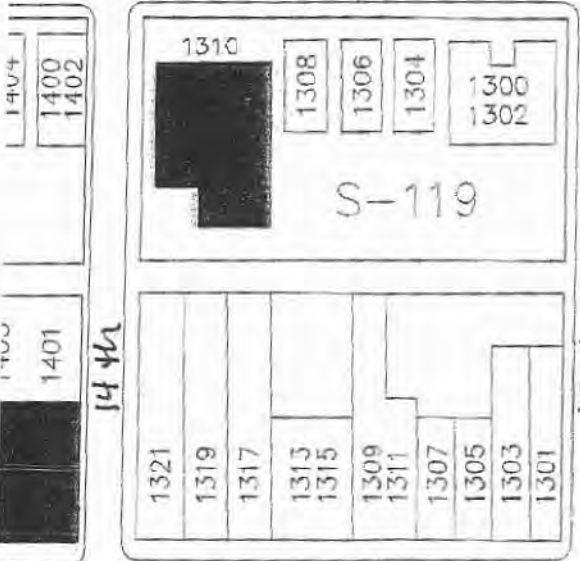
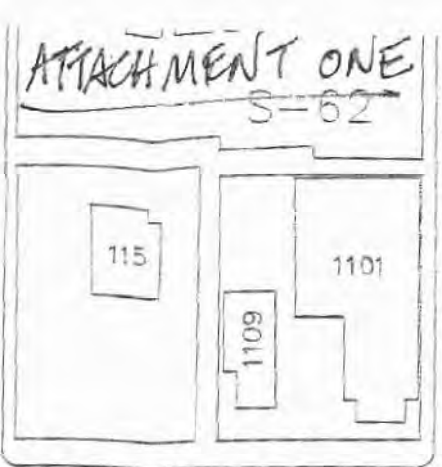
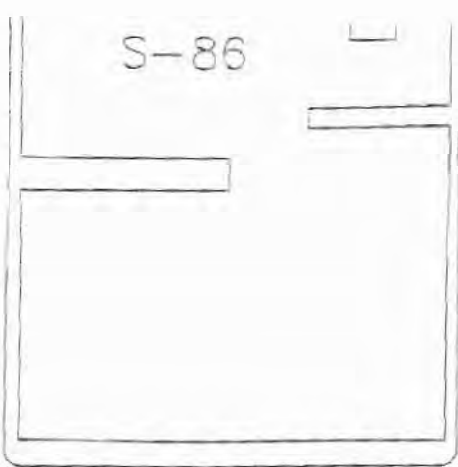
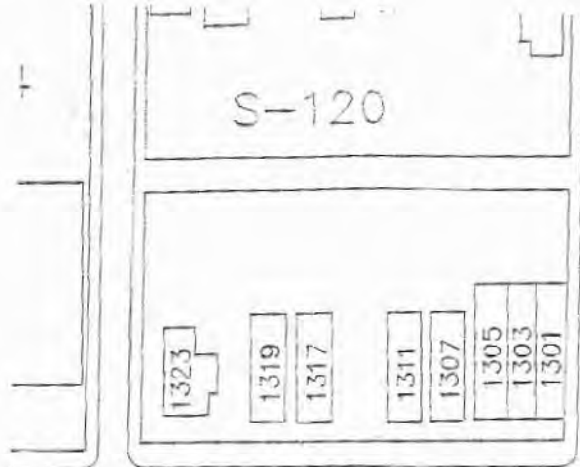

ATTACHMENT  
TWO

SITE PLAN

Date: 10-14-96

NORTH ARROW

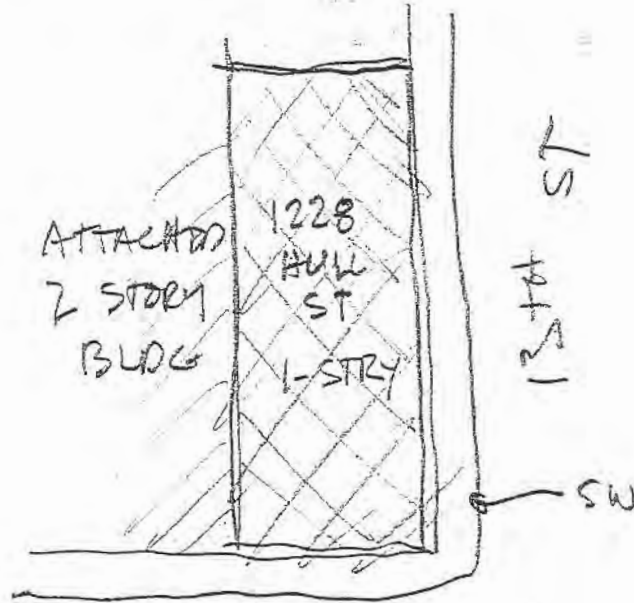

1228 HULL ST



ATTACHMENT  
THREE

127 0239  
Manchester  
Residential  
and  
H. T.  
Richmond  
Zone 18

- ① N 4155 740  
E 283 560
- ② N 4155 760  
E 283 640
- ③ N 4155 480  
E 284 150
- ④ N 4155 290  
E 284 500
- ⑤ N 4155 950  
E 283 750
- ⑥ N 4154 960  
E 283 560
- ⑦ N 4155 680  
E 283 420
- ⑧ N 4155 190  
E 283 380
- ⑨ N 4155 390  
E 283 410

1228 Hill S  
UTM 18  
283 943E  
4155 419N

UTM 18  
 4155 419N  
 283 943E  
 1228 Hill S

ATTACHMENT FOUR



**United States Department of the Interior  
National Park Service**

**National Register of Historic Places  
Continuation Sheet**

Approved:  
VLR and NRHP 8/2/2016

Manchester Residential and Commercial Historic District (127-0859) 2016 Update to Correct Inventory
----- Name of Property
City of Richmond, VA
----- County and State
N/A
----- Name of multiple listing (if applicable)

Section number Additional Documentation Page 1

Introduction

The Manchester Residential and Commercial Historic District was originally listed in the National Register of Historic Places on May 16, 2002. The Virginia Department of Historic Resources recently received documentation that demonstrates the original nomination included an erroneous entry for a building at 1212 Hull Street (DHR No. 127-0859-0225) was incorrectly categorized as a noncontributing resource. The historic district’s period of significance is 1797-1950. The building at 1212 Hull Street was constructed during the late 19<sup>th</sup> century and its extant façade was added in 1950. Therefore, in Section 7, the inventory entry for the building has been corrected to change its status from Non-Contributing to Contributing as the building is associated with the historic district’s areas of significance in Commerce and Architecture and with its period of significance. The resource counts in Section 5 also have been updated to reflect this new information. The district’s historic boundaries and areas of significance *have not changed* as a result of this update.

Section 5. Classification

**Number of Resources within Property**

(Do not include previously listed resources in the count)

Contributing	Noncontributing	
<u>215</u>	<u>32</u>	buildings
<u>0</u>	<u>0</u>	sites
<u>0</u>	<u>0</u>	structures
<u>0</u>	<u>0</u>	objects
<u>215</u>	<u>32</u>	Total

Section 7. Description

*Narrative Description*

The commercial building located at 1212 Hull Street (DHR No. 127-0859-0225) is a one-story, brick building that was constructed in the late-19<sup>th</sup> century. The extant façade was installed in 1950, and is an intact example of the standardized, Moderne façade design used by the Virginia Department of Alcoholic Beverage Control (ABC) at this time. Character-defining features of this design include a rectangular parapet with concrete coping, a centered display window flanked by panels of glass block with rounded corners, and by recessed entries with single-light transoms (see Figures 1-3). Examples of this façade design are extant in numerous communities across Virginia (see Figure 4). Some examples feature a buff brick veneer and others have a smooth concrete veneer with fluted pilasters, such as the building at 1212 Hull Street. The consistency of its fenestration and materials allow the informed viewer to identify current and former Virginia ABC stores dating to the mid-20<sup>th</sup> century.

The following photos show the building as it appeared in 2001 and as it appears currently.

**United States Department of the Interior  
National Park Service**

**National Register of Historic Places  
Continuation Sheet**

Manchester Residential and Commercial  
Historic District (127-0859) 2016 Update  
to Correct Inventory

Name of Property

City of Richmond, VA

County and State

N/A

Name of multiple listing (if applicable)

Section number Additional Documentation Page 2



*Figure 1. 1212 Hull Street  
in 2001*



*Figure 2. 1212 Hull Street in 2016*

**United States Department of the Interior  
National Park Service**

**National Register of Historic Places  
Continuation Sheet**

Manchester Residential and Commercial  
Historic District (127-0859) 2016 Update  
to Correct Inventory

-----  
Name of Property

City of Richmond, VA

-----  
County and State

N/A

-----  
Name of multiple listing (if applicable)

Section number Additional Documentation Page 3



*Figure 3. 1212 Hull Street in 2016, Façade and Side Elevation*



*Figure 4. Example of a Similar Standardize Façade Design in the Town of Dillwyn, Buckingham County, Virginia*

**Inventory**

Following is the corrected inventory entry for the resource affected by this additional documentation.

**1200 block Hull Street, Even Side**

**1212 Hull Street**

**Primary Resource: Building (Building), Stories 1, Style: Moderne, Originally constructed ca. 1895; façade replaced in 1950**

**Contributing Total: 1**



**United States Department of the Interior**  
National Park Service

**National Register of Historic Places**  
**Continuation Sheet**

Manchester Residential and Commercial Historic District (127-0859) 2016 Update to Correct Inventory
----- Name of Property
City of Richmond, VA
----- County and State
N/A
----- Name of multiple listing (if applicable)

Section number Additional Documentation Page 4

Section 11.

**Prepared By**

name/title: DHR National Register Staff  
organization: Virginia Department of Historic Resources  
street & number: 2801 Kensington Avenue  
city or town: Richmond state: VA zip code: 23221  
e-mail: lena.mcdonald@dhr.virginia.gov  
telephone: (804) 482-6439  
date: June 2016