

United States Department of the Interior
National Park Service

National Register of Historic Places
Continuation Sheet

Lawrenceville Historic District 2021 Update

Name of Property

Brunswick County, Virginia

County and State

00000313

NR Reference Number

Section number Additional DocumentationPage 1

NRHP Approved: 8/5/2021

State/Federal Agency Certification

As the designated authority under the National Historic Preservation Act, as amended,

I hereby certify that this additional documentation move removal
 name change (additional documentation) other

meets the documentation standards for registering properties in the National Register of Historic Places and
meets the procedural and professional requirements set forth in 36 CFR Part 60.

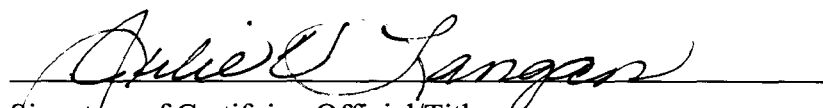
Signature of Certifying Official/Title:

7/19/2021
Date of Action

National Park Service Certification

I hereby certify that this property is:

- entered in the National Register
 determined eligible for the National Register
 determined not eligible for the National Register
 removed from the National Register
 additional documentation accepted
 other (explain:) _____

Signature of the Keeper

Date of Action

United States Department of the Interior
National Park Service

National Register of Historic Places
Continuation Sheet

Lawrenceville Historic District 2021 Update

Name of Property

Brunswick County, Virginia

County and State

00000313

NR Reference Number

Section number Additional DocumentationPage 2**Introduction**

Lawrenceville Historic District (DHR ID 251-5001), located in Brunswick County, Virginia, was originally listed in the National Register of Historic Places in 2000 and the Virginia Landmarks Register in 1999. The original nomination form identified nine areas of significance for the district including Architecture, Archaeology (modern industrial), Commerce, Education, Entertainment/Recreation, Ethnic Heritage (Black), Law/ Politics/ Government¹, Religion, and Transportation, with a period of significance spanning from 1784 to 1949. The purpose of this Additional Documentation is to update the Lawrenceville Historic District nomination to provide current information about the district's physical condition, to provide further documentation of the significance of the district (including adding new areas of significance), and to extend the end date of the district's period of significance to 1973.

Additional documentation provided below is organized based on the current NRHP nomination form, including Section 5, Classification (with an updated count of contributing and non-contributing resources); Section 6, Function or Use of Resources; Section 7, Description (including a complete and updated inventory of all resources); Section 8, Statement of Significance; Section 9, Major Bibliographical References (based on new research); Section 11, information regarding authors; and Section 12, new Additional Documentation including an updated Sketch Map (showing contributing and noncontributing resources) and photographs of buildings throughout the district.

Only updated information is provided herein. Information in the original nomination that has not been updated, such as historic functions in Section 6 and architectural styles in Section 7, are not reproduced in this additional documentation. The historic boundaries of the district *have not changed* as a result of this Additional Documentation.

Section 7 of this update includes a complete inventory of previously and newly surveyed resources organized by street name and number. In December 2020 and January 2021, a reconnaissance-level survey of 424 properties in the Lawrenceville Historic District was conducted, during which surveyors verified the conditions of all previously-documented resources within the district, as well as documented resources not previously surveyed and all significant secondary resources. The original nomination included an inventory listing 326 contributing buildings, and 91 noncontributing buildings, 1 contributing site and 1 noncontributing site, 3 contributing structures and 2 noncontributing structures and 1 contributing object, accompanied by short architectural descriptions of each resource. The 2020/2021 survey and expansion of the period of significance resulted in the identification of 431 contributing resources, including 423 buildings, 6 structures, 1 object, and 1 site. The updated survey also identified 201 noncontributing resources, including 171 buildings, 28 structures, 1 object, and 1 site, including secondary resources such as garages, sheds, and barns. Not included in the count of noncontributing resources are 36 resources that were previously surveyed, but are no longer extant, and 1 resource listed as "other" in the original survey that was not visible from the public right-of-way during the recent resurvey.

Section 8 of this Additional Documentation expands upon the original district's statement of significance. The district's original period of significance spanned the period from 1784 to 1949. This update extends the period of

¹ The original nomination groups Law/ Politics/ Government together as a single area of significance. Law is typically a separate area of significance from Politics/Government.

United States Department of the Interior
National Park Service

National Register of Historic Places
Continuation Sheet

Lawrenceville Historic District 2021 Update

Name of Property

Brunswick County, Virginia

County and State

0000313

NR Reference Number

Section number Additional DocumentationPage 3

significance to end in 1973, capturing Lawrenceville's mid-twentieth century growth and development. This update to the Lawrenceville Historic District also expands upon and provides additional justification for the areas of significance identified in the original nomination. The Statement of Significance for the original nomination discussed several areas of significance especially as related to the town's late-eighteenth and early nineteenth-century history. This Additional Documentation includes aspects of the district's significance that apply to those areas with a focus on its mid-twentieth century, as well as new areas of significance not discussed in the original nomination. A new area of significance, Social History, and sub-category, Social History: Civil Rights, are being added to the historic district listing for the important contributions of James Solomon Russell (also significant in the area of Education) and Nellie Pratt Russell, both of whom are significant under Criterion B.

5. Classification

Ownership of Property

(Check as many boxes as apply.)

Private:

Public – Local

Public – State

Public – Federal

Category of Property

(Check only **one** box.)

Building(s)

District

Site

Structure

Object

United States Department of the Interior
National Park Service

National Register of Historic Places
Continuation Sheet

Lawrenceville Historic District 2021 Update

Name of Property

Brunswick County, Virginia

County and State

0000313

NR Reference Number

Section number Additional DocumentationPage 4**Number of Resources within Property**

(Do not include previously listed resources in the count)

Contributing	Noncontributing	
<u>423</u>	<u>171</u>	buildings
<u>1</u>	<u>1</u>	sites
<u>6</u>	<u>28</u>	structures
<u>1</u>	<u>1</u>	objects
<u>431</u>	<u>201</u>	Total

Number of contributing resources previously listed in the National Register 7

The following NRHP-listed historic districts are also within the boundaries of the Lawrenceville Historic District: **Brunswick County Courthouse Square** at 202-234 North Main Street (NRHP 1974, updated 2009; 251-0001), which includes the Brunswick County Courthouse (251-0001-0001/251-5001-0108), the Brunswick County Courthouse Clerk's Office Building (251-0001-0002/251-5001-0107), the Brunswick County Confederate Monument (251-0001-0003/251-5001-0110), the Library (now Brunswick County Historical Society Museum; 251-0001-0004/251-5001-0109); and **Saint Paul's College** (NRHP 1979; 251-0003), which includes the Fine Arts Building (formerly the President's House) at 105 College Drive (251-0003-0001/251-5001-0448), the Saul Building at 111 College Drive (251-0003-0002/251-5001-0452), and Memorial Chapel at 109 College Drive (251-0003-0003/251-5001-0451).

6. Function or Use**Historic Functions**

(Enter categories from instructions.)

DOMESTIC: secondary structureCOMMERCE/TRADE: organizational; specialty store;SOCIAL: meeting hall; civicGOVERNMENT: town hall; jail; government officeFUNERARY: mortuaryRELIGION: religious facilityRECREATION AND CULTURE: museumINDUSTRY/PROCESSING/EXTRACTION: industrial storageTRANSPORTATION: road-related (vehicular)**Current Functions**

(Enter categories from instructions.)

United States Department of the Interior
National Park Service

National Register of Historic Places
Continuation Sheet

Lawrenceville Historic District 2021 Update

Name of Property

Brunswick County, Virginia

County and State

00000313

NR Reference Number

Section number Additional DocumentationPage 5DOMESTIC: secondary structureCOMMERCE/TRADE: organizational; financial institution; specialty storeSOCIAL: meeting hall; civicGOVERNMENT: town hall; government office; post office; courthouseFUNERARY: mortuaryRECREATION AND CULTURE: museumTRANSPORTATION: road-related (vehicular)

7. Description

Architectural Classification

(Enter categories from instructions.)

LATE VICTORIAN/ Victorian; Stick/EastlakeLATE 19TH AND 20TH CENTURY REVIVALS/ Georgian Revival; Italian Renaissance RevivalMODERN MOVEMENT/ Ranch; Art DecoOTHER/ Minimal Traditional; No discernable style**Materials:** (enter categories from instructions.)Principal exterior materials of the property: GLASS; ASBESTOS

Narrative Description

(Describe the historic and current physical appearance and condition of the property. Describe contributing and noncontributing resources if applicable. Begin with a **summary paragraph** that briefly describes the general characteristics of the property, such as its location, type, style, method of construction, setting, size, and significant features. Indicate whether the property has historic integrity.)

Summary Paragraph

Lawrenceville Historic District encompasses the historic commercial and residential core of the small town, which is centrally located in Brunswick County, Virginia, just 19 miles north of the North Carolina border and roughly halfway between Interstates 85 and 95 along Highway 58. Situated on the eastern side of Virginia's historic tobacco region, the town of Lawrenceville has a long history as the political and commercial center of Brunswick County. The town is located near the Meherrin River and approximately 16 miles north of the Lake Gaston area. The town maintains an intact commercial and residential historic district with examples of high-style and vernacular architecture ranging from the late-eighteenth through the mid-twentieth century. The town's commercial, governmental, and institutional architecture is predominantly located at the core of the district and to the north where Saint Paul's College is situated. The district primarily includes late-nineteenth and early- to mid-twentieth-century Main Street Commercial style buildings, as well as singular examples of Classical Revival, Greek Revival, Italian Renaissance Revival, International Style, Art Deco, and Romanesque Revival architecture. While most of the residential buildings constructed from the early to mid-twentieth

United States Department of the Interior
National Park Service

National Register of Historic Places
Continuation Sheet

Lawrenceville Historic District 2021 Update
Name of Property
Brunswick County, Virginia
County and State
0000313
NR Reference Number

Section number Additional Documentation

Page 6

century were vernacular dwellings with minimal ornamentation, other popular residential styles within the district include Colonial Revival, Folk Victorian, Craftsman, and Minimal Traditional. Houses constructed after the 1960s are generally smaller and simpler examples of Minimal Traditional and vernacular types.

Additionally, the district includes examples of simplified Italianate, Queen Anne, and Gothic Revival styles as well as a few mid-twentieth century Ranch houses. Lawrenceville Historic District includes 431 contributing and 201 noncontributing resources, and retains a high degree of architectural and historic integrity associated with its period of significance.

Narrative Description

Setting and Landscape

The Lawrenceville Historic District is located in Brunswick County in southside Virginia. The town, which is the historic county seat, is located on the crest of a hill and is surrounded by rolling land. The district includes the commercial and institutional core of the town, which is comprised of one- to three-story buildings primarily constructed to the lot line. The downtown streets are laid out in a semi-grid like pattern, with major cross streets branching out from the center in a star-like pattern. While the courthouse area and Saint Paul's College have large landscaped areas, the commercial core has minimal vegetation with the exception of a few street trees and is lined with sidewalks. Residential areas within the district have larger lots and streets are laid out in a combination of grid-like patterns, with a few cross or curvilinear streets. A few of the residential areas have sidewalks, and large, mature trees and vegetation are present throughout the town. The Lawrenceville Historic District is bisected by the former Atlantic & Danville Railroad that is currently part of Virginia's Rails-to-Trails program as the Tobacco Heritage Trail. Residential lots close to this trail on the west side of the town are smaller with simpler dwellings, retaining their association with the railway as former worker neighborhoods.

Integrity Analysis

The Lawrenceville Historic District retains a high degree of the seven aspects of integrity, with significantly more contributing resources than noncontributing resources. Located in central Brunswick County in Southern Virginia, Lawrenceville is surrounded by the still relatively rural landscape of the Southside Piedmont region of Virginia, and maintains integrity of *location*, *setting*, and *design* of the district. The district reflects the development of the community around the central commercial district with a majority of early neighborhoods to the south along South Main Street and west along Windsor Avenue. These neighborhoods were close to the retail shops, restaurants and entertainment options as well as the financial and government institutions of the downtown Hicks Street and North Main Street corridors. North of the downtown and northeast of Windsor Avenue contains Saint Paul's College, established in 1888, which was an institutional focal point for the town. While the school is currently closed, the buildings of the college remain preserved in their original setting and location with their materials and design unchanged. More modest neighborhoods are found south of Windsor Avenue and were built surrounding the town's historic-age Lawrenceville High School and ancillary buildings; the school has been closed. Southward expansion continued in the form of worker dwellings on smaller lots constructed in connection with the Atlantic & Danville Railroad line that was completed in 1891.

A vast majority of the individual resources in the district retain integrity of *design*, *materials*, and *workmanship* associated with their various styles and construction methods. Materials and workmanship have been retained that convey each period of development and the associated style of various buildings, with examples such as brick

United States Department of the Interior
National Park Service

National Register of Historic Places
Continuation Sheet

Lawrenceville Historic District 2021 Update

Name of Property

Brunswick County, Virginia

County and State

0000313

NR Reference Number

Section number Additional Documentation

Page 7

construction and wood siding during the early-twentieth century to the rise in popularity of asbestos siding and roofing materials, metal-framed windows, and concrete block clad in brick veneer later in the mid-twentieth century. Common material replacements in the district include vinyl siding, vinyl or metal replacement window sash, metal doors, and roofing materials. These alterations are generally not to character-defining features, and do not impact the overall integrity of the district. Retention of historic setbacks, building massing and volume, and fenestration patterns effectively convey the district's integrity.

The contributing resources together help convey Lawrenceville's historic *feeling* as a small town in Southside Virginia with a central courthouse complex and commercial district surrounded by residential neighborhoods which saw growth over the course of the twentieth century during the operation of the railroad and continued advancement of Saint Paul's College. This growth is exemplified through the continuous periods of development with a diverse collection of architectural styles that, while modest and mostly vernacular derivations of popular styles, are appropriate for a smaller town. The district also retains integrity of *association* with its period of significance ranging from 1784 to 1973 and areas of significance including Architecture, Commerce, Education, Entertainment/Recreation, Ethnic Heritage, Law/Politics/Government, Religion, Transportation, and the newly added Social History area.

Inventory

The inventory below is the result of reconnaissance-level survey of 424 properties conducted from December 2020 to January 2021. Surveyors verified the conditions of all previously-documented resources within the district, as well as documented resources not previously surveyed and all significant secondary resources. The original nomination included an inventory listing 326 contributing buildings, and 91 noncontributing buildings, 1 contributing site and 1 noncontributing site, 3 contributing structures and 2 noncontributing structures and 1 contributing object accompanied by short architectural descriptions of each resource. The 2020/2021 survey and expansion of the period of significance resulted in the identification of 431 contributing resources, including 423 buildings, 6 structures, 1 object, and 1 site. The updated survey also identified 201 noncontributing resources, including 171 buildings, 28 structures, 1 object, and 1 site, including secondary resources such as garages, sheds, and barns. Not included in the count of noncontributing resources are 36 resources that were previously surveyed, but are no longer extant, and 1 resource listed as "other" in the original survey that was not visible from the public right-of-way.

Each entry in the attached inventory identifies the primary and secondary (where applicable) resource(s), the resource type (building, site, structure, or object), number of stories, architectural style, approximate construction date, and contributing or noncontributing status. Resources within the Lawrenceville Historic District are considered contributing if they were constructed during the district's period of significance (1784-1973), are associated with one or more of the district's areas of significance, and retain architectural integrity sufficient to convey historic associations. Alterations to contributing resources were evaluated based on the overall impact to the character-defining features of the building. A detailed architectural description and surveyor assessment for each resource has also been prepared in conjunction with this nomination update, and can be accessed via the Virginia Department of Historic Resources architectural survey archives and/or the Virginia Cultural Resource Information System (V-CRIS). Resources are keyed to the updated Sketch Map by the last four digits of the resource's 11-digit historic district identification number (e.g. -0001, -0002, etc.).

United States Department of the Interior
National Park Service

National Register of Historic Places
Continuation Sheet

Lawrenceville Historic District 2021 Update
Name of Property
Brunswick County, Virginia
County and State
0000313
NR Reference Number

Section number Additional DocumentationPage 9

104 Church Street	251-5001-0010	<i>Other DHR Id#:</i>
<i>Primary Resource: Commercial Building (Building), Stories 1, Style: Commercial Style, Ca 1940</i>		
	Contributing	<i>Total: 1</i>
104-A Church Street	251-5001-0011	<i>Other DHR Id#:</i>
<i>Primary Resource: Commercial Building (Building), Stories 2, Style: Commercial Style, Ca 1956</i>		
	Contributing	<i>Total: 1</i>
106 Church Street	251-5001-0012	<i>Other DHR Id#:</i>
<i>Primary Resource: Commercial Building (Building), Stories 2, Style: Colonial Revival, Ca 1890</i>		
	Contributing	<i>Total: 1</i>
108 Church Street	251-5001-0013	<i>Other DHR Id#:</i>
<i>Primary Resource: Commercial Building (Building), Stories 2, Style: Commercial Style, Ca 1924</i>		
	Contributing	<i>Total: 1</i>
114 Church Street	251-5001-0015	<i>Other DHR Id#:</i>
<i>Primary Resource: Single Dwelling (Building), Stories 2, Style: Colonial Revival, Ca 1895</i>		
	Contributing	<i>Total: 1</i>
300 Church Street	251-5001-0016	<i>Other DHR Id#:</i>
<i>Primary Resource: Church/Chapel (Building), Stories 2, Style: Gothic Revival, 1906</i>		
	Contributing	<i>Total: 1</i>
<i>Secondary Resource: Shed (Building)</i>	Non-contributing	<i>Total: 1</i>
319 Church Street	251-5001-0022	<i>Other DHR Id#:</i>
<i>Primary Resource: Doctors Office/Building (Building), Stories 1, Style: No discernible style, 1948</i>		
	Contributing	<i>Total: 1</i>
402 Church Street	251-5001-0019	<i>Other DHR Id#:</i>
<i>Primary Resource: Single Dwelling (Building), Stories 1.5, Style: Colonial Revival, Ca 1930</i>		
	Contributing	<i>Total: 1</i>
<i>Secondary Resource: Shed (Building)</i>	Non-contributing	<i>Total: 2</i>
502 Church Street	251-5001-0020	<i>Other DHR Id#:</i>
<i>Primary Resource: Single Dwelling (Building), Stories 2, Style: Tudor Revival, 1937</i>		
	Contributing	<i>Total: 1</i>
<i>Secondary Resource: Shed (Building)</i>	Non-contributing	<i>Total: 1</i>
504 Church Street	251-5001-0323	<i>Other DHR Id#:</i>
<i>Primary Resource: Single Dwelling (Building), Stories 2, Style: Colonial Revival, 1936</i>		
	Contributing	<i>Total: 1</i>
<i>Secondary Resource: Garage (Building)</i>	Contributing	<i>Total: 1</i>

United States Department of the Interior
National Park Service

National Register of Historic Places
Continuation Sheet

Lawrenceville Historic District 2021 Update
Name of Property
Brunswick County, Virginia
County and State
0000313
NR Reference Number

Section number Additional DocumentationPage 11**Contributing** Total: 1

115 College Drive 251-5001-0454

Other DHR Id#:

*The William H. Scott Memorial Building**Primary Resource: Administration Building (Building), Stories 2, Style: Colonial Revival, 1932***Contributing** Total: 1

118 College Drive 251-5001-0455

Other DHR Id#:

*Student Center (M.E. Johnston Hall)**Primary Resource: Dining Hall/Cafeteria (Building), Stories 1, Style: No discernible style, 1966***Contributing** Total: 1

121 College Drive 251-5001-0456

Other DHR Id#:

*A.R. Johnston Hall**Primary Resource: Administration Building (Building), Stories 2, Style: Colonial Revival, 1933***Contributing** Total: 1

122 College Drive 251-5001-0457

Other DHR Id#:

*Old Student Union**Primary Resource: School (Building), Stories 1, Style: No discernible style, 1929***Contributing** Total: 1

126 College Drive 251-5001-0458

Other DHR Id#:

*The Omega Hut**Primary Resource: Clubhouse (Building), Stories 1, Style: No discernible style, 1965***Contributing** Total: 1

133 College Drive 251-5001-0459

Other DHR Id#:

*J.S. Russell Library**Primary Resource: Library (Building), Stories 1, Style: Colonial Revival, 1951***Contributing** Total: 1

134 College Drive 251-5001-0460 Other DHR Id#:

*Julia C. Emery Hall**Primary Resource: Dormitory/Barrack (Building), Stories 3, Style: Colonial Revival, 1928***Contributing** Total: 1

138 College Drive 251-5001-0462

Other DHR Id#:

United States Department of the Interior
National Park Service

National Register of Historic Places
Continuation Sheet

Lawrenceville Historic District 2021 Update

Name of Property

Brunswick County, Virginia

County and State

00000313

NR Reference Number

Section number Additional DocumentationPage 12*The Loulie Taylor Letcher Memorial Hospital**Primary Resource: Hospital (Building), Stories 2, Style: Colonial Revival, 1922***Contributing** Total: 1**21 College Drive****251-5001-0441***Other DHR Id#:**Russell Hall**Primary Resource: Classroom Building (Building), Stories 1, Style: No discernible style, 1972***Contributing** Total: 1**24 College Drive****251-5001-0442***Other DHR Id#:**The Chicago Building**Primary Resource: Administration Building (Building), Stories 1, Style: No discernible style, 1928***Contributing** Total: 1**28 College Drive****251-5001-0443***Other DHR Id#: Primary**Resource: Workshop (Building), Stories 1, Style: No discernible style, 1990***Non-contributing** Total: 1**31 College Drive****251-5001-0445***Other DHR Id#:**W.A. Brown Hall**Primary Resource: Classroom Building (Building), Stories 2, Style: No discernible style, 1951***Contributing** Total: 1

College View

100 College View**251-5001-0463***Other DHR Id#:**Primary Resource: School (Building), Stories 1, Style: Classical Revival, 1992***Non-contributing** Total: 1**125 College View****251-5001-0464***Other DHR Id#:**Primary Resource: Multiple Dwelling (Building), Stories 2, Style: Colonial Revival, 1977***Non-contributing** Total: 1**129 College View****251-5001-0465***Other DHR Id#:**Primary Resource: Multiple Dwelling (Building), Stories 2.5, Style: Colonial Revival, 1979***Non-contributing** Total: 1**133 College View****251-5001-0466***Other DHR Id#:*

United States Department of the Interior
National Park Service

National Register of Historic Places
Continuation Sheet

Lawrenceville Historic District 2021 Update
Name of Property
Brunswick County, Virginia
County and State
0000313
NR Reference Number

Section number Additional DocumentationPage 14

Primary Resource: Single Dwelling (Building), Stories 1.5, Style: Colonial Revival, 1952

Contributing Total: 1

Secondary Resource: Shed (Building)

Non-contributing Total: 1

Fifth Avenue

East 105 Fifth Avenue 251-5001-0346

Other DHR Id#:

Primary Resource: Single Dwelling (Building), Stories 1.5, Style: Colonial Revival, Ca 1950

Contributing Total: 1

East 109 Fifth Avenue 251-5001-0347

Other DHR Id#:

Primary Resource: Single Dwelling (Building), Stories 2, Style: Colonial Revival, Ca 1938

Contributing Total: 1

Secondary Resource: Garage (Building)

Contributing Total: 1

East 110 Fifth Avenue 251-5001-0348

Other DHR Id#:

Primary Resource: Single Dwelling (Building), Stories 2, Style: Colonial Revival, 1934

Contributing Total: 1

Secondary Resource: Basketball Court (Structure)

Non-contributing Total: 1

Secondary Resource: Shed (Building)

Non-contributing Total: 1

East 111 Fifth Avenue 251-5001-0349

Other DHR Id#:

Primary Resource: Single Dwelling (Building), Stories 1.5, Style: Georgian Revival, 1937

Contributing Total: 1

Secondary Resource: Shed (Building)

Non-contributing Total: 1

East 202 Fifth Avenue 251-5001-0350

Other DHR Id#:

Primary Resource: Single Dwelling (Building), Stories 1.5, Style: Craftsman, 1923

Contributing Total: 1

Secondary Resource: Garage (Building)

Contributing Total: 1

Secondary Resource: Shed (Building)

Non-contributing Total: 1

East 203 Fifth Avenue 251-5001-0351

Other DHR Id#:

Primary Resource: Single Dwelling (Building), Stories 2, Style: Tudor Revival, 1927

Contributing Total: 1

Secondary Resource: Garage (Building)

Contributing Total: 1

East 207 Fifth Avenue 251-5001-0352

Other DHR Id#:

Primary Resource: Single Dwelling (Building), Stories 2, Style: Georgian Revival, 1958

Contributing Total: 1

Secondary Resource: Shed (Building)

Non-contributing Total: 1

West 102 Fifth Avenue 251-5001-0353

Other DHR Id#:

United States Department of the Interior
National Park Service

National Register of Historic Places
Continuation Sheet

Lawrenceville Historic District 2021 Update

Name of Property

Brunswick County, Virginia

County and State

0000313

NR Reference Number

Section number Additional DocumentationPage 15

Primary Resource: Single Dwelling (Building), Stories 1, Style: Ranch, 1962

Contributing Total: 1

Secondary Resource: Shed (Building)

Non-contributing Total: 1

West 104 Fifth Avenue

251-5001-0354

Other DHR Id#:

Primary Resource: Single Dwelling (Building), Stories 1.5, Style: Colonial Revival, 1938

Contributing Total: 1

Secondary Resource: Shed (Building)

Non-contributing Total: 1

West 108 Fifth Avenue

251-5001-0355

Other DHR Id#:

Primary Resource: Single Dwelling (Building), Stories 1.5, Style: Colonial Revival, 1948

Contributing Total: 1

Secondary Resource: Garage (Building)

Contributing Total: 1

West 128 Fifth Avenue

251-5001-0360

Other DHR Id#:

Primary Resource: Single Dwelling (Building), Stories 1.5, Style: Minimal Traditional, Ca 1940

Contributing Total: 1

Secondary Resource: Pool/Swimming Pool (Structure) Non-contributing Total: 1

Secondary Resource: Shed (Building)

Non-contributing Total: 1

West 130 Fifth Avenue

251-5001-0361

Other DHR Id#:

Primary Resource: Single Dwelling (Building), Stories 1.5, Style: Minimal Traditional, Ca 1940

Contributing Total: 1

Secondary Resource: Shed (Building)

Contributing Total: 1

West 204 Fifth Avenue

251-5001-0362

Other DHR Id#:

Primary Resource: Single Dwelling (Building), Stories 1.5, Style: Minimal Traditional, 1948

Contributing Total: 1

Secondary Resource: Shed (Building)

Contributing Total: 1

West 205 Fifth Avenue

251-5001-0387

Other DHR Id#:

Primary Resource: Single Dwelling (Building), Stories 2, Style: Folk Victorian, 1905

Contributing Total: 1

West 206 Fifth Avenue

251-5001-0363

Other DHR Id#:

Primary Resource: Single Dwelling (Building), Stories 1, Style: Folk Victorian, Ca 1890

Contributing Total: 1

Secondary Resource: Shed (Building)

Contributing Total: 1

West 208 Fifth Avenue

251-5001-0364

Other DHR Id#:

Primary Resource: Single Dwelling (Building), Stories 2, Style: No discernible style, 1912

Contributing Total: 1

Secondary Resource: Garage (Building)

Contributing Total: 1

United States Department of the Interior
National Park Service

National Register of Historic Places
Continuation Sheet

Lawrenceville Historic District 2021 Update
Name of Property
Brunswick County, Virginia
County and State
00000313
NR Reference Number

Section number Additional DocumentationPage 16

Secondary Resource: Pool/Swimming Pool (Structure) Non-contributing Total: 1

West 209 Fifth Avenue **251-5001-0389** *Other DHR Id#:*

Primary Resource: Single Dwelling (Building), Stories 2, Style: No discernible style, 1905
Contributing Total: 1

West 210 Fifth Avenue **251-5001-0365** *Other DHR Id#:*

Primary Resource: Single Dwelling (Building), Stories 2, Style: No discernible style, 1912
Contributing Total: 1

Secondary Resource: Garage (Building) Contributing Total: 1

West 211 Fifth Avenue **251-5001-0390** *Other DHR Id#:*

Primary Resource: Single Dwelling (Building), Stories 2, Style: Folk Victorian, 1905
Contributing Total: 1

Secondary Resource: Barn (Building) Contributing Total: 1

West 214 Fifth Avenue **251-5001-0366** *Other DHR Id#:*

Primary Resource: Single Dwelling (Building), Stories 1, Style: No discernible style, 1960
Contributing Total: 1

Secondary Resource: Shed (Building) Contributing Total: 1

West 215 Fifth Avenue **251-5001-0391** *Other DHR Id#:*

Primary Resource: Service Station (Building), Stories 1, Style: Other, 2018

Non-contributing Total: 1

West 220 Fifth Avenue **251-5001-0367** *Other DHR Id#:*

Primary Resource: Bank (Building), Stories 1, Style: No discernible style, 2012

Non-contributing Total: 1

West 304 Fifth Avenue **251-5001-0368** *Other DHR Id#:*

The ca. 1900 primary dwelling has been demolished. The following secondary resources are extant.

Secondary Resource: Garage (Building) Non-contributing Total: 1

Secondary Resource: Office/Office Building (Building) Built 1948 Contributing Total: 1

Secondary Resource: Workshop (Building) Non-contributing Total: 1

West 305 Fifth Avenue **251-5001-0392** *Other DHR Id#:*

Primary Resource: Warehouse (Building), Stories 1, Style: No discernible style, 1975
Non-contributing Total: 1

West 308 Fifth Avenue **251-5001-0369** *Other DHR Id#:*

Primary Resource: Single Dwelling (Building), Stories 2, Style: No discernible style, Ca 1900

Contributing Total: 1

United States Department of the Interior
National Park Service

National Register of Historic Places
Continuation Sheet

Lawrenceville Historic District 2021 Update

Name of Property

Brunswick County, Virginia

County and State

00000313

NR Reference Number

Section number Additional DocumentationPage 17

West 310 Fifth Avenue	251-5001-0370	<i>Other DHR Id#:</i>
<i>Primary Resource: Single Dwelling (Building), Stories 1.5, Style: Minimal Traditional, 1958</i>		
		Contributing Total: 1
<i>Secondary Resource: Barbecue Pit (Object)</i>		Non-contributing Total: 1
West 312 Fifth Avenue	251-5001-0371	<i>Other DHR Id#:</i>
<i>Primary Resource: Restaurant (Building), Stories 1, Style: No discernible style, 1979</i>		
		Non-contributing Total: 1
<i>Secondary Resource: Shelter (Building)</i>		Non-contributing Total: 1
West 315 Fifth Avenue	251-5001-0393	<i>Other DHR Id#:</i>
<i>Primary Resource: Single Dwelling (Building), Stories 1, Style: No discernible style, 1980</i>		
		Non-contributing Total: 1
<i>Secondary Resource: Carport (Structure)</i>		Non-contributing Total: 1
West 316 Fifth Avenue	251-5001-0372	<i>Other DHR Id#:</i>
<i>Primary Resource: Commercial Building (Building), Stories 2, Style: No discernible style, 1948</i>		
		Contributing Total: 1
<i>Secondary Resource: Shed (Building)</i>		Non-contributing Total: 1
West 317 Fifth Avenue	251-5001-0394	<i>Other DHR Id#:</i>
<i>Primary Resource: Workshop (Building), Stories 1, Style: No discernible style, 1985</i>		
		Non-contributing Total: 1
West 318 Fifth Avenue	251-5001-0373	<i>Other DHR Id#:</i>
<i>Primary Resource: Commercial Building (Building), Stories 1, Style: No discernible style, 1960</i>		
		Contributing Total: 1
West 319 Fifth Avenue	251-5001-0395	<i>Other DHR Id#:</i>
<i>Primary Resource: Office/Office Building (Building), Stories 1, Style: Minimal Traditional, 1948</i>		
		Contributing Total: 1
<i>Secondary Resource: Communications Tower(Structure)</i>		Non-contributing Total: 1
<i>Secondary Resource: Scale/Scale Building (Structure)</i>		Non-contributing Total: 1
West 320 Fifth Avenue	251-5001-0374	<i>Other DHR Id#:</i>
<i>Primary Resource: Workshop (Building), Stories 1, Style: No discernible style, 1975</i>		
		Non-contributing Total: 1
West 402 Fifth Avenue	251-5001-0375	<i>Other DHR Id#:</i>
<i>Primary Resource: Church/Chapel (Building), Stories 1, Style: No discernible style, 1948</i>		
		Contributing Total: 1
<i>Secondary Resource: Shed (Building)</i>		Non-contributing Total: 1

United States Department of the Interior
National Park Service

National Register of Historic Places
Continuation Sheet

Lawrenceville Historic District 2021 Update

Name of Property

Brunswick County, Virginia

County and State

00000313

NR Reference Number

Section number Additional DocumentationPage 18

West 408 Fifth Avenue **251-5001-0376** *Other DHR Id#:*
Primary Resource: Single Dwelling (Building), Stories 1.5, Style: Minimal Traditional, 1940

*Secondary Resource: Shed (Building)***Contributing Total: 1****Non-contributing Total: 1**

West 409 Fifth Avenue **251-5001-0396** *Other DHR Id#:*

*Primary Resource: Warehouse (Building), Stories 1, Style: No discernible style, Ca 1910**Secondary Resource: Commercial Building (Building)**Secondary Resource: Other (Other)**Secondary Resource: Scale/Scale Building (Structure)**Secondary Resource: Shed (Building)**Secondary Resource: Warehouse (Building)***Contributing Total: 1****Contributing Total: 1****Non-contributing Total: 1****Contributing Total: 1****Contributing Total: 1****Contributing Total: 1**

West 410 Fifth Avenue **251-5001-0377** *Other DHR Id#:*

*Primary Resource: Single Dwelling (Building), Stories 2, Style: No discernible style, 1910**Secondary Resource: Shed (Building)***Contributing Total: 1****Contributing Total: 1**

West 411 Fifth Avenue **251-5001-0398** *Other DHR Id#:*

*Primary Resource: Single Dwelling (Building), Stories 1, Style: No discernible style, 1948**Secondary Resource: Shed (Building)***Contributing Total: 1****Non-contributing Total: 1**

West 414 Fifth Avenue **251-5001-0378** *Other DHR Id#:*

*Primary Resource: Single Dwelling (Building), Stories 1, Style: Folk Victorian, 1912**Secondary Resource: Garage (Building)**Secondary Resource: Shed (Building)***Contributing Total: 1****Contributing Total: 1****Non-contributing Total: 1**

West 415 Fifth Avenue **251-5001-0399** *Other DHR Id#:*

*Primary Resource: Single Dwelling (Building), Stories 2, Style: Folk Victorian, Ca 1902**Secondary Resource: Shed (Building)**Secondary Resource: Workshop (Building)***Contributing Total: 1****Contributing Total: 1****Contributing Total: 1**

West 417 Fifth Avenue **251-5001-0400** *Other DHR Id#:*

*Primary Resource: Single Dwelling (Building), Stories 1, Style: No discernible style, Ca 1905**Secondary Resource: Shed (Building)***Contributing Total: 1****Total: 1**

West 418 Fifth Avenue **251-5001-0380** *Other DHR Id#:*

*Primary Resource: Single Dwelling (Building), Stories 1, Style: No discernible style, 1910***Contributing Total: 1**

United States Department of the Interior
National Park Service

National Register of Historic Places
Continuation Sheet

Lawrenceville Historic District 2021 Update

Name of Property

Brunswick County, Virginia

County and State

00000313

NR Reference Number

Section number Additional DocumentationPage 19*Secondary Resource: Garage (Building)***Contributing Total: 1****West 419 Fifth Avenue 251-5001-0401***Other DHR Id#:**Primary Resource: Single Dwelling (Building), Stories 2, Style: Folk Victorian, Ca 1902***Contributing Total: 1****First Avenue****West 701 First Avenue 251-5001-0299***Other DHR Id#:**Primary Resource: Single Dwelling (Building), Stories 2, Style: No discernible style, Ca 1910***Contributing Total: 1****West 705 First Avenue 251-5001-0300***Other DHR Id#:**Primary Resource: Single Dwelling (Building), Stories 2, Style: No discernible style, Ca 1930***Contributing Total: 1***Secondary Resource: Carport (Structure)***Non-contributing Total: 1***Secondary Resource: Shed (Building)***Non-contributing Total: 1****West 801 First Avenue 251-5001-0301***Other DHR Id#:**Primary Resource: Single Dwelling (Building), Stories 1.5, Style: Craftsman, 1924***Contributing Total: 1***Secondary Resource: Shed (Building)***Non-contributing Total: 1****West 803 First Avenue 251-5001-0302***Other DHR Id#:**Primary Resource: Single Dwelling (Building), Stories 2, Style: No discernible style, Ca 1920***Contributing Total: 1***Secondary Resource: Animal Shelter/Kennel (Building) Non-contributing Total: 1**Secondary Resource: Shed (Building)***Contributing Total: 1****West 804 First Avenue 251-5001-0294***Other DHR Id#:**Primary Resource: Single Dwelling (Building), Stories 1.5, Style: No discernible style, Ca 1945***Contributing Total: 1****West 805 First Avenue 251-5001-0303***Other DHR Id#:**Primary Resource: Single Dwelling (Building), Stories 1.5, Style: Colonial Revival, 1948***Contributing Total: 1***Secondary Resource: Shed (Building)***Non-contributing Total: 1****West 808 First Avenue 251-5001-0295***Other DHR Id#:**Primary Resource: Single Dwelling (Building), Stories 1.5, Style: Queen Anne, Ca 1908***Contributing Total: 1****West 809 First Avenue 251-5001-0304***Other DHR Id#:**Primary Resource: Multiple Dwelling (Building), Stories 2, Style: Folk Victorian, 1910*

United States Department of the Interior
National Park Service

National Register of Historic Places
Continuation Sheet

Lawrenceville Historic District 2021 Update
Name of Property
Brunswick County, Virginia
County and State
00000313
NR Reference Number

Section number Additional DocumentationPage 20

Contributing Total: 1

West 901 First Avenue 251-5001-0305

Other DHR Id#:

Primary Resource: Single Dwelling (Building), Stories 1.5, Style: Craftsman, 1928

Contributing Total: 1

Secondary Resource: Garage (Building)

Contributing Total: 1

West 902 First Avenue 251-5001-0296

Other DHR Id#:

Primary Resource: Single Dwelling (Building), Stories 2, Style: Folk Victorian, Ca 1910

Contributing Total: 1

Secondary Resource: Garage (Building)

Contributing Total: 1

West 905 First Avenue 251-5001-0306

Other DHR Id#:

Primary Resource: Single Dwelling (Building), Stories 1.5, Style: Craftsman, Ca 1920

Contributing Total: 1

Secondary Resource: Shed (Building)

Non-contributing Total: 1

West 908 First Avenue 251-5001-0297

Other DHR Id#:

Primary Resource: Single Dwelling (Building), Stories 1.5, Style: Craftsman, Ca 1924

Contributing Total: 1

Secondary Resource: Shed (Building)

Non-contributing Total: 1

West 909 First Avenue 251-5001-0307

Other DHR Id#:

Primary Resource: Single Dwelling (Building), Stories 1.5, Style: Minimal Traditional, 1948

Contributing Total: 1

Secondary Resource: Carport (Structure)

Non-contributing Total: 1

Secondary Resource: Garage (Building)

Contributing Total: 1

West 911 First Avenue 251-5001-0308

Other DHR Id#:

Primary Resource: Single Dwelling (Building), Stories 1, Style: Craftsman, Ca 1930

Contributing Total: 1

Secondary Resource: Office/Office Building (Building) Contributing Total: 1

West 912 First Avenue 251-5001-0298

Other DHR Id#:

Primary Resource: Single Dwelling (Building), Stories 1, Style: Craftsman, Ca 1930

Contributing Total: 1

Secondary Resource: Garage (Building) Contributing Total: 1

Fourth Avenue

East 104 Fourth Avenue 251-5001-0341

Other DHR Id#:

Primary Resource: Single Dwelling (Building), Stories 1, Style: Ranch, 1993

Non-contributing Total: 1

United States Department of the Interior
National Park Service

National Register of Historic Places
Continuation Sheet

Lawrenceville Historic District 2021 Update

Name of Property

Brunswick County, Virginia

County and State

0000313

NR Reference Number

Section number Additional DocumentationPage 21

East 106 Fourth Avenue **251-5001-0342** *Other DHR Id#:*
Primary Resource: Single Dwelling (Building), Stories 1.5, Style: Colonial Revival, Ca 1925

*Secondary Resource: Shed (Building)***Contributing Total: 1****Non-contributing Total: 1**

West 418 Fourth Avenue **251-5001-0344** *Other DHR Id#:*

*Primary Resource: Single Dwelling (Building), Stories 1, Style: Folk Victorian, Ca 1910***Contributing Total: 1**

West 420 Fourth Avenue **251-5001-0345** *Other DHR Id#:*

*Primary Resource: Single Dwelling (Building), Stories 2, Style: No discernible style, Ca 1905***Contributing Total: 1***Secondary Resource: Garage (Building)***Non-contributing Total: 1****Grove Avenue**

803 Grove Avenue **251-5001-0035** *Other DHR Id#:*

*Primary Resource: Single Dwelling (Building), Stories 1, Style: Craftsman, Ca 1918***Contributing Total: 1**

806 Grove Avenue **251-5001-0036** *Other DHR Id#:*

*Primary Resource: Single Dwelling (Building), Stories 2, Style: Craftsman, Ca 1924***Contributing Total: 1***Secondary Resource: Carport (Structure)***Non-contributing Total: 1***Secondary Resource: Shed (Building)***Non-contributing Total: 1**

808 Grove Avenue **251-5001-0037** *Other DHR Id#:*

*Primary Resource: Single Dwelling (Building), Stories 1.5, Style: Colonial Revival, Ca 1950***Contributing Total: 1***Secondary Resource: Shed (Building)***Non-contributing Total: 1**

900 Grove Avenue **251-5001-0038** *Other DHR Id#:*

*Primary Resource: Single Dwelling (Building), Stories 1.5, Style: Craftsman, Ca 1916***Contributing Total: 1***Secondary Resource: Shed (Building)***Non-contributing Total: 1****Hicks Street**

201 Hicks Street **251-5001-0189** *Other DHR Id#:*

Primary Resource: Commercial Building (Building), Stories 1, Style: Commercial Style, 1960

United States Department of the Interior
National Park Service

National Register of Historic Places
Continuation Sheet

Lawrenceville Historic District 2021 Update

Name of Property

Brunswick County, Virginia

County and State

0000313

NR Reference Number

Section number Additional DocumentationPage 22

		Contributing	<i>Total:</i> 1
205 Hicks Street	251-5001-0190		<i>Other DHR Id#:</i>
<i>Primary Resource: Commercial Building (Building), Stories 2, Style: Commercial Style, 1948</i>			
		Contributing	<i>Total:</i> 1
301-305 Hicks Street	251-5001-0191		<i>Other DHR Id#:</i>
<i>Primary Resource: Commercial Building (Building), Stories 1, Style: Commercial Style, 1955</i>			
		Contributing	<i>Total:</i> 1
302 Hicks Street	251-5001-0193		<i>Other DHR Id#:</i>
<i>Primary Resource: Commercial Building (Building), Stories 1, Style: Commercial Style, 1958</i>			
		Contributing	<i>Total:</i> 1
304 Hicks Street	251-5001-0192		<i>Other DHR Id#:</i>
<i>Primary Resource: Commercial Building (Building), Stories 1, Style: Commercial Style, Ca 1955</i>			
		Contributing	<i>Total:</i> 1
East 102 Hicks Street	251-5001-0041		<i>Other DHR Id#:</i>
<i>Primary Resource: Commercial Building (Building), Stories 3, Style: Commercial Style, 1910</i>			
		Contributing	<i>Total:</i> 1
East 110 Hicks Street	251-5001-0042		<i>Other DHR Id#:</i>
<i>Primary Resource: Commercial Building (Building), Stories 2, Style: Commercial Style, Ca 1915</i>			
		Contributing	<i>Total:</i> 1
Hicks Street	251-5001-0481		<i>Other DHR Id#:</i>
<i>Primary Resource: Bridge (Structure), Stories , Style: No discernible style, 1956</i>			
		Contributing	<i>Total:</i> 1
South 101 Hicks Street	251-5001-0064		<i>Other DHR Id#:</i>
<i>Primary Resource: Service Station (Building), Stories 1, Style: Commercial Style, 1954</i>			
		Contributing	<i>Total:</i> 1
South 201 Hicks Street	251-5001-0067		<i>Other DHR Id#:</i>
<i>Primary Resource: Single Dwelling (Building), Stories 2, Style: Folk Victorian, Ca 1900</i>			
		Contributing	<i>Total:</i> 1
<i>Secondary Resource: Shed (Building)</i>		Non-contributing	<i>Total:</i> 1
South 301 Hicks Street	251-5001-0068		<i>Other DHR Id#:</i>
<i>Primary Resource: Single Dwelling (Building), Stories 1, Style: Folk Victorian, Ca 1900</i>			
		Contributing	<i>Total:</i> 1
<i>Secondary Resource: Shed (Building)</i>		Non-contributing	<i>Total:</i> 1

United States Department of the Interior
National Park Service

National Register of Historic Places
Continuation Sheet

Lawrenceville Historic District 2021 Update
Name of Property
Brunswick County, Virginia
County and State
0000313
NR Reference Number

Section number Additional DocumentationPage 23

South 303 Hicks Street	251-5001-0069	<i>Other DHR Id#:</i>
<i>Primary Resource: Single Dwelling (Building), Stories 1, Style: Folk Victorian, Ca 1900</i>		
		Contributing Total: 1
<i>Secondary Resource: Shed (Building)</i>		
		Non-contributing Total: 1
South 304 Hicks Street	251-5001-0070	<i>Other DHR Id#:</i>
<i>Primary Resource: Church/Chapel (Building), Stories 2, Style: Gothic Revival, 1901</i>		
		Contributing Total: 1
<i>Secondary Resource: Carport (Structure)</i>		
		Non-contributing Total: 1
South 401 Hicks Street	251-5001-0071	<i>Other DHR Id#:</i>
<i>Primary Resource: Single Dwelling (Building), Stories 2, Style: Folk Victorian, Ca 1900</i>		
		Contributing Total: 1
<i>Secondary Resource: Garage (Building)</i>		
		Contributing Total: 1
South 403 Hicks Street	251-5001-0072	<i>Other DHR Id#:</i>
<i>Primary Resource: Single Dwelling (Building), Stories 2, Style: Folk Victorian, Ca 1900</i>		
		Contributing Total: 1
South 405 Hicks Street	251-5001-0073	<i>Other DHR Id#:</i>
<i>Primary Resource: Single Dwelling (Building), Stories 1, Style: No discernible style, Ca 1900</i>		
		Contributing Total: 1
<i>Secondary Resource: Shed (Building)</i>		
		Non-contributing Total: 2
South 409 Hicks Street	251-5001-0074	<i>Other DHR Id#:</i>
NOTE: the post office is in space leased by the US Postal Service.		
<i>Primary Resource: Post Office (Building), Stories 1, Style: No discernible style, 1980</i>		
		Non-contributing Total: 1
South 411 Hicks Street	251-5001-0075	<i>Other DHR Id#:</i>
<i>Primary Resource: Commercial Building (Building), Stories 1, Style: Commercial Style, 1947</i>		
		Contributing Total: 1
West 102 Hicks Street	251-5001-0045	<i>Other DHR Id#:</i>
<i>Primary Resource: Commercial Building (Building), Stories 3, Style: Commercial Style, Ca 1915</i>		
		Contributing Total: 1
West 106 Hicks Street	251-5001-0046	<i>Other DHR Id#:</i>
<i>Primary Resource: Commercial Building (Building), Stories 2, Style: Commercial Style, Ca 1928</i>		
		Contributing Total: 1
West 108 Hicks Street	251-5001-0047	<i>Other DHR Id#:</i>
<i>Primary Resource: Commercial Building (Building), Stories 1, Style: Commercial Style, Ca 1928</i>		

United States Department of the Interior
National Park Service

National Register of Historic Places
Continuation Sheet

Lawrenceville Historic District 2021 Update

Name of Property

Brunswick County, Virginia

County and State

0000313

NR Reference Number

Section number Additional DocumentationPage 24**Contributing** Total: 1**West 111-113 Hicks Street** 251-5001-0057

Other DHR Id#:

Primary Resource: **Commercial Building (Building), Stories 2, Style: Commercial Style, Ca 1899****Contributing** Total: 1**West 112 Hicks Street** 251-5001-0048

Other DHR Id#:

Primary Resource: **Commercial Building (Building), Stories 2, Style: No discernible style, Ca 1930****Contributing** Total: 1**West 114 Hicks Street** 251-5001-0049

Other DHR Id#:

Primary Resource: **Commercial Building (Building), Stories 1, Style: Commercial Style, Ca 1924****Contributing** Total: 1**West 115 Hicks Street** 251-5001-0058

Other DHR Id#:

Primary Resource: **Commercial Building (Building), Stories 2, Style: Commercial Style, Ca 1900****Contributing** Total: 1**West 116 Hicks Street** 251-5001-0050

Other DHR Id#:

Primary Resource: **Commercial Building (Building), Stories 3, Style: Commercial Style, Ca 1914****Contributing** Total: 1**West 118 Hicks Street** 251-5001-0052

Other DHR Id#:

Primary Resource: **Commercial Building (Building), Stories 2, Style: Commercial Style, Ca 1913****Contributing** Total: 1**West 121 Hicks Street** 251-5001-0059

Other DHR Id#:

Primary Resource: **Commercial Building (Building), Stories 1, Style: Commercial Style, Ca 1902****Contributing** Total: 1**West 122 Hicks Street** 251-5001-0053

Other DHR Id#:

Primary Resource: **Mobile Home/Trailer (Building), Stories 1, Style: No discernible style, Ca 2004****Non-contributing** Total: 1**West 123 Hicks Street** 251-5001-0060

Other DHR Id#:

Primary Resource: **Commercial Building (Building), Stories 1, Style: Commercial Style, 1956****Contributing** Total: 1**West 126 Hicks Street** 251-5001-0053

Other DHR Id#:

Primary Resource: **Commercial Building (Building), Stories 1, Style: Commercial Style, 2004****Non-Contributing** Total: 1**West 127 Hicks Street** 251-5001-0430

Other DHR Id#:

Primary Resource: **Commercial Building (Building), Stories 1, Style: Commercial Style, Ca 1925**

United States Department of the Interior
National Park Service

National Register of Historic Places
Continuation Sheet

Lawrenceville Historic District 2021 Update

Name of Property

Brunswick County, Virginia

County and State

0000313

NR Reference Number

Section number Additional DocumentationPage 25

		Contributing	<i>Total:</i> 1
West 128 Hicks Street	251-5001-0054		<i>Other DHR Id#:</i>
<i>Primary Resource: Commercial Building (Building), Stories 2, Style: Commercial Style, Ca 1919</i>			
		Contributing	<i>Total:</i> 1
West 129 Hicks Street	251-5001-0061		<i>Other DHR Id#:</i>
<i>Primary Resource: Commercial Building (Building), Stories 1, Style: Commercial Style, Ca 1928</i>			
		Contributing	<i>Total:</i> 1
West 130 Hicks Street	251-5001-0055		<i>Other DHR Id#:</i>
<i>Primary Resource: Commercial Building (Building), Stories 2, Style: Commercial Style, Ca 1922</i>			
		Contributing	<i>Total:</i> 1
West 132 Hicks Street	251-5001-0056		<i>Other DHR Id#:</i>
<i>Primary Resource: Commercial Building (Building), Stories 2, Style: Italian Renaissance Revival, Ca 1922</i>			
		Contributing	<i>Total:</i> 1
West 133 Hicks Street	251-5001-0429		<i>Other DHR Id#:</i>
<i>Primary Resource: Library (Building), Stories 1, Style: Commercial Style, Ca 1930</i>			
		Contributing	<i>Total:</i> 1
West 135 Hicks Street	251-5001-0062		<i>Other DHR Id#:</i>
<i>Primary Resource: Library (Building), Stories 2, Style: Commercial Style, Ca 1916</i>			
		Contributing	<i>Total:</i> 1
West 137 Hicks Street	251-5001-0186		<i>Other DHR Id#:</i>
<i>Primary Resource: Commercial Building (Building), Stories 1, Style: Commercial Style, Ca 1941</i>			
		Contributing	<i>Total:</i> 1
West 139 Hicks Street	251-5001-0187		<i>Other DHR Id#:</i>
<i>Primary Resource: Commercial Building (Building), Stories 1, Style: Commercial Style, Ca 1900</i>			
		Contributing	<i>Total:</i> 1
West 141 Hicks Street	251-5001-0188		<i>Other DHR Id#:</i>
<i>Primary Resource: Commercial Building (Building), Stories 1, Style: Commercial Style, Ca 1900</i>			
		Contributing	<i>Total:</i> 1
West 143 Hicks Street	251-5001-0063		<i>Other DHR Id#:</i>
<i>Primary Resource: Service Station (Building), Stories 1, Style: International Style, 1960</i>			
		Contributing	<i>Total:</i> 1
High Street			

United States Department of the Interior
National Park Service

National Register of Historic Places
Continuation Sheet

Lawrenceville Historic District 2021 Update

Name of Property

Brunswick County, Virginia

County and State

0000313

NR Reference Number

Section number Additional DocumentationPage 26

200 High Street	251-5001-0077	<i>Other DHR Id#:</i>
<i>Primary Resource: Warehouse (Building), Stories 1, Style: No discernible style, 1970</i>		
		Contributing Total: 1
304 High Street	251-5001-0078	<i>Other DHR Id#:</i>
<i>Primary Resource: Single Dwelling (Building), Stories 1, Style: No discernible style, 1956</i>		
		Contributing Total: 1
<i>Secondary Resource: Shed (Building)</i>		Contributing Total: 1
305 High Street	251-5001-0089	<i>Other DHR Id#:</i>
<i>Primary Resource: Single Dwelling (Building), Stories 1.5, Style: Minimal Traditional, 1950</i>		
		Contributing Total: 1
<i>Secondary Resource: Carport (Structure)</i>		Non-contributing Total: 2
<i>Secondary Resource: Garage (Building)</i>		Contributing Total: 1
306 High Street	251-5001-0079	<i>Other DHR Id#:</i>
<i>Primary Resource: Single Dwelling (Building), Stories 1.5, Style: Craftsman, Ca 1925</i>		
		Contributing Total: 1
<i>Secondary Resource: Garage (Building)</i>		Contributing Total: 1
308 High Street	251-5001-0080	<i>Other DHR Id#:</i>
<i>Primary Resource: Single Dwelling (Building), Stories 1, Style: Craftsman, Ca 1924</i>		
		Contributing Total: 1
310 High Street	251-5001-0081	<i>Other DHR Id#:</i>
<i>Primary Resource: Single Dwelling (Building), Stories 1, Style: No discernible style, 2011</i>		
		Non-contributing Total: 1
312 High Street	251-5001-0082	<i>Other DHR Id#:</i>
<i>Primary Resource: Single Dwelling (Building), Stories 2, Style: No discernible style, 2012</i>		
		Non-contributing Total: 1
315 High Street	251-5001-0093	<i>Other DHR Id#:</i>
<i>Primary Resource: Single Dwelling (Building), Stories 1, Style: No discernible style, Ca 1902</i>		
		Contributing Total: 1
401 High Street	251-5001-0094	<i>Other DHR Id#:</i>
<i>Primary Resource: Single Dwelling (Building), Stories 2, Style: No discernible style, Ca 1905</i>		
		Contributing Total: 1
<i>Secondary Resource: Shed (Building)</i>		Non-contributing Total: 1
402 High Street	251-5001-0083	<i>Other DHR Id#:</i>

United States Department of the Interior
National Park Service

National Register of Historic Places
Continuation Sheet

Lawrenceville Historic District 2021 Update
Name of Property
Brunswick County, Virginia
County and State
0000313
NR Reference Number

Section number Additional DocumentationPage 28**507 High Street****251-5001-0102***Other DHR Id#:*

Primary Resource: Single Dwelling (Building), Stories 1.5, Style: Craftsman, Ca 1930
Contributing Total: 1

Main Street**Main Street****251-5001-0478***Other DHR Id#:*

Primary Resource: Bridge (Structure), Stories , Style: No discernible style, 1956
Contributing Total: 1

North 102 Main Street**251-5001-0103***Other DHR Id#:*

Primary Resource: Meeting/Fellowship Hall (Building), Stories 1, Style: No discernible style, 1950
Contributing Total: 1

North 108 Main Street**251-5001-0104***Other DHR Id#:*

Primary Resource: Single Dwelling (Building), Stories 1.5, Style: Colonial Revival, 1947
Contributing Total: 1

North 202 Main Street**251-0001-0005***Other DHR Id#: 251-5001-0106**Current Brunswick County Courthouse*

Primary Resource: Courthouse (Building), Stories 2.5, Style: Colonial Revival, 1998
Non-contributing Total: 1
Secondary Resource: Trough (Structure)
Contributing Total: 1

North 203 Main Street**251-5001-0111***Other DHR Id#:*

Primary Resource: Commercial Building (Building), Stories 2, Style: Art Deco, Ca 1890
Contributing Total: 1

North 205 Main Street**251-5001-0112***Other DHR Id#:*

Primary Resource: Commercial Building (Building), Stories 2, Style: Commercial Style, Ca 1912
Contributing Total: 1

North 207 Main Street**251-5001-0113***Other DHR Id#:*

Primary Resource: Commercial Building (Building), Stories 3, Style: Commercial Style, 1885
Contributing Total: 1

North 209 Main Street**251-5001-0114***Other DHR Id#:*

Primary Resource: Commercial Building (Building), Stories 2, Style: Commercial Style, Ca 1890
Contributing Total: 1

United States Department of the Interior
National Park Service

National Register of Historic Places
Continuation Sheet

Lawrenceville Historic District 2021 Update

Name of Property

Brunswick County, Virginia

County and State

0000313

NR Reference Number

Section number Additional DocumentationPage 29

North 213 Main Street	251-5001-0115	<i>Other DHR Id#:</i>
<i>Primary Resource: Commercial Building (Building), Stories 2, Style: Commercial Style, Ca 1890</i>		
	Contributing	<i>Total: 1</i>
North 215 Main Street	251-5001-0116	<i>Other DHR Id#:</i>
<i>Primary Resource: Office/Office Building (Building), Stories 2, Style: Commercial Style, Ca 1916</i>		
	Contributing	<i>Total: 1</i>
North 216 Main Street	251-0001-0002	<i>Other DHR Id#: 251-5001-0107</i>
<i>Courthouse Clerk's Office Building</i>		
<i>Primary Resource: Office/Office Building (Building), Stories 2, Style: Romanesque Revival/Richardsonian, 1893</i>		
	Contributing	<i>Total: 1</i>
North 219 Main Street	251-5001-0117	<i>Other DHR Id#:</i>
<i>Primary Resource: Bank (Building), Stories 2, Style: Classical Revival, Ca 1924</i>		
	Contributing	<i>Total: 1</i>
North 221 Main Street	251-5001-0118	<i>Other DHR Id#:</i>
<i>Primary Resource: Commercial Building (Building), Stories 2, Style: Commercial Style, Ca 1900</i>		
	Contributing	<i>Total: 1</i>
North 225 Main Street	251-5001-0119	<i>Other DHR Id#:</i>
<i>Primary Resource: Commercial Building (Building), Stories 2, Style: Commercial Style, Ca 1930</i>		
	Contributing	<i>Total: 1</i>
North 228 Main Street	251-0001-0001	<i>Other DHR Id#: 251-5001-0108</i>
<i>Brunswick County Courthouse (former)</i>		
<i>Primary Resource: Courthouse (Building), Stories 2, Style: Greek Revival, 1854</i>		
	Contributing	<i>Total: 1</i>
<i>Secondary Resource: Monument/Marker (Object)</i>		
	Contributing	<i>Total: 1</i>
North 229 Main Street	251-5001-0120	<i>Other DHR Id#:</i>
<i>Primary Resource: Commercial Building (Building), Stories 2, Style: Commercial Style, Ca 1890</i>		
	Contributing	<i>Total: 1</i>
North 233 Main Street	251-5001-0121	<i>Other DHR Id#:</i>
<i>Primary Resource: Commercial Building (Building), Stories 2, Style: Commercial Style, Ca 1880</i>		
	Contributing	<i>Total: 1</i>
North 234 Main Street	251-0001-0003	<i>Other DHR Id#: 251-5001-0110</i>

United States Department of the Interior
National Park Service

National Register of Historic Places
Continuation Sheet

Lawrenceville Historic District 2021 Update

Name of Property

Brunswick County, Virginia

County and State

0000313

NR Reference Number

Section number Additional DocumentationPage 30**Brunswick County Confederate Monument**

Primary Resource: **Monument/Marker (Object), Stories , Style: Classical Revival, 1911**
Contributing Total: 1

North 234 Main Street 251-0001-0004

*Other DHR Id#: 251-5001-0109**Brunswick County Historical Society (former library)*

Primary Resource: **Library (Building), Stories 1.5, Style: Colonial Revival, 1941**

Contributing Total: 1

North 307 Main Street 251-5001-0122

Other DHR Id#:

Primary Resource: **Commercial Building (Building), Stories 3, Style: Commercial Style, Ca 1885**

Contributing Total: 1*Secondary Resource: Other (Other)***Contributing Total: 1***Secondary Resource: Warehouse (Building)***Contributing Total: 1**

North 311 Main Street 251-5001-0123

Other DHR Id#:

Primary Resource: **Commercial Building (Building), Stories 2, Style: Commercial Style, Ca 1895**

Contributing Total: 1

North 313 Main Street 251-5001-0124

Other DHR Id#:

Primary Resource: **Commercial Building (Building), Stories 2, Style: Commercial Style, Ca 1895**

Contributing Total: 1

North 317 Main Street 251-5001-0125

Other DHR Id#:

Primary Resource: **Commercial Building (Building), Stories 2, Style: Commercial Style, Ca 1895**

Contributing Total: 1

North 319 Main Street 251-5001-0126

Other DHR Id#:

Primary Resource: **Commercial Building (Building), Stories 2, Style: Commercial Style, Ca 1918**

Contributing Total: 1

North 321 Main Street 251-5001-0127

Other DHR Id#:

Primary Resource: **Commercial Building (Building), Stories 1, Style: Commercial Style, Ca 1930**

Contributing Total: 1

North 405-407 Main Street 251-5001-0128

Other DHR Id#:

Primary Resource: **Commercial Building (Building), Stories 1, Style: Commercial Style, 1960**

Contributing Total: 1

North 409-413 Main Street 251-5001-0129

*Other DHR Id#:**The Corner Inn*

United States Department of the Interior
National Park Service

National Register of Historic Places
Continuation Sheet

Lawrenceville Historic District 2021 Update
Name of Property
Brunswick County, Virginia
County and State
00000313
NR Reference Number

Section number Additional DocumentationPage 31

Primary Resource: Commercial Building (Building), Stories 2, Style: Commercial Style, Ca 1948

Contributing Total: 1

North 417 Main Street 251-5001-0130

Other DHR Id#:

Primary Resource: Single Dwelling (Building), Stories 1.5, Style: Colonial Revival, 1948

Contributing Total: 1

Secondary Resource: Carport (Structure)

Non-contributing Total: 1

North 419 Main Street 251-5001-0131

Other DHR Id#:

Primary Resource: Multiple Dwelling (Building), Stories 1.5, Style: Colonial Revival, 1947

Contributing Total: 1

North 425 Main Street 251-5001-0433

Other DHR Id#:

Primary Resource: Single Dwelling (Building), Stories 1, Style: Other, 1970

Contributing Total: 1

North Main Street 251-5001-0105

Other DHR Id#:

Primary Resource: Commercial Building (Building), Stories 1, Style: Commercial Style, 1924

Contributing Total: 1

South 101 Main Street 251-5001-0148

Other DHR Id#:

Primary Resource: Single Dwelling (Building), Stories 2, Style: Colonial Revival, Ca 1900

Contributing Total: 1

Secondary Resource: Carport (Structure)

Non-contributing Total: 1

Secondary Resource: Shed (Building)

Non-contributing Total: 1

South 103 Main Street 251-5001-0149

Other DHR Id#:

Primary Resource: Single Dwelling (Building), Stories 2, Style: Other, Ca 1835

Contributing Total: 1

Secondary Resource: Slave/Servant Quarters (Building) Non-contributing Total: 1

South 104 Main Street 251-5001-0133

Other DHR Id#:

Primary Resource: Single Dwelling (Building), Stories 1.5, Style: Colonial Revival, Ca 1955

Contributing Total: 1

Secondary Resource: Garage (Building)

Non-contributing Total: 1

South 105 Main Street 251-5001-0150

Other DHR Id#:

Primary Resource: Multiple Dwelling (Building), Stories 2, Style: Craftsman, Ca 1925

Contributing Total: 1

Secondary Resource: Barn (Building)

Non-contributing Total: 1

Secondary Resource: Garage (Building)

Non-contributing Total: 1

South 110 Main Street 251-5001-0135

Other DHR Id#:

United States Department of the Interior
National Park Service

National Register of Historic Places
Continuation Sheet

Lawrenceville Historic District 2021 Update
Name of Property
Brunswick County, Virginia
County and State
0000313
NR Reference Number

Section number Additional DocumentationPage 32

Primary Resource: Single Dwelling (Building), Stories 1.5, Style: Other, Ca 1964

Contributing Total: 1

Secondary Resource: Secondary Dwelling (Building) Non-contributing Total: 1

South 202 Main Street 251-5001-0136

Other DHR Id#:

Primary Resource: Single Dwelling (Building), Stories 2, Style: Other, Ca 1810

Contributing Total: 1

Secondary Resource: Shed (Building) Non-contributing Total: 1

South 203 Main Street 251-5001-0151

Other DHR Id#:

Primary Resource: Park (Site), Stories , Style: Classical Revival, 1996

Non-contributing Total: 1

South 205 Main Street 251-5001-0152

Other DHR Id#:

Primary Resource: Multiple Dwelling (Building), Stories 2, Style: Colonial Revival, 1968

Contributing Total: 1

Secondary Resource: Multiple Dwelling (Building) Non-contributing Total: 1

South 206 Main Street 251-5001-0137

Other DHR Id#:

Primary Resource: Single Dwelling (Building), Stories 1.5, Style: Colonial Revival, Ca 1950

Contributing Total: 1

South 207 Main Street 251-5001-0153

Other DHR Id#:

Primary Resource: Single Dwelling (Building), Stories 1, Style: Ranch, 1971

Contributing Total: 1

Secondary Resource: Garage (Building) Non-contributing Total: 1

Secondary Resource: Shed (Building) Non-contributing Total: 1

South 209 Main Street 251-5001-0154

Other DHR Id#:

Primary Resource: Single Dwelling (Building), Stories 1.5, Style: Craftsman, Ca 1918

Contributing Total: 1

Secondary Resource: Carport (Structure) Non-contributing Total: 1

Secondary Resource: Shed (Building) Non-contributing Total: 1

South 210 Main Street 251-5001-0138

Other DHR Id#:

Primary Resource: Multiple Dwelling (Building), Stories 2, Style: Other, Ca 1890

Contributing Total: 1

Secondary Resource: Garage (Building) Non-contributing Total: 1

South 301 Main Street 251-5001-0155

Other DHR Id#:

Primary Resource: Single Dwelling (Building), Stories 1, Style: Folk Victorian, Ca 1875

Contributing Total: 1

United States Department of the Interior
National Park Service

National Register of Historic Places
Continuation Sheet

Lawrenceville Historic District
Name of Property
Brunswick County, Virginia
County and State
Name of multiple listing (if applicable)

Section number Additional Documentation

Page 33

Secondary Resource: Garage (Building)

Non-contributing Total: 1

South 304 Main Street 251-5001-0139

Other DHR Id#:

Primary Resource: Single Dwelling (Building), Stories 1.5, Style: Colonial Revival, Ca 1930

Contributing Total: 1

Secondary Resource: Garage (Building)

Non-contributing Total: 1

South 306 Main Street 251-5001-0140

Other DHR Id#:

Primary Resource: Single Dwelling (Building), Stories 2, Style: Colonial Revival, Ca 1930

Contributing Total: 1

Secondary Resource: Secondary Dwelling (Building)

Contributing Total: 1

South 308 Main Street 251-5001-0141

Other DHR Id#:

Primary Resource: Single Dwelling (Building), Stories 2, Style: Stick/Eastlake, Ca 1890

Contributing Total: 1

Secondary Resource: Pool House (Building)

Non-contributing Total: 1

Secondary Resource: Pool/Swimming Pool (Structure)

Non-contributing Total: 1

South 309 Main Street 251-5001-0156

Other DHR Id#:

Primary Resource: Single Dwelling (Building), Stories 2, Style: Craftsman, Ca 1900

Contributing Total: 1

South 401 Main Street 251-5001-0157

Other DHR Id#:

Primary Resource: Single Dwelling (Building), Stories 1.5, Style: Craftsman, Ca 1918

Contributing Total: 1

South 402 Main Street 251-5001-0142

Other DHR Id#:

Primary Resource: Single Dwelling (Building), Stories 1.5, Style: Craftsman, Ca 1918

Contributing Total: 1

South 404 Main Street 251-5001-0143

Other DHR Id#:

Primary Resource: Single Dwelling (Building), Stories 1.5, Style: Tudor Revival, Ca 1936

Contributing Total: 1

South 405 Main Street 251-5001-0158

Other DHR Id#:

Primary Resource: Single Dwelling (Building), Stories 1.5, Style: Craftsman, Ca 1922

Contributing Total: 1

South 406 Main Street 251-5001-0144

Other DHR Id#:

Primary Resource: Single Dwelling (Building), Stories 1.5, Style: Tudor Revival, Ca 1936

Contributing Total: 1

South 507 Main Street 251-5001-0159

Other DHR Id#:

United States Department of the Interior
National Park Service

National Register of Historic Places
Continuation Sheet

Lawrenceville Historic District
Name of Property
Brunswick County, Virginia
County and State
Name of multiple listing (if applicable)

Section number Additional Documentation

Page 37

Secondary Resource: Garage (Building)

Contributing Total: 1
Contributing Total: 1

514 New Street

251-5001-0185

Other DHR Id#:

Primary Resource: Warehouse (Building), Stories 1, Style: No discernible style, Ca 1945

Secondary Resource: Ice House (Building)

Contributing Total: 1

Secondary Resource: Office/Office Building (Building)

Non-contributing Total: 2

Secondary Resource: Shed (Building)

Non-contributing Total: 1

Secondary Resource: Warehouse (Building)

Non-contributing Total: 2

Non-contributing Total: 1

Park Street

301 Park Street

251-5001-0213

Other DHR Id#:

Primary Resource: Warehouse (Building), Stories 1, Style: No discernible style, 1988

Secondary Resource: Shed (Building)

Non-contributing Total: 1

Non-contributing Total: 3

304 Park Street

251-5001-0194

Other DHR Id#:

Primary Resource: Single Dwelling (Building), Stories 1, Style: No discernible style, Ca 1900

Contributing Total: 1

306 Park Street

251-5001-0195

Other DHR Id#:

Primary Resource: Single Dwelling (Building), Stories 1, Style: No discernible style, Ca 1930

Secondary Resource: Garage (Building)

Contributing Total: 1

Non-contributing Total: 1

308 Park Street

251-5001-0196

Other DHR Id#:

Primary Resource: Single Dwelling (Building), Stories 1.5, Style: No discernible style, Ca 1902

Contributing Total: 1

310 Park Street

251-5001-0197

Other DHR Id#:

Primary Resource: Single Dwelling (Building), Stories 2, Style: No discernible style, Ca 1900

Contributing Total: 1

312 Park Street

251-5001-0198

Other DHR Id#:

Primary Resource: Single Dwelling (Building), Stories 2, Style: No discernible style, Ca 1900

Contributing Total: 1

314 Park Street

251-5001-0199

Other DHR Id#:

Primary Resource: Single Dwelling (Building), Stories 2, Style: No discernible style, Ca 1900

Contributing Total: 1

402 Park Street

251-5001-0200

Other DHR Id#:

United States Department of the Interior
National Park Service

National Register of Historic Places
Continuation Sheet

Lawrenceville Historic District
Name of Property
Brunswick County, Virginia
County and State
Name of multiple listing (if applicable)

Section number Additional Documentation

Page 39

Secondary Resource: Outbuilding, Domestic (Building) **Contributing Total: 1**
Contributing Total: 1
512 Park Street **251-5001-0210** *Other DHR Id#:*

Primary Resource: Single Dwelling (Building), Stories 2, Style: No discernible style, 1948 **Contributing Total: 1**
Secondary Resource: Shed (Building) **Non-contributing Total: 1**

514 Park Street **251-5001-0211** *Other DHR Id#:*
Primary Resource: Single Dwelling (Building), Stories 2, Style: No discernible style, Ca 1905

Secondary Resource: Shed (Building) **Contributing Total: 1**
Non-contributing Total: 1

516 Park Street **251-5001-0212** *Other DHR Id#:*
Primary Resource: Single Dwelling (Building), Stories 2, Style: No discernible style, Ca 1902

Contributing Total: 1

517 Park Street **251-5001-0215** *Other DHR Id#:*

Primary Resource: Single Dwelling (Building), Stories 2, Style: Folk Victorian, 1890 **Contributing Total: 1**
Secondary Resource: Shed (Building) **Contributing Total: 1**

Plank Road

416 Plank Road **251-5001-0217** *Other DHR Id#:*

Primary Resource: Single Dwelling (Building), Stories 1, Style: Minimal Traditional, 1970 **Contributing Total: 1**

426 Plank Road **251-5001-0218** *Other DHR Id#:*
Primary Resource: Single Dwelling (Building), Stories 2, Style: No discernible style, Ca 1918

Contributing Total: 1

508 Plank Road **251-5001-0219** *Other DHR Id#:*

Primary Resource: Single Dwelling (Building), Stories 1.5, Style: Craftsman, Ca 1925 **Contributing Total: 1**

510 Plank Road **251-5001-0220** *Other DHR Id#:*

Primary Resource: Single Dwelling (Building), Stories 1, Style: Craftsman, Ca 1925 **Contributing Total: 1**
Secondary Resource: Garage (Building) **Non-contributing Total: 1**

Railroad Street

United States Department of the Interior
National Park Service

National Register of Historic Places
Continuation Sheet

Lawrenceville Historic District
Name of Property
Brunswick County, Virginia
County and State
Name of multiple listing (if applicable)

Section number Additional Documentation

Page 41

Primary Resource: **Commercial Building (Building), Stories 2, Style: Moderne, 1948**
Contributing Total: 1

Second Avenue

West 502 Second Avenue 251-5001-0309 Other DHR Id#:

Primary Resource: **Church School (Building), Stories 1, Style: No discernible style, 1947**
Contributing Total: 1

West 601 Second Avenue 251-5001-0317 Other DHR Id#:

Primary Resource: **Single Dwelling (Building), Stories 1, Style: No discernible style, Ca 1890**
Contributing Total: 1
Secondary Resource: **Office/Office Building (Building) Non-contributing Total: 1**
Secondary Resource: **Shed (Building) Non-contributing Total: 1**

West 603 Second Avenue 251-5001-0318 Other DHR Id#:

Primary Resource: **Single Dwelling (Building), Stories 1, Style: No discernible style, Ca 1880**
Contributing Total: 1

West 605 Second Avenue 251-5001-0319 Other DHR Id#:

Primary Resource: **Single Dwelling (Building), Stories 1, Style: No discernible style, 1922**
Contributing Total: 1
Secondary Resource: **Garage (Building) Contributing Total: 1**

West 610 Second Avenue 251-5001-0310 Other DHR Id#:

Primary Resource: **Single Dwelling (Building), Stories 1, Style: No discernible style, Ca 1900**
Contributing Total: 1
Secondary Resource: **Well House (Building) Contributing Total: 1**

West 704 Second Avenue 251-5001-0311 Other DHR Id#:

Primary Resource: **Single Dwelling (Building), Stories 1, Style: No discernible style, Ca 1910**
Contributing Total: 1
Secondary Resource: **Garage (Building) Non-contributing Total: 1**
Secondary Resource: **Secondary Dwelling (Building) Non-contributing Total: 1**

West 706 Second Avenue 251-5001-0312 Other DHR Id#:

Primary Resource: **Single Dwelling (Building), Stories 2, Style: Craftsman, Ca 1920**
Contributing Total: 1

West 707 Second Avenue 251-5001-0320 Other DHR Id#:

Primary Resource: **Multiple Dwelling (Building), Stories 2, Style: Folk Victorian, Ca 1905**
Contributing Total: 1

United States Department of the Interior
National Park Service

National Register of Historic Places
Continuation Sheet

Lawrenceville Historic District
Name of Property
Brunswick County, Virginia
County and State
Name of multiple listing (if applicable)

Section number Additional Documentation

Page 42

West 802 Second Avenue **251-5001-0313** *Other* *DHR* *Id#:*

Primary Resource: Single Dwelling (Building), Stories 1, Style: Craftsman, Ca 1920
Contributing Total: 1

West 803 Second Avenue **251-5001-0321** *Other* *DHR* *Id#:*

Primary Resource: Multiple Dwelling (Building), Stories 2, Style: Craftsman, Ca 1915
Contributing Total: 1

West 804 Second Avenue **251-5001-0314** *Other* *DHR* *Id#:*

Primary Resource: Single Dwelling (Building), Stories 1.5, Style: Craftsman, Ca 1922
Contributing Total: 1
Secondary Resource: Garage (Building) **Contributing Total: 1**
Secondary Resource: Shed (Building) **Contributing Total: 1**
Secondary Resource: Shed (Building) **Non-contributing Total: 1**

West 806 Second Avenue **251-5001-0315** *Other* *DHR* *Id#:*

Primary Resource: Single Dwelling (Building), Stories 1.5, Style: Craftsman, 1918
Contributing Total: 1
Secondary Resource: Carport (Structure) **Non-contributing Total: 1**

Sharp Street

201 Sharp Street **251-5001-0235** *Other* *DHR* *Id#:*

Primary Resource: Factory (Building), Stories 1, Style: No discernible style, 1950
Contributing Total: 1

206 Sharp Street **251-5001-0236** *Other* *DHR* *Id#:*

Primary Resource: Fire Station (Building), Stories 1, Style: No discernible style, Ca 1918
Contributing Total: 1

304 Sharp Street **251-5001-0237** *Other* *DHR* *Id#:*

Primary Resource: Single Dwelling (Building), Stories 1.5, Style: Colonial Revival, Ca 1950
Contributing Total: 1
Secondary Resource: Garage (Building) **Contributing Total: 1**

Sixth Avenue

104 Sixth Avenue **251-5001-0415** *Other* *DHR* *Id#:*

Primary Resource: Single Dwelling (Building), Stories 1, Style: Tudor Revival, 1938
Contributing Total: 1

United States Department of the Interior
National Park Service

National Register of Historic Places
Continuation Sheet

Lawrenceville Historic District
Name of Property
Brunswick County, Virginia
County and State
Name of multiple listing (if applicable)

Section number Additional Documentation

Page 45

Primary Resource: Single Dwelling (Building), Stories 2, Style: No discernible style, Ca 1895

Secondary Resource: Carport (Structure)
Secondary Resource: Shed (Building)

Contributing Total: 1
Non-contributing Total: 1
Non-contributing Total: 2

West 616 Third Avenue 251-5001-0329

Other DHR Id#:

Primary Resource: Single Dwelling (Building), Stories 2, Style: No discernible style, Ca 1900

Contributing Total: 1

West 618 Third Avenue 251-5001-0330

Other DHR Id#:

Primary Resource: Single Dwelling (Building), Stories 1, Style: No discernible style, Ca 1900

Secondary Resource: Garage (Building)

Contributing Total: 1
Non-contributing Total: 1

West 705 Third Avenue 251-5001-0334

Other DHR Id#:

Primary Resource: Single Dwelling (Building), Stories 1, Style: Minimal Traditional, 1948

Secondary Resource: Carport (Structure)
Secondary Resource: Garage (Building)

Contributing Total: 1
Non-contributing Total: 1
Contributing Total: 1

West 711 Third Avenue 251-5001-0480

Other DHR Id#:

Primary Resource: Single Dwelling (Building), Stories 1, Style: No discernible style, Ca 2002

Non-contributing Total: 1

West 713 Third Avenue 251-5001-0335

Other DHR Id#:

Primary Resource: Single Dwelling (Building), Stories 1, Style: No discernible style, 1950

Contributing Total: 1

West 717 Third Avenue 251-5001-0336

Other DHR Id#:

Primary Resource: Single Dwelling (Building), Stories 2, Style: No discernible style, 1915

Secondary Resource: Workshop (Building)

Contributing Total: 1
Non-contributing Total: 1

West 719 Third Avenue 251-5001-0337

Other DHR Id#:

Primary Resource: Single Dwelling (Building), Stories 2, Style: No discernible style, 1915

Secondary Resource: Shed (Building)

Contributing Total: 1
Non-contributing Total: 1

West 721 Third Avenue 251-5001-0338

Other DHR Id#:

Primary Resource: Single Dwelling (Building), Stories 2, Style: Craftsman, Ca 1915

Secondary Resource: Carport (Structure)
Secondary Resource: Shed (Building)

Contributing Total: 1
Non-contributing Total: 1
Contributing Total: 1

United States Department of the Interior
National Park Service

National Register of Historic Places
Continuation Sheet

Lawrenceville Historic District
Name of Property
Brunswick County, Virginia
County and State
Name of multiple listing (if applicable)

Section number Additional Documentation

Page 48

Primary Resource: Single Dwelling (Building), Stories 1, Style: Folk Victorian, Ca 1910
Contributing Total: 1

515 Walnut Street 251-5001-0257 Other DHR Id#:

Primary Resource: Single Dwelling (Building), Stories 2, Style: No discernible style, Ca 1905
Contributing Total:1

Windsor Avenue

400 Windsor Avenue 251-5001-0258 Other DHR Id#:

Primary Resource: Church/Chapel (Building), Stories 1, Style: Gothic Revival, 1829
Contributing Total: 1

Secondary Resource: Monument/Marker (Object) Contributing Total: 1

401 Windsor Avenue 251-5001-0276 Other DHR Id#:

Primary Resource: Multiple Dwelling (Building), Stories 2, Style: Craftsman, 1910
Contributing Total: 1

402 Windsor Avenue 251-5001-0259 Other DHR Id#:

Primary Resource: Single Dwelling (Building), Stories 1, Style: Ranch, 1979
Non-contributing Total:1

403 Windsor Avenue 251-5001-0277 Other DHR Id#:

Primary Resource: Single Dwelling (Building), Stories 2, Style: Folk Victorian, 1885
Contributing Total: 1

Secondary Resource: Secondary Dwelling (Building) Non-contributing Total: 1

404 Windsor Avenue 251-5001-0260 Other DHR Id#:

Primary Resource: Single Dwelling (Building), Stories 1, Style: Craftsman, Ca 1915
Contributing Total: 1

405 Windsor Avenue 251-5001-0278 Other DHR Id#:

Primary Resource: Single Dwelling (Building), Stories 2, Style: Italianate, Ca 1890
Contributing Total:1

409 Windsor Avenue 251-5001-0279 Other DHR Id#:

Primary Resource: Single Dwelling (Building), Stories 2, Style: Queen Anne, Ca 1900
Contributing Total: 1

Secondary Resource: Shed (Building) Non-contributing Total: 1

410 Windsor Avenue 251-5001-0261 Other DHR Id#:

Primary Resource: Funeral Home/Mortuary (Building), Stories 1, Style: No discernible style,

United States Department of the Interior
National Park Service

National Register of Historic Places
Continuation Sheet

Lawrenceville Historic District
Name of Property
Brunswick County, Virginia
County and State
Name of multiple listing (if applicable)

Section number Additional Documentation

Page 52

Contributing Total: 1

710 Windsor Avenue

251-5001-0275

Other DHR Id#:

Primary Resource: Single Dwelling (Building), Stories 2, Style: Colonial Revival, 1848

Contributing Total: 1

Secondary Resource: Barn (Building)

Contributing Total: 1

Secondary Resource: Cemetery (Site)

Contributing Total: 1

Secondary Resource: Constructed Water feature (Structure) Non-contributing Total: 1

Secondary Resource: Gazebo (Structure)

Non-contributing Total: 1

Secondary Resource: Smoke/Meat House (Building)

Contributing Total: 1

711 Windsor Avenue

251-5001-0292

Other DHR Id#:

Primary Resource: Single Dwelling (Building), Stories 1.5, Style: Craftsman, Ca 1915

Contributing Total: 1

Secondary Resource: Constructed Water feature (Structure) Non-contributing Total: 1

Secondary Resource: Garage (Building)

Non-contributing Total: 1

Secondary Resource: Pergola (Structure)

Non-contributing Total: 1

712 Windsor Avenue

251-5001-0428

Other DHR Id#:

Primary Resource: Single Dwelling (Building), Stories 2, Style: No discernible style, 1935

Contributing Total: 1

8. Statement of Significance

Applicable National Register Criteria

B. Property is associated with the lives of persons significant in our past.

Areas of Significance

(Enter categories from instructions.)

SOCIAL HISTORY

SOCIAL HISTORY: Civil Rights

Period of Significance

1784-1973

Significant Dates

United States Department of the Interior
National Park Service

National Register of Historic Places
Continuation Sheet

Lawrenceville Historic District
Name of Property
Brunswick County, Virginia
County and State
Name of multiple listing (if applicable)

Section number Additional Documentation

Page 53

1961

Significant Person

(Complete only if Criterion B is marked above.)

Russell, James Solomon

Russell, Nellie Pratt

Architect/Builder

Streat, Jr., William Alfred, Architect

Students of Saint Paul's College

Statement of Significance Summary Paragraph (Provide a summary paragraph that includes level of significance, applicable criteria, justification for the period of significance, and any applicable criteria considerations.)

Lawrenceville Historic District (251-5001), located in Brunswick County, Virginia, was originally listed in the National Register of Historic Places in 2000 and the Virginia Landmarks Register in 1999. The original nomination form identified nine areas of significance: Architecture, Archaeology, Commerce, Education, Entertainment/Recreation, Ethnic Heritage, Law/Politics/Government, Religion, and Transportation. The district was listed under Criteria A, C, and D at the local level of significance, with a period of significance of 1784 to 1949. This update to the Lawrenceville Historic District extends the period of significance to end in 1973 to include the full and comprehensive growth and development of the town into the mid-twentieth century. This nomination update also provides additional context and justification for several areas of significance identified in the original nomination. Specifically, the areas which continued to contribute to the significance of the district through the mid-twentieth century include Architecture, Commerce, Transportation, Education, Ethnic Heritage: African-American, and Politics/Government. A new area of significance, Social History, has been identified due to contributions of James Solomon Russell and Nellie Pratt Russell as well as events associated with the Civil Rights movement in Lawrenceville. J. S. Russell and N. P. Russell each are significant individuals under Criterion B, J. S. Russell in the areas of Education, Ethnic Heritage: African American, and Social History and N. P. Russell in the areas of Social History and Ethnic Heritage: African American. The district also is locally significant in the area of Social History: Civil Rights as a place where St. Paul College students engaged in protests against segregation including at locations in downtown Lawrenceville. This update to the Lawrenceville Historic District adds 1961, associated with the construction of U.S. Highway 58, as a significant date. Lawrenceville leadership opposed constructing Hwy 58 through downtown Lawrenceville. The construction of the new transportation route around the town resulted in the preservation of the main street core, but also prompted the beginning of an

United States Department of the Interior
National Park Service

National Register of Historic Places
Continuation Sheet

Lawrenceville Historic District
Name of Property
Brunswick County, Virginia
County and State
Name of multiple listing (if applicable)

Section number Additional Documentation

Page 54

economic decline coinciding with increased automobile travel and a decrease in the use of passenger trains

Narrative Statement of Significance (Provide at least **one** paragraph for each area of significance.)

Criterion C: Architecture

The Lawrenceville Historic District was originally nominated for the NRHP under Criterion C for the Architecture area of significance as a well-preserved collection of 19th and early 20th century commercial and residential buildings that represent a wide range of styles and forms. The district continued to grow and evolve through the early 1970s. Commercial and institutional architecture from the mid-20th century primarily features the Colonial Revival, Main Street Commercial, and other styles associated with the Modern Movement (e.g., Corporate Commercial). The town’s mid-20th century commercial development occurred primarily along New and Hicks Streets, with a few infill buildings along Main Street. New Street, which is located near the center of the historic district, includes a high concentration of one-story commercial buildings constructed during the early 1950s. These commercial buildings consist mainly of concrete block buildings with brick veneer storefronts with parapet roofs, most having metal coping. The storefronts have minimal decoration with large one or two pane windows with aluminum frames and brick kneewalls. Only a few of the buildings' facades have been covered with metal panels or parged, and one building at 406 New Street (251-5001-0183) has had their original windows infilled.

The district’s original nomination identified many Colonial Revival-style residences. The preference for this style continued into the post-World War II era but using a more stripped down, economical interpretation of the style. The district also includes a number Ranch and Split-level houses, demonstrating adoption of newly emerging housing forms and layouts. A large majority of the residential architecture constructed during the 1950s through the early 1970s are one-story Minimal Traditional dwellings, and have such minimal detailing that they display no discernable style. Other prevalent influences include Cape Cod, Tudor Revival, Folk Victorian, and Neo-Eclectic stylistic derivations.

The mid-twentieth century commercial and residential buildings in the district are primarily one to one-and-a-half stories, with the exception of a few larger two-story academic and dormitory buildings located on the campus of St. Paul’s College. These buildings, which reflect the growth and expansion of the college during the mid-20th century, are primarily Colonial Revival style, but also include several examples of International Style including the 1973 Russell Hall (251-5001-0441) or the 1966 M.E. Johnston Hall (251-5001-0455). Prior to this period, in 1919, the campus of St. Paul’s Normal and Industrial School (later St. Paul’s College) included 40 buildings, three of which were brick. In addition to the original three buildings constructed in the late 1800s, the campus showpiece became the 1928 Chicago Building (251-5001-0442), constructed with student labor. It housed the administration, the auditorium and classrooms.²

² *Story of the St. Paul Normal and Industrial School (Catechetically Arranged), Lawrenceville, VA, 1919.*

United States Department of the Interior
National Park Service

National Register of Historic Places
Continuation Sheet

Lawrenceville Historic District

Name of Property

Brunswick County, Virginia

County and State

Name of multiple listing (if applicable)

Section number Additional DocumentationPage 55

St. Paul's students were involved in the construction of some campus buildings, as well as buildings in the town. Their role in building construction allowed them to apply the skills they learned in their training. St. Paul's students also provided manpower and learned skills for the building expansion that came with the growth of the town after the coming of the Atlantic & Danville Railroad at the turn of the twentieth century. Archdeacon James Solomon Russell, founder and principal of the school, noted in his autobiography, *Adventure in Faith*, that St. Paul's students "built about three-fourths of the new houses" in the town."³ Russell's autobiography also noted that St. Paul's College provided ice and electricity to much of the town, and some obtained water by tapping to the college's system.⁴

William Alfred Streat, Jr. (1920-1994)

Architect William Alfred Streat, Jr., designed several of the mid-twentieth century buildings on the campus of St. Paul's College, including the 1952 restoration of the St. Paul's College Student Center (251-5001-0455), the 1953 restoration of the St. Paul's College President's Residence (demolished; not in district boundary), ca. 1900 Fine Arts Building (251-0003-0001/251-5001-0448), and later with the 1993 renovation of the ca. 1888 Saul Building (251-0003-000-0002/251-5001-0452), the first building erected on the campus.⁵

Streat spent his childhood on the campus of St. Paul's College, where his parents, William A. Streat, Sr. and Marie Green Streat, were teachers. He completed St. Paul's High School in 1937. During World War II, Streat served in the U.S. Army Corps of Engineers and in the Army Air Corps as a B-25 twin-engine bomber pilot with the 99th U.S. Pursuit Squadron, better known as the "Tuskegee Airmen." Upon returning home from the war, Streat received a Bachelor of Science degree in building construction from Hampton Institute in 1948; a Bachelor of Science degree in architecture from the University of Illinois in 1948; and, a master of Science degree in architectural engineering from Massachusetts Institute of Technology in 1949. He completed additional study in civil engineering at Duke University and University of California at Berkeley. Streat also attended the jointly offered program in architectural criticism at Harvard University/MIT, and city and regional planning at Columbia University.

Streat was a registered architect and practiced for forty-two years in North Carolina, South Carolina, and Virginia. In 1952, he became the second African American person licensed to practice architecture in the state of North Carolina. Streat served as Professor and Chair of the Architectural Engineering Department at North Carolina Agricultural and Technical State University from 1949 to 1985. He maintained a practice in North Carolina and surrounding states from 1952 until his death in 1994. His extensive list of life's work includes 22 buildings. Churches, houses, and historic restorations were

<http://hdl.handle.net/2027/nnc2.ark:/13960/t3cz75g91>; http://www.hathitrust.org/access_use#pd as cited in "Lost Colleges – St. Paul's College (258). <https://www.lostcolleges.com/st-paul-normal0and-industrial-school>, (accessed on 11 September 2020).

³ James Solomon Russell. *Adventure in Faith*. Morehouse Publishing, 1936: pp. 54-55.

⁴ James Solomon Russell. *Adventure in Faith*. Morehouse Publishing, 1936: pp. 54-55.

⁵ Samuel J. Hodges, III. "William Alfred Streat Jr. (1920-1994)" in Dreck Spurlock Wilson, ed. *African American Architects, a Biographical Dictionary, 1865-1945* (New York: Routledge, 2004): 532-534.

United States Department of the Interior
National Park Service

National Register of Historic Places
Continuation Sheet

Lawrenceville Historic District
Name of Property
Brunswick County, Virginia
County and State
Name of multiple listing (if applicable)

Section number Additional Documentation

Page 56

prominent among his designs portfolio.⁶

Criterion A: Commerce and Transportation

The Lawrenceville Historic District is locally significant under Criterion A in the areas of Commerce and Transportation. In general, Lawrenceville’s prosperity waned after World War II. The automobile and associated highway building programs gave easier access to businesses across the region while rail transportation declined. The mid-twentieth century did bring some new types of commercial growth and development to Lawrenceville, and tobacco cultivation remained integral to the local and regional economy of Southside Virginia. Among the most important mid-twentieth-century elements of Lawrenceville’s commercial development and transportation significance was the construction of U.S. Highway 58 in 1961. Local leadership opposed the construction of the highway through downtown Lawrenceville, citing its potential impact to the historic core. Merchants, however, correctly feared that Highway 58 bypass of Lawrenceville would have a negative impact on the town’s economy. While the town saw a gradual decline in economic activity associated with the increase in automobile travel and decrease in passenger and freight railroad transport, by virtue of the highway 58 bypass, the downtown area was spared road widening projects that might have affected the architectural character of the town. Ultimately, the work by city leadership resulted in the preservation of downtown Lawrenceville, and the introduction of new types of businesses.

During the 1950s and 1960s, new commercial buildings were constructed to accommodate new or growing businesses along Church Street, High Street, New Street, New Hicks Street, North Hicks Street, North Main Street, Sharp Street, South Street, West Hicks Street, and Windsor Avenue. Several automobile related businesses and garages opened along New Street, South Street, and South Hicks Street. These businesses were strategically located within proximity to the new bypass and lined the main route into downtown from the bypass. While the new Hwy 58 bypass prompted new commercial development south of the traditional downtown, by the early 1970s disinvestment in downtown commercial businesses and deterioration of buildings began to occur. This was not uncommon throughout Virginia and across the country as historic downtowns were bypassed by the automobile. One exception during this period was W.S. Peebles & Co, which expanded its headquarters and department store at 203 N. Main Street after World War II and opened Peebles clothing stores (251-5001-0111) and Star Value grocery stores (251-5001-0191) both in Lawrenceville (Star Value Grocery at 301-305 New Hicks Street) and across Virginia and North Carolina. Peebles was founded in 1891 by William Smith Peebles, who opened his first store in Lawrenceville.⁷ During the 1920s and 1930s, Peebles expanded operations throughout Virginia and into the Carolinas, and by the mid-twentieth century Peebles stores were scattered across the Mid-Atlantic region. Peebles stores were generally modestly sized, but offered a wide variety of luxury brands from across the United States to their communities. The Peebles store in Lawrenceville, sometimes referred to as the “Mother Store” remained

⁶ Samuel J. Hodges, III. “William Alfred Streat, Jr. (1920-1994): 532-534.

⁷ Gregory J. Gilligan. “After 125 years, Peebles’ name on stores in Virginia is ending as locations are converted to off-price concept” *Richmond Times-Dispatch*. August 16, 2019.

United States Department of the Interior
National Park Service

National Register of Historic Places
Continuation Sheet

Lawrenceville Historic District
Name of Property
Brunswick County, Virginia
County and State
Name of multiple listing (if applicable)

Section number Additional Documentation

Page 57

family operated until 1986.⁸ Marion Wooten Peebles, part owner of the Peebles Department store chain, died in April 1956 at the age of 55. He was a lifelong resident of Lawrenceville, a member of the Lawrenceville Town Council for almost fifteen years, and a Trustee of the Lawrenceville Methodist Church.⁹

Lawrenceville was never characterized by heavy industry and had limited industrial growth during the mid-twentieth century, although there were some industrial operations in and just outside of the town. Tobacco storage warehouses historically were present within the town but were demolished during the 1970s. The large Planters Warehouse at 305 West 5th Street served as a central trading center. A factory for General Garment Manufacturing Company was built in 1950 at 201 Sharp Street (251-5001-0235) (today Brunswick Business Center), and an industrial building was constructed by Felton Bros at 301 South Street (251-5001-0435) in 1970. Lawrenceville Machine Shop (251-5001-0374) provided steel fabrication services on West 5th Avenue across from the railroad yard. The largest and most thriving industry in Lawrenceville was Brunswick Ice & Coal (251-5001-0185 & 251-5001-0213), established by the Pecht Family in a Quonset hut warehouse along the Atlantic & Danville Railroad on New Street just after the end of World War II. Recent companies have expanded it for beverage warehousing and purified ice plant operations.¹⁰

The economic impact of the Atlantic & Danville Railroad in Lawrenceville and its demise perhaps played the most significant role in the town’s history and development patterns from the 1890s until the railroad shops stopped operating in 1952-55. According to the district’s original nomination, “Lawrenceville’s prosperity was directly related to the coming of the Atlantic & Danville RR in 1891.”¹¹ Being the midway point on the route between Portsmouth and Danville enabled Lawrenceville to prosper and grow as a freight shipping point for agriculture and lumber products grown and milled in the Brunswick County area. Additionally, its mid-point location functioned as a turning yard for the trains along the route. In order to provide “workingman’s houses” in proximity to the railroad, Benjamin Newglass, an Atlantic & Danville Railroad investor, developed the neighborhood of “Newtown” in Lawrenceville.¹² Newtown was located within the Lawrenceville Historic District, just south of the railroad along West Fourth, Fifth, and Sixth Streets. The modest dwellings were one to two-stories, wood frame construction with asbestos shingle siding. Many have recently been updated with vinyl siding and windows, but their footprints and character remain largely intact and representative of the worker housing developed specifically with railroad laborers in mind.

After the boom years of World War II, traffic on the Atlantic and Danville track between Danville and Pinners Point declined, which began to have an impact on Lawrenceville’s economy. Trucks competed

⁸ Michael Lisicky. “Peebles Waits To Reopen And Restart Its Final Closing Sale” *Forbes*. May 14, 2020. <https://www.forbes.com/sites/michaellisicky/2020/05/14/peebles-waits-to-reopen-and-restart-its-final-closing-sale/?sh=23b3f59917c1>, (accessed on 1 March 2021).

⁹ “M. W. Peebles Chain Store Owner Dies” *Richmond Times-Dispatch*. April 3, 1956.

¹⁰ Bill Laffoon and Nat Neblett. *Lawrenceville Historic District National Register Nomination, 2000*: Section 8, p. 12.

¹¹ Bill Laffoon and Nat Neblett. *Lawrenceville Historic District National Register Nomination, 2000*.

¹² Virginia Places: The Atlantic & Danville Railroad. <http://www.virginiaplaces.org/rail/anlanticdanville.html>, (accessed on 5 February 2021).

United States Department of the Interior
National Park Service

National Register of Historic Places
Continuation Sheet

Lawrenceville Historic District
Name of Property
Brunswick County, Virginia
County and State
Name of multiple listing (if applicable)

Section number Additional Documentation

Page 58

successfully for much of the freight-hauling business of the railroads. Although the Atlantic & Danville Railroad continued to operate the line independently for 13 years after the end of its long-term lease with Southern Railway, by 1962 the railroad was acquired by Norfolk and Western. The Norfolk and Western renamed the line as the Norfolk, Franklin & Danville Railway. In 1983, Norfolk and Western merged with Southern Railway to form Norfolk Southern, resulting in the eventual abandonment of most of the railroad line. The only portion of the old Atlantic and Danville Railroad still in use today is the branch from Suffolk to the West Norfolk site on the Elizabeth River.¹³

Today, repurposing abandoned portions of the rail line is underway. The Tobacco Heritage Trail, spurred by the Roanoke River Rails-to-Trails effort and local governments, will follow routes of the Atlantic and Danville, Richmond and Danville, and Virginian railroads. A trail head is located just outside of downtown Lawrenceville within the historic district on the west side of South Street and the Tobacco Heritage Trail Park is located on the former site of the Claiborne Hotel at 108 North Hicks Street (251-5001-0436), adjacent to the former rail line. Economic development leaders anticipate that tourism will help to offset the decline of manufacturing jobs in Southside Virginia.¹⁴

An archaeological resource, the “Atlantic & Danville RR Lawrenceville Yard Archaeological Site” (44-BR-0136 at 321-407 West Fifth Avenue) was included in the original nomination as having potential to yield significant archaeological information. A search in VCRIS in February 2021 revealed no additional archaeological research has been conducted for this resource since first identified in 1998. No additional evaluation of archaeological potential was conducted as part of this update.

Criterion A: Education

The Lawrenceville Historic District is significant under Criterion A in the area of Education, reflective of broader trends occurring across the rural South and Virginia and for its association with St. Paul’s College. Lawrenceville Historic District is also significant under Criterion B for its association with Reverend James Solomon Russell, founder of St. Paul’s College.

Lawrenceville’s all-white public school facilities originally occupied the block west of Park Street between Third Avenue to the south and Second Avenue to the north, with at least one building being actively used during the years between 1906 and 1976. The original brick, two-story high school was constructed 1906-1907 followed by a new brick high school in 1927. Between these years a frame school building was constructed for the primary grades. With the construction of the 1927 high school, the 1906 high school was repurposed as the elementary school. Later, when the Town and County consolidated their education facilities, a consolidated high school was erected in 1955 to the northeast, outside of the town. Consequently, the 1927 building was eventually demolished. The lower grades moved to a separate facility outside town in 1976, leaving the 1906 brick high school and the early frame school building occupied by a learning center. Thus, by the mid-to-late twentieth century, there

¹³ Virginia Places: The Atlantic & Danville Railroad.

¹⁴ Virginia Places: The Atlantic & Danville Railroad.

United States Department of the Interior
National Park Service

National Register of Historic Places
Continuation Sheet

Lawrenceville Historic District
Name of Property
Brunswick County, Virginia
County and State
Name of multiple listing (if applicable)

Section number Additional Documentation

Page 59

were no longer any remaining public schools within the Town of Lawrenceville.¹⁵ The impact of this over time on the vitality and stability of the neighborhood along Park Avenue, Second Avenue, and Third Avenue areas has been substantial. Many of the original houses have been demolished and replaced with modern infill housing of an incompatible scale and style.

Prior to 1950, Brunswick County had no public high school facilities for black students. According to George R. “Billy” Smith, a Brunswick County native locally-renowned for his activism associated with the passage of the Voting Rights Act, “the schools did not even pretend to be ‘separate but equal’.”¹⁶ Segregated schooling was the norm throughout Virginia starting in 1870 with creation of the first statewide public school system. Because the local public high school was for whites only, Smith and his friends attended classes in rooms the county rented from the all-black St. Paul’s College.¹⁷ This was because St. Paul’s College was fully accredited and Brunswick County decided to enter into an agreement with Saint Paul’s to fill this void. Saint Paul’s School, therefore, included a high school course segment in its curriculum that mainly consisted of the trades and some academic training. The Saint Paul’s Polytechnic Institute enrollment was 547 and the Saint Paul’s High School enrollment was 585.¹⁸

In 1948, discussions began regarding the construction of a new high school building for black students to be funded by the Brunswick County School Board. The efforts were led by Oris P. Jones, an African-American mortician in Lawrenceville, whose home is located at 419 N. Main Street (251-5001-0131), and businessman John Brown, who also donated land for the new high school site. The Brunswick County School Board, under superintendent R. Lee Chambliss, requested that Saint Paul’s continue its high school program through 1950 and, in turn, it would build the new high school and assume the financial responsibilities for its operation. James Solomon Russell High School was built outside of the Lawrenceville Historic District on VA-46 north of Lawrenceville. The first group of students transferred from Saint Paul’s High School in 1950 to the new high school under the leadership of principal H. Leslie Giles, principal, and assistant principal James B. Cooley.¹⁹

Like most school districts throughout Virginia, Lawrenceville and Brunswick County schools remained racially segregated until 1969. Although the Supreme Court decision of *Brown vs. Board of Education* found racial segregation of schools unconstitutional in 1954, states found various methods to delay integration based upon the court’s vague instruction to integrate schools at “all deliberate speed.” In 1956, Virginia added a series of legislative acts designed to resist integration, which became known as Massive Resistance. Then Governor Thomas B. Stanley formed a committee chaired by Garland Gray of Sussex County, which developed legislation that allowed for local governments to integrate public schools; however, it also provided alternative solutions that supported segregation, including taxpayer-

¹⁵ Laffoon and Neblett. *Lawrenceville Historic District National Register Nomination*: Sect. 7, p. 6

¹⁶ Kent Willis. “Black History Month IV: George Smith and the Virginia Voting Rights Miracle.” American Civil Liberties Union – Virginia. <https://www.acluva.org/en/news/black-history-month-iv-george-smith-and-virginia-voting-rights-miracle>, (accessed on 24 September 2020).

¹⁷ Kent Willis. “Black History Month IV: George Smith and the Virginia Voting Rights Miracle.” .

¹⁸ “James Solomon Russell High School: A Brief History.”

¹⁹ “James Solomon Russell High School: A Brief History.”

United States Department of the Interior
National Park Service

National Register of Historic Places
Continuation Sheet

Lawrenceville Historic District
Name of Property
Brunswick County, Virginia
County and State
Name of multiple listing (if applicable)

Section number Additional Documentation

Page 60

funded tuition grants for students to attend private schools rather than integrated public schools.²⁰ Parents in Brunswick County utilized this special funding to send their children to the all-white private school, Brunswick Academy, which was founded in 1964. Virginia’s General Assembly continued to use alternative methods to derail federal desegregation orders until 1968, when the Supreme Court decision of *Green vs. County School Board of New Kent County* required school placement based on geographic zoning.²¹ Brunswick County schools were integrated in 1969 in the consolidated Brunswick High School (constructed ca. 1955) outside the historic district.²² The James Solomon Russell High School became the racially integrated County middle school.

Criterion B: Education and Social History - Reverend/Archdeacon James Solomon Russell

The Lawrenceville Historic District is locally significant under Criterion B in the area of Education for its association with Reverend James Solomon Russell, founder of Saint Paul’s College. Russell was born enslaved in Mecklenburg County, Virginia. He is thought to be the only child of Solomon Russell and Araminta Russell. Late in 1867, the family returned to Mecklenburg County, where Russell later worked for his tuition at a small private school. In 1873, Russell was appointed superintendent of a Sunday school for African Americans in the county.²³ He sought an education and attended Hampton Normal and Agricultural Institute (later Hampton University) in 1874. Because he was needed on the family farm, he withdrew in 1875 after his first year and sought work as a teacher in order to save money.²⁴ Russell received a teaching license in Warren County, where he taught school while continuing to work on the farm. He returned to Hampton in the fall of 1877; however, due to financial difficulties, he was unable to complete the term and left again to teach in Warren County.²⁵

Russell attended the annual conferences of the Zion Union Apostolic Church (later Reformed Zion Union Apostolic Churches of America) in 1876 and 1878, serving as recording secretary for the former. During the conferences, he encouraged and tried to steer the denomination to consider a more orderly form of worship along the lines of the Episcopal Church. With the aid of Martha “Pattie” Hicks Buford, an Episcopal educator who worked among Zion Union members in Brunswick County, he sought entrance into the Episcopal ministry. Russell sought the advice and assistance of Pattie E. Buford, a white woman in Lawrenceville involved in ministry work in the black community. Buford worked with Bishop Francis M. Whittle to arrange for Russell to attend the Theological Seminary of Virginia at St.

²⁰ Sara K. Eskridge, “Thomas B. Stanley,” *Encyclopedia Virginia: Virginia Humanities*, https://www.encyclopediavirginia.org/Stanley_Thomas_Bahnonson_1890-1970 accessed 5 April 2019), as cited in *Preliminary Information Form for Martinsville Historic District 2019 Boundary Increase*, Kayla Hallberg, Commonwealth Preservation Group, Norfolk, VA, 2020.

²¹ Sara K. Eskridge. “Thomas B. Stanley,” *Encyclopedia Virginia: Virginia Humanities*.

²² “James Solomon Russell High School: A Brief History.” <https://jsrussell.org/venue/james-s-russell-high-school/>, (accessed on 11 September 2020).

²³ Philip W. Stanley and the Dictionary of Virginia Biography. “James Solomon Russell (1857-1935).” *Encyclopedia Virginia*. Virginia Humanities, 29 Jan. 2015. Web. 24 Sept 2020. (accessed on 11 September 2020).

²⁴ Philip W. Stanley and the Dictionary of Virginia Biography. “James Solomon Russell (1857-1935); “The Reverend James Solomon Russell, 1857-1935” in “Leadership Gallery” of “The Church Awakens: African Americans and the Struggle for Justice.” The Archives of the Episcopal Church, DFMS. <https://episcopalarchives.org/church-awakens/exhibits/show/leaderships/clergy/russell> (accessed 11 September 2020).

²⁵ Stanley and the *Dictionary of Virginia Biography*, “James Solomon Russell (1857-1935).”

United States Department of the Interior
National Park Service

National Register of Historic Places
Continuation Sheet

Lawrenceville Historic District
Name of Property
Brunswick County, Virginia
County and State
Name of multiple listing (if applicable)

Section number Additional Documentation

Page 61

Stephen’s Church in Petersburg, Virginia. There, Russell became the first student to attend Saint Stephen’s Normal and Industrial School, which later became Bishop Payne Divinity School.²⁶ Russell attended from 1878 to 1882. Throughout his studies he assisted Saint Stephen’s Episcopal Church rector Giles Buckner Cooke, led Sunday school, acted as church treasurer, and served on the vestry. Russell was ordained as a deacon in the Protestant Episcopal Church on March 9, 1882. On December 20, 1882, he married Virginia Michigan Morgan, the daughter of Peter George Morgan, who had represented Petersburg in the Convention of 1867-1868 and in the House of Delegates from 1869 to 1871. They had two sons and four daughters, one of whom died in infancy.²⁷

Russell began his ministry on March 16, 1882, in Lawrenceville, when he was “assigned to a small group of eager worshipers attending St. Andrew’s Episcopal Church. He grew that group, along with more than 20 churches, into one of the largest memberships of African American Episcopalians anywhere in the United States.”²⁸ They met at Saint Andrew’s (a whites-only Episcopal church) every Sunday afternoon for Sunday school and the second and fourth Sundays each month for church services. At the May 1882 annual meeting of the Diocese of Virginia, a collection was taken to purchase a horse for Russell and funds were raised to help build a church for his new congregation, which became Saint Paul’s Episcopal Church in Lawrenceville, completed in February 1883.²⁹ In January of that year Russell began a parish school for children. He was ordained a priest on February 9, 1887.³⁰ As a priest, Russell maintained a high profile in the Episcopal Church during the period when the church was experiencing internal conflict about its treatment of African American clergymen. Two years after his ordination, he joined George Freeman Bragg and other black ministers in protesting an amendment to the diocesan constitution that limited the participation of black clergymen in the governing council.³¹

The Episcopal Diocese of Virginia established a separate convocation for African Americans and, on October 11, 1893, Russell was appointed the first Archdeacon of Colored Work in the Diocese in the early days of the Diocese of Southern Virginia. He traveled around the diocese, which until 1919 encompassed the southern part of the state from the Atlantic coast to Kentucky. In this capacity, he ministered to mission churches and supported the establishment of new churches by African Americans. He also urged the church’s governing council to provide more funds and additional African American clergymen for the increasing number of congregations. An advocate for racial equality, he was unsuccessful in his petition to the diocese in 1933 to remove references to race from its constitution and canons to allow full representation for all clergy.³²

In addition to his accomplishments as an Episcopal priest, Russell is perhaps best known as the founder of the St. Paul Normal and Industrial Institute (later Saint Paul’s College) in Lawrenceville in 1888,

²⁶ “The Reverend James Solomon Russell, 1857-1935” in “Leadership Gallery” of “The Church Awakens: African Americans and the Struggle for Justice.” The Archives of the Episcopal Church, DFMS.

²⁷ Stanley and the *Dictionary of Virginia Biography*, “James Solomon Russell (1857-1935).”

²⁸ Xavier Kendrick Russell (great-great-grandson of James Solomon Russell) in the “Introduction” to the 2021 reprint of *Adventure in Faith* by James Solomon Russell (Morehouse Publishing, 1936).

²⁹ Stanley and the *Dictionary of Virginia Biography*, “James Solomon Russell (1857-1935).”

³⁰ Stanley and the *Dictionary of Virginia Biography*, “James Solomon Russell (1857-1935).”

³¹ Stanley and the *Dictionary of Virginia Biography*, “James Solomon Russell (1857-1935).”

³² Stanley and the *Dictionary of Virginia Biography*, “James Solomon Russell (1857-1935).”

United States Department of the Interior
National Park Service

National Register of Historic Places
Continuation Sheet

Lawrenceville Historic District
Name of Property
Brunswick County, Virginia
County and State
Name of multiple listing (if applicable)

Section number Additional Documentation

Page 62

“realizing the intense desire of residents in the surrounding counties to learn to read and write,” and was its president until 1929.³³ Although Russell opened St. Paul’s with only three teachers and forty students, he was convinced that it would succeed because he believed African Americans wanted their children to have the education and opportunities that their elders had been denied. The aim of the school was to make the name of St. Paul “stand for the highest Christian education coupled with a good normal training and a useful trade of some kind.” To that end, St. Paul’s hoped “to turn out boys and girls fitted for actual service in life.” The *Richmond-Times Dispatch* newspaper noted that students had daily morning and evening prayers and regular classroom study of the Bible.³⁴

St. Paul’s offered students a three-year curriculum featuring a variety of courses, including Bible study, U.S. history, penmanship, composition, English literature, geography, physics, and algebra. The school’s curriculum received criticism from some whites who were opposed to blacks receiving any higher education and also from some African Americans, who perceived it demeaning to include industrial training, such as masonry and carpentry. Russell fended off the school’s early struggles by aggressively fund-raising, and St. Paul’s expanded in both its size and curriculum such that by 1889, he had added an agricultural department. St. Paul’s School was incorporated in 1890 and then, after years of financial instability, it became stable enough to purchase its main campus and an adjacent piece of land from Russell and his wife in 1898. By 1904, the school included about thirty buildings, many constructed by the students.³⁵

Inspired by Booker T. Washington, Russell started an annual farmers’ conference at St. Paul’s in 1904 as a catalyst for black economic development.³⁶ He urged African Americans to stay out of debt, vote, and become landowners.³⁷

Early in the twentieth century, Saint Paul’s also affiliated with the American Church Institute for Negroes, which the Episcopal Church had established in 1906 to oversee the funding and management of some of its denominational colleges. The executive director disagreed with Russell’s management of the school and attempted to force his resignation, in part because of an arrangement benefitting Saint Paul by which many of its students were contracted to work for local white farmers and businessmen. The trustees of St. Paul supported Russell and he retained control.³⁸

By 1913 the school’s curriculum stressed technical skills and enrollment had grown to be greater than 500 students. In 1917, the school employed more than forty teachers and instructors with a diverse student body consisting of students from about twenty states, as well as from the Caribbean and Africa.

³³ “James Solomon Russell” Virginia Highway Marker #UL-8, Brunswick County, Virginia; Stanley and the *Dictionary of Virginia Biography*, “James Solomon Russell (1857-1935)”;

³⁴ As cited in “Lost Colleges – St. Paul’s College (258).” <https://www.lostcolleges.com/st-paul-normal0and-industrial-school>, (accessed on 11 September 2020).

³⁵ Stanley and the *Dictionary of Virginia Biography*, “James Solomon Russell (1857-1935).”

³⁶ Stanley and the *Dictionary of Virginia Biography*, “James Solomon Russell (1857-1935)”;

³⁷ “James Solomon Russell” Virginia Highway Marker #UL-8, Brunswick County, Virginia.

³⁸ Stanley and the *Dictionary of Virginia Biography*, “James Solomon Russell (1857-1935).”

United States Department of the Interior
National Park Service

National Register of Historic Places
Continuation Sheet

Lawrenceville Historic District

Name of Property

Brunswick County, Virginia

County and State

Name of multiple listing (if applicable)

Section number Additional DocumentationPage 63

In the same year, Russell received an honorary doctorate of divinity from the Protestant Episcopal Theological Seminary in Virginia.³⁹ In 1918, Russell was the first African American to be elected by the Episcopal Church as a suffragan bishop for the Diocese of North Carolina; a bishop who is subordinate to a metropolitan bishop or diocesan bishop (bishop ordinary) and so is not normally jurisdictional in their role. Suffragan bishops may be charged by a metropolitan to oversee a suffragan diocese and may be assigned to areas which do not have a cathedral of their own. Russell declined election, preferring to continue his ministry in Lawrenceville, stating that his work as head of St. Paul's was too important. Though the issue lingered, dioceses slowly eliminated "color convocations."⁴⁰ A collegiate department in teacher training was added to the school's curriculum in 1922, receiving state accreditation in 1926.⁴¹ By 1929, St. Paul's began a junior college program and that same year, Russell received the 1928 Harmon Foundation's gold medal for his achievements in religious and educational work among African Americans.⁴²

From the founding of St. Paul's College through his later years, Russell traveled around the country and wrote letters to raise money for the institution, including from the businessmen and philanthropists John P. Morgan, Fred M. Kirby, Julius Rosenwald, and the General Education Board founded by John D. Rockefeller. He proposed to retire in 1928 because of his age, but the College Board of Visitors refused to accept his resignation until December 13, 1929. By then, St. Paul's College enrolled almost 800 students, employed more than fifty staff members, and consisted of thirty-six buildings. His son, James Alvin Russell, succeeded him as president.⁴³ Russell died in 1935 of myocarditis in Lawrenceville and was buried next to his wife in Saint Paul's Cemetery located near the school on Windsor Avenue, just beyond the town limits (later named Saint Paul's Memorial Chapel Cemetery.)⁴⁴ The *Norfolk Journal and Guide* reported on April 6, 1935, that 3,000 people, including three bishops and 40 priests, attended Russell's funeral.⁴⁵ His autobiography, *Adventure in Faith*, was published in 1936 by Morehouse College and was re-printed in 2021 by the James Solomon Russell-St. Paul's College Museum and Archives, Inc. in Lawrenceville.

In October 1996, James Solomon Russell was designated a local saint by the Diocese of Southern Virginia in recognition of his service to the community.⁴⁶ In 2009 the Diocese of Southern Virginia

³⁹ Stanley and the *Dictionary of Virginia Biography*, "James Solomon Russell (1857-1935)."

⁴⁰ Worth E. "Woody" Norman, Jr. "Archdeacon, Educator, PROPOSED SAINT." *The Living Church*, April 10, 2011: 16. The Living Church Foundation, Inc., a 501(c)3 non-profit charitable organization, is a corporation governed by members of the Episcopal Church and Anglican Communion seeking to champion the catholic and evangelical faith of the one Church and to hasten the visible unity of all Christians. TLC publishes *The Living Church* magazine, in continuous publication since 1878.

⁴¹ *Story of the St. Paul Normal and Industrial School (Catechetically Arranged)*, Lawrenceville, VA, 1919.

<http://hdl.handle.net/2027/nnc2.ark:/13960/t3cz75g91>; http://www.hathitrust.org/access_use#pd as cited in "Lost Colleges – St. Paul's College (258)." <https://www.lostcolleges.com/st-paul-normal0and-industrial-school>, (accessed on 11 September 2020).

⁴² *Story of the St. Paul Normal and Industrial School (Catechetically Arranged)*, Lawrenceville, VA, 1919.

<http://hdl.handle.net/2027/nnc2.ark:/13960/t3cz75g91>; http://www.hathitrust.org/access_use#pd as cited in *Lost Colleges – St. Paul's College (258)*." <https://www.lostcolleges.com/st-paul-normal0and-industrial-schoolm>, (accessed on 11 September 2020).

⁴³ Stanley and the *Dictionary of Virginia Biography*, "James Solomon Russell (1857-1935)."

⁴⁴ Stanley and the *Dictionary of Virginia Biography*, "James Solomon Russell (1857-1935)."

⁴⁵ Worth E. "Woody" Norman, Jr. "Archdeacon, Educator, PROPOSED SAINT." *The Living Church*, April 10, 2011: 16.

⁴⁶ Stanley and the *Dictionary of Virginia Biography*, "James Solomon Russell (1857-1935)."; "Leadership Gallery: The Reverend James Solomon Russell, 1857-1935" in *The Church Awakens: African Americans and the Struggle for Justice*. <http://episcopalarchives.org/church-awakens/exhibits/show/leadership/clergy/Russell>, (accessed on 20 September 2020).

United States Department of the Interior
National Park Service

National Register of Historic Places
Continuation Sheet

Lawrenceville Historic District
Name of Property
Brunswick County, Virginia
County and State
Name of multiple listing (if applicable)

Section number Additional Documentation

Page 64

asked its General Convention to consider adding James Solomon Russell to *Lesser Feasts and Fasts*. The General Convention was to revisit that request in 2012. In an essay “Archdeacon, Educator, PROPOSED SAINT” by Worth E. “Woody” Norman, Jr. in *The Living Church*, April 10, 2011, Norman includes the diocese’s suggested propers and collection in honor of Russell, making the case for his inclusion in what is now *Holy Women, Holy Men: Celebrating the Saints*.⁴⁷ During the 2020 General Assembly Session, the Virginia Senate passed Senate Resolution (SR) 7 designating March 28, 2020, and each succeeding year thereafter as “James Solomon Russell Day” in Virginia.⁴⁸

Even before the Rev. Dr. Martin Luther King Jr. began his long fight for equality of the races in America, there were people in Southside Virginia working to bring free and equal educational opportunities to all, regardless of their race, sex, or creed. Their journey to an open and just American education system spanned over a hundred years. These sites make up the Civil Rights in Education Heritage Trail, established in 2004 by the Old Dominion Resource Conservation & Development Council with funding from the Virginia Department of Transportation, and are a remembrance of their sacrifices and struggles.⁴⁹ The trail was developed when Virginia and the United States commemorated the 50th anniversary of *Brown vs. Board of Education*, the landmark 1954 Supreme Court case that ended forced segregation in public education. The self-guided driving trail winds its way through Appomattox, Buckingham, and Cumberland counties in the north to Brunswick, Halifax, and Mecklenburg counties in the south and includes 41 stops. Collectively, they highlight the story of the fight for educational opportunities by men and women and boys and girls of color. The St. Paul’s College campus in Lawrenceville is a stop on this trail. Today, the trail is managed by Virginia Crossroads, a tourism marketing consortium comprised of the 13 member counties, including Brunswick County, and the City of Petersburg.⁵⁰

The James Solomon Russell Museum and College Archives was dedicated at the Brunswick Conference Center (the former St. Paul’s College Student Union building [251-5001-0457], which is on the college campus but not within the Lawrenceville Historic District) on August 10, 2019. The collection was moved from downtown at 219 N. Main Street (251-5001-0117) within the district because it had outgrown the space. The museum started when former college administrators and alumni gathered artifacts/memorabilia from the campus buildings before the college closed.⁵¹

St. Paul’s College in Lawrenceville, which was listed on the Virginia Landmarks Register on March 20, 1979, and on the National Register of Historic Places on June 27, 1979 (251-0003), was founded as Saint Paul Normal and Industrial School in 1888 by the Reverend James Solomon Russell. It then became Saint Paul’s Polytechnic Institute in 1941. The name was changed in 1957 to Saint Paul’s College to reflect its liberal arts curriculum. This HBCU college closed on June 30, 2013.

⁴⁷ Worth E. “Woody” Norman, Jr. “Archdeacon, Educator, PROPOSED SAINT.” *The Living Church*, April 10, 2011: 16.

⁴⁸ Senate of Virginia, 2020. Legislative Information System. <https://lis.virginia.gov/cgi-bin/legp604.exe?201+sum+SR7>

⁴⁹ Bracey site gains place on regional tourist trail. SoVaNow.com

⁵⁰ Bracey site gains place on regional tourist trail. SoVaNow.com

⁵¹ “Grand Opening: James Solomon Russell – St. Paul’s College Museum and Archives.” *American Evolution*.

<https://www.americanevolution2019.com/partnerevent/grand-opening-james-solomon-russell-saint-pauls-college-museum-and-archives/> (accessed on 11 September 2020).

United States Department of the Interior
National Park Service

National Register of Historic Places
Continuation Sheet

Lawrenceville Historic District
Name of Property
Brunswick County, Virginia
County and State
Name of multiple listing (if applicable)

Section number Additional Documentation

Page 65

Criterion A: Ethnic Heritage: African-American and Social History: Civil Rights

The Lawrenceville Historic District is locally significant under Criterion A in the areas of Ethnic Heritage: African-American and Social History: Civil Rights for its association with leaders and activities related to the mid-twentieth century Civil Rights Movement. Students from Saint Paul’s College were instrumental in advancing civil rights locally and in partnership with larger statewide organizations. In 1960 and “inspired by the Greensboro and Rock Hill sit-ins in 1960, seven students at St. Paul’s proposed the idea of campaigning to change the segregated policies of the town to a council of faculty and students. While the administration supported the goals of the students, they opposed the idea of sit-ins and picketing, believing it to be dangerous.”⁵² The student group decided to refrain from open confrontation and instead to boycott the local white-owned movie theatre because of its segregated seating policy. In addition to boycotting the movie theatre, the group of students set up a Fund for Equal Rights and collected \$250.00 to support activities elsewhere. The administration of the college established an alternative movie theatre on campus that offered viewings of the same movies at lower prices. The movie theatre lost customers as a result of the boycott and in the spring of 1960, the theatre was on the edge of closure. Over time, however, the student’s enthusiasm for the boycott fell off and by fall 1960 they were returning to the movie theatre in town.⁵³

Following Freedom Summer in Mississippi in 1964, two groups were working in the fall of 1964 to energize Virginia students—the Student Non-Violent Coordinating Committee (SNCC) of the Southern Christian Leadership Conference, and the Virginia College Council on Human Relations (VCCHR). The Virginia Student Civil Rights Committee (VSCRC) was an interracial group of Virginia college students formed to focus on the needs of Virginia, where its members lived and attended school, rather than travel to the Deep South.⁵⁴ The students of VSCRC “planned to ‘attack the roots of the social evils of poverty, deprivation and segregation.’”⁵⁵ From 1965 to 1966, the VSCRC was headquartered in Brunswick County, and spent at least one summer headquartered in Lawrenceville on the campus of St. Paul’s College.

According to one of the leaders of VSCRC, David Joseph Nolan, Brunswick County in the mid-1960s had a 60 percent black majority, while only 9 percent of its registered voters were African American. In partnership with the local chapter of the NAACP and students from Saint Paul’s College, the VSCRC helped register voters and organize civil rights activism in Brunswick County. In March 1966 alone, a week-long effort resulted in over five hundred Lawrenceville and Brunswick County African American citizens marching to the county courthouse to register to vote. Over three hundred were registered,

⁵² Nicole Vanchieri. “St. Paul’s College student boycott segregated Virginia movie theater, Lawrenceville, VA 1960.” Global Nonviolent Action Database, Swarthmore College, U.S. Civil Rights Movement (1950s-1960s). www.nvdatabase.swarthmore.edu/content/st-pauls-college-students-boycott-segregated-virginia-movie-theater-lawrenceville-va-1960 (accessed 24 September 2020).

⁵³ Nicole Vanchieri. “St. Paul’s College students boycott segregated Virginia movie theatre, Lawrenceville, VA, 1960.”

⁵⁴ Bruce Smith, Dottie Edwards, and Lucious “Duke” Edwards, members of the VSCRC 50th Reunion Organizing Committee. “Origin of student civil rights group clarified” *Richmond Free Press*. Richmond, VA: July 3, 2015. www.richmondfreepress.com/news/2015/jul/03/origin-student-civil-rights-group-clarified/ (accessed 25 August 2020).

⁵⁵ Dale M. Brumfield. “Student civil rights workers recall efforts” in *Richmond Free Press*. Richmond, VA: June 27, 2015. www.richmondfreepress.com/news/2015/jun/27/student-civil-rights-workers-recall-efforts/ (accessed 25 August 2020).

United States Department of the Interior
National Park Service

National Register of Historic Places
Continuation Sheet

Lawrenceville Historic District
Name of Property
Brunswick County, Virginia
County and State
Name of multiple listing (if applicable)

Section number Additional Documentation

Page 66

despite efforts in the Voter Registrar’s office to turn them away due to an alleged shortage of poll tax receipt books available at the time. A Petersburg newspaper reported that “more than 300 new Negro voters are on the Brunswick County poll books today as a result of a week-long drive by student groups in the area. The 24 students, on spring vacation from six colleges, including Smith College, DePauw, Bucknell, and Boston Universities, were aided by about 100 others from St. Paul’s College and Russell High School here...Some 1,100 Negroes in [Brunswick] County pledged to register...and the rest would be ready to register at the county’s next registration date, April 9.”⁵⁶

The efforts of the VSCRC attracted the attention of national civil rights organizations and leaders, including the SNCC and Stokely Carmichael, who came to train them on organizing. Anne Braden, a noted civil rights activist and editor of *The Southern Patriot*, visited Lawrenceville and stayed with David Nolan and the VSCRC on the campus of Saint Paul’s College in the summer of 1965. Braden’s stop in Lawrenceville was part of a larger tour of Virginia’s Southside, during which she documented the VSCRC’s organizing efforts. While other cities in Virginia’s Southside are often cited for unrest and activism during the Civil Rights Movement, the visit by Braden and other national civil rights leaders during the mid-1960s demonstrates the significance of Lawrenceville and St. Paul’s College to the area’s efforts to organize.⁵⁷

Green Book Sites in Lawrenceville

The Negro Motorist Green Book, The Negro Traveler’s Green Book or *The Traveler’s Green Book* travel guide (commonly known as the *Green Book*; published 1936-1967) during the segregation era in the United States, identified businesses that would accept African American customers. Compiled by Victor Hugo Green (1892-1960), a Black postman who lived in the Harlem section of New York City, the *Green Book* listed a variety of businesses—from restaurants and hotels to beauty salons and drugstores—that were necessary to make travel comfortable and safe for African Americans in the period before passage of the Civil Rights Act of 1964.⁵⁸ The first entry for a Lawrenceville-based business-- and the only Lawrenceville business-- appeared in the 1963-1964 International Edition of the *Green Book*. Listed then was “The Corner Inn, Beverly Taylor, Mgr.” at 409 N. Main Street (251-5001-0129), subsequently addressed as 409-413 N. Main Street.⁵⁹ This same entry appears in the 1966-1967 International Edition.⁶⁰ The inclusion of this entry in the publication is also indicative of the status of Lawrenceville as a stop for travelers and likely due to the inn’s location in proximity to St. Paul’s College for visitors needing accommodations.

⁵⁶ “Brunswick Drive Adds 300 Voters” *The Progress-Index* (Petersburg, Virginia), 28 Mar 1966, 9. Newspapers.com by ancestry, downloaded on 9 January 2020; *The Pittsburgh Courier*. Pittsburgh, PA. April 9, 1966; ⁵⁶ Brian Daughterity and Ryan Smith. “Oral History Interview: David Joseph Nolan for the VSCRC 50th Reunion Oral History Project in Blackstone, VA.” Virginia Commonwealth University (VCU), June 20, 2015.

⁵⁷ Brian Daughterity and Ryan Smith. “Oral History Interview: David Joseph Nolan for the VSCRC 50th Reunion Oral History Project in Blackstone, VA.” Virginia Commonwealth University (VCU), June 20, 2015; “How It’s Done” Ed. by Anne Braden. *The Southern Patriot*. Vol. 23, No. 9, November 1965.

⁵⁸ Schomburg Center for Research in Black Culture, The New York Public Library Digital Library (b15424178), (accessed on 24 September 2020).

⁵⁹ Referred to historically in VCRIS as “Pinecrest,” Victor Hugo Green, *The Traveler’s Green Book*. International Edition, 1963-1964: 73.

⁶⁰ Green. *The Traveler’s Green Book*. International Edition, 1966-1967: 73.

United States Department of the Interior
National Park Service

National Register of Historic Places
Continuation Sheet

Lawrenceville Historic District
Name of Property
Brunswick County, Virginia
County and State
Name of multiple listing (if applicable)

Section number Additional Documentation

Page 67

Criterion A: Social History

The Lawrenceville Historic District is locally significant under Criterion A in the area of Social History related to fraternal groups and societies. The historic district is also significant under Criterion B in the area of Social History for its association with Nellie Pratt Russell, a founder of the Alpha Kappa Alpha Fraternity. In the United States, fraternal organizations gained significant popularity during the nineteenth through the mid-twentieth century. As described by historians Theda Skocpol and Jennifer Lynn Oser, “fraternal associations are self-selecting brotherhoods and sisterhoods that provide mutual aid to members, enact group rituals, and engage in community service.”⁶¹

Brunswick Lodge 52

Among the oldest and most well-known of the fraternal orders in the United States is the Order of the Freemasons. The first Masonic Lodge in the United States was founded in Boston in 1733. Freemasonry promoted republican ideals like those that influenced the American Constitution and Bill of Rights such as freedom, free enterprise, limited state powers, and self-government.⁶² Masonic lodges of the period also, however, were racially segregated with membership limited to white men.

The Brunswick Lodge 52 Meeting Hall (now a law office) located at 102 N. Main Street (251-5001-0103) was constructed in 1950, although the history of the Lodge in Lawrenceville is much older. According to the historical records of the Grand Lodge of Virginia, the Brunswick Lodge is one of the oldest in Virginia and was established by charter in 1797.⁶³ Other historical records indicate that the lodge may have been established as early as 1768, prior to the nation’s founding.⁶⁴ By 1933, the Brunswick Lodge had a meeting location in the Town of Lawrenceville, and recorded at least 130 members.⁶⁵ It is not surprising that the lodge building constructed at 102 N. Main Street was built on that street, where just south along S. Main Street and Turnbull Street were the homes of many of Lawrenceville’s most prominent white citizens. Several Brunswick Lodge 52 members served as Grand Masters of the Virginia Freemasons. Powhatan B. Stark, a physician, was elected Grand Master of the Virginia Freemasons in 1859. Others elected Grand Master include Needham Stuart Turnbull, Jr. (1939), a lawyer born in Lawrenceville in 1866; Enoch Dorrton Flowers (1950), a Chief Dispatcher for the Southern Railroad, who died in 1952 and is buried in Oakwood Cemetery in Lawrenceville; and,

⁶¹Theda Skocpol and Jennifer Lynn Oser, “Organization despite Adversity: The Origins and Development of African American Fraternal Associations,” *Social Science History: Special Issue: African American Fraternal Associations and the History of Civil Society in the United States*, Vol. 28, No. 3, Fall 2004, 367, as cited in *Town of Warrenton Historic District, National Register Nomination Update*, Kayla Halberg, Commonwealth Preservation Group, Norfolk, VA, 2019.

⁶² Peter Feuerherd, “The Strange History of Masons in America,” *JSTOR Daily*, 3 Aug 2017, <https://daily.jstor.org/the-strange-history-of-masons-in-america/> (accessed on 12 August 2019).

⁶³ “Virginia Masonic Lodges – 1933.” https://www.newrivernotes.com/topical_organizations_1933_mason_lodges.htm (accessed on March 1, 2021).

⁶⁴ John Dove, *The Virginia Text Book: A History of Masonic Grand Lodges and the Constitution of Masonry*, Richmond, VA: James G Goode, 1866, 125.

⁶⁵ “Virginia Masonic Lodges – 1933.”

United States Department of the Interior
National Park Service

National Register of Historic Places
Continuation Sheet

Lawrenceville Historic District
Name of Property
Brunswick County, Virginia
County and State
Name of multiple listing (if applicable)

Section number Additional Documentation

Page 68

Edmund Carroll Glover (1961), a pharmacist.⁶⁶

The Lawrenceville Freemasons are credited with saving the County records located in the courthouse during the Civil War.⁶⁷ According to oral tradition, Civil War-era journals, and letters of the Turnbull family, Edward Randolph Turnbull, the Brunswick County Clerk and member of the Brunswick Lodge 52, received word that Union troops were headed to the courthouse on May 15, 1865. Turnbull placed the county's record books on a table and draped his Masonic apron over them before he evacuated the courthouse. Records indicate that Turnbull hoped that "the incoming one would be a Mason," and therefore, spare the records from being destroyed as had occurred at other courthouses in Confederate-controlled territory.⁶⁸ Shortly after the Union troops departed the courthouse, a guard rode to Turnbull's house and handed him the apron, according to a letter written by Turnbull's son years later. When Turnbull got back to the courthouse, he discovered ink-stained papers scattered all about, but the county's records remained intact.⁶⁹

Fraternal organizations were historically segregated organizations. Many of the most prominent organizations did not grant membership to African Americans. Therefore, African Americans formed separate chapters or new separate organizations. Additional research into Lawrenceville's African American fraternal organizations is recommended for future study. Due to research limitations during the 2020-2021 pandemic, information on the town's African American orders or lodges were not uncovered.

Criterion B: Social History - Nellie Pratt Russell

In addition to the significant activities related to the Civil Rights Movement of the mid-twentieth century, Lawrenceville was also home to Nellie Pratt Russell (1890-1979), a founding member of Alpha Kappa Alpha sorority, the first black Greek-letter organization founded by African American women. Russell was known for her work assisting African Americans following the Civil War and during Reconstruction and served as a teacher at St. Paul Normal and Industrial School (later St. Paul's College). DHR Historical Highway Marker (S-92), erected in 2016 at its original location at the intersection of Christanna Highway and Boydton Plank Road and subsequently relocated to Church Street in Lawrenceville in front of St. Paul's College Campus, reads: "Nellie Pratt Russell, educator, attended Howard University and was one of six incorporators of Alpha Kappa Alpha Sorority, the first Greek letter organization founded by African American women."⁷⁰ The sorority was established in 1908 and was incorporated on January 29, 1913. It was the first black Greek-letter organization to attempt and complete incorporation in order to preserve its traditions and securing its right to charter new chapters.

⁶⁶ Right Worshipful Robert E. Simpson. Virginia's Grand Masters 1778-2012. Compiled for the Grand Lodge Library, Museum and Historical Foundation.

⁶⁷ Bobby Conner, Lawrenceville, VA, March 2021.

⁶⁸ Bill Lohman. "Civil War civility spares history in Brunswick" https://richmond.com/entertainment/civil-war-civility-spares-history-in-brunswick/article_5d67b101-5886-5dfa-b5a6-f52b53b900d0.html, (accessed 1 March 2021).

⁶⁹ Lohman, "Civil War civility spares history in Brunswick"; Historical Marker (kiosk) located at Brunswick County Courthouse, N. Main Street, Lawrenceville.

⁷⁰ Virginia Highway Marker S-92 "Nellie Pratt Russell" Virginia Department of Historic Resources, 2016. <https://vcris.dhr.virginia.gov/HistoricMarkers/>, (accessed 2 March 2021).

**United States Department of the Interior
National Park Service**

**National Register of Historic Places
Continuation Sheet**

Lawrenceville Historic District
Name of Property
Brunswick County, Virginia
County and State
Name of multiple listing (if applicable)

Section number Additional Documentation

Page 69

This positioned the sorority to broaden its service concept offerings while ensuring the preservation of its founding principles and brands.⁷¹ In 1913, Pratt married Dr. J. Alvin Russell, the elder son of the St. Paul’s College founder, Reverend James Solomon Russell.⁷² “In 1931, Nellie Pratt Russell earned a Master of Arts degree from Teachers College, Columbia University. To be closer to her mother, she took a teaching job at Saint Paul’s Normal and Industrial School, later known as Saint Paul’s College, where she taught English for over 50 years...[and] where she helped found the Gamma Lambda Omega chapter of Alpha Kappa Alpha. Russell also led women’s organizations in the Episcopal Diocese of Southern Virginia.”⁷³ She lived in Lawrenceville for the remainder of her life, where she died on December 13, 1979.⁷⁴ She is buried in the Russell family plot in the St. Paul’s Memorial Chapel Cemetery just outside of Lawrenceville. In 2019, a new Women’s Monument was dedicated on the grounds of the Capitol Building in Richmond. Two-hundred thirty notable woman from across Virginia are honored on the monument, including Pratt.⁷⁵



Figure 1: Members of Alpha Kappa Alpha Sorority, Inc., Gamma Lambda Omega Chapter gather in Lawrenceville on August 12, 2017, to celebrate unveiling of Virginia Highway Marker S-92 honoring Nellie Pratt Russell (1890-1979). The marker was sponsored by members of the chapter. Photo Source: Bobby Conner, Brunswick Times-Gazette, August 17, 2017.

⁷¹ Bobby Conner. “New Women’s Monument Dedicated at VA State Capitol with 2 Brunswick County Women.” Emporia Independent Messenger. Emporia, VA: November 16, 2019.

⁷² Conner, “New Women’s Monument Dedicated at VA State Capitol with 2 Brunswick County Women.”

⁷³ Virginia Highway Marker S-92 “Nellie Pratt Russell.”

⁷⁴ Conner, “New Women’s Monument Dedicated at VA State Capitol with 2 Brunswick County Women.”

⁷⁵ Conner. “New Women’s Monument Dedicated at VA State Capitol with 2 Brunswick County Women.”

United States Department of the Interior
National Park Service

National Register of Historic Places
Continuation Sheet

Lawrenceville Historic District
Name of Property
Brunswick County, Virginia
County and State
Name of multiple listing (if applicable)

Section number Additional Documentation

Page 70

Criterion A: Politics/Government

The Lawrenceville Historic District originally was listed under Criterion A in the area of Politics/Government in part for the town’s association with Albertis Sydney Harrison, Jr. (1907-1995). Harrison was a native of Lawrenceville who practiced law in the town and also served as Town Attorney. Harrison is significant for his contributions as Governor of Virginia, and for his association with the Commonwealth’s “Massive Resistance” period. Harrison was one of few Virginians to serve in all three branches of state government as State Senator (1947-1958), Attorney General (1958-1962), Governor (1962-1966), and Justice of the Supreme Court of Virginia (1967-1981). Recent research has yielded additional information about Harrison’s legal and political career.

Harrison was born in Alberta in Brunswick County in 1907. A graduate of the University of Virginia Law School in 1928, he began his law career in private practice in Brunswick County (c. 1928-1932), then served concurrently as Commonwealth’s Attorney for Brunswick County and General Counsel to the Farmers & Merchants Bank (1932-1948) and as Town Attorney for Lawrenceville.⁷⁶ While serving as Town Attorney, Harrison sought and received a change in the Town Charter from the Virginia General Assembly enabling the Town to establish and maintain a department or division of police. Harrison, who had been elected as State Senator, continued his duties as Town Attorney. He discontinued his role and connection to the Lawrenceville Police Department as Town Attorney in March of 1958, when he was elected as Virginia’s Attorney General.⁷⁷ In 1962, while serving as Attorney General, Harrison was elected to serve as Virginia’s Governor with 63 percent of the vote. During his tenure, numerous improvements were made to the State’s financial and banking laws, education system, public infrastructure, industrial development, and tourism. Harrison, however, also lent his expertise to “Massive Resistance,” the years long effort by state leaders to enact legislation that would block racial integration of public schools and survive Supreme Court scrutiny.⁷⁸

By virtue of his office, Harrison was involved in confrontations with the federal government as Attorney General from 1958 to 1962 and then as Governor until 1966. These included Virginia’s legal battles to continue a poll tax and close public schools in Prince Edward County, which left black pupils without a formal education for four years. The county supervisors ordered the public schools padlocked to avoid integrating them. White pupils then attended a private academy with their tuitions subsidized by the state. Most of the 1,700 black children had no schools to go to while the issue was decided in Federal court, but for a one-year effort to create “freedom schools” for these students. In 1963, the county’s schools were ordered to open, and when the Supreme Court agreed in 1964, the board of supervisors gave in rather than risk prison. Virginia’s General Assembly continued to use alternative methods to derail federal desegregation orders until 1968, when the Supreme Court decision of *Green vs. County School Board of New Kent County* dealt the final blow to Massive Resistance, and required school

⁷⁶ Virginia Appellate Court History. <https://scvahistory.org/courtofappeals/h/albertis-sydney-harrison-jr/> (accessed on 5 February 2021).

⁷⁷ <https://lawrencevillepolice.com/our-history>

⁷⁸ University of Virginia School of Law; Obituary. “Albertis S. Harrison, Jr.” [The New York Times](#).

United States Department of the Interior
National Park Service

National Register of Historic Places
Continuation Sheet

Lawrenceville Historic District
Name of Property
Brunswick County, Virginia
County and State
Name of multiple listing (if applicable)

Section number Additional Documentation

Page 71

placement based on geographic zoning.⁷⁹

After he left the Governor’s office, Harrison was appointed to the Virginia Appellate Court by Governor Mills E. Godwin, Jr., on September 2, 1967, to fill the vacancy created by the retirement of Vernon C. Spratley and began his service on October 23, 1967. He was subsequently elected by the General Assembly on January 24, 1968, to complete the unexpired term of Spratley, and was elected on March 11, 1970, to a regular 12-year term beginning February 1, 1971, retiring in 1981.⁸⁰ While serving as a Justice, Harrison chaired the Commission on Constitutional Revision in 1968 that drafted the current Constitution of Virginia. One clause the panel purged from the preceding version was a requirement that “white and colored children shall not be taught in the same school.” Harrison continued to serve the Supreme Court of Virginia as a Retired Justice until his death. He died at his home in Lawrenceville at 504 Church Street (251-5001-0323) on January 23, 1995, at the age of 88 and is buried in Lawrenceville’s Oakwood Cemetery located on W. Fifth Avenue.⁸¹ In 1999, the newly built Brunswick County Courthouse in Lawrenceville was named in his honor.

⁷⁹Sara K. Eskridge. “Thomas B. Stanley,” *Encyclopedia Virginia: Virginia Humanities*.

⁸⁰ Virginia Appellate Court History.

⁸¹ Obituary. “Albertis S. Harrison, Jr.” The Baltimore Sun, January 25, 1995.

United States Department of the Interior
Here
National Park Service

National Register of Historic Places
Continuation Sheet

Lawrenceville Historic District
Name of Property
Brunswick County, Virginia
County and State
Name of multiple listing (if applicable)

Section number Additional Documentation

Page 72

9. Major Bibliographical References

NOTE: Research for this National Register Nomination update was conducted during the COVID-19 pandemic in 2020. Research repository closures and travel restrictions severely limited access to primary source material and some secondary scholarly works.

Newspapers & Periodicals

Baltimore Sun

Brunswick Times-Gazette

Capital News Service

Emporia Independent Messenger

Forbes

New York Times

The Pittsburgh Courier.

The Progress-Index

Richmond Free Press

Richmond Times-Dispatch

The Southern Patriot

Other Sources

“Albertis Sydney Harrison, Jr., October 23, 1967- December 31, 1981,” Virginia Appellate Court History. <https://scvahistory.org/courtofappeals/h/albertis-sydney-harrison-jr/>

Archives of the Episcopal Church. “The Reverend James Solomon Russell, 1857-1935” in *The Church Awakens: African Americans and the Struggle for Justice – Leadership Gallery*. Electronic publication and online exhibit <https://episcopalarchives.org/church-awakens/exhibits/show/leadership/clergy/russell>

Dove, John. *The Virginia Text Book: A History of Masonic Grand Lodges and the Constitution of Masonry*. Richmond, VA: James G Goode, 1866.

United States Department of the Interior
Here
National Park Service

National Register of Historic Places
Continuation Sheet

Lawrenceville Historic District
Name of Property
Brunswick County, Virginia
County and State
Name of multiple listing (if applicable)

Section number Additional Documentation Page 73

Feuerher, Peter. "The Strange History of Masons in America." *JSTOR Daily*. August 3, 2017.
<https://daily.jstor.org/the-strange-history-of-masons-in-america/>

Global Nonviolent Action Database. "St. Paul's College students boycott segregated Virginia movie theatre, Lawrenceville, VA, 1960." <https://nvdatabase.swarthmore.edu/content/st-pauls-college-students-boycott-segregated-virginia-movie-theater-lawrenceville-va-1960>

"Grand Opening: James Solomon Russell – St. Paul's College Museum and Archives." *American Evolution*. <https://www.americanevolution2019.com/partnerevent/grand-opening-james-solomon-russell-saint-pauls-college-museum-and-archives/>

Green, Victor Hugo. *The Traveler's Green Book*. International Edition, 1963-1964; International Edition, 1966-1967.

Hall, Simon. "Civil Rights Activism in 1960s Virginia." *Journal of Black Studies*. Vol 38. No. 2. November 2007.

Hodges, Samuel J., III. "William Alfred Streat Jr. (1920-1994)" in Dreck Spurlock Wilson, ed. *African American Architects, a Biographical Dictionary, 1865-1945*. New York: Routledge, 2004.

Laffoon, Bill and Nat Neblett. "Lawrenceville Historic District, Brunswick County, Virginia." National Register of Historic Places Inventory/Nomination Form. April 13, 2000.

Lawrenceville Police Department. "History." <https://lawrencevillepolice.com/our-history>

Michel, Gregg L. *Struggle for a Better South: The Southern Student Organizing Committee, 1964-1969*. Palgrave Macmillan, 2004th Edition. January 15, 2008.

New River Notes. "Virginia Masonic Lodges – 1933." https://www.newrivernotes.com/topical_organizations_1933_mason_lodges.htm

Nolan, David Joseph. "Oral History Interview with David Joseph Nolan for the VSCRC 50th Reunion Oral History Project in Blackstone, VA." Interviewed by Brian Daugherty and Ryan Smith on June 20, 2015. Richmond, VA: Virginia Commonwealth University, 2015. https://archives.library.vcu.edu/repositories/5/archival_objects/57967

United States Department of the Interior
Here
National Park Service

National Register of Historic Places
Continuation Sheet

Lawrenceville Historic District
Name of Property
Brunswick County, Virginia
County and State
Name of multiple listing (if applicable)

Section number Additional Documentation

Page 74

Remembrance for Anne Braden on Veterans of the Civil Rights Movement,
March 7, 2006. <https://www.crmvet.org/mem/bradena.htm#bradendavid>.

Novelli, Chris, Melina Bezirdjian, Calder Loth, and Lena Sweeten McDonald. *Classic Commonwealth: Virginia Architecture from the Colonial Era to 1940*. Richmond, VA: Virginia Department of Historic Resources, 2015.
https://www.dhr.virginia.gov/pdf_files/Classic_Commonwealth_Style_Guide.pdf

Russell, James S. *Adventure in Faith: An Autobiographic Story of St. Paul Normal and Industrial School, Lawrenceville, Virginia*. New York: Morehouse Publishing: 1936.

Saint Paul's Normal and Industrial School, *Story of the St. Paul Normal and Industrial School (Catechetically Arranged), Lawrenceville, VA, 1919*. Lawrenceville, VA: Saint Paul's Normal and Industrial School, 1919. <https://catalog.hathitrust.org/Record/101789670>

Simpson, Robert E. *Virginia's Grand Masters 1778-2012*. Compiled for the Grand Lodge Library, Museum and Historical Foundation.

Skocpol, Theda and Jennifer Lynn Oser. "Organization Despite Adversity: The Origins and Development of African American Fraternal Associations." *Social Science History: Special Issue: African American Fraternal Associations and the History of Civil Society in the United States*, Vol. 28, No. 3, Fall 2004.

Stanley, Phillip W. and the Dictionary of Virginia Biography. "James Solomon Russell (1857-1935)." *Encyclopedia Virginia*. Virginia Humanities, January 29, 2015.

Nicole Vanchieri. "St. Paul's College student boycott segregated Virginia movie theater, Lawrenceville, VA 1960." Global Nonviolent Action Database, Swarthmore College, U.S. Civil Rights Movement (1950s-1960s).
www.nvdatabase.swarthmore.edu/content/st-pauls-college-students-boycott-segregated-virginia-movie-theater-lawrenceville-va-1960. Accessed 24 September 2020.

Virginia Civil War Trails. "Brunswick County Courthouse: Surviving Kautz's Raid." Marker at Brunswick County Courthouse, N. Main Street, Lawrenceville, VA.

Virginia Department of Historic Resources. "James Solomon Russell" Virginia Highway Marker #UL-8, Brunswick County, Virginia. 2013.

United States Department of the Interior
Here
National Park Service

Lawrenceville Historic District
Name of Property
Brunswick County, Virginia
County and State
Name of multiple listing (if applicable)

National Register of Historic Places
Continuation Sheet

Section number Additional Documentation Page 75

“Nellie Pratt Russell.” Virginia Highway Marker S-92. 2016.

“St. Paul’s College.” Virginia Highway Marker SN-93. 1994.
Virginia General Assembly. Senate Resolution No. 7 “Designating March 28, in 2020 and in each succeeding year, as James Solomon Russell Day in Virginia.” Virginia Legislative Information Service, 2020 General Assembly Session, February 11, 2020.
<https://lis.virginia.gov/cgi-bin/legp604.exe?201+ful+SR7ER>

“Virginia Places: The Atlantic & Danville Railroad.”
<http://www.virginiaplaces.org/rail/atlantictdanville.html>

Wilson, Dreck Spurlock, ed. *African American Architects, a Biographical Dictionary, 1865-1945*. New York: Routledge, 2004.

Willis, Kent. “Black History Month IV: George Smith and the Virginia Voting Rights Miracle.” American Civil Liberties Union – Virginia.
<https://www.acluva.org/en/news/black-history-month-iv-george-smith-and-virginia-voting-rights-miracle>

Primary location of additional data:

State Historic Preservation Office
 Other

Name of repository: Virginia Department of Historic Resources, Richmond, Virginia; Brunswick County Historical Society Museum and James Solomon Russell-St. Paul’s College Museum and Archives, Inc., Lawrenceville, Virginia

Historic Resources Survey Number (if assigned): DHR ID 251-5001

10. Geographical Data

The historic district boundary *has not changed* as a result of this additional documentation. Geographical data has been updated to include latitude/longitude coordinates as listed below and as shown on the attached Location Map.

- | | |
|---------------------|-------------------|
| 1. Lat: 36.764908 N | Lon: -77.702777 W |
| 2. Lat: 36.765030 N | Lon: -77.841944 W |

United States Department of the Interior
Here
National Park Service

National Register of Historic Places
Continuation Sheet

Lawrenceville Historic District
Name of Property
Brunswick County, Virginia
County and State
Name of multiple listing (if applicable)

Section number Additional Documentation

Page 76

3. Lat: 36.751241 N Lon: -77.841944 W
4. Lat: 36.751258 N Lon: -77.858611 W

11. Update Prepared By

name/title: Jess Archer and Jeryl Rose Phillips, AICP; Assisted by: Erica Howard, Ethan Halberg, Ashlen Stump, Katie Paulson, Victoria Leonard
organization: Commonwealth Preservation Group
street & number: 536 West 35th Street
city or town: Norfolk state: VA zip code: 23508
e-mail: admin@commonwealthpreservationgroup.com
telephone: 757-923-1900
date: 7-1-2021

Photographs

Submit clear and descriptive photographs. The size of each image must be 1600x1200 pixels (minimum), 3000x2000 preferred, at 300 ppi (pixels per inch) or larger. Key all photographs to the sketch map. Each photograph must be numbered and that number must correspond to the photograph number on the photo log. For simplicity, the name of the photographer, photo date, etc. may be listed once on the photograph log and doesn't need to be labeled on every photograph.

Photo Log

Name of Property: Lawrenceville Historic District

City or Vicinity: Lawrenceville

County: Brunswick

State: Virginia

Photographer: Jess Archer (JA), Ethan Halberg (EH), Jeryl Rose Phillips, AICP (JP)

Date Photographed: December 2020; January 2021

United States Department of the Interior
Here
National Park Service

Lawrenceville Historic District
Name of Property
Brunswick County, Virginia
County and State
Name of multiple listing (if applicable)

National Register of Historic Places
Continuation Sheet

Section number Additional Documentation Page 77

Description of Photograph(s) and number, include description of view indicating direction of camera:

Photo Number of 16	Description	Camera Direction	Date	Photographer
1	West Hicks Street at North Main Street	W	12/2020	JP
2	Resources along North Main Street	SW	12/2020	JP
3	133 and 135 West Hicks Street	N	12/2020	JA
4	201 Sharp Street	SW	01/2021	JA
5	302 New Hicks Street	S	12/2020	JA
6	129 North Hicks Street	W	12/2020	JA
7	601 Windsor Avenue	SW	12/2020	JA
8	504 Windsor Avenue – typical contributing infill	NE	12/2020	JA
9	312 Davie Street	E	12/2020	JA
10	320 West Sixth Avenue	SW	01/2021	JA
11	207 East Fifth Avenue	N	01/2021	EH
12	510 Maple Street	SE	01/2021	JA
13	509 South Main Street	W	01/2021	EH
14	507 Belt Road	NW	01/2021	EH
15	St. Paul’s College, Mary E. Johnson Hall, 118 College Drive	NW	01/2021	JA
16	St. Paul’s College, Russell Hall, 21 College Drive	SE	01/2021	JA

Figure No.	Caption
1	Members of Alpha Kappa Alpha Sorority, Inc., Gamma Lambda Omega Chapter gather in Lawrenceville on August 12, 2017 to celebrate unveiling of Virginia Highway Marker S-92 honoring Nellie Pratt Russell (1890-1979). The marker was sponsored by members of the chapter. Photo source: Brunswick Times-Gazette, August 17, 2017.



Legend

Lawrenceville Historic District
DHR ID 251-5001
Lawrenceville, VA

Location Map Coordinates:

- 1. Lat: 36.764908 N
Lon: -77.702777 W
- 2. Lat: 36.765030 N
Lon: -77.841944 W
- 3. Lat: 36.751241 N
Lon: -77.841944 W
- 4. Lat: 36.751258 N
Lon: -77.858611 W



Lawrenceville
Historic District
Boundary



Feet

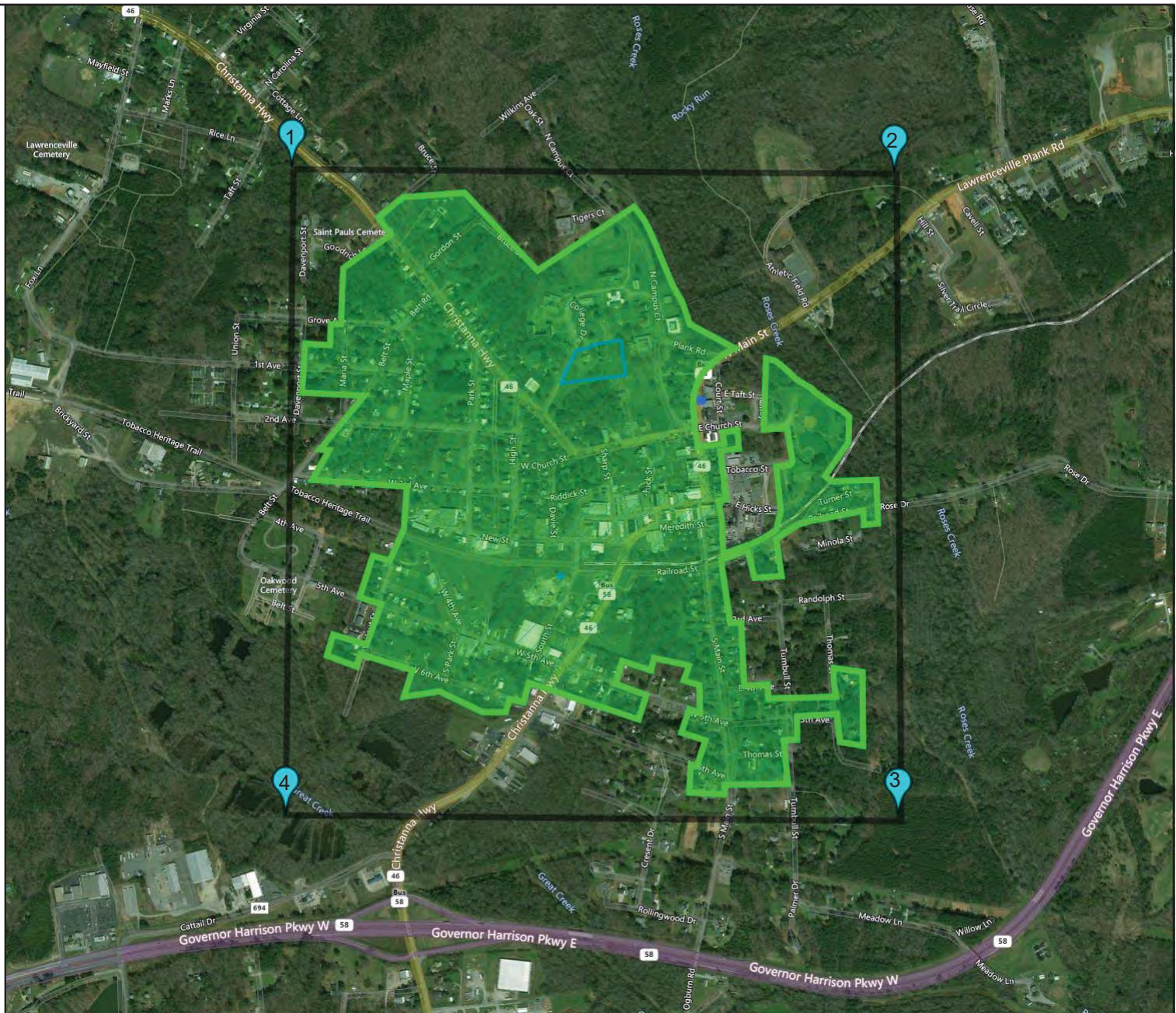
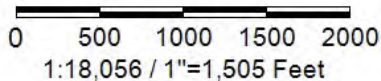

Title: Lawrenceville Historic District Location Map (251-5001)

Date: 3/2/2021

DISCLAIMER: Records of the Virginia Department of Historic Resources (DHR) have been gathered over many years from a variety of sources and the representation depicted is a cumulative view of field observations over time and may not reflect current ground conditions. The map is for general information purposes and is not intended for engineering, legal or other site-specific uses. Map may contain errors and is provided "as-is". More information is available in the DHR Archives located at DHR's Richmond office.

Notice if AE sites: Locations of archaeological sites may be sensitive the National Historic Preservation Act (NHPA), and the Archaeological Resources Protection Act (ARPA) and Code of Virginia §2.2-3705.7 (10). Release of precise locations may threaten archaeological sites and historic resources.



Legend

-  Architecture Resources
-  County Boundaries

Lawrenceville Historic District
Lawrenceville, VA

 Lawrenceville Historic District Boundary



Photo Locations



Feet

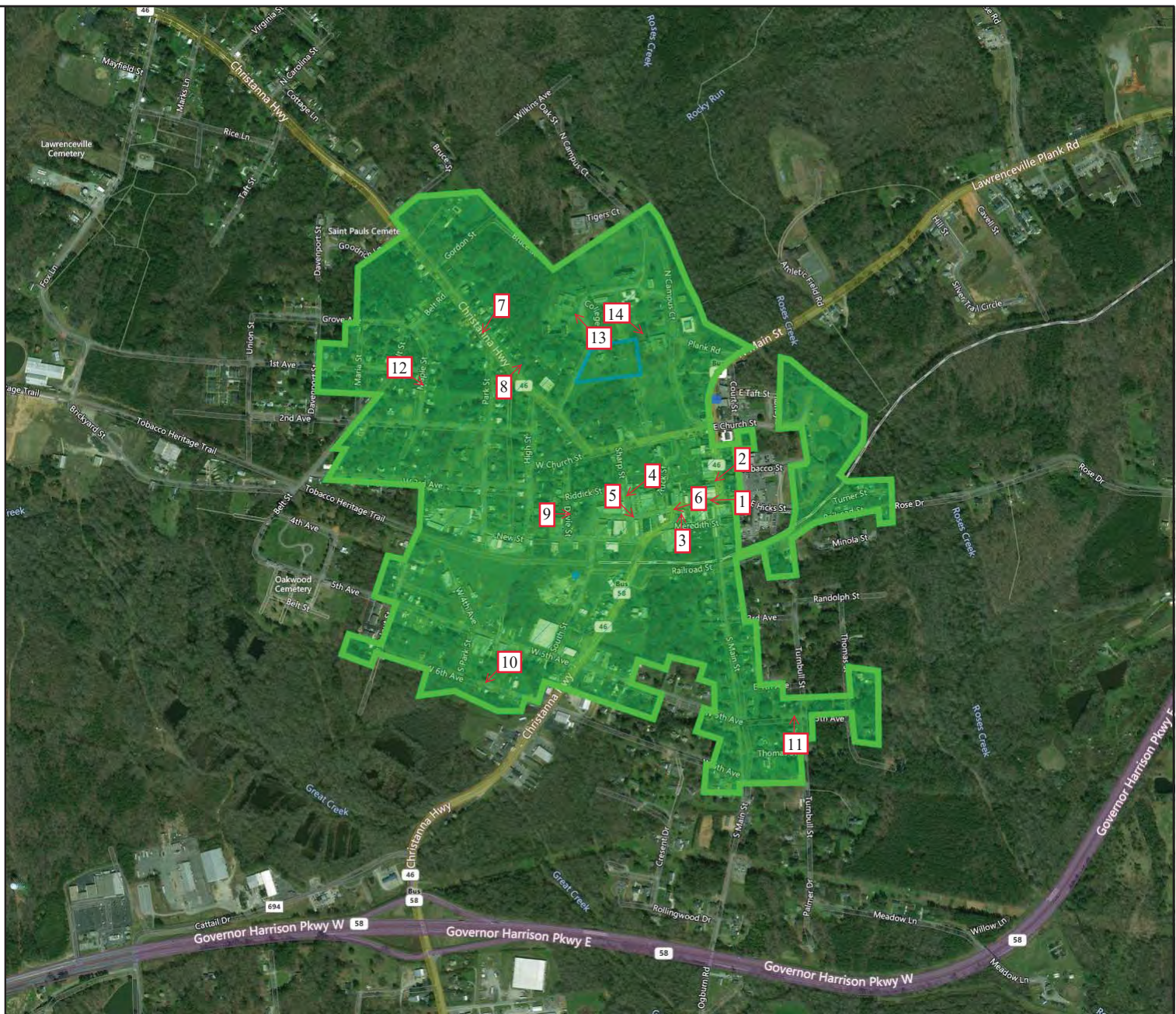
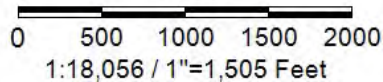

Title: Lawrenceville Historic District Photo Key (251-5001)

Date: 3/5/2021



DISCLAIMER: Records of the Virginia Department of Historic Resources (DHR) have been gathered over many years from a variety of sources and the representation depicted is a cumulative view of field observations over time and may not reflect current ground conditions. The map is for general information purposes and is not intended for engineering, legal or other site-specific uses. Map may contain errors and is provided "as-is". More information is available in the DHR Archives located at DHR's Richmond office.

Notice if AE sites: Locations of archaeological sites may be sensitive the National Historic Preservation Act (NHPA), and the Archaeological Resources Protection Act (ARPA) and Code of Virginia §2.2-3705.7 (10). Release of precise locations may threaten archaeological sites and historic resources.

Lawrenceville Historic District, Lawrenceville, VA (251-5001) Sketch Map 1



3/2/2021, 2:20:06 PM

-  Lawrenceville Historic District Boundary
-  Buildings
- 0001: DHR ID

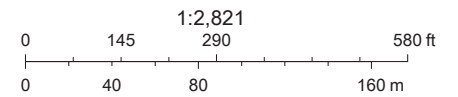

-  Parcel Boundaries
- NC : Non-Contributing
- * All other properties are contributing

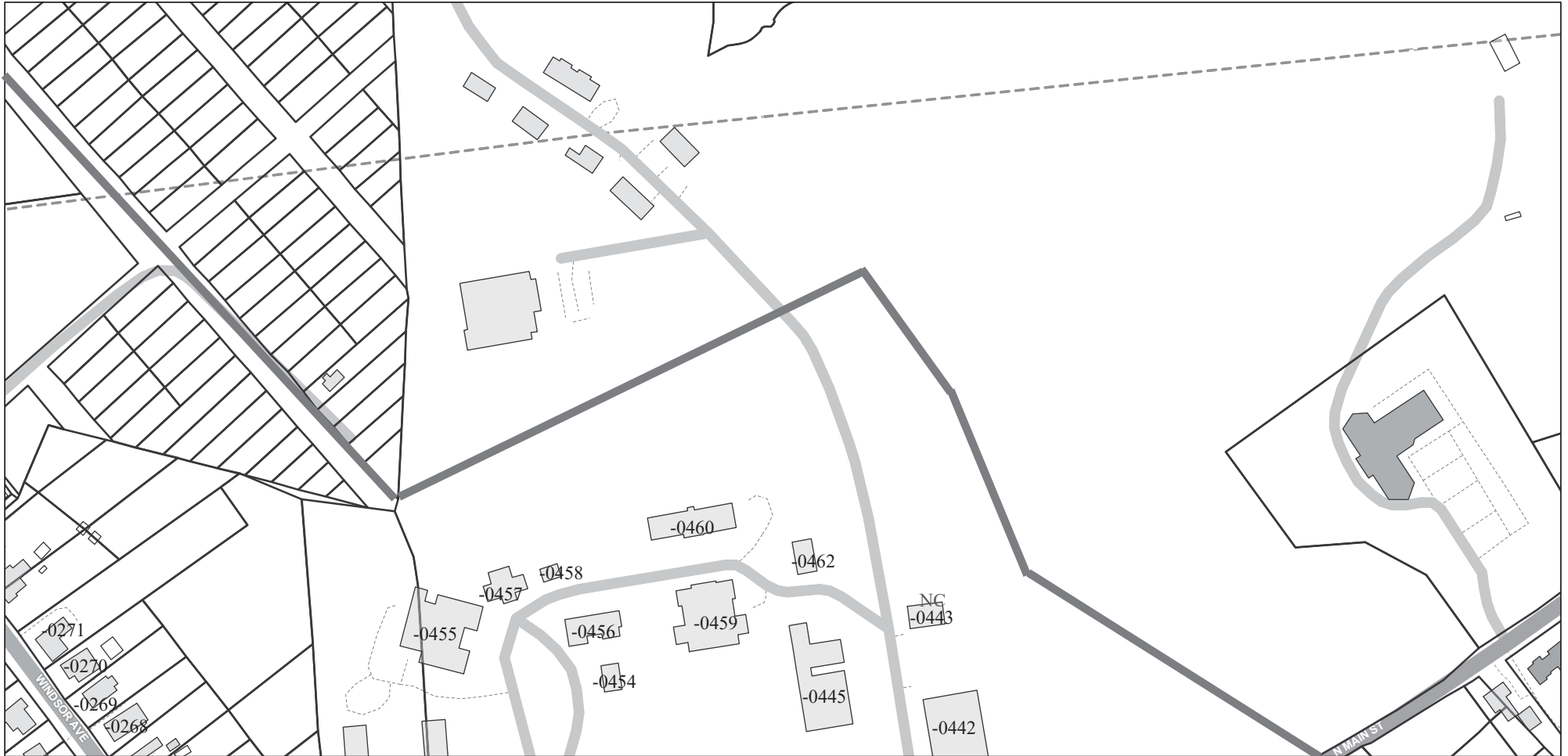

Lawrenceville Historic District, Lawrenceville, VA (251-5001) Sketch Map 2



3/2/2021, 2:22:13 PM

-  Lawrenceville Historic District Boundary
-  Buildings
- 0001: DHR ID

-  Parcel Boundaries
- NC : Non-Contributing
- * All other properties are contributing

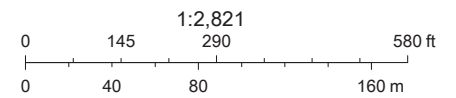

Lawrenceville Historic District, Lawrenceville, VA (251-5001) Sketch Map 3

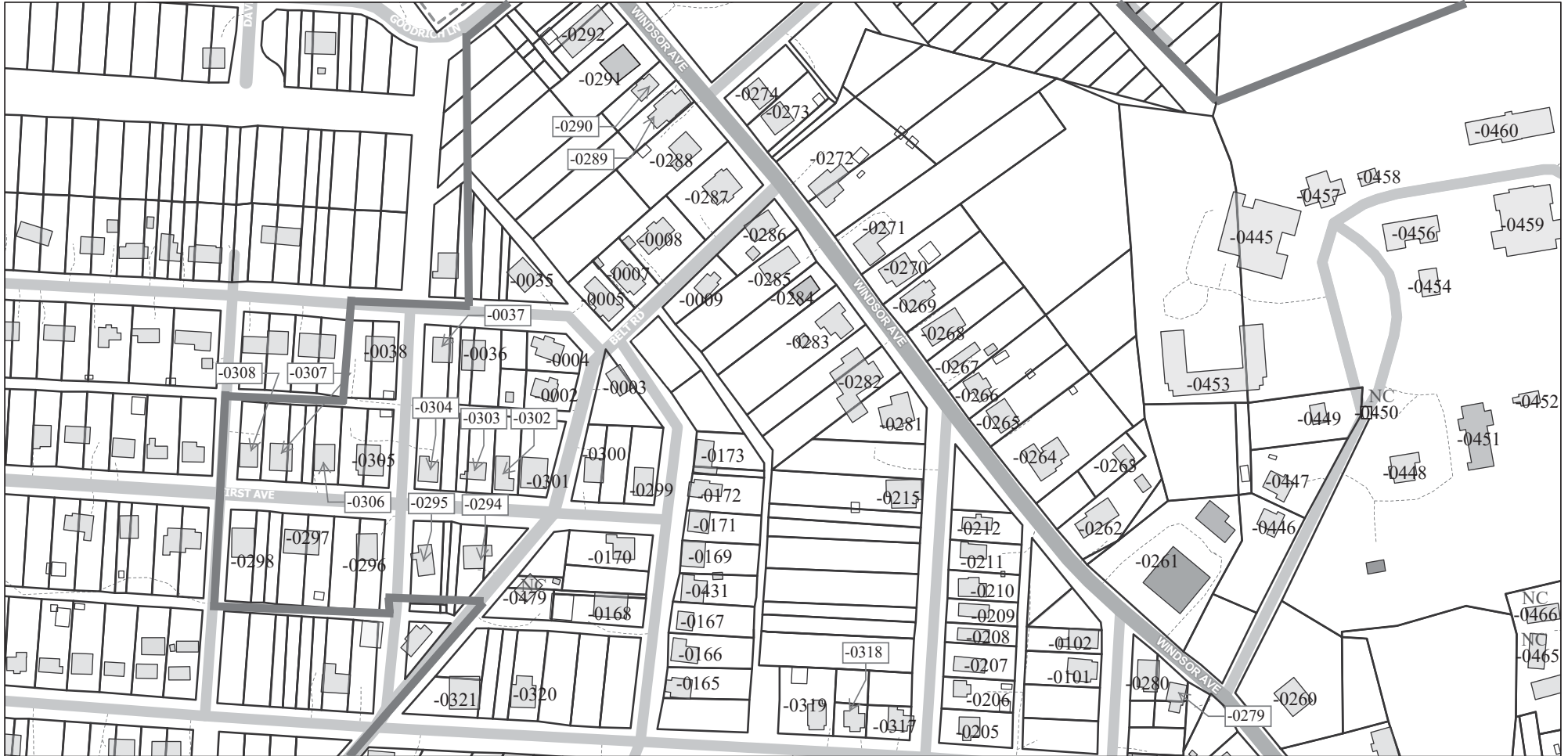

3/2/2021, 2:29:08 PM

-  Lawrenceville Historic District Boundary
-  Buildings
- 0001: DHR ID

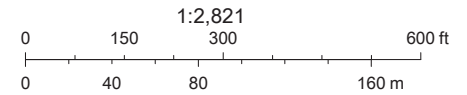

-  Parcel Boundaries
- NC : Non-Contributing
- * All other properties are contributing



Lawrenceville Historic District, Lawrenceville, VA (251-5001) Sketch Map 5



3/2/2021, 2:32:35 PM

-  Lawrenceville Historic District Boundary
-  Buildings
- 0001: DHR ID

-  Parcel Boundaries
- NC : Non-Contributing
- * All other properties are contributing

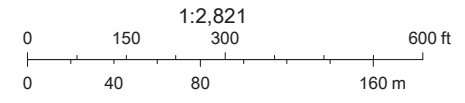

Lawrenceville Historic District, Lawrenceville, VA (251-5001) Sketch Map 6A



3/3/2021, 12:11:06 PM

Buildings
 -0001: DHR ID

Parcel Boundaries

NC : Non-Contributing

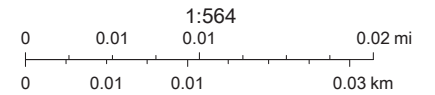

* All other properties are contributing



Lawrenceville Historic District, Lawrenceville, VA (251-5001) Sketch Map 7



3/2/2021, 2:37:22 PM

-  Lawrenceville Historic District Boundary
-  Buildings
- 0001: DHR ID

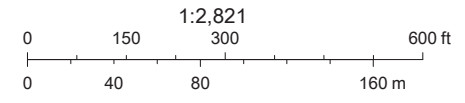

-  Parcel Boundaries
- NC : Non-Contributing
- * All other properties are contributing



Lawrenceville Historic District, Lawrenceville, VA (251-5001) Sketch Map 8



3/2/2021, 2:39:45 PM

-  Lawrenceville Historic District Boundary
-  Buildings
- 0001: DHR ID

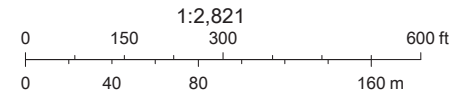

-  Parcel Boundaries
- NC : Non-Contributing
- * All other properties are contributing



Lawrenceville Historic District, Lawrenceville, VA (251-5001) Sketch Map 9



3/2/2021, 2:41:03 PM

-  Lawrenceville Historic District Boundary
-  Buildings
- 0001: DHR ID

-  Parcel Boundaries
- NC : Non-Contributing
- * All other properties are contributing

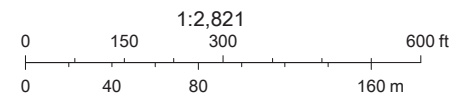

Lawrenceville Historic District, Lawrenceville, VA (251-5001) Sketch Map 10



3/2/2021, 2:42:46 PM

-  Lawrenceville Historic District Boundary
-  Buildings
- 0001: DHR ID

-  Parcel Boundaries
- NC : Non-Contributing
- * All other properties are contributing

