

United States Department of the Interior  
 National Park Service

*demolished 1945 1946*

# National Register of Historic Places Registration Form

This form is for use in nominating or requesting determinations of eligibility for individual properties or districts. See instructions in *Guidelines for Completing National Register Forms* (National Register Bulletin 16). Complete each item by marking "x" in the appropriate box or by entering the requested information. If an item does not apply to the property being documented, enter "N/A" for "not applicable." For functions, styles, materials, and areas of significance, enter only the categories and subcategories listed in the instructions. For additional space use continuation sheets (Form 10-900a). Type all entries.

### 1. Name of Property

historic name Montgomery White Sulphur Springs Cottage  
 other names/site number Haley House; 154-8

### 2. Location Northwest corner of Depot and

street & number New streets N/A  not for publication  
 city, town Christiansburg N/A  vicinity  
 state Virginia code VA county Montgomery code 121 zip code 24073

### 3. Classification

#### Ownership of Property

- private  
 public-local  
 public-State  
 public-Federal

#### Category of Property

- building(s)  
 district  
 site  
 structure  
 object

#### Number of Resources within Property

Contributing	Noncontributing	
<u>1</u>	<u>0</u>	buildings
<u>0</u>	<u>0</u>	sites
<u>0</u>	<u>0</u>	structures
<u>0</u>	<u>0</u>	objects
<u>1</u>	<u>0</u>	Total

Name of related multiple property listing: Prehistoric and Historic Resources of Montgomery County

Number of contributing resources previously listed in the National Register 0

### 4. State/Federal Agency Certification

As the designated authority under the National Historic Preservation Act of 1966, as amended, I hereby certify that this  nomination  request for determination of eligibility meets the documentation standards for registering properties in the National Register of Historic Places and meets the procedural and professional requirements set forth in 36 CFR Part 60. In my opinion, the property  meets  does not meet the National Register criteria.  See continuation sheet.

Signature of certifying official

Date

Virginia Department of Historic Resources

State or Federal agency and bureau

In my opinion, the property  meets  does not meet the National Register criteria.  See continuation sheet.

Signature of commenting or other official

Date

State or Federal agency and bureau

### 5. National Park Service Certification

I, hereby, certify that this property is:

- entered in the National Register.  
 See continuation sheet.  
 determined eligible for the National Register.  See continuation sheet.  
 determined not eligible for the National Register.  
 removed from the National Register.  
 other. (explain) \_\_\_\_\_

Signature of the Keeper

Date of Action

## 6. Function or Use

Historic Functions (enter categories from instructions)

Health care: resort

Current Functions (enter categories from instructions)

Domestic: single dwelling

## 7. Description

Architectural Classification  
(enter categories from instructions)

Mid-19th century: Italian Villa

Materials (enter categories from instructions)

foundation brick

walls wood: weatherboard

roof metal: tin

other

Describe present and historic physical appearance.

The Montgomery White Sulphur Springs Cottage on Depot Street is now located in a commercial district just to the northwest of downtown Christiansburg. The one-story, two-room structure has a four-bay facade with two doors in the center bays. The hipped, standing-seam metal roof has a brick central chimney. The four-bay porch is integral to the main roof and is supported by tapered square columns on plinths. The doors are surmounted by transoms and the large six-over-six double-hung sash windows have early blinds. A frame leanto addition across the rear (north) increased the floor space, as did a later concrete block wing to the southwest, without compromising the house's visual integrity.

The interior features Greek Revival-style molded trim and mantels. The room arrangement from the original site, consisting of two rooms divided by a chimney stack, has been preserved.

**8. Statement of Significance**

Certifying official has considered the significance of this property in relation to other properties:

nationally     statewide     locally

Applicable National Register Criteria     A     B     C     D

Criteria Considerations (Exceptions)     A     B     C     D     E     F     G

Areas of Significance (enter categories from instructions)

Period of Significance

Significant Dates

Entertainment/Recreation  
Architecture

mid-1850s - ca. 1904

ca. 1904

Cultural Affiliation

N/A

Significant Person

Architect/Builder

N/A

Unknown

State significance of property, and justify criteria, criteria considerations, and areas and periods of significance noted above.

The Montgomery White Sulphur Springs Cottage in Christiansburg is one of three surviving structures from the Montgomery White Sulphur Springs resort. The property is eligible under criterion A as an important example of the cottages built for the summer use of guests at mid-nineteenth-century resorts, a type of resource particularly popular in the mountains of western Virginia at that time. It is also eligible under criterion C as an example of the architecture associated with such resorts. The building is similar in plan and form to a somewhat later example also being nominated at Crockett Springs (60-487). Its relocation in ca. 1904 to Christiansburg corresponded to the sale of all of the structures on the site. The relocation to the Christiansburg site contributes to the architectural significance by demonstrating the common historical practice of relocating and reusing structures.

The Montgomery White Sulphur Springs resort was built in the mid-1850s in response to the advent of the railway in the area, and it soon superceded in scale and grandeur the nearly-fifty-years-older Yellow Sulphur Springs several miles to the west (listed in the National Register in 1978). The frame buildings were arranged in a large quadrangular pattern and faced a central lawn ornamented with several pavilions. The resort was unusual in that the rows of detached cottages were built in picturesquely varying heights and sizes, symmetrically arranged to either side of a central hotel on each of the long sides of the quadrangle. The architectural style was Italianate with Greek Revival elements. Deep bracketed eaves, arcades, and elaborate railings were used to give the buildings distinction.

**9. Major Bibliographical References**

Bevgochea, Arthur et al. "Springs of Montgomery County." Paper written at Virginia Polytechnic Institute and State University for History 4120, 1976.

Cohen, Stan. Historic Springs of the Virginias. Charleston: the Pictoral Histories Publishing Company, 1981.

Lucas, Charlie. Interview, 1986.

See continuation sheet

Previous documentation on file (NPS):

- preliminary determination of individual listing (36 CFR 67) has been requested
- previously listed in the National Register
- previously determined eligible by the National Register
- designated a National Historic Landmark
- recorded by Historic American Buildings Survey # \_\_\_\_\_
- recorded by Historic American Engineering Record # \_\_\_\_\_

Primary location of additional data:

- State historic preservation office
- Other State agency
- Federal agency
- Local government
- University
- Other

Specify repository:

Virginia Department of Historic Resources  
221 Governor Street  
Richmond, VA 23219

**10. Geographical Data**

Acreage of property less than one acre.

UTM References

A 17 5152000 411091300  
 Zone Easting Northing

C         

B           
 Zone Easting Northing

D         

See continuation sheet

Verbal Boundary Description

Beginning at point A, 100 feet southwest of the corner of Depot and New streets, on the northwest side of Depot Street, proceeding north 97 feet along a lot line to point B, thence east 100 feet along a lot line to point C, thence south 97 feet along a lot line to point D, thence west 100 feet along a lot line to the point of origin.

See continuation sheet

Boundary Justification

The boundaries correspond to the edges of the original lot onto which the house was moved and which enclose its domestic-related space. These boundaries also correspond to lot 526-(A)-223 on the county tax maps.

See continuation sheet

**11. Form Prepared By**

name/title Gibson Worsham date June 1988  
 organization Gibson Worsham, Architect telephone (703) 552-4730  
 street & number Route 2, Yellow Sulphur Springs state Virginia zip code 24073  
 city or town Christiansburg

United States Department of the Interior  
National Park Service

## National Register of Historic Places Continuation Sheet

Prehistoric and Historic  
Resources of Montgomery County  
Montgomery White Sulphur  
Springs Cottage, 154-8

Section number 8 Page 1

---

The resort was among the most popular in the state; before the Civil War the spa accommodated 1,000 guests, and after the war as many as twenty-four former Confederate generals gathered there at one time. It was one of the region's most fashionable resorts and its activities were widely reported in the state's newspapers. In 1904 the property including the buildings was sold at auction after years of failing economic health. The end was apparently hurried along by a summer freshet that flooded the grounds. A neighbor of the house at its present location remembers it being built by a Mr. Harley, and that Mr. Harley was employed as a blacksmith and wagon repairman at White Sulphur Springs (Lucas). Historic photographs in Historic Springs of the Virginias show a similar building at that site, so that it seems clear that Haley bought the building and moved it to Christiansburg in ca. 1904.

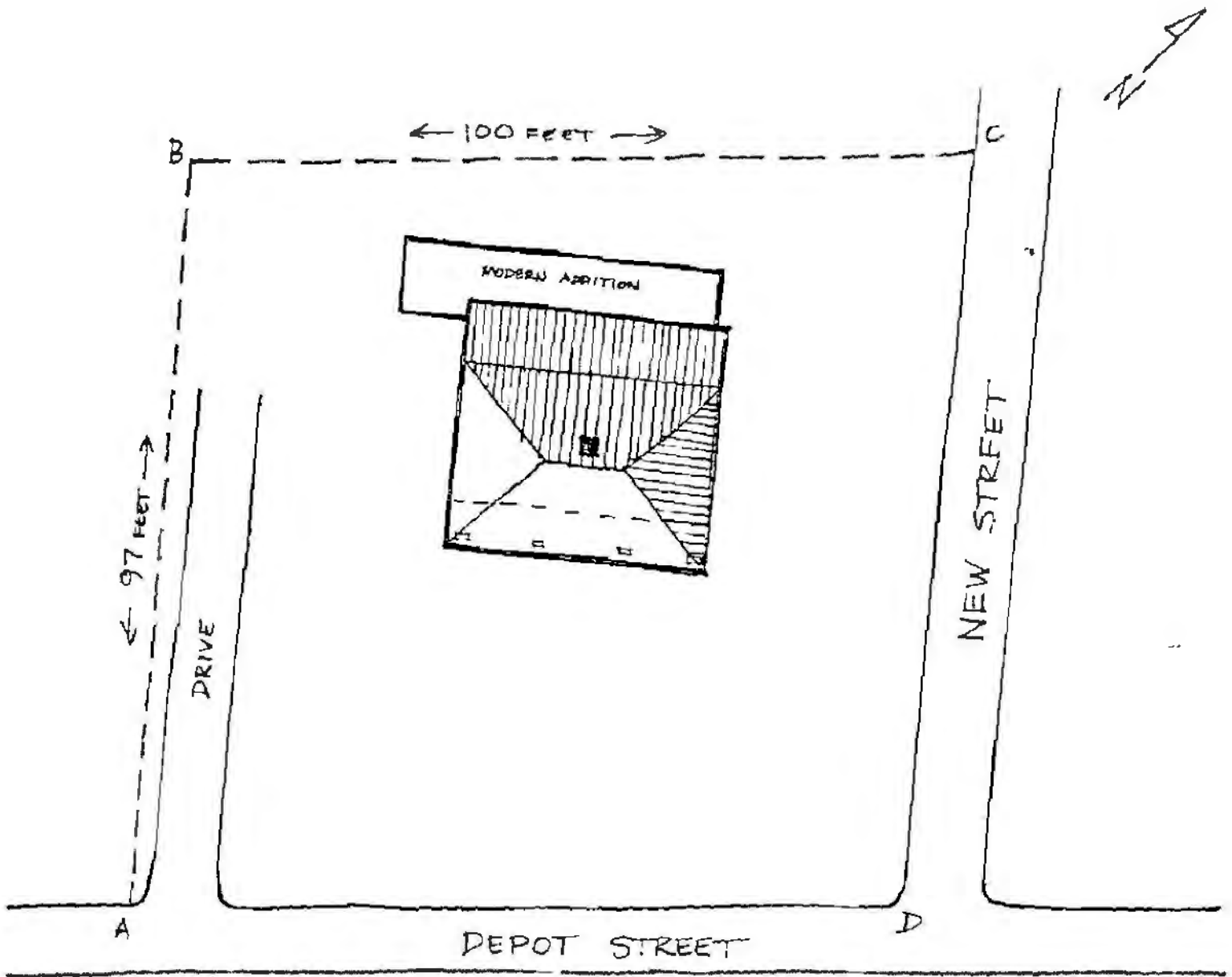

154-8 MONTGOMERY WHITE SULPHUR SPRINGS COTTAGE  
 G. WORSHAM  
 K. MARTIN 04/88

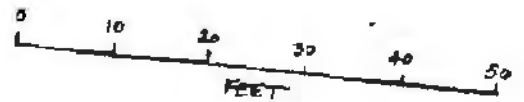

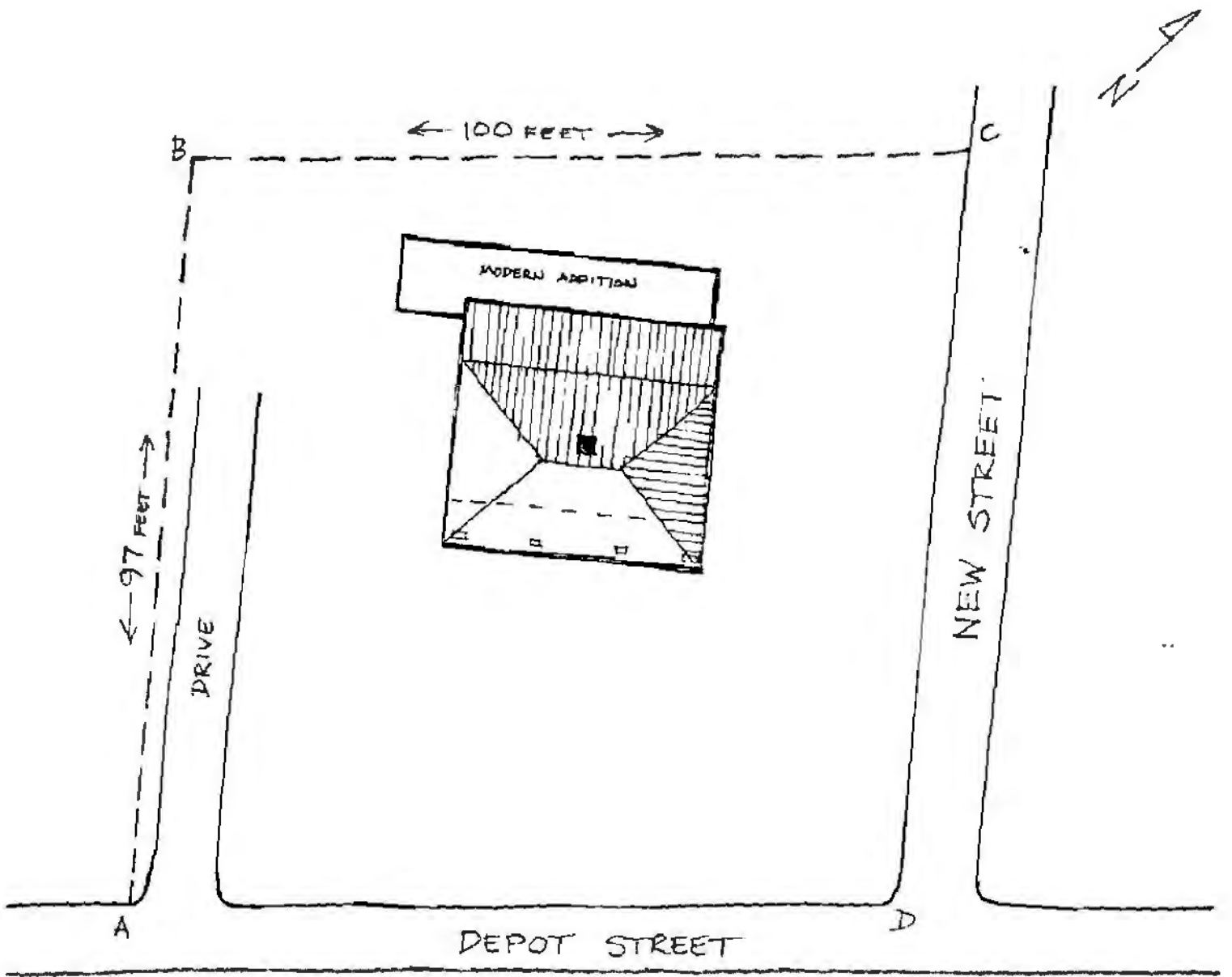

154-8 MONTGOMERY WHITE SULPHUR SPRINGS COTTAGE  
 G. WORSHAM  
 K. MARTIN 04/88

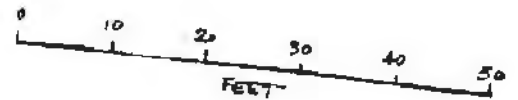

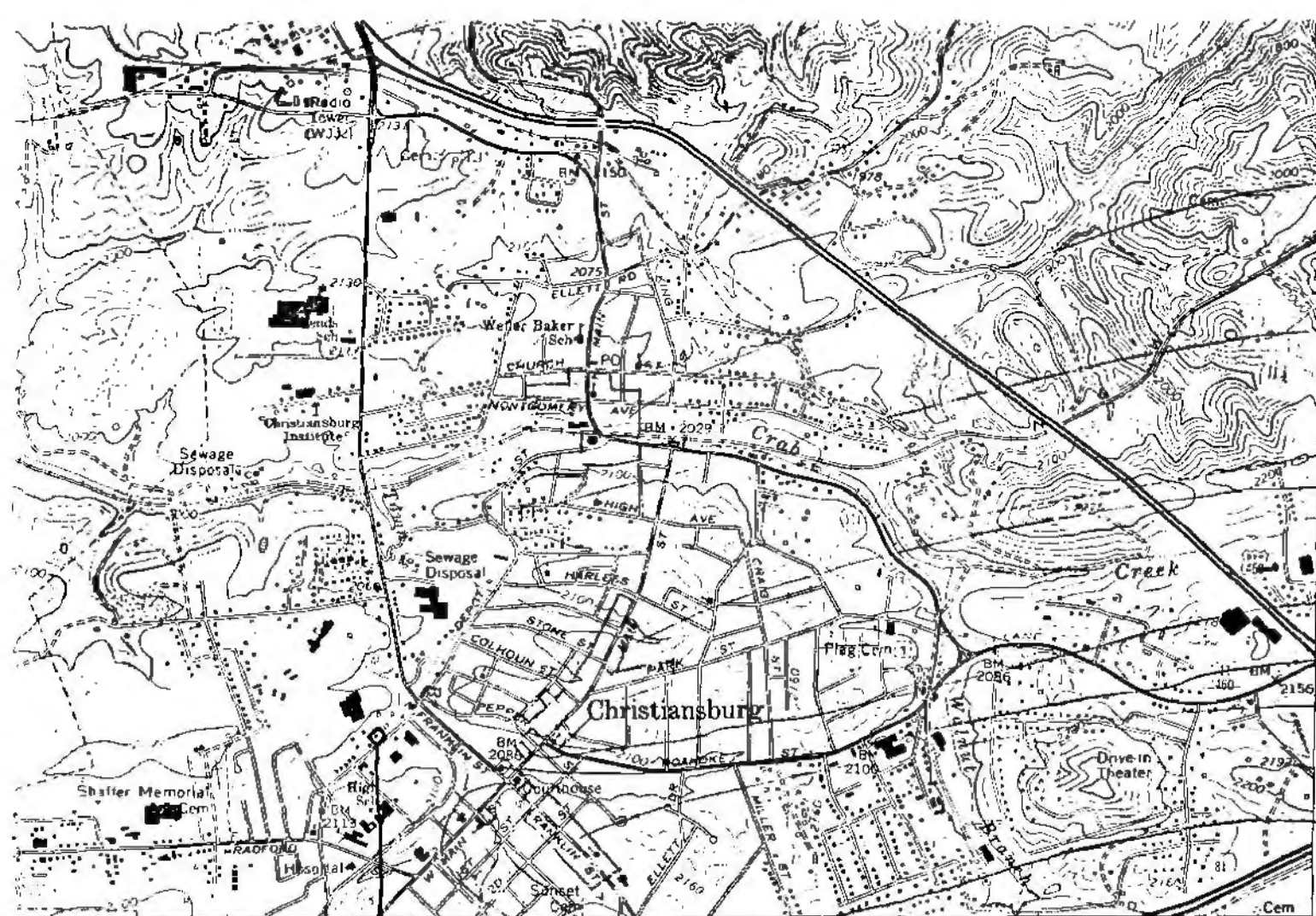

CAMPBELL HISTORIC DISTRICT  
 17 553230 4110420  
 17 553240 4110805  
 17 553240 4110010  
 17 554230 4110435

SURFACE HOUSE  
 17 552595 4110280

E. MAIN ST. HISTORIC DISTRICT  
 17 552520 4109410  
 17 552700 4109290  
 17 553178 4109562  
 17 552690 4109300

HARRISON-HANCOCK HARDWARE  
 17 552510 4109270 BLDG.  
 CHRISTIANBURG POST OFFICE  
 17 552430 4109220

S. FRANKLIN ST. HISTORIC DISTRICT  
 17 553490 4109017  
 17 553320 4109320  
 17 553045 4108910  
 17 553200 4108805

A.L. JOHNSON STORE BUILDING  
 17 552410 4109070

PULICAR BUILDING  
 17 551540 4109160

MONTGOMERY WHITE SULPHUR  
 CRINK'S COTTAGE  
 17 551985 4109360

ROAD CLASSIFICATION

Heavy-duty	—————	Light duty	—————
Medium duty	—————	Unimproved dirt	-----
Interstate Route	—————	U. S. Route	—————
		State Route	—————

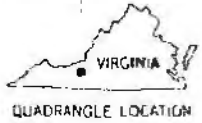

**BLACKSBURG, VA.**

N3707.5—W8022 5/7.5

1965  
 PHOTOREVISED 1978  
 AMS 4958 III NW—SERIES V834

Boundary lines shown in purple compiled from latest information available from the controlling authority

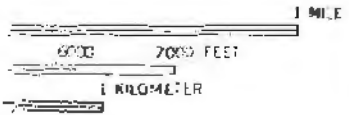

STANDARDS  
 VIRGINIA 22092  
 ESVILLE, VIRGINIA 22903  
 AVAILABLE ON REQUEST